

HF | 模块框架技术特性

Hinged frames technical characteristics

技术参数/Technical characteristics

模块数量/Number of modules	2, 3, 4, 6
接地线/PE contact(Wire gauge)	
- 功率线/Power side	4-10mm ²
	AWG 12-8
- 信号线/Signal side	1-2.5mm ²
	18-14
材料/Material	zinc die-cast
工作温度范围/Limiting temperatures	-40°C...+125°C
可拔插次数/Mechanical working life(mating cycles)	≥500

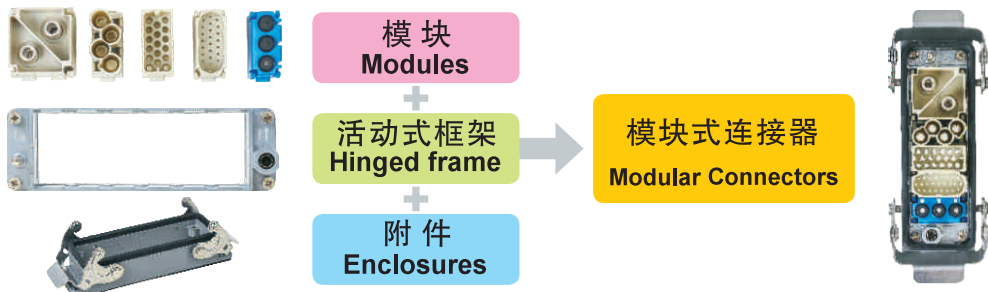

框架结构类型 1, 滑动边框锁定结构/frame construction version 1

Unit: mm

HF

6B 活动框架 适用所有6B外壳
6B frame, size 6B hoods/housings



描述/Application	标示/Marking	型号/Type
用于2个模块/for 2 modules	A-B	SO-HF6B-UA
用于2个模块/for 2 modules	a-b	SO-HF6B-LA

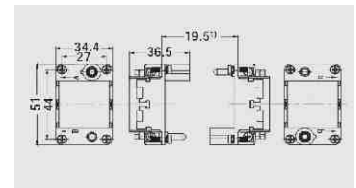

10B 活动框架 适用所有10B外壳
10B frame, size 10B hoods/housings



描述/Application	标示/Marking	型号/Type
用于3个模块/for 3 modules	A-C	SO-HF10B-UA
用于3个模块/for 3 modules	a-c	SO-HF10B-LA

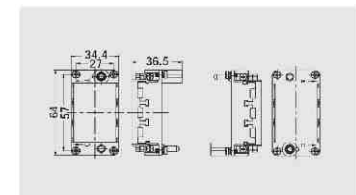

16B 活动框架 适用所有16B外壳
16B frame, size 16B hoods/housings



描述/Application	标示/Marking	型号/Type
用于4个模块/for 4 modules	A-D	SO-HF16B-UA
用于4个模块/for 4 modules	a-d	SO-HF16B-LA

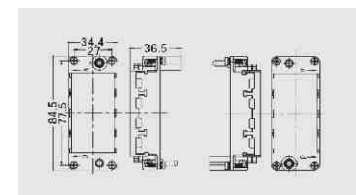

24B 活动框架 适用所有24B外壳
24B frame, size 10B hoods/housings



描述/Application	标示/Marking	型号/Type
用于6个模块/for 6 modules	A-F	SO-HF24B-UA
用于6个模块/for 6 modules	a-f	SO-HF24B-LA

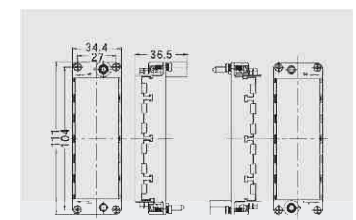

HF | 模块框架技术特性

Hinged frames technical characteristics

技术参数/Technical characteristics

模块数量/Number of modules	2,3,4,6
接地线/PE contact(Wire gauge)	
- 功率线/Power side	4-10mm ²
	AWG 12-8
- 信号线/Signal side	1-2.5mm ²
	18-14
材料/Material	聚碳酸酯/PC
工作温度范围/Limiting temperatures	-40°C...+125°C
可拔插次数/Mechanical working life(mating cycles)	≥ 500

frame construction version 框架结构类型：浮动安装

塑料模块框架 6B Docking frames 6B



描述/Application	标示/Marking	型号/Type
用于2个模块/for 2 modules	A-B	SO-HF6B.P-UA
用于2个模块/for 2 modules	a-b	SO-HF6B.P-LA

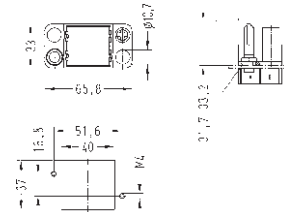

塑料模块框架 10B Docking frames 10B



描述/Application	标示/Marking	型号/Type
用于3个模块/for 3 modules	A-C	SO-HF10B.P-UA
用于3个模块/for 3 modules	a-c	SO-HF10B.P-LA

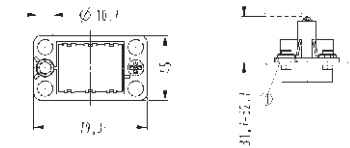

塑料模块框架 16B Docking frames 16B



描述/Application	标示/Marking	型号/Type
用于4个模块/for 4 modules	A-D	SO-HF16B.P-UA
用于4个模块/for 4 modules	a-d	SO-HF16B.P-LA

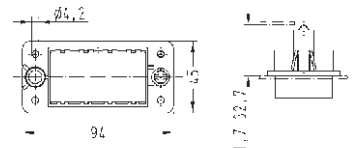

塑料模块框架 24B Docking frames 24B



描述/Application	标示/Marking	型号/Type
用于6个模块/for 6 modules	A-F	SO-HF24B.P-UA
用于6个模块/for 6 modules	a-f	SO-HF24B.P-LA

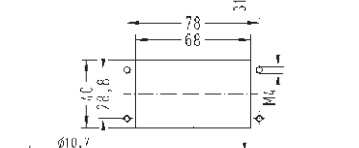

漂浮垫圈 Washer for M4 Fixing screws



用于固定塑料模块

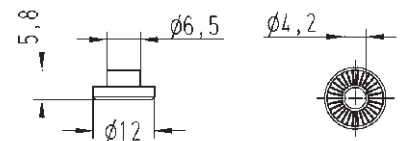

HF