

# HD | 技术特性

Technical characteristics

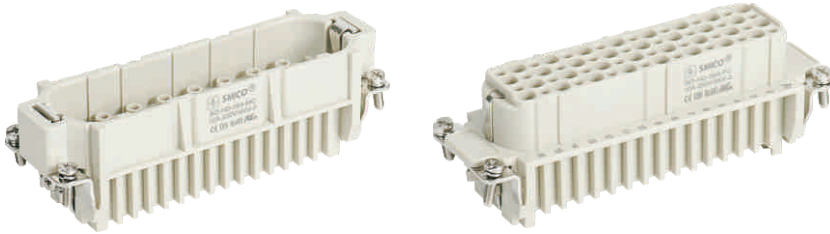

## 电流负载能力

### Current carrying capacity

电流负载能力所受的限制主要来自包含接插针的接插体可承受的最大温度  
The current carrying is limited by maximum temperature of materials for inserts and contacts including terminals

测试和控制过程依据DIN IEC 60512-5  
Control and test procedures according to DIN IEC 60512-5

## 规范/Specifications

接插体/Inserts

接插件针数/Number of contacts

DIN EN 60 664  
DIN EN 61 984

7, 15, 25, 40, 50, 64, 80, 128,  
50(2x25), 80(2x40),  
128(2x64)+PE

工作电流/Working current

( 见负载图/See current carrying capacity )

工作电压/Working voltage

额定脉冲耐受电压/Rated impulse voltage

污染等级/Pollution degree

当污染程度2时参数/Pollution degree 2 also

绝缘电阻/Insulation resistance

材料/Material

阻燃等级UL94/Flammability acc.to(UL94)

工作温度范围/Limiting temperatures

插拔次数/Mechanical working life (mating cycles)

据UL/CSA工作电压/Working voltage acc.to UL/CSA

10A 250V 4KV 3

10 A 230/400V 4KV 2

$\geq 10^{10} \Omega$

Polycarbonate

V0

-40°C ~ +125°C

$\geq 500$

600V

## 接插针/Contacts

材料/Material

表面处理/Surface

接触电阻/Contact resistance

接线形式/Terminal

导线规格/Wire gauge

铜/Copper alloy

镀金/Gold plated

镀银/Silver plated

$\leq 3m\Omega$

冷压压接/Crimp terminal

0.14-2.5mm<sup>2</sup>(AWG26-14)

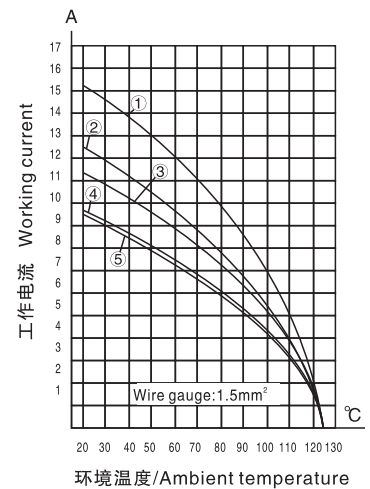
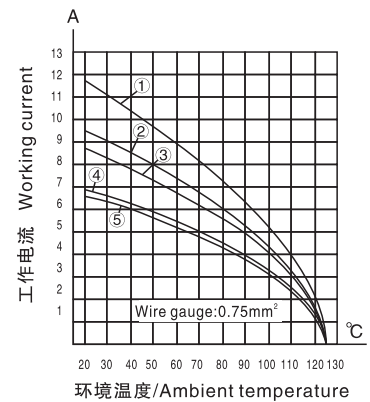

- ① SO-HD-007      ④ SO-HD-040
- ② SO-HD-015      ⑤ SO-HD-064
- ③ SO-HD-025

# SO-HD

接插件针数

Number of contacts

7 +

插芯/Insert 250V 10A

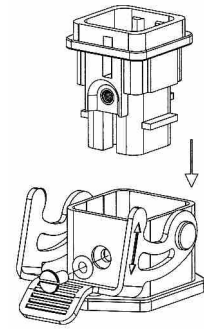

安装示意图  
Mounting example

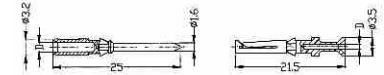

TYPE

SO-HD-007-MC

SO-HD-007-FC

尺寸图

Drawing(Dimensions in mm)

公插体

Male insert (MC)

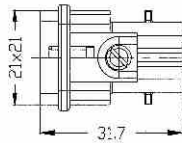
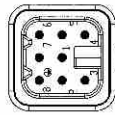
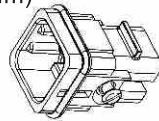

母插体

Female insert (FC)

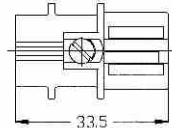
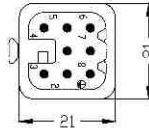
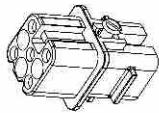

Crimp contacts	Wire gauge	D	Stripping length
	0.14~0.37mm <sup>2</sup>	AWG 26-22	0.90mm
	0.5mm <sup>2</sup>	AWG 20	1.10mm
	0.75mm <sup>2</sup>	AWG 18	1.30mm
	1.0mm <sup>2</sup>	AWG 18	1.45mm
	1.5mm <sup>2</sup>	AWG 16	1.75mm
	2.5mm <sup>2</sup>	AWG 14	2.25mm

Note: 10A冷压针需另外订购, 订货号详情请参见第100页  
Crimp termina of 10A should order contacts pins separately, detail please refer to page 100

HD

# SO-HD

接插件针数

Number of contacts

8 +

插芯/Insert -120V/~50V 10A

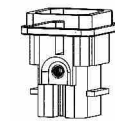

安装示意图  
Mounting example

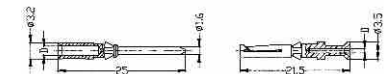
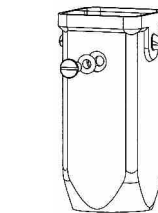

TYPE

SO-HD-008-MC

SO-HD-008-FC

尺寸图

Drawing(Dimensions in mm)

公插体

Male insert (MC)

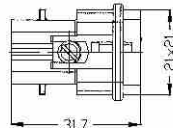
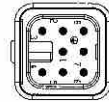
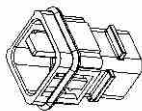

母插体

Female insert (FC)

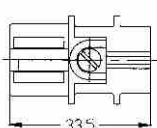
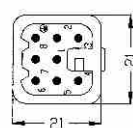
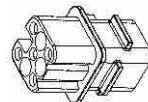

Crimp contacts	Wire gauge	D	Stripping length
	0.14~0.37mm <sup>2</sup>	AWG 26-22	0.90mm
	0.5mm <sup>2</sup>	AWG 20	1.10mm
	0.75mm <sup>2</sup>	AWG 18	1.30mm
	1.0mm <sup>2</sup>	AWG 18	1.45mm
	1.5mm <sup>2</sup>	AWG 16	1.75mm
	2.5mm <sup>2</sup>	AWG 14	2.25mm

Note: 10A冷压针需另外订购, 订货号详情请参见第100页  
Crimp termina of 10A should order contacts pins separately, detail please refer to page 100

Note: 配套外壳 Suit hood/housing: Size H3A  
外壳详细参数见“外壳部分”  
Hood/Housing detail on "Hood/Housing" section

# SO-HD

插芯/Insert 250V 10A

接插件针数

Number of contacts

15,25,40,64 +



SO-HD-015-MC



SO-HD-015-FC



SO-HD-025-MC



SO-HD-025-FC

TYPE

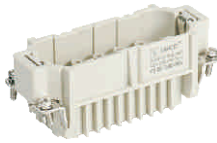

SO-HD-040-MC



SO-HD-040-FC



SO-HD-064-MC

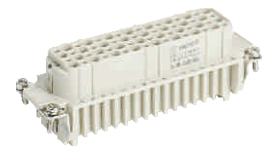

SO-HD-064-FC

TYPE

## 尺寸图

Drawing(Dimensions in mm)

### 公插体

Male insert (MC)

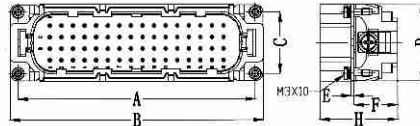
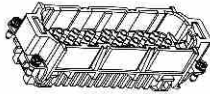

### Male insert(M)

number of contacts	A	B	C	D	E	F	H
SO-HD-015	49.5	56.5	16	22.8	1	14	33
SO-HD-025	66	73	16	22.8	1.2	14.8	34
SO-HD-040	77.5	84.5	27	34	1.2	19	34
SO-HD-064	104	111	27	34	1.2	19	36

### 母插体

Female insert (FC)

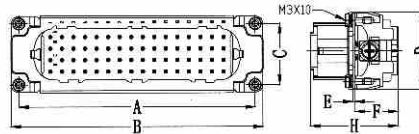
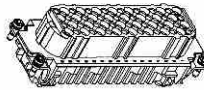

### Female insert(F)

number of contacts	A	B	C	D	E	F	H
SO-HD-015	49.5	56.5	16	22.8	1	4.5	33.2
SO-HD-025	66	73	16	22.8	1	5.5	34
SO-HD-040	77.5	84.5	27	34	1.2	6.8	37.2
SO-HD-064	104	111	27	34	1.2	9	38.5

## 面板安装开孔图

Panel cut out for inserts

for use without hoods/housings

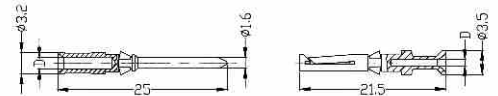
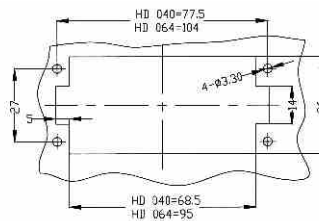
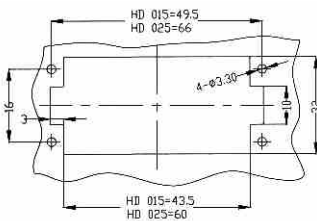

Crimp contacts	Wire gauge	D	Stripping length
Gold plated	0.14-0.37mm <sup>2</sup>	AWG 26-22	0.90mm
	0.5mm <sup>2</sup>	AWG 20	1.10mm
Silver plated	0.75mm <sup>2</sup>	AWG 18	1.30mm
	1.0mm <sup>2</sup>	AWG 18	1.45mm
	1.5mm <sup>2</sup>	AWG 16	1.75mm
	2.5mm <sup>2</sup>	AWG 14	2.25mm

Note: 配套外壳 Suit hood/housing: Size H10A,H16A,H16B,H24B  
外壳详细参数见“外壳部分”  
Hood/Housing detail on "Hood/Housing" section

Note: 10A冷压针需另外订购, 订货号详情请参见第100页  
Crimp termina of 10A should order contacts pins separately,detail please refer to page 100