

Комплектующие для канатных стропов

ЗВЕНО ИСПОЛНЕНИЕ Ов1 по ГОСТ 25573-82

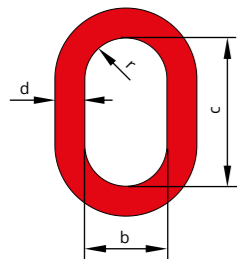

| Обозначение звена | Допускаемая нагрузка, кН (тс) | d | b | c | r | Вес штуки, кг |
|-------------------|-------------------------------|----|-----|-----|-----|---------------|
| | | мм | | | | |
| Ов1-0,5 | 4,90 (0,50) | 11 | 32 | 55 | 16 | 0,135 |
| Ов1-0,63 | 6,18 (0,63) | 14 | 36 | 60 | 18 | 0,248 |
| Ов1-0,8 | 7,85 (0,80) | | 40 | 70 | 20 | 0,278 |
| Ов1-1,0 | 9,81 (1,00) | 16 | 44 | 80 | 22 | 0,411 |
| Ов1-1,25 | 12,26 (1,25) | 18 | 50 | 90 | 25 | 0,464 |
| Ов1-1,6 | 15,70 (1,60) | 20 | 56 | 100 | 28 | 0,781 |
| Ов1-2,0 | 19,62 (2,00) | 22 | 60 | 110 | 30 | 1,068 |
| Ов1-2,5 | 24,52 (2,50) | 25 | 70 | 120 | 35 | 1,545 |
| Ов1-3,2 | 31,40 (3,20) | 28 | 80 | 130 | 40 | 2,123 |
| Ов1-4,0 | 39,24 (4,00) | 32 | 90 | 150 | 45 | 3,176 |
| Ов1-5,0 | 49,05 (5,00) | 36 | 100 | 170 | 50 | 4,530 |
| Ов1-6,3 | 61,80 (6,30) | 40 | 110 | 190 | 55 | 6,225 |
| Ов1-8,0 | 78,50 (8,00) | 45 | 120 | 210 | 60 | 8,714 |
| Ов1-10,0 | 98,10 (10,00) | 50 | 140 | 230 | 70 | 11,976 |
| Ов1-12,5 | 122,60 (12,50) | 56 | 150 | 260 | 75 | 16,763 |
| Ов1-16,0 | 157,00 (16,00) | 65 | 200 | 290 | 100 | 26,440 |
| Ов1-20,0 | 196,20 (20,00) | 72 | 220 | 320 | 110 | 35,380 |

ЗВЕНО ИСПОЛНЕНИЯ Рт1 по ГОСТ 25573-82

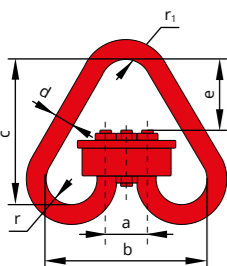

| Обозначение звена | Допускаемая нагрузка, кН (тс) | d | a | b | c | e | r | r ₁ | Вес штуки, кг |
|-------------------|-------------------------------|----|-----|-----|-----|-----|----|----------------|---------------|
| | | мм | | | | | | | |
| Рт1-1,25 | 12,26 (1,25) | 16 | 38 | 142 | 130 | 66 | 22 | 22 | 1,33 |
| Рт1-1,6 | 15,70 (1,60) | 18 | 42 | 156 | 140 | 73 | 25 | 25 | 1,69 |
| Рт1-2,0 | 19,62 (2,00) | 20 | 42 | 174 | 160 | 90 | 30 | 30 | 2,29 |
| Рт1-2,5 | 24,52 (2,50) | 22 | 50 | 192 | 175 | 100 | 32 | 32 | 3,00 |
| Рт1-3,2 | 31,40 (3,20) | 25 | 55 | 200 | 185 | 100 | 35 | 35 | 4,12 |
| Рт1-4,0 | 39,24 (4,00) | 28 | 60 | 228 | 215 | 128 | 40 | 40 | 5,76 |
| Рт1-5,0 | 49,05 (5,00) | 32 | 68 | 260 | 240 | 142 | 45 | 45 | 8,50 |
| Рт1-6,3 | 61,80 (6,30) | 35 | 74 | 289 | 265 | 160 | 50 | 50 | 11,00 |
| Рт1-8,0 | 78,50 (8,00) | 40 | 82 | 322 | 295 | 185 | 55 | 55 | 15,48 |
| Рт1-10,0 | 98,10 (10,00) | 45 | 90 | 355 | 325 | 195 | 60 | 60 | 22,40 |
| Рт1-12,5 | 122,00 (12,50) | 50 | 100 | 390 | 360 | 215 | 65 | 65 | 30,00 |
| Рт1-16,0 | 157,00 (16,00) | 55 | 110 | 425 | 395 | 235 | 75 | 75 | 41,10 |

ЗВЕНО ИСПОЛНЕНИЕ Ов2 по ГОСТ 25573-82

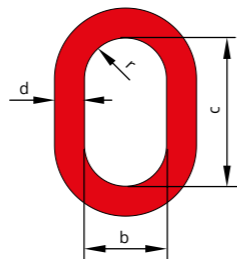

| Обозначение звена | Допускаемая нагрузка, кН (тс) | d | b | c | r | Вес штуки, кг |
|-------------------|-------------------------------|----|-----|-----|-----|---------------|
| | | мм | | | | |
| Ов2-0,63 | 6,18 (0,63) | 16 | 70 | 120 | 35 | 0,584 |
| Ов2-0,8 | 7,85 (0,80) | 18 | 90 | 150 | 45 | 0,916 |
| Ов2-1,0 | 9,81 (1,00) | 20 | | | | 1,146 |
| Ов2-1,25 | 12,26 (1,25) | 22 | 120 | 180 | 60 | 1,408 |
| Ов2-1,6 | 15,70 (1,60) | 25 | | | | 2,226 |
| Ов2-2,0 | 19,62 (2,00) | 28 | 150 | 230 | 75 | 2,827 |
| Ов2-2,5 | 24,52 (2,50) | 32 | | | | 3,769 |
| Ов2-3,2 | 31,40 (3,20) | 36 | 220 | 350 | 110 | 5,944 |
| Ов2-4,0 | 39,24 (4,00) | 40 | | | | 7,468 |
| Ов2-5,0 | 49,05 (5,00) | 42 | 350 | 500 | 150 | 8,298 |
| Ов2-6,3 | 61,80 (6,30) | 45 | | | | 12,145 |
| Ов2-8,0 | 78,50 (8,00) | 50 | 500 | 700 | 200 | 21,796 |
| Ов2-10,0 | 98,10 (10,00) | 56 | | | | 21,796 |

ЗВЕНО ИСПОЛНЕНИЯ Рт3 по ГОСТ 25573-82

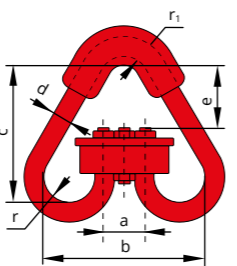

| Обозначение звена | Допускаемая нагрузка, кН (тс) | d | a | b | c | e | r | r ₁ | Вес штуки, кг |
|-------------------|-------------------------------|----|-----|-----|-----|-----|-----|----------------|---------------|
| | | мм | | | | | | | |
| Рт3-2,0 | 19,62 (2,0) | 16 | 38 | 142 | 150 | 90 | 30 | 30 | 1,45 |
| Рт3-2,5 | 24,52 (2,5) | 18 | 46 | 164 | 165 | 98 | 32 | 32 | 1,93 |
| Рт3-3,2 | 31,40 (3,2) | 20 | 50 | 182 | 180 | 110 | 35 | 35 | 2,50 |
| Рт3-4,0 | 39,24 (4,0) | 22 | 54 | 196 | 205 | 125 | 40 | 40 | 3,64 |
| Рт3-5,0 | 49,05 (5,0) | 25 | 60 | 205 | 225 | 142 | 45 | 45 | 4,98 |
| Рт3-6,3 | 61,80 (6,3) | 28 | 68 | 236 | 250 | 160 | 50 | 50 | 6,70 |
| Рт3-8,0 | 78,50 (8,0) | 32 | 74 | 266 | 280 | 185 | 55 | 55 | 9,62 |
| Рт3-10,0 | 98,10 (10,0) | 36 | 80 | 296 | 300 | 190 | 60 | 60 | 13,70 |
| Рт3-12,5 | 122,00 (12,5) | 40 | 90 | 330 | 340 | 215 | 65 | 65 | 18,80 |
| Рт3-25,0 | 245,25 (25,0) | 56 | 125 | 461 | 425 | 250 | 120 | 120 | 51,60 |

КРЮК С ПРОУШИНОЙ И ПЛАСТИНЧАТЫМ ЗАМКМ ТИПА S 320A

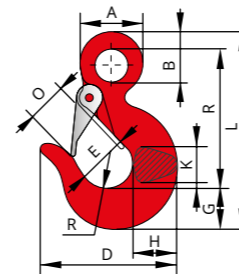

| Г/п, тн | A | B | D | E | G | H | K | L | R | T | O | Вес штуки, кг |
|---------|-------|------|-------|-------|-------|-------|------|-------|-------|------|------|---------------|
| | мм | | | | | | | | | | | |
| 0,75 | 32,0 | 16,0 | 64,0 | 23,0 | 19,0 | 20,0 | 13,0 | 97,0 | 70,0 | 16,0 | 19,0 | 0,16 |
| 1,00 | 38,0 | 19,0 | 75,0 | 25,0 | 20,0 | 21,0 | 14,0 | 110,0 | 82,0 | 21,0 | 23,0 | 0,25 |
| 1,50 | 44,5 | 23,0 | 81,0 | 26,0 | 21,0 | 24,0 | 16,0 | 125,5 | 93,0 | 20,5 | 24,5 | 0,34 |
| 2,00 | 51,5 | 28,5 | 92,0 | 27,0 | 25,5 | 29,5 | 19,0 | 141,0 | 104,0 | 21,5 | 25,5 | 0,56 |
| 3,00 | 61,0 | 32,0 | 104,0 | 31,0 | 28,5 | 33,0 | 21,5 | 162,5 | 119,0 | 30,0 | 28,5 | 0,75 |
| 5,00 | 74,5 | 39,5 | 125,5 | 38,0 | 36,5 | 41,0 | 28,5 | 201,0 | 146,0 | 35,0 | 34,0 | 1,60 |
| 7,00 | 97,0 | 51,0 | 165,0 | 47,5 | 46,0 | 52,0 | 35,0 | 256,0 | 187,5 | 45,0 | 43,0 | 3,20 |
| 11,00 | 119,0 | 62,0 | 192,0 | 57,0 | 57,0 | 66,5 | 41,0 | 316,0 | 230,0 | 54,0 | 52,0 | 5,80 |
| 15,00 | 136,5 | 72,0 | 210,0 | 63,5 | 66,0 | 74,5 | 55,5 | 354,0 | 256,0 | 66,5 | 57,5 | 9,80 |
| 22,00 | 160,0 | 85,0 | 240,0 | 85,0 | 80,0 | 85,0 | 69,0 | 435,0 | 320,0 | 80,0 | 75,0 | 17,50 |
| 30,00 | 180,0 | 90,0 | 335,0 | 110,0 | 100,0 | 118,0 | 78,0 | 495,0 | 355,0 | 97,0 | 88,0 | 26,50 |

КРЮК ИСПОЛНЕНИЯ К ХЛ по ГОСТ 25573-82

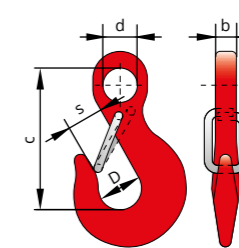

| Обозначение крюка | Допускаемая нагрузка, кН (тс) | D | d | c | s | b | Вес штуки, кг |
|-------------------|-------------------------------|-----|----|-------|----|----|---------------|
| | | мм | | | | | |
| К-1,0ХЛ | 9,81 (1,00) | 32 | 26 | 104,0 | 24 | 12 | 0,46 |
| К-1,25ХЛ | 12,26 (1,25) | 36 | 30 | 113,0 | 28 | 15 | 0,61 |
| К-1,6ХЛ | 15,70 (1,60) | 40 | 35 | 125,0 | 30 | 16 | 0,81 |
| К-2,0ХЛ | 19,62 (2,00) | 45 | 35 | 140,0 | 36 | 18 | 1,11 |
| К-2,5ХЛ | 24,52 (2,50) | 50 | 38 | 154,0 | 38 | 20 | 1,42 |
| К-3,2ХЛ | 31,40 (3,20) | 55 | 42 | 168,5 | 40 | 24 | 1,72 |
| К-4,0ХЛ | 39,24 (4,00) | 60 | 44 | 177,0 | 45 | 30 | 2,42 |
| К-5,0ХЛ | 49,05 (5,00) | 65 | 48 | 196,5 | 50 | 30 | 3,53 |
| К-6,3ХЛ | 61,80 (6,30) | 75 | 50 | 217,5 | 58 | 36 | 5,03 |
| К-8,0ХЛ | 78,50 (8,00) | 85 | 60 | 252,5 | 65 | 42 | 7,45 |
| К-10,0ХЛ | 98,10 (10,00) | 95 | 70 | 287,5 | 75 | 44 | 10,86 |
| К-12,5ХЛ | 122,60 (12,50) | 110 | 80 | 330,0 | 85 | 46 | 14,57 |

КОУШИ по ГОСТ 2224-93 ДЛЯ СТАЛЬНЫХ КАНАТОВ

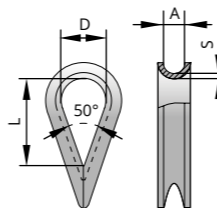

| Типо-размер | Диаметр каната, мм | A | L | D | S | Вес 100 шт, кг |
|-------------|--------------------|-----|-----|------|------|----------------|
| | | мм | | | | |
| 30 | 7,0-8,6 | 30 | 50 | 5,0 | 2,0 | 5,8 |
| 34 | 8,6-10,2 | 34 | 56 | 6,0 | 3,0 | 11,0 |
| 40 | 10,2-12,5 | 40 | 65 | 7,0 | | 15,0 |
| 45 | 12,5-15,5 | 45 | 74 | 9,0 | 4,0 | 20,0 |
| 56 | 15,5-18,5 | 56 | 92 | 10,0 | | 40,0 |
| 63 | 18,5-22,0 | 63 | 104 | 12,0 | 5,0 | 55,0 |
| 75 | 22,0-25,5 | 75 | 125 | 14,0 | | 97,0 |
| 85 | 25,5-30,0 | 85 | 142 | 16,0 | 6,0 | 132,0 |
| 95 | 30,0-34,5 | 95 | 158 | 19,0 | | 185,0 |
| 105 | 34,5-39,5 | 105 | 175 | 22,0 | 8,0 | 230,0 |
| 120 | 39,5-44,5 | 120 | 202 | 24,0 | | 400,0 |
| 130 | 44,5-49,5 | 130 | 217 | 27,0 | 10,0 | 470,0 |
| 140 | 49,5-54,5 | 140 | 234 | 30,0 | | 715,0 |

КОУШИ ТИП ВФ по DIN 6899 ДЛЯ СТАЛЬНЫХ КАНАТОВ

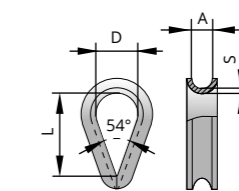

| Типо-размер | Диаметр каната, мм | A | L | D | S | Вес 100 шт, кг |
|-------------|--------------------|----|-----|-----|-------|----------------|
| | | мм | | | | |
| KOU 6,0 | 6 | 7 | 28 | 18 | 2,2 | 1,9 |
| KOU 7,0 | 7 | 8 | 32 | 20 | 2,7 | 3,0 |
| KOU 9,0 | 8-9 | 10 | 38 | 24 | 2,9 | 4,7 |
| KOU 11,0 | 10-11 | 12 | 45 | 28 | 3,2 | 5,3 |
| KOU 12,0 | 11-12 | 13 | 48 | 30 | | 6,8 |
| KOU 13,0 | 12-13 | 14 | 51 | 32 | 3,5 | 10,0 |
| KOU 15,0 | 14-15 | 16 | 58 | 36 | 3,8 | 13,5 |
| KOU 16,0 | 15-16 | 18 | 64 | 40 | | 14,5 |
| KOU 18,0 | 17-18 | 20 | 72 | 45 | 4,2 | 19,0 |
| KOU 20,0 | 19-20 | 22 | 80 | 50 | 5,2 | 29,0 |
| KOU 22,0 | 21-22 | 24 | 90 | 56 | | 32,0 |
| KOU 24,0 | 23-24 | 26 | 99 | 62 | 6,2 | 50,0 |
| KOU 26,0 | 25-27 | 28 | 112 | 70 | 6,5 | 59,0 |
| KOU 28,0 | 27-28 | 30 | 120 | 75 | 7,3 | 82,0 |
| KOU 30,0 | 29-31 | 32 | 128 | 80 | 8,0 | 100,0 |
| KOU 32,0 | 31-32 | 34 | 152 | 95 | | 130,0 |
| KOU 34,0 | 33-34 | 36 | 160 | 100 | 160,0 | |
| KOU 36,0 | 35-36 | 38 | 176 | 110 | 170,0 | |
| KOU 38,0 | 37-38 | 40 | 184 | 115 | 8,5 | 180,0 |
| KOU 40,0 | 39-40 | 42 | 192 | 120 | 10,5 | 275,0 |