

# Deep Groove Ball Bearings

## Single row deep groove ball bearings

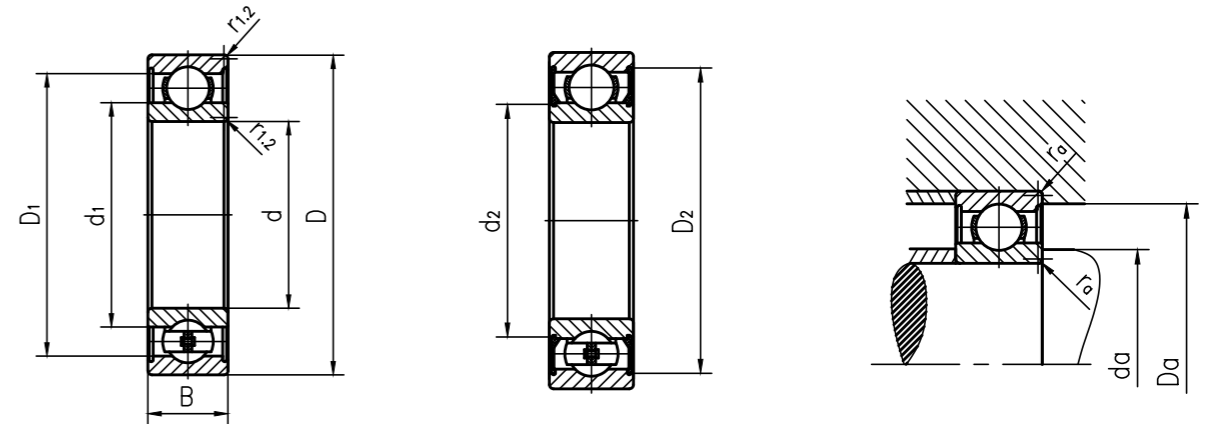

Type Bearing both sides of open or closed seal	One side closed seal	Main dimensions			Dimensions					Shoulder and chamfer dimensions			
		d	D	B	$d_1$ ≈	$d_2$ ≈	$D_1$ ≈	$D_2$ ≈	$r_{1,2}$ Min.	$d_a$ Min.	$d_a$ Max.	$D_a$ Max.	$r_a$ Max.
-	-	mm			mm					mm			
6210-2RZ	6210-RZ	50	90	20	62.5	-	-	81.7	1.1	57	62	83	1
62210-2RS1	-	50	90	23	62.5	-	-	81.7	1.1	57	62	83	1
6310 M	-	50	110	27	68.7	-	-	95.2	2	61	-	99	2
6310-2RSH	6310-RSH	50	110	27	-	64.7	-	95.9	2	61	64	99	2
6310	-	50	110	27	68.7	-	-	95.2	2	61	-	99	2
6310-2Z	6310-Z	50	110	27	68.7	-	-	95.2	2	61	68	99	2
62310-2RS1	-	50	110	40	68.7	-	-	95.2	2	61	68	99	2
6410	-	50	130	31	75.4	-	105	-	2.1	64	-	116	2
61811-2RS1	-	55	72	9	60.3	-	-	68.6	0.3	57	60	70	0.3
61811-2RZ	-	55	72	9	60.3	-	-	68.6	0.3	57	60	70	0.3
61811	-	55	72	9	60.3	-	67	-	0.3	57	-	70	0.3
61911-2RS1	-	55	80	13	63	-	-	74.2	1	60	63	75	1
61911-2RZ	-	55	80	13	63	-	-	74.2	1	60	63	75	1
61911	-	55	80	13	63	-	72.3	-	1	60	-	75	1
16011	-	55	90	11	67	-	78.1	-	0.6	59	-	86	0.6
6011 M	-	55	90	18	66.3	-	-	81.5	1.1	61	-	84	1
6011	-	55	90	18	66.3	-	-	81.5	1.1	61	-	84	1
6011-2RS1	6011-RS1	55	90	18	66.3	-	-	81.5	1.1	61	66	84	1
6011-2Z	6011-Z	55	90	18	66.3	-	-	81.5	1.1	61	66	84	1
6211	-	55	100	21	69	-	-	89.4	1.5	64	-	91	1.5
6211 M	-	55	100	21	69	-	-	89.4	1.5	64	-	91	1.5
6211-2RSH	6211-RSH	55	100	21	-	65.2	-	90.5	1.5	64	64	91	1.5
6211-2Z	6211-Z	55	100	21	69	-	-	89.4	1.5	64	69	91	1.5
62211-2RS1	-	55	100	25	69	-	-	89.4	1.5	64	69	91	1.5
6311	-	55	120	29	75.3	-	-	104	2	66	-	109	2
6311 M	-	55	120	29	75.3	-	-	104	2	66	-	109	2
6311-2RSH	6311-RSH	55	120	29	-	71.1	-	105	2	66	70	109	2
6311-2Z	6311-Z	55	120	29	75.3	-	-	104	2	66	75	109	2
62311-2RS1	-	55	120	43	75.3	-	-	104	2	66	75	109	2
6411	-	55	140	33	81.5	-	114	-	2.1	69	-	126	2
61812-2RS1	-	60	78	10	65.4	-	-	74.5	0.3	62	65	76	0.3
61812-2RZ	-	60	78	10	65.4	-	-	74.5	0.3	62	65	76	0.3
61812	-	60	78	10	65.4	-	72.9	-	0.3	62	-	76	0.3
61912-2RS1	-	60	85	13	68.3	-	-	78.7	1	65	68	80	1

Type Bearing both sides of open or closed seal	One side closed seal	Weight	Basic load rating		Fatigue load limit	Rated speed reference speed	Maximum speed	Calculate the coefficient	
			Dynamic	Static				$K_r$	$f_o$
-	-	kg	kN		$P_u$	r/min	-	-	-
6210-2RZ	6210-RZ	0.48	38.96	24.36	1.03	15750	8400	0.025	14
62210-2RS1	-	0.54	36.86	24.36	1.03	-	5040	0.025	14
6310 M	-	1.3	68.25	39.90	1.68	13650	8925	0.03	13
6310-2RSH	6310-RSH	1.1	68.25	39.90	1.68	-	4515	0.03	13
6310	-	1.1	68.25	39.90	1.68	13650	8925	0.03	13
6310-2Z	6310-Z	1.1	68.25	39.90	1.68	13650	7035	0.03	13
62310-2RS1	-	1.6	64.89	39.90	1.68	-	4515	0.03	13
6410	-	1.95	91.46	54.60	2.31	12600	7875	0.035	12
61811-2RS1	-	0.083	9.49	9.24	0.39	-	5565	0.015	17
61811-2RZ	-	0.083	9.49	9.24	0.39	19950	9975	0.015	17
61811	-	0.083	9.49	9.24	0.39	19950	12600	0.015	17
61911-2RS1	-	0.19	17.33	14.70	0.63	-	5250	0.02	16
61911-2RZ	-	0.19	17.33	14.70	0.63	17850	8925	0.02	16
61911	-	0.19	17.33	14.70	0.63	17850	11550	0.02	16
16011	-	0.26	21.32	14.70	0.73	16800	10500	0.02	14
6011 M	-	0.44	31.08	22.26	0.95	16800	14700	0.025	15
6011	-	0.38	31.08	22.26	0.95	16800	10500	0.025	15
6011-2RS1	6011-RS1	0.4	31.08	22.26	0.95	-	4725	0.025	15
6011-2Z	6011-Z	0.4	31.08	22.26	0.95	16800	8400	0.025	15
6211	-	0.61	48.51	30.45	1.31	14700	9450	0.025	14
6211 M	-	0.72	48.51	30.45	1.31	14700	13650	0.025	14
6211-2RSH	6211-RSH	0.62	48.51	30.45	1.31	-	4515	0.025	14
6211-2Z	6211-Z	0.64	48.51	30.45	1.31	14700	7350	0.025	14
62211-2RS1	-	0.75	45.78	30.45	1.31	-	4515	0.025	14
6311	-	1.35	77.81	47.25	2.00	12600	8400	0.03	13
6311 M	-	1.65	77.81	47.25	2.00	12600	11550	0.03	13
6311-2RSH	6311-RSH	1.4	77.81	47.25	2.00	-	3990	0.03	13
6311-2Z	6311-Z	1.4	77.81	47.25	2.00	12600	6615	0.03	13
62311-2RS1	-	2.05	75.08	47.25	2.00	-	3990	0.03	13
6411	-	2.35	104.48	65.10	2.73	11550	7350	0.035	12
61812-2RS1	-	0.11	12.50	11.97	0.51	-	5040	0.015	17
61812-2RZ	-	0.11	12.50	11.97	0.51	17850	8925	0.015	17
61812	-	0.11	12.50	11.97	0.51	17850	11550	0.015	17
61912-2RS1	-	0.21	17.33	12.60	0.63	-	4725	0.02	14

# Deep Groove Ball Bearings

## Single row deep groove ball bearings

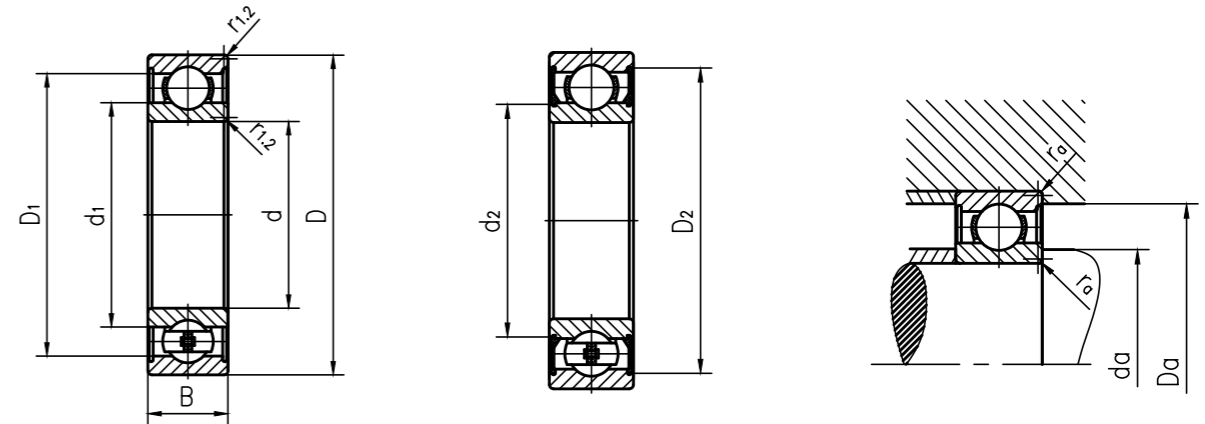

Type Bearing both sides of open or closed seal	One side closed seal	Main dimensions			Dimensions					Shoulder and chamfer dimensions			
		d	D	B	$d_1$ ≈	$d_2$ ≈	$D_1$ ≈	$D_2$ ≈	$r_{1,2}$ Min.	$d_a$ Min.	$d_a$ Max.	$D_a$ Max.	$r_a$ Max.
-	-	mm			mm					mm			
61912	-	60	85	13	68.3	-	-	78.7	1	65	-	80	1
61912-2RZ	-	60	85	13	68.3	-	-	78.7	1	65	68	80	1
16012	-	60	95	11	72	-	83	-	0.6	64	-	91	0.6
6012	-	60	95	18	71.3	-	-	86.5	1.1	66	-	89	1
6012-2RS1	6012-RS1	60	95	18	71.3	-	-	86.5	1.1	66	71	89	1
6012-2RZ	6012-RZ	60	95	18	71.3	-	-	86.5	1.1	66	71	89	1
6012-2Z	6012-Z	60	95	18	71.3	-	-	86.5	1.1	66	71	89	1
6212	-	60	110	22	75.5	-	-	98	1.5	69	-	101	1.5
6212 M	-	60	110	22	75.5	-	-	98	1.5	69	-	101	1.5
6212-2RSH	6212-RSH	60	110	22	-	71.5	-	99.5	1.5	69	71	101	1.5
6212-2Z	6212-Z	60	110	22	75.5	-	-	98	1.5	69	75	101	1.5
62212-2RS1	-	60	110	28	75.5	-	-	98	1.5	69	75	101	1.5
6312 M	-	60	130	31	81.8	-	-	113	2.1	72	-	118	2
6312-2RSH	6312-RSH	60	130	31	-	77.5	-	113	2.1	72	77	118	2
6312-2Z	6312-Z	60	130	31	81.8	-	-	113	2.1	72	81	118	2
6312	-	60	130	31	81.8	-	-	113	2.1	72	-	118	2
62312-2RS1	-	60	130	46	81.8	-	-	113	2.1	72	81	118	2
6412	-	60	150	35	88.1	-	122	-	2.1	74	-	136	2
61813-2RS1	-	65	85	10	71.4	-	-	80.5	0.6	69	71	81	0.6
61813-2RZ	-	65	85	10	71.4	-	-	80.5	0.6	69	71	81	0.6
61813	-	65	85	10	71.4	-	78.9	-	0.6	69	-	81	0.6
61913-2RS1	-	65	90	13	73	-	-	84.2	1	70	73	85	1
61913-2RZ	-	65	90	13	73	-	-	84.2	1	70	73	85	1
61913	-	65	90	13	73	-	82.3	-	1	70	-	85	1
16013	-	65	100	11	76.5	-	88.4	-	0.6	69	-	96	0.6
6013	-	65	100	18	76.3	-	-	91.5	1.1	71	-	94	1
6013 M	-	65	100	18	76.3	-	-	91.5	1.1	71	-	94	1
6013-2RS1	6013-RS1	65	100	18	76.3	-	-	91.5	1.1	71	76	94	1
6013-2Z	6013-Z	65	100	18	76.3	-	-	91.5	1.1	71	76	94	1
6213 M	-	65	120	23	83.3	-	-	106	1.5	74	-	111	1.5
6213	-	65	120	23	83.3	-	-	106	1.5	74	-	111	1.5
6213-2RS1	6213-RS1	65	120	23	83.3	-	-	106	1.5	74	83	111	1.5
6213-2Z	6213-Z	65	120	23	83.3	-	-	106	1.5	74	83	111	1.5
62213-2RS1	-	65	120	31	83.3	-	-	106	1.5	74	83	111	1.5

Type Bearing both sides of open or closed seal	One side closed seal	Weight kg	Basic load rating kN		Fatigue load limit $P_u$	Rated speed reference speed r/min	Maximum speed	Calculate the coefficient	
			Dynamic C	Static $C_0$				$K_r$	$f_0$
-	-	kg	kN			r/min		-	
61912	-	0.2	17.33	12.60	0.63	16800	10500	0.02	14
61912-2RZ	-	0.2	17.33	15.02	0.63	16800	8400	0.02	16
16012	-	0.29	21.84	15.75	0.77	15750	9975	0.02	14
6012	-	0.41	32.24	24.36	1.03	15750	9975	0.025	16
6012-2RS1	6012-RS1	0.43	32.24	24.36	1.03	-	4515	0.025	16
6012-2RZ	6012-RZ	0.43	32.24	24.36	1.03	15750	7875	0.025	16
6012-2Z	6012-Z	0.43	32.24	24.36	1.03	15750	7875	0.025	16
6212	-	0.78	58.07	37.80	1.61	13650	8400	0.025	14
6212 M	-	0.93	58.07	37.80	1.61	13650	8400	0.025	14
6212-2RSH	6212-RSH	0.79	58.07	37.80	1.61	-	4200	0.025	14
6212-2Z	6212-Z	0.81	58.07	37.80	1.61	13650	6615	0.025	14
62212-2RS1	-	1	55.34	37.80	1.61	-	4200	0.025	14
6312 M	-	2.1	89.46	54.60	2.31	11550	7350	0.03	13
6312-2RSH	6312-RSH	1.75	89.46	54.60	2.31	-	3570	0.03	13
6312-2Z	6312-Z	1.8	89.46	54.60	2.31	11550	5880	0.03	13
6312	-	1.7	89.46	54.60	2.31	11550	7350	0.03	13
62312-2RS1	-	2.55	86.00	54.60	2.31	-	3570	0.03	13
6412	-	2.85	113.40	72.98	3.05	10500	6615	0.035	12
61813-2RS1	-	0.13	13.02	13.34	0.57	-	4725	0.015	17
61813-2RZ	-	0.13	13.02	13.34	0.57	16800	8400	0.015	17
61813	-	0.13	13.02	13.34	0.57	16800	10500	0.015	17
61913-2RS1	-	0.22	18.27	16.80	0.71	-	4515	0.02	17
61913-2RZ	-	0.22	18.27	16.80	0.71	15750	7875	0.02	17
61913	-	0.22	18.27	16.80	0.71	15750	9975	0.02	17
16013	-	0.3	23.63	20.58	0.87	14700	9450	0.02	16
6013	-	0.44	33.50	26.25	1.11	14700	9450	0.025	16
6013 M	-	0.44	33.50	26.25	1.11	14700	12600	0.025	16
6013-2RS1	6013-RS1	0.45	33.50	26.25	1.11	-	4200	0.025	16
6013-2Z	6013-Z	0.46	33.50	26.25	1.11	14700	7350	0.025	16
6213 M	-	1.2	61.43	42.53	1.82	12600	10500	0.025	15
6213	-	1	61.43	42.53	1.82	12600	7875	0.025	15
6213-2RS1	6213-RS1	1.05	61.43	42.53	1.82	-	3780	0.025	15
6213-2Z	6213-Z	1.05	61.43	42.53	1.82	12600	6300	0.025	15
62213-2RS1	-	1.4	58.70	42.53	1.82	-	3780	0.025	15

# Deep Groove Ball Bearings

## Single row deep groove ball bearings

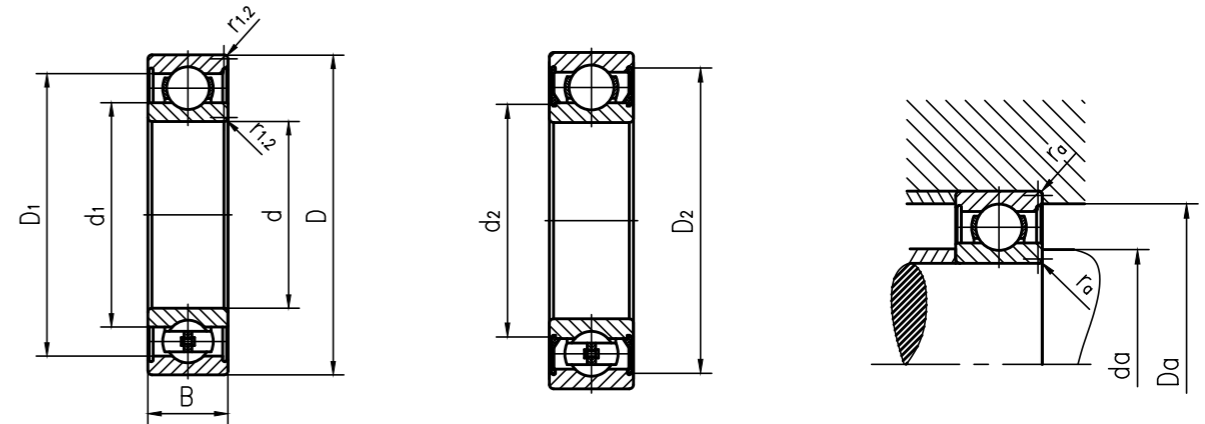

Type Bearing both sides of open or closed seal	One side closed seal	Main dimensions			Dimensions					Shoulder and chamfer dimensions			
		d	D	B	$d_1$ ≈	$d_2$ ≈	$D_1$ ≈	$D_2$ ≈	$r_{1,2}$ Min.	$d_a$ Min.	$d_a$ Max.	$D_a$ Max.	$r_a$ Max.
-	-	mm			mm					mm			
6313 M	-	65	140	33	88.3	-	-	122	2.1	77	-	128	2
6313	-	65	140	33	88.3	-	-	122	2.1	77	-	128	2
6313-2RS1	6313-RS1	65	140	33	88.3	-	-	122	2.1	77	88	128	2
6313-2Z	6313-Z	65	140	33	88.3	-	-	122	2.1	77	88	128	2
62313-2RS1	-	65	140	48	88.3	-	-	122	2.1	77	88	128	2
6413	-	65	160	37	94	-	131	-	2.1	79	-	146	2
61814-2RS1	-	70	90	10	76.4	-	-	85.5	0.6	74	76	86	0.6
61814-2RZ	-	70	90	10	76.4	-	-	85.5	0.6	74	76	86	0.6
61814	-	70	90	10	76.4	-	83.9	-	0.6	74	-	86	0.6
61914	-	70	100	16	79.8	-	-	92.9	1	75	-	95	1
61914-2RS1	-	70	100	16	79.8	-	-	92.9	1	75	79	95	1
61914-2RZ	-	70	100	16	79.8	-	-	92.9	1	75	79	95	1
16014	-	70	110	13	83.3	-	96.8	-	0.6	74	-	106	0.6
6014 M	-	70	110	20	82.8	-	-	99.9	1.1	76	-	104	1
6014	-	70	110	20	82.8	-	-	99.9	1.1	76	-	104	1
6014-2RS1	6014-RS1	70	110	20	82.8	-	-	99.9	1.1	76	82	104	1
6014-2Z	6014-Z	70	110	20	82.8	-	-	99.9	1.1	76	82	104	1
6214 M	-	70	125	24	87	-	-	111	1.5	79	-	116	1.5
6214	-	70	125	24	87	-	-	111	1.5	79	-	116	1.5
6214-2RS1	6214-RS1	70	125	24	87	-	-	111	1.5	79	87	116	1.5
6214-2Z	6214-Z	70	125	24	87	-	-	111	1.5	79	87	116	1.5
62214-2RS1	-	70	125	31	87	-	-	111	1.5	79	87	116	1.5
6314	-	70	150	35	94.9	-	-	130	2.1	82	-	138	2
6314M	-	70	150	35	94.9	-	-	130	2.1	82	-	138	2
6314-2RS1	6314-RS1	70	150	35	94.9	-	-	130	2.1	82	94	138	2
6314-2Z	6314-Z	70	150	35	94.9	-	-	130	2.1	82	94	138	2
62314-2RS1	-	70	150	51	94.9	-	-	130	2.1	82	94	138	2
6414	-	70	180	42	103	-	146	-	3	86	-	164	2.5
61815-2RS1	-	75	95	10	81.7	-	-	90.7	1.3	79	81	91	0.6
61815-2RZ	-	75	95	10	81.7	-	-	90.7	1.3	79	81	91	0.6
61815	-	75	95	10	81.7	-	-	90.7	1.3	79	-	91	0.6
61915	-	75	105	16	84.8	-	-	97.9	1.9	80	-	100	1
61915-2RS1	-	75	105	16	84.7	-	-	98.3	1	80	84	100	1
61915-2RZ	-	75	105	16	84.7	-	-	98.3	1	80	84	100	1

Type Bearing both sides of open or closed seal	One side closed seal	Weight	Basic load rating		Fatigue load limit	Rated speed reference speed	Maximum speed	Calculate the coefficient	
			Dynamic	Static				$K_r$	$f_o$
-	-	kg	kN		$P_u$	r/min	-		
6313 M	-	2.55	102.38	63.00	2.63	10500	7035	0.03	13
6313	-	2.1	102.38	63.00	2.63	10500	7035	0.03	13
6313-2RS1	6313-RS1	2.15	102.38	63.00	2.63	-	3360	0.03	13
6313-2Z	6313-Z	2.15	102.38	63.00	2.63	10500	5565	0.03	13
62313-2RS1	-	3	96.92	63.00	2.63	-	3360	0.03	13
6413	-	3.35	124.95	81.90	3.31	9975	6300	0.035	12
61814-2RS1	-	0.14	13.02	13.86	0.59	-	4515	0.015	17
61814-2RZ	-	0.14	13.02	13.86	0.59	15750	7875	0.015	17
61814	-	0.14	13.02	13.86	0.59	15750	9450	0.015	17
61914	-	0.34	24.99	19.22	0.95	14700	8925	0.02	14
61914-2RS1	-	0.35	24.99	22.26	0.95	-	4200	0.02	16
61914-2RZ	-	0.35	24.99	22.26	0.95	14700	7350	0.02	16
16014	-	0.44	30.56	26.25	1.11	13650	8400	0.02	16
6014 M	-	0.7	41.69	32.55	1.39	13650	11550	0.025	16
6014	-	0.61	41.69	32.55	1.39	13650	8400	0.025	16
6014-2RS1	6014-RS1	0.63	41.69	32.55	1.39	-	3780	0.025	16
6014-2Z	6014-Z	0.64	41.69	32.55	1.39	13650	6615	0.025	16
6214 M	-	1.3	63.53	47.25	2.00	11550	10500	0.025	15
6214	-	1.1	66.89	47.25	2.00	11550	7350	0.025	15
6214-2RS1	6214-RS1	1.1	66.89	47.25	2.00	-	3570	0.025	15
6214-2Z	6214-Z	1.15	66.89	47.25	2.00	11550	5880	0.025	15
62214-2RS1	-	1.4	63.53	47.25	2.00	-	3570	0.025	15
6314	-	2.55	116.55	71.40	2.89	9975	6615	0.03	13
6314M	-	3.1	116.55	71.40	2.89	9975	6615	0.03	13
6314-2RS1	6314-RS1	2.6	116.55	71.40	2.89	-	3150	0.03	13
6314-2Z	6314-Z	2.65	116.55	71.40	2.89	9975	5250	0.03	13
62314-2RS1	-	3.75	109.20	71.40	2.89	-	3150	0.03	13
6414	-	4.95	150.15	109.20	4.10	8925	5565	0.035	12
61815-2RS1	-	0.15	13.13	11.34	0.61	-	4200	0.015	13
61815-2RZ	-	0.15	13.13	11.34	0.61	14700	7350	0.015	13
61815	-	0.15	13.13	11.34	0.61	14700	8925	0.015	13
61915	-	0.36	25.41	20.27	1.01	13650	8400	0.02	14
61915-2RS1	-	0.37	25.41	23.52	1.01	-	3780	0.02	17
61915-2RZ	-	0.37	25.41	23.52	1.01	13650	6615	0.02	17

# Deep Groove Ball Bearings

## Single row deep groove ball bearings

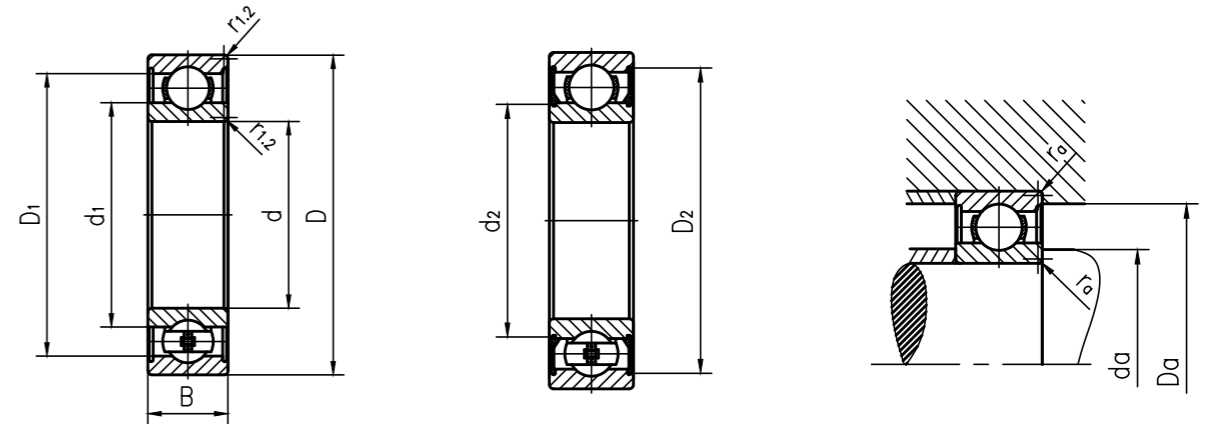

Type Bearing both sides of open or closed seal	One side closed seal	Main dimensions			Dimensions					Shoulder and chamfer dimensions			
		d	D	B	d <sub>1</sub> ≈	d <sub>2</sub> ≈	D <sub>1</sub> ≈	D <sub>2</sub> ≈	r <sub>1,2</sub> Min.	d <sub>a</sub> Min.	d <sub>a</sub> Max.	D <sub>a</sub> Max.	r <sub>a</sub> Max.
-	-	mm			mm					mm			
16015	-	75	115	13	88.3	-	102	-	0.6	79	-	111	0.6
6015 M	-	75	115	20	87.8	-	-	105	1.1	81	-	109	1
6015	-	75	115	20	87.8	-	-	105	1.1	81	-	109	1
6015-2RS1	6015-RS1	75	115	20	87.8	-	-	105	1.1	81	87	109	1
6015-2RZ	6015-RZ	75	115	20	87.8	-	-	105	1.1	81	87	109	1
6015-2Z	6015-Z	75	115	20	87.8	-	-	105	1.1	81	87	109	1
6215 M	-	75	130	25	92	-	-	117	1.5	84	-	121	1.5
6215	-	75	130	25	92	-	-	117	1.5	84	-	121	1.5
6215-2RS1	6215-RS1	75	130	25	92	-	-	117	1.5	84	92	121	1.5
6215-2Z	6215-Z	75	130	25	92	-	-	117	1.5	84	92	121	1.5
6315	-	75	160	37	101	-	-	139	2.1	87	-	148	2
6315 M	-	75	160	37	101	-	-	139	2.1	87	-	148	2
6315-2RS1	6315-RS1	75	160	37	101	-	-	139	2.1	87	100	148	2
6315-2Z	6315-Z	75	160	37	101	-	-	139	2.1	87	100	148	2
6415	-	75	190	45	110	-	-	155	3	91	-	174	2.5
61816-2RS1	-	80	100	10	86.7	-	-	95.7	1.3	84	86	96	0.6
61816	-	80	100	10	86.7	-	-	95.7	1.3	84	-	96	0.6
61916-2RS1	-	80	110	16	89.8	-	-	103	1	85	89	105	1
61916-2RZ	-	80	110	16	89.8	-	-	103	1	85	89	105	1
61916	-	80	110	16	89.8	-	-	103	1	85	-	105	1
16016	-	80	125	14	95.3	-	110	-	0.6	84	-	121	0.6
6016	-	80	125	22	94.4	-	-	115	1.1	86	-	119	1
6016-2RS1	6016-RS1	80	125	22	94.4	-	-	115	1.1	86	94	119	1
6016-2Z	6016-Z	80	125	22	94.4	-	-	115	1.1	86	94	119	1
6216	-	80	140	26	101	-	-	127	2	91	-	129	2
6216M	-	80	140	26	101	-	-	127	2	91	-	129	2
6216-2RS1	6216-RS1	80	140	26	101	-	-	127	2	91	100	129	2
6216-2Z	6216-Z	80	140	26	101	-	-	127	2	91	100	129	2
6316 M	-	80	170	39	108	-	-	147	2.1	92	-	158	2
6316	-	80	170	39	108	-	-	147	2.1	92	-	158	2
6316-2RS1	6316-RS1	80	170	39	108	-	-	147	2.1	92	107	158	2
6316-2Z	6316-Z	80	170	39	108	-	-	147	2.1	92	107	158	2
6416	-	80	200	48	116	-	163	-	3	96	-	184	2.5
61817-2RS1	-	85	110	13	93.3	-	-	105	1.9	90	93	105	1

Type Bearing both sides of open or closed seal	One side closed seal	Weight	Basic load rating		Fatigue load limit	Rated speed reference speed	Maximum speed	Calculate the coefficient	
			Dynamic	Static				K <sub>r</sub>	f <sub>0</sub>
-	-	kg	kN		P <sub>u</sub>	r/min	-		
16015	-	0.46	31.71	28.35	1.20	12600	7875	0.02	16
6015 M	-	0.74	43.68	35.18	1.50	12600	10500	0.025	16
6015	-	0.65	43.68	35.18	1.50	12600	7875	0.025	16
6015-2RS1	6015-RS1	0.67	43.68	35.18	1.50	-	3570	0.025	16
6015-2RZ	6015-RZ	0.67	43.68	35.18	1.50	12600	6300	0.025	16
6015-2Z	6015-Z	0.68	43.68	35.18	1.50	12600	6300	0.025	16
6215 M	-	1.4	72.35	51.45	2.14	10500	9975	0.025	15
6215	-	1.2	72.35	51.45	2.14	10500	7035	0.025	15
6215-2RS1	6215-RS1	1.2	72.35	51.45	2.14	-	3360	0.025	15
6215-2Z	6215-Z	1.25	72.35	51.45	2.14	10500	5565	0.025	15
6315	-	3.05	124.95	80.33	3.15	9450	5880	0.03	13
6315 M	-	3.7	124.95	80.33	3.15	9450	5880	0.03	13
6315-2RS1	6315-RS1	3.15	124.95	80.33	3.15	-	2940	0.03	13
6315-2Z	6315-Z	3.15	124.95	80.33	3.15	9450	4725	0.03	13
6415	-	5.8	160.65	119.70	4.36	8400	5250	0.035	12
61816-2RS1	-	0.16	13.34	11.76	0.64	-	3780	0.015	13
61816	-	0.15	13.34	11.76	0.64	13650	8400	0.015	13
61916-2RS1	-	0.4	26.36	21.42	1.07	-	3570	0.02	14
61916-2RZ	-	0.4	26.36	21.42	1.07	12600	6300	0.02	14
61916	-	0.38	26.36	21.42	1.07	12600	7875	0.02	14
16016	-	0.61	36.86	33.08	1.39	11550	7350	0.02	16
6016	-	0.86	51.87	42.00	1.74	11550	7350	0.025	16
6016-2RS1	6016-RS1	0.88	51.87	42.00	1.74	-	3360	0.025	16
6016-2Z	6016-Z	0.89	51.87	42.00	1.74	11550	5880	0.025	16
6216	-	1.45	76.44	57.75	2.31	9975	6300	0.025	15
6216M	-	1.7	76.44	57.75	2.31	9975	8925	0.025	15
6216-2RS1	6216-RS1	1.5	76.44	57.75	2.31	-	3150	0.025	15
6216-2Z	6216-Z	1.55	76.44	57.75	2.31	9975	5040	0.025	15
6316 M	-	4.4	136.50	90.83	3.41	8925	7875	0.03	13
6316	-	3.65	136.50	90.83	3.41	8925	5565	0.03	13
6316-2RS1	6316-RS1	3.7	136.50	90.83	3.41	-	2730	0.03	13
6316-2Z	6316-Z	3.75	136.50	90.83	3.41	8925	4515	0.03	13
6416	-	6.85	171.15	131.25	4.73	7875	5040	0.035	12
61817-2RS1	-	0.28	20.48	17.43	0.92	-	3570	0.015	14

# Deep Groove Ball Bearings

## Single row deep groove ball bearings

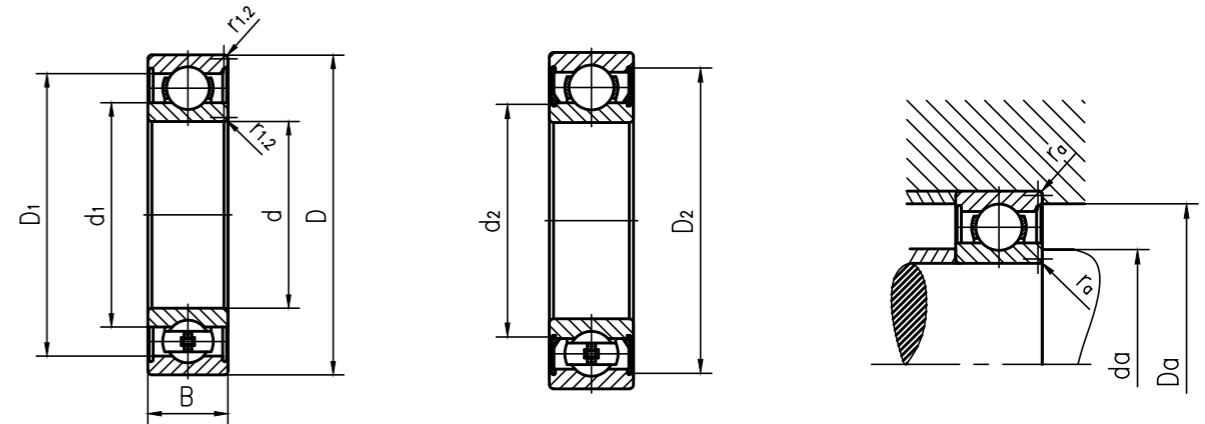

Type Bearing both sides of open or closed seal	One side closed seal	Main dimensions			Dimensions					Shoulder and chamfer dimensions			
		d	D	B	$d_1$	$d_2$	$D_1$	$D_2$	$r_{1,2}$	$d_a$	$d_a$	$D_a$	$r_a$
		mm			mm					mm			
-	-	85	110	13	93.3	-	-	105	1.9	90	93	105	1
61817-2RZ	-	85	110	13	93.3	-	-	105	1.9	90	-	105	1
61817	-	85	120	18	96.4	-	109	-	1.1	91	-	114	1
61917	-	85	130	14	100	-	115	-	0.6	89	-	126	0.6
16017	-	85	130	22	99.4	-	-	120	1.1	92	-	123	1
6017	-	85	130	22	99.4	-	-	120	1.1	92	-	123	1
6017-2RS1	6017-RS1	85	130	22	99.4	-	-	120	1.1	92	99	123	1
6017-2Z	6017-Z	85	130	22	99.4	-	-	120	1.1	92	99	123	1
6217 M	-	85	150	28	106	-	-	135	2	96	-	139	2
6217	-	85	150	28	106	-	-	135	2	96	-	139	2
6217-2RS1	6217-RS1	85	150	28	106	-	-	135	2	96	105	139	2
6217-2Z	6217-Z	85	150	28	106	-	-	135	2	96	105	139	2
6317	-	85	180	41	114	-	-	156	3	99	-	166	2.5
6317 M	-	85	180	41	114	-	-	156	3	99	-	166	2.5
6317-2RS1	6317-RS1	85	180	41	114	-	-	156	3	99	114	166	2.5
6317-2Z	6317-Z	85	180	41	114	-	-	156	3	99	114	166	2.5
6417	-	85	210	52	123	-	172	-	4	105	-	190	3
61818-2RS1	-	90	115	13	98.3	-	-	110	1	95	98	110	1
61818-2RZ	-	90	115	13	98.3	-	-	110	1	95	98	110	1
61818	-	90	115	13	98.3	-	-	110	1	95	-	110	1
61918	-	90	125	18	101	-	114	-	1.1	96	-	119	1
16018	-	90	140	16	106	-	124	-	1	95	-	135	1
6018 M	-	90	140	24	105	-	-	129	1.5	97	-	133	1.5
6018	-	90	140	24	105	-	-	129	1.5	97	-	133	1.5
6018-2RS1	6018-RS1	90	140	24	105	-	-	129	1.5	97	105	133	1.5
6018-2Z	6018-Z	90	140	24	105	-	-	129	1.5	97	105	133	1.5
6218	-	90	160	30	112	-	-	143	2	101	-	149	2
6218 M	-	90	160	30	112	-	-	143	2	101	-	149	2
6218-2RS1	6218-RS1	90	160	30	112	-	-	143	2	101	112	149	2
6218-2Z	6218-Z	90	160	30	112	-	-	143	2	101	112	149	2
6318 M	-	90	190	43	121	-	-	164	3	104	-	176	2.5
6318	-	90	190	43	121	-	-	164	3	104	-	176	2.5
6318-2RS1	6318-RS1	90	190	43	121	-	-	164	3	104	120	176	2.5
6318-2Z	6318-Z	90	190	43	121	-	-	164	3	104	120	176	2.5
6418	-	90	225	54	132	-	181	-	4	110	-	205	3

Type Bearing both sides of open or closed seal	One side closed seal	Weight	Basic load rating		Fatigue load limit	Rated speed reference speed	Maximum speed	Calculate the coefficient	
			Dynamic	Static				$K_r$	$f_o$
		kg	kN		$P_u$	r/min			
-	-	0.28	20.48	17.43	0.92	12600	6300	0.015	14
61817-2RZ	-	0.28	20.48	17.43	0.92	12600	6300	0.015	14
61817	-	0.26	20.48	17.43	0.92	12600	7875	0.015	14
61917	-	0.55	33.50	31.50	1.31	11550	7350	0.02	16
16017	-	0.64	37.59	35.18	1.44	11550	7035	0.02	17
6017	-	0.9	54.60	45.15	1.85	11550	7035	0.025	16
6017-2RS1	6017-RS1	0.93	54.60	45.15	1.85	-	3150	0.025	16
6017-2Z	6017-Z	0.94	54.60	45.15	1.85	11550	5565	0.025	16
6217 M	-	2	91.46	67.20	2.63	9450	8400	0.025	15
6217	-	1.8	91.46	67.20	2.63	9450	5880	0.025	15
6217-2RS1	6217-RS1	1.9	91.46	67.20	2.63	-	2940	0.025	15
6217-2Z	6217-Z	1.9	91.46	67.20	2.63	9450	4725	0.025	15
6317	-	4.25	147.00	101.33	3.73	8400	5250	0.03	13
6317 M	-	5.2	147.00	101.33	3.73	8400	7875	0.03	13
6317-2RS1	6317-RS1	4.35	147.00	101.33	3.73	-	2520	0.03	13
6317-2Z	6317-Z	4.4	147.00	101.33	3.73	8400	4200	0.03	13
6417	-	8.05	182.70	143.85	4.99	7350	4725	0.035	12
61818-2RS1	-	0.29	20.48	17.85	0.96	-	3360	0.015	13
61818-2RZ	-	0.29	20.48	17.85	0.96	11550	5880	0.015	13
61818	-	0.28	20.48	17.85	0.96	11550	7350	0.015	13
61918	-	0.59	34.86	33.08	1.35	11550	7035	0.02	17
16018	-	0.85	45.78	40.95	1.64	10500	6615	0.02	16
6018 M	-	1.35	63.53	52.50	2.06	10500	8925	0.025	16
6018	-	1.15	63.53	52.50	2.06	10500	6615	0.025	16
6018-2RS1	6018-RS1	1.2	63.53	52.50	2.06	-	2940	0.025	16
6018-2Z	6018-Z	1.2	63.53	52.50	2.06	10500	5250	0.025	16
6218	-	2.2	106.05	77.18	2.94	8925	5565	0.025	15
6218 M	-	2.65	106.05	77.18	2.94	8925	5565	0.025	15
6218-2RS1	6218-RS1	2.3	106.05	77.18	2.94	-	2730	0.025	15
6218-2Z	6218-Z	2.3	106.05	77.18	2.94	8925	4515	0.025	15
6318 M	-	6.1	158.55	113.40	3.99	7875	7350	0.03	13
6318	-	4.95	158.55	113.40	3.99	7875	5040	0.03	13
6318-2RS1	6318-RS1	5.1	158.55	113.40	3.99	-	2520	0.03	13
6318-2Z	6318-Z	5.15	158.55	113.40	3.99	7875	3990	0.03	13
6418	-	9.8	195.30	157.50	5.25	7035	4515	0.035	13