

Single-row Cylindrical Roller Bearing

d 25–35 mm

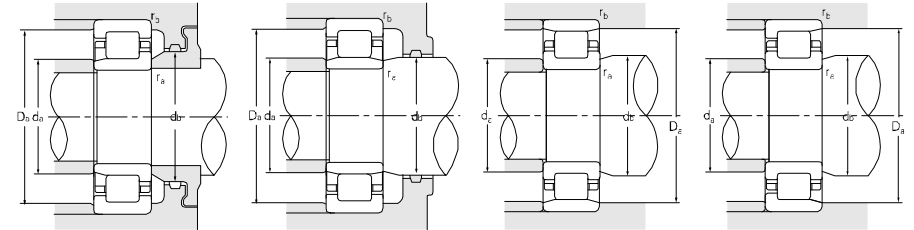
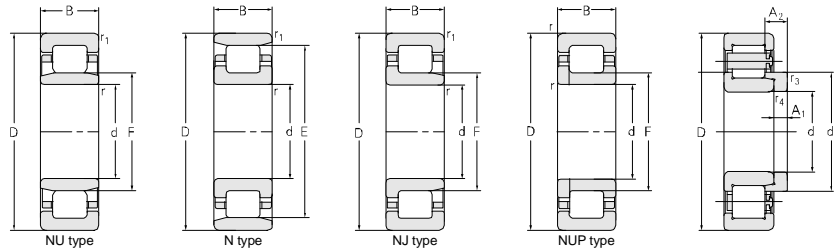

Principal dimensions						Basic load ratings		Limit speed ratings		Designations	
d	D	B	r _{1smin}	r _{smin}	F	E	C _r	C _{Or}	Grease		Oil
mm						kN		r/min			
25	52	15	1	0.6	31.5		28	26.5	11000	13500	NU205EM
	52	15	1	0.6	31.5		28	26.5	11000	13500	NJ205M
	52	15	1	0.6	31.5		28	26.5	11000	13500	NJ205ETN1
	52	15	1	0.6	31.5		28	26.5	11000	13500	NU205ETN1/C9
	52	18	1	1	31.5		33.5	33	11000	13500	NUP2205ETN1
	52	18	1	0.6	31.5		33.5	33	11000	13500	NJ2205EM/P49YB2
	62	17	1.1	1.1	34		45.5	36	9500	12000	NJ305M
	62	17	1.1	1.1	34		45.5	36	9500	12000	NJ305ETN1
	62	17	1.1	1.1	34		45.5	36	9500	12000	NUP305EM
	62	24	1.1	1.1	35		62	53	9500	12000	NJ2305M/HAP6
26	55	18	1	0.3	32		39	56	10500	13000	NU6/26NRTN1-DZ
30	55	13	1	0.6	36.5		20	23	12000	15000	NU1006M
	55	13	1	0.6	36.5		20	23	12000	15000	NU1006TN1
	62	16	1	0.6	37.5		42	35	9500	12000	NJ206EM
	62	16	1	0.6	37.5		42	35	9500	12000	NJ206ETN1
	62	16	1	0.6	37.5		42	35	9500	12000	NU206EM
	62	16	1	0.6	37.5		42	35	9500	12000	NU206ETN1/C9
	62	20	1	0.6	37.5		53	54	9500	12000	NJ2206EM
	62	20	1	0.6	37.5		53	54	9500	12000	NU2206ETN1
	62	20	1	0.6	37.5		53	54	9500	12000	NJ2206ETN1
	62	20	1	0.6	37.5		53	54	9500	12000	NU2206ETN1/C9
	70	18	1.1	0.6	40		57.2	55.0	9000	11000	NJ306X3WB/C9
	72	19	1.1	1.1	40.5		56	48	9000	11000	NJ306EM
	72	19	1.1	1.1	40.5		45	42.5	9000	11000	N306M
	72	19	1.1	1.1	40.5		56	48	9000	11000	NJ306ETN1
	72	19	1.1	1.1	40.5		56	48	9000	11000	NJ306ETN1/C3-FST
	72	23	1.1	1.1	40.5		53	50	9000	11000	NJ306X2EM-2RSL
	72	27	1.1	1.1	42		80	72	9000	11000	NUP2306M
	72	27	1.1	1.1	40.5		80	72	8000	95000	NU2306EM
72.046	23	1.1	1.1	40.5		63.5	63	9000	11000	NF306X3EM/YA6	
90	23	1.5	1.5	45		60	52	7500	9000	NJ406M	
35	62	14	1	0.6	42		34	36	9000	11000	NU1007M
	62	14	1	0.6	42		34	36	9000	11000	NU1007TN1

Abutment and fillet dimensions							Weight	Model	Weight	Separate thrust collar		
d _{amin}	d _{amax}	d _{bmin}	D _{amax}	D _{amin}	r _{amax}	r _{bmax}				A1	A2	r _{3,r4}
mm							kg	kg	mm			
29	30	36	47		1	0.7	0.159					
29	30	36	47		1	0.6	0.164					
29	30	36	47		1	0.6	0.134					
29	30	36	47		1	0.6	0.134					
30.6		36	46.4		1	1	0.171					
30.6		36	46.4		1	1	0.188					
31.5	32	40	55.5		1	1	0.267					
31.5	32	40	55.5		1	1	0.239					
31.5	40	55.5			1	1	0.28					
31.5	32	40	55.5		1	1	0.453					
29.5	30.5				1	0.3	0.212					
34	35	38	50		1	0.6	0.138					
34	35	38	50		1	0.6	0.119					
34	36	43	57		1	0.6	0.264					
34	36	43	57		1	0.6	0.203					
34	36	39	57		1	0.6	0.259					
					1	0.6	0.198					
					1	0.6	0.297					
					1	0.6	0.259					
34	36	43	57		1	0.6	0.265					
34	36	43	57		1	0.6	0.259					
35	38	45	63.5		1	1	0.342					
36.5	39	47	65.5		1	1	0.411					
36.5	39	47	65.5		1	1	0.403					
36.5	39	47	65.5		1	1	0.374					
36.5	39	47	65.5		1	1	0.369					
36.5	39	47	65.5		1	1	0.472					
36.5		47	65.5		1	1	0.585					
36.5		47	65.5		1	1	0.593					
36.5	39	47	65.5		1	1	0.502					
38	43	52	82		1.5	1.5	0.882					
38.2	41	44	56		1	0.6	0.173					
38.2	41	44	56		1	0.6	0.156					

Single-row Cylindrical Roller Bearing

d 35-40 mm

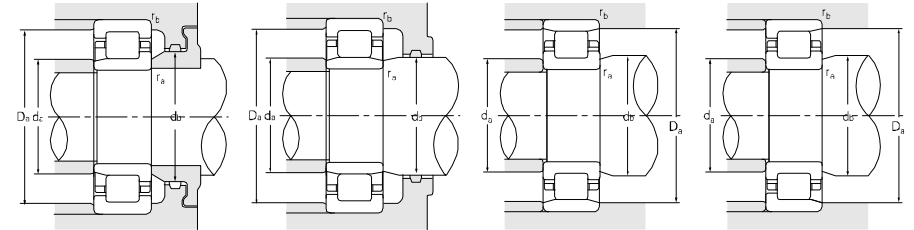
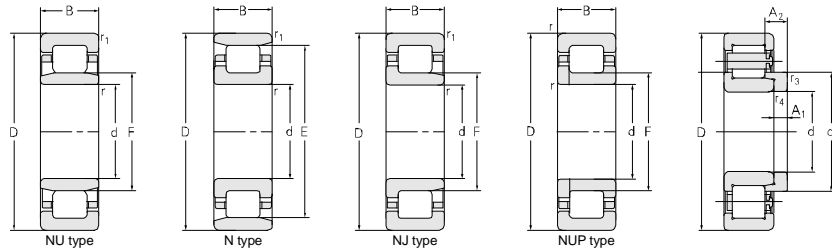

Principal dimensions						Basic load ratings		Limit speed ratings		Designations	
d	D	B	r _{1smin}	r _{smin}	F	E	C _r	C _{0r}	Grease		Oil
mm						kN		r/min			
35	72	17	0.6	1.1		64	54	46	8500	10000	N207EM
	72	17	1.1	0.6	44		54	46	8500	10000	NJ207EM
	72	17	1.1	0.6	44		54	46	8500	10000	NJ207ETN1
	72	17	1.1	0.6	44		54	46	8500	10000	NU207EM
	72	23	1.1	1.1	44		66.0	70	8500	10000	NJ2207EM
	72	23	1.1	1.1	44		66.0	70	8500	10000	NU2207EM
	72	23	1	0.6	44		66.0	70	8500	10000	NJ2207ETN1
	72	23	1	0.6	44		66	70	8500	10000	NJ2207EM/C9YA8
	72	23	1	0.6	44		66.0	70	8500	10000	NU2207ETN1/C9
	80	21	1.5	1.5		67.8	72	60	8000	9500	NCL307E/YA
	80	21	1.5	1.1	46.2		72	60	8000	9500	NJ307M
	80	21	1.5	1.5		70.2	72	60	8000	9500	N307M
	80	21	1.5	1.1	46.2		72	60	8000	9500	NJ307E
	80	21	1.5	1.1		70.2	72	60	8000	9500	NF307M
	80	21	1.5	1.1		70.2	72	60	8000	9500	NF307ETN1
	80	21	1.5	1.1	46.2		72	60	8000	9500	NU307M
	80	21	1.5	1.1	46.2		72	60	8000	9500	NU307ENRM
	80	21	1.5	1.1	46.2		72	60	8000	9500	NJ307ENRM
	80	21	1.5	1.1	46.2		72	60	8000	9500	NU307ETN1/C9
	80	21	1.5	1.5		70.2	72	60	8000	9500	NF307ETN1-FST
80	21	1.5	1.1	46.2		72	60	8000	9500	NU307EMA	
80	21	1.5	1.1	46.2		72	60	8000	9500	NU307E	
80	21	1.5	1.1	46.2		72	60	8000	9500	NU307EQ1	
80	31	1.5	1.5	46.2		87	75	7000	8500	NJ2307M	
80	31	1.5	1.5	46.2		102	94	7000	8500	NJ2307EM	
80	31	1.1	1.1	46.2		102	94	7000	8500	NU2307EM	
100	25	1.5	1.5	53		74	67	6700	8000	NJ407M	
38	83	25.4		1.1	48.5		73.5	74.5	7500	9000	NUP6/38X2NM
40	68	15	1	0.6	47		27	32	9500	12000	NU1008M
	68	15	1	0.6	47		27	32	9500	12000	NU1008TN1
	80	18	1.1	1.1	49.5		60	55.5	7500	9000	NJ208EM
	80	18	1.1	1.1	49.5		60	55.5	7500	9000	NJ208E
	80	18	1.1	1.1	49.5		60	55.5	7500	9000	NU208EM
	80	18	1.1	1.1	49.5		60	55.5	7500	9000	NUP208EM

Abutment and fillet dimensions							Weight	Model	Weight	Separate thrust collar		
d _{amin}	d _{amax}	d _{bmin}	D _{amax}	D _{amin}	r _{amax}	r _{bmax}				A1	A2	r _{3,4}
mm							kg	kg	mm			
41.5	62		68	66	1	0.6	0.331					
39	42	50	65.5		1	0.6	0.338					
39	42	50	65.5		1	0.6	0.303					
39	42	46	65.5		1	0.6	0.331					
39	42	50	65.5		1	0.6	0.363					
39	42	46	65.5		1	0.6	0.445					
39	42	50	65.5		1	0.6	0.404					
39	42	50	65.5		1	0.6	0.455					
39	42	50	65.5		1	0.6	0.393					
41.5	44	48	72		1.5	1	0.503					
41.5	44	53	72		1.5	1	0.604					
41.5	44		73.5	72	1.5	1	0.595					
41.5	44	53	72		1.5	1	0.62					
41.5	67		73.5	72	1.5	1	0.610					
41.5	67		73.5	72	1.5	1	0.519					
41.5	44	48	72		1.5	1	0.591					
41.5	44	48	72		1.5	1	0.607					
41.5	44	53	72		1.5	1	0.620					
41.5	44	48	72		1.5	1	0.500					
41.5	67		73.5	72	1.5	1.5	0.519					
41.5	44	48	72		1.5	1	0.547					
41.5	44	48	72		1.5	1	0.526					
41.5	44	48	72		1.5	1	0.591					
41.5	44	53	72		1.5	1	0.833					
41.5	44	53	72		1.5	1	0.823					
41.5	44	48	72		1.5	1	0.81					
44	49	59	85		1.5	1.5	1.10					
44.5	47	55	75		1	1	0.705					
42	45	50	65		1	0.6	0.231					
42	45	50	65		1	0.6	0.183					
46.5	48	56	73.5		1	1	0.460					
46.5		56	73.5		1	1	0.442					
46.5	48	51	73.5		1	1	0.439					
46.5		56	73.5		1	1	0.460					

Single-row Cylindrical Roller Bearing

d 40-45 mm

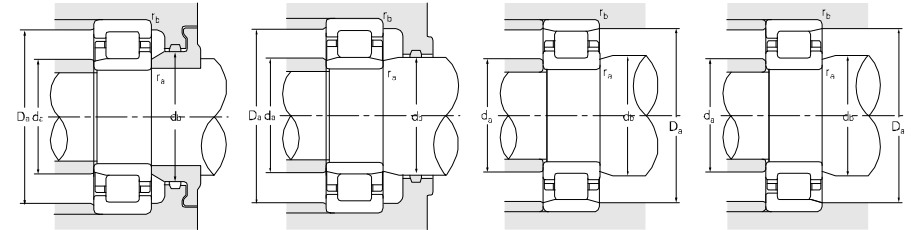
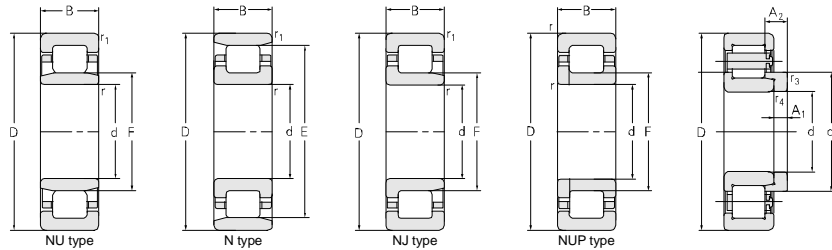

Principal dimensions						Basic load ratings		Limit speed ratings		Designations	
d	D	B	r _{1smin}	r _{smin}	F	E	C _r	C _{0r}	Grease		Oil
mm						kN		r/min			
40	80	18		1.1	49.5		60	55.5	7500	9000	NUP208ETN1
	80	18	1.1	1.1		71.5	60	55.5	7500	9000	N208EM
	80	18	1.1	1.1			60	55.5	7500	9000	NJ208ETN1
	80	18	1.1	1.1	49.5		60	55.5	7500	9000	NU208ETN1/C9
	80	18	1.1	1.1	49.5		60	55.5	7500	9000	NU208ETN1
	80	23	1.1	1.1	49.5		78	72	7500	9000	NJ2208EM
	80	23	1.1	1.1	49.5		78	72	7500	9000	NU2208EM
	80	23	1.1	1.1	49.5		78	72	7500	9000	NU2208ETN1
	80	23	1.1	1.1	49.5		78	72	7500	9000	NU2208ETN1/C9
	90	23	1.1	0.2	52.5		90	75	6700	8000	NCL308E/C9YA-1
	90	23	1.1	0.2		80	90	75	6700	8000	N308ETN1
	90	23	1.5	1.5		80	90	75	6700	8000	NF308ETN1/C9-FST
	90	23	1.5	1.5		77.5	90	75	6700	8000	NCL308E/YA
	90	23	1.5	1.5		80	90	75	6700	8000	N308EM
	90	23	1.5	1.5		80	90	75	6700	8000	NF308E
	90	23	1.5	1.5	52		90	75	6700	8000	NF308EM/C9-FST
	90	23	1.5	1.5	52		90	75	6700	8000	NJ308EM
	90	23	1.5	1.5	52		90	75	6700	8000	NJ308EM/YA8
	90	23	1.5	1.5	52		90	75	6700	8000	NJ308ETN1
	90	23		1.5	52		90	75	6700	8000	NUP308EM/C2
90	23		1.5	52		90	75	6700	8000	NUP308EM/YA6	
90	23		1.5	52		90	75	6700	8000	NUP308ETN1/YA6	
90	33	1.5	1.5	52		124	115	6300	7500	NU2308EM	
90	33	1.5	1.5	52		124	115	6300	7500	NJ2308E	
45	80.036	16	1	1	57.5		35.5	46.5	6700	8000	NJ609M/YA1
	85	19	1.1	1.1	55		57.5	56	6700	8000	NJ209M
	85	19	1.1	1.1	55		57.5	56	6700	8000	NJ209TN1
	85	19	1.1	1.1	54.5		67.5	61.5	6700	8000	NJ209EM
	85	19	1.1	1.1	55		67.5	61.5	6700	8000	NU209EM
	85	19	1.1	1.1		76.5	67.5	61.5	6700	8000	NF209EM
	85	19	1.1	1.1		76.5	67.5	61.5	6700	8000	NF209ETN1
	85	19	1.1	1.1	54.5		67.5	61.5	6700	8000	NUP209EM
	85	23	1.1	1.1	54.5		82	78	5600	6700	NU2209EM
	85	23	1.1	1.1	54.5		82	78	5600	6700	NU2209ETN1
	85	23	1.1	1.1	54.5		82	78	5600	6700	NU2209ETN1/C9

Abutment and fillet dimensions							Weight	Model	Weight	Separate thrust collar		
d _{amin}	d _{amax}	d _{bmin}	D _{amax}	D _{amin}	r _{amax}	r _{bmax}				A1	A2	r _{3,4}
mm							kg	kg	mm			
46.5	48	56	73.5		1	1	0.40					
46.5	69		73.5	73	1	1	0.425					
46.5	69		73.5	73	1	1	0.398					
46.5	48	51	73.5		1	1	0.377					
46.5	48	51	73.5		1	1	0.377					
46.5	48	56	73.5		1	1	0.539					
46.5	48	51	73.5		1	1	0.530					
46.5	48	51	73.5		1	1	0.487					
46.5	48	51	73.5		1	1	0.487					
48	50	60	82		1		0.678					
48	78		82	82	1		0.648					
48		60	82		1.5	1.5	0.667					
48	50	60	82		1.5	1.5	0.683					
48	78		82	82	1.5	1.5	0.794					
48			82	82	1.5	1.5	0.750					
48		60	82		1.5	1.5	0.813					
48	50	60	82		1.5	1.5	0.815					
48	50	60	82		1.5	1.5	0.805					
48	50	60	82		1.5	1.5	0.669					
48		60	82		1.5	1.5	0.819					
48		60	82		1.5	1.5	0.819					
48		60	82		1.5	1.5	0.673					
48	49	55	82		1.5	1.5	1.01					
48	49	60	82		1.5	1.5	1.10					
51.5	53	61	73.5	73	1	1	0.363					
51.5	53	61	78.5		1	1	0.487					
51.5	53	61	78.5		1	1	0.439					
51.5	53	61	78.5		1	1	0.51					
51.5	53	61	78.5		1	1	0.498					
51.5	73		78.5	78	1	1	0.510					
51.5	73		78.5	78	1	1	0.444					
52		61	78		1		0.507					
51	53	58	79		1	1	0.635					
51	53	58	79		1	1	0.571					
51	53	58	79		1	1	0.571					

Single-row Cylindrical Roller Bearing



d 45–50 mm

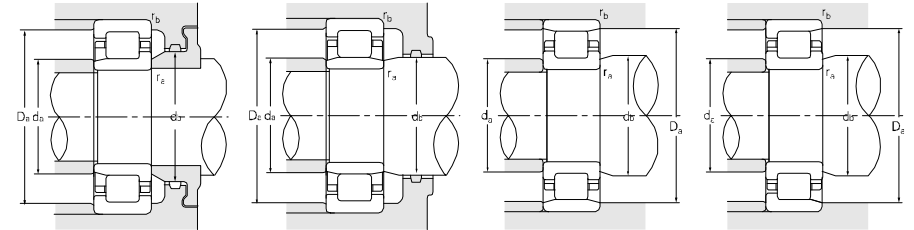
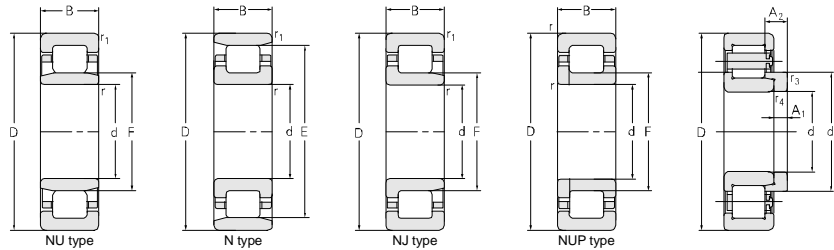

Principal dimensions						Basic load ratings		Limit speed ratings		Designations	
d	D	B	r _{1smin}	r _{smin}	F	E	C _r	C _{0r}	Grease		Oil
mm						kN		r/min			
45	85	23	1.1	1.1	54.5		82	78	5600	6700	NJ2209E/C3
	85	23	1.1	1.1	54.5		82	78	5600	6700	NJ2209EM
	85	30.16	1.1	1.1	55.52		94.6	119	6300	7500	NU3209X2M/C9YA6
	85	30.16	1.1	1.1	55.52		94.6	119	6300	7500	NU5209XPC3
	100	25	1.5	1.5		86.5	108	96	6300	7500	N309M
	100	25	1.5	1.5		86.5	108	96	6300	7500	N309J
	100	25	1.5	1.5		88.5	108	96	6300	7500	NCL309EN/YA
	100	25	1.5	1.5	58.5		108	96	6300	7500	NJ309ETN1
	100	25	1.5	1.5		88.5	108	96	6300	7500	NCL309E/YA
	100	25	1.5	1.5	58.5		108	96	6300	7500	NU309M/C3
	100	25	1.5	1.5	58.5		108	96	6300	7500	NJ309EM
	100	25	1.5	1.5		88.5	108	96	6300	7500	N309EM
	100	25	1.5	1.5	58.5		108	96	6300	7500	NUP309E
	100	25	1.5	1.5		88.5	108	96	6300	7500	N309E
	100	25	1.5	1.5		88.5	108	96	6300	7500	N309ETN1
	100	25	1.5	1.5		88.5	108	96	6300	7500	NF309E
	100	25	1.5	1.5	58.5		108	96	6300	7500	NJ309E
	100	25	1.5	1.5	58.5		108	96	6300	7500	NJ309EM/C4W124YA8
	100	25	1.5	1.5	58.5		108	96	6300	7500	NU309E
	100	25	1.5	1.5	56.4		108	96	6300	7500	NU309NRB1/YA6
	100	25	1.5	1.5	58.5		108	96	6300	7500	NUP309ETN1/HAC3YA6
	100	27.5	1.5	0.8	58.5		101	102	6300	7500	NUP309EWB1NRTN1
	100	31	1.5	1.5		88	119	120	6300	7500	NF2309X2J/YA6
	100	36	1.5	4.5	58.5		154	150	5600	6700	NU2309EM/C3
100	36	1.5	1.5	58.5		154	150	5600	6700	NJ2309E	
100	31	1.5	1.5	58.5		141	153	5600	6700	NJ2309X2NV/C9YA26	
100	36	1.5	1.5	58.5		154	150	5600	6700	NJ2309EM	
100	36	1.5	1.5	58.5		154	150	5600	6700	NJ2309EM/C4W124	
100	36	1.5	1.5	58.5		154	150	5600	6700	NU2309E	
100.038	25	1.5	1.5		86.5	108	96	6300	7500	NF309X1MR/YA1	
120	29	2	2		100.5	124	123	5600	6700	N409M	
120	29	2	2	64.5		124	123	5600	6700	NU409M	
120	29	2	2	64.5		124	123	5600	6700	NJ409M	
50	80	16	1	0.6	57.5		45	54	8500	10000	NJ1010M
	80	16	1	0.6	57.5		45	54	8500	10000	NJ1010TN1

Abutment and fillet dimensions						Weight	Model	Weight	Separate thrust collar		
d _{amin}	d _{amax}	d _{bmin}	D _{amax}	D _{amin}	r _{amax}				r _{bmax}	A1	A2
mm						kg	kg	mm			
51.5	53	61	78.5		1	1	0.639				
51.5	53	61	78.5		1	1	0.645				
51	53	58	79		1	1	0.831				
51	53	58	79		1	1	0.843				
53	84		92	90.5	1.5	1.5	0.920				
53	84		92	90.5	1.5	1.5	0.820				
53	84		92	90.5	1.5	1.5	0.872				
53	56	67	92		1.5	1.5	0.891				
53	84		92	90.5	1.5	1.5	0.872				
53	56	61	92		1.5	1.5	0.992				
53	56	67	92		1.5	1.5	1.00				
53	86		92	91	1.5	1.5	0.959				
53		67	92		1.5	1.5	1.01				
53	86		92	91	1.5	1.5	0.964				
53	86		92	91	1.5	1.5	0.846				
53			92	91	1.5	1.5	0.995				
53	56	67	92		1.5	1.5	1.01				
53	56	67	92		1.5	1.5	1.09				
53	56	61	92		1.5	1.5	0.986				
51	54	60	92		1.5	1.5	0.912				
53		67	92		1.5	1.5	0.892				
53		67	92		1.5	1.5	0.942				
53			92	91	1.5	1.5	1.12				
53	56	61	93		1	1	1.49				
53	56	67	92		1.5	1.5	1.45				
53	56	67	92		1.5	1.5	1.17				
53	56	67	92		1.5	1.5	1.52				
53	56	67	92		1.5	1.5	1.47				
53	56	61	93		1.5	1.5	1.42				
53	84		92	90.5	1.5	1.5	1.03				
54	97		111	103	2	2	1.67				
54	62	67	111		2	2	1.87				
54	62	74	111		2	2	1.88				
54	56	60	75		1	0.6	0.316				
54	56	60	75		1	0.6	0.279				

Single-row Cylindrical Roller Bearing

d 50 mm

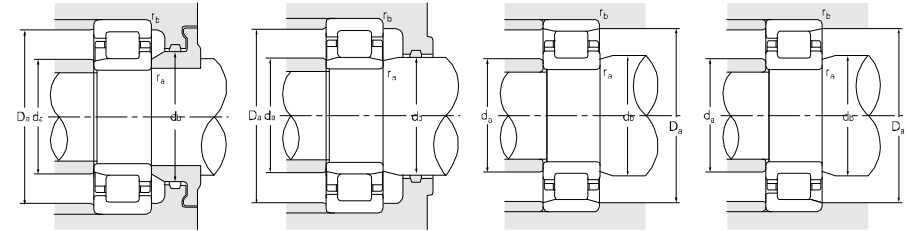
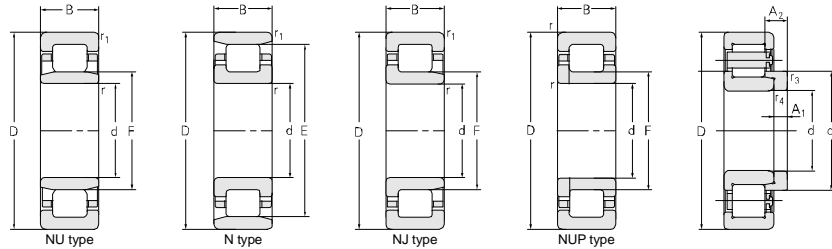

Principal dimensions						Basic load ratings		Limit speed ratings		Designations	
d	D	B	r _{1smin}	r _{smin}	F	E	C _r	C _{Or}	Grease		Oil
mm						kN		r/min			
50	80	16	1	1		60.5	45	54	8500	10000	N1010KM/P49
	90	20	1.1	1.1		80.4	57.2	64.0	6300	7500	N210M
	90	20	1.1	1.1		81.5	70.5	67.5	6300	7500	N210EM
	90	20	1.1	1.1		80.4	57.2	64.0	6300	7500	NF210M
	90	20	1.1	1.1	60.4		57.2	64.0	6300	7500	NU210M
	90	20	1.1	1.1	60.4		57.2	64.0	6300	7500	NU210Q1
	90	20	1.1	1.1	59.5		70.5	67.5	6300	7500	NU210EM
	90	20	1.1	1.1	59.5		70.5	67.5	6300	7500	NJ210EM
	90	20	1.1	1.1	59.5		70.5	67.5	6300	7500	NJ210ETN1
	90	20	1.1	1.1		81.5	70.5	67.5	6300	7500	NF210E
	90	20	1.1	1.1		81.5	70.5	67.5	6300	7500	NF210EM
	90	20	1.1	1.1	59.5		70.5	67.5	6300	7500	NUP210E
	90	23	1.1	1.1	59.5		86.5	84.5	6300	7500	NU2210EM
	90	23	1.1	1.1	59.5		86.5	84.5	6300	7500	NU2210ETN1/C9
	90	23	1.1	1.1	59.5		86.5	84.5	6300	7500	NJ2210EM
	90	23	1.1	1.1	59.5		86.5	84.5	6300	7500	NJ2210ETN1
	90	30.16	1.1	1.1	60.45		99.0	128	6300	7500	NU5210XPC3
	90	30.16	1.1	1.1	60.45		99.0	128	6300	7500	NU3210X2M/C9YA6
	100	33.34	1.5	1.1	66.9		118	155	6000	7000	NU5211XPC3
	100	32	2	2	65		112	116	5000	6000	NU310EWBTN1
	110	27	2	2		95	122	108	5000	6000	N310M
	110	27	2	2		95	122	108	5000	6000	NF310M
	110	27	2	2	65		122	108	5000	6000	NJ310M
	110	27	2	2	65		122	108	5000	6000	NJ310M+HJ310
	110	27	2	2	65		122	108	5000	6000	NU310M/C3
	110	27	2	2		97	122	108	5000	6000	N310EM
	110	27	2	2		97	122	108	5000	6000	N310E
	110	27	2	2	65		122	108	5000	6000	NJ310E
	110	27	2	2	65		122	108	5000	6000	NU310E
	110	27	2	2	65		122	108	5000	6000	NU310EM
	110	27	2	2	65		122	108	5000	6000	NUP310EM
	110	27	2	2	65		122	108	5000	6000	NUP310M
	110	27	2	2	65		122	108	5000	6000	NJ310TN1
	110	27	2	2	65		122	108	5000	6000	NU310TN1
	110	40	2	2	65		180	180	5000	6000	NU2310M
	110	40	2	2	65		180	180	5000	6000	NJ2310E

Abutment and fillet dimensions						Weight	Model	Weight	Separate thrust collar		
d _{amin}	d _{amax}	d _{bmin}	D _{amax}	D _{amin}	r _{amax}				r _{bmax}	A1	A2
mm						kg	kg	mm			
54	56		75		1	1	0.309				
56.5	79		83.5	82	1	1	0.559				
56.5	79		83.5	82	1	1	0.566				
56.5			83.5	82	1	1	0.565				
56.5	57	62	83.5		1	1	0.564				
56.5	57	62	83.5		1	1	0.557				
56.5	57	62	83.5		1	1	0.562				
56.5	57	66	83.5		1	1	0.573				
56.5	57	66	83.5		1	1	0.503				
56.5			83.5	82	1	1	0.578				
56.5			83.5	82	1	1	0.596				
56.5		66	83.5		1	1	0.591				
56.5	57	62	83.5		1	1	0.65				
56.5	57	66	83.5		1	1	0.563				
56.5	57	66	83.5		1	1	0.666				
56.5	57	66	83.5		1	1	0.579				
56	58	62	84		1	1	0.902				
56	58	62	84		1	1	0.902				
60	62		94		1	1	1.21				
59	63	67	101		2	2	1.19	HJ310E	0.152	8 12.74 2	
59	93		101	97	2	2	1.17				
59	93		101	97	2	2	1.31	HJ310	0.158	8 13.74 2	
59	63	73	101		2	2	1.36	HJ310	0.158	8 13.74 2	
59	63	73	101		2	2	1.52	HJ310	0.158	8 13.74 2	
59	63	67	101		2	2	1.29				
59	95		101	99	2	2	1.30				
59	95		101	99	2	2	1.30	HJ310E	0.152	8 12.74 2	
59	63	73	101		2	2	1.33	HJ310E	0.152	8 12.74 2	
59	63	67	101		2	2	1.29	HJ310E	0.152	8 12.74 2	
59	63	67	101		2	2	1.27				
59	63	67	101		2	2	1.34				
61		73	99		2	2	1.37	HJ310	0.158	8 13.74 2	
59	63	73	101		2	2	1.14	HJ310	0.158	8 13.74 2	
59	63	67	101		2	2	1.10				
59	61	67	101		2	2	1.91				
59	62	73	101		2	2	1.95				

Single-row Cylindrical Roller Bearing



d 50–55 mm

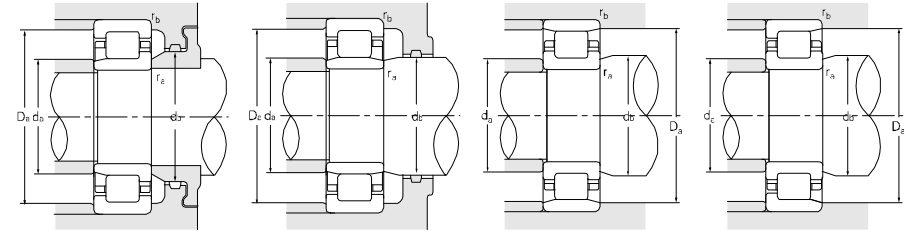
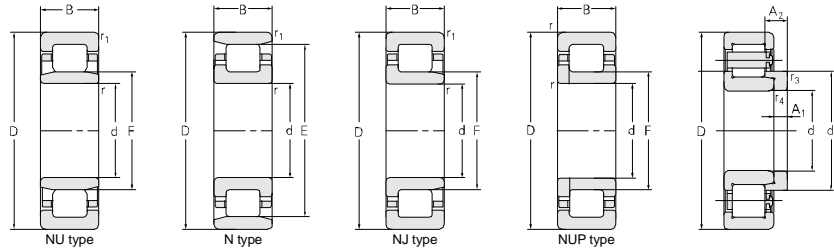

Principal dimensions						Basic load ratings		Limit speed ratings		Designations		
d	D	B	r _{1smin}	r _{smin}	F	E	C _r	C _{0r}	Grease		Oil	
mm						kN		r/min				
50	110	40	2	2	65		180	180	5000	6000	NJ2310EM	
	110	40	2	2	65		180	180	5000	6000	NU2310E	
	110	40	2	2	65		180	180	5000	6000	NU2310EM	
	110	40	2	2	65		180	180	5000	6000	NU2310ETN1	
	110	40	2	2	65		180	180	5000	6000	NJ2310ETN1	
	130	31	2.1	2.1		110	150	150	5000	6000	N410M	
	130	31	2.1	2.1		110	150	150	5000	6000	N410	
	130	31	2.1	2.1	70		150	150	5000	6000	NU410M	
	130	31	2.1	2.1	70		150	150	5000	6000	NU410	
	130	31	2.1	2.1	70		150	150	5000	6000	NJ410	
	130	31	2.1	2.1	70		150	150	5000	6000	NJ410M	
	130	31	2.1	2.1	70		150	150	5000	6000	NJ410TN1	
	130	31	2.1	2.1	70		150	150	5000	6000	NU410TN1	
	55	90	18	1.1	1	64.5		55	67	7000	8500	NU1011M
		90	18	1.1	1	64.5		55	67	7000	8500	NU1011TN1
		100	21	1.5	1.5		88.5	93	91	6000	7000	NF211M
100		21	1.5	1.5		90	93	91	6000	7000	NF211E	
100		21	1.5	1.1	66		93	91	6000	7000	NJ211E	
100		21	1.5	1.5	66		93	91	6000	7000	NUP211E	
100		21	1.5	1.5	66		93	91	6000	7000	NUP211EM	
100		21	1.5	1.5	66		93	91	6000	7000	NU211ETN1/C9	
100		21	1.5	1.5	66		93	91	6000	7000	NUP211ETN1	
100		21	1.5	1.1	66		93	91	6000	7000	NJ211ETN1	
100		25	1.5	1.1	66		109	113	6000	7000	NJ221EM	
100		25	1.5	1.1	66		109	113	6000	7000	NJ221ETN1	
100		25	1.5	1.1	66		109	113	6000	7000	NU2211EM	
100		33.3	1.5	1.1		88.9	117	155	4800	7000	N3211M	
100		33.34	1.1	1.1	66.9		118	155	4800	5600	NU5211XPC3	
100		33.34	1.1	1.1	66.9		118	155	4800	5600	NU3211X2M/C9YA6	
120		29	2	2		104.5	150	137	4800	5600	NF311M	
120		29	2	2		104.5	150	137	4800	5600	N311M	
120		29	2	2		104.5	150	137	4800	5600	N311J	
120		29	2	2	70.5		150	137	4800	5600	NU311M	
120		29	2	2	70.5		150	137	4800	5600	NJ311M	
120		29	2	2	70.5		150	137	4800	5600	NUP311M	

Abutment and fillet dimensions							Weight	Model	Weight	Separate thrust collar		
damin	damax	dbmin	Damax	Damin	ramax	rbmax				A1	A2	r _{3,4}
mm							kg	kg	mm			
59	62	73	101		2	2	1.92					
59	61	62	67	101	2	2	1.92					
59	61	67	101		2	2	1.89					
59	61	67	101		2	2	1.71					
59	62	73	101		2	2	1.74					
61	107		119	113	2	2	2.18					
61	107		119	113	2	2	2.09					
61	68	73	119		2	2	2.20					
61	68	73	119		2	2	2.11					
61	68	81	119		2	2	2.15					
61	68	81	119		2	2	2.24					
61	68	81	119		2	2	2.02					
61	68	73	119		2	2	1.99					
59.6	63	67	84		1	1	0.479					
59.6	63	67	84		1	1	0.403					
63			93.5	92	1.5	1.5	0.806					
63			93.5	92	1.5	1.5	0.757					
61.5	64	73	92		1.5	1	0.767					
61.5	64	73	92		1	1	0.751					
61.5	64	73	92		1	1	0.762					
61.5	64	73	92		1	1	0.67					
61.5	64	73	92		1	1	0.667					
61.5	64	73	92		1.5	1	0.701					
61.5	64	73	92		1.5	1	0.783					
61.5	64	73	92		1.5	1	0.666					
61.5	64	68	92		1.5	1	0.763					
63	87		93.5	92	1.5	1	1.20					
61	65	69	93		1	1	1.21					
61	65	69	93		1	1	1.21					
64			111	107	2	2	1.7					
64	102		111	107	2	2	1.65					
64	102		111	107	2	2	1.45					
64	68	73	111		2	2	1.74					
64	68	79	111		2	2	1.75					
64	68	79	111		2	2	1.76					

Single-row Cylindrical Roller Bearing

d 55-60 mm

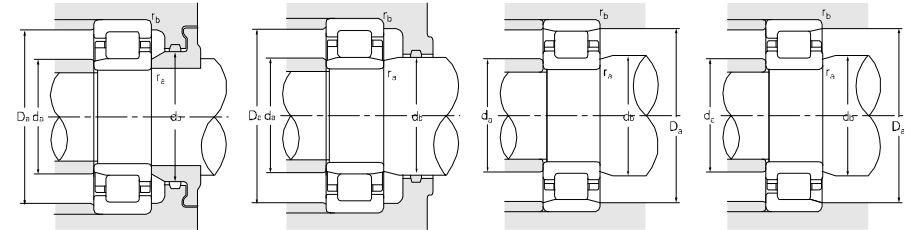
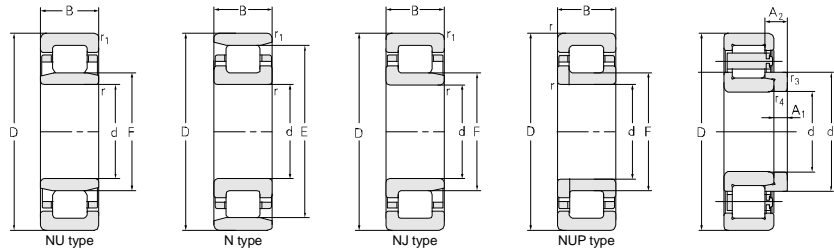

Principal dimensions						Basic load ratings		Limit speed ratings		Designations	
d	D	B	r _{1smin}	r _{smin}	F	E	C _r	C _{0r}	Grease		Oil
mm						kN		r/min			
55	120	29	2	2	70.5	150	137	4800	5600	NJ311M/YA6	
	120	29	2	0.5	68.75	150	137	4800	5600	NUP311NJJC	
	120	29	2	2	68.75	150	137	4800	5600	NUP311NRJC	
	120	29	2	2		106.5	150	137	4800	5600	N311EM
	120	29	2	2	106.5	150	137	4800	5600	N311E	
	120	29	2	2	70.5	150	137	4800	5600	NJ311TN1/YA6	
	120	29	2	2	70.5	150	137	4800	5600	NU311ETN1/C9	
	120	29	2	2	70.5	150	137	4800	5600	NU311TN1	
	120	29	2	2	70.5	150	137	4800	5600	NJ311E	
	120	29	2	2	70.5	150	137	4800	5600	NU311E	
	120	29	2	2	70.5	150	137	4800	5600	NUP311E	
	120	29	2	2	106.5	150	137	4800	5600	N311ETN1	
	120	29	2	2	70.5	150	137	4800	5600	NU311EM	
	120	29	2	2	70.5	150	137	4800	5600	NU311EM/C9	
	120	43	2	2	70.5	156	174	4800	5600	NU2311M	
	120	43	2	2	106.5	223	246	4800	5600	N2311E	
	120	43	2	2	70.5	223	246	4800	5600	NJ2311E	
	120	43	2	2	70.5	223	246	4800	5600	NU2311E	
	140	33	2.1	2.1	117.2	162	168	4800	5600	N411M	
	140	33	2.1	2.1	77.2	162	168	4800	5600	NJ411M/C5	
140	33	2.1	2.1	77.2	162	168	4800	5600	NU411M		
60	95	18	1.1	1	85.5	50.6	66.0	6700	8000	N1012M	
	95	18	1.1	1	85.5	50.6	66	6700	8000	N1012TN1	
	95	18	1.1	1	69.5	50.6	66.0	6700	8000	NU1012M	
	110	22	1.5	1.5	100	104	85	5300	6300	N212EM	
	110	22	1.5	1.5	97.5	104	85	5300	6300	N212M	
	110	22	1.5	1.5	97.5	104	85	5300	6300	NF212M	
	110	22	1.5	1.5	73.5	104	85	5300	6300	NU212M	
	110	22	1.5	1.5	72	104	85	5300	6300	NU212EM	
	110	22	1.5	1.5	73.5	104	85	5300	6300	NJ212M	
	110	22	1.5	1.5	72	104	85	5300	6300	NJ212E	
	110	22	1.5	1.5	72	104	85	5300	6300	NJ212EM	
	110	22	1.5	1.5	72	104	85	5300	6300	NJ212ETN1	
	110	22	1.5	1.5	72	104	85	5300	6300	NU212ETN1/C9	
	110	22	1.5	1.5	73.5	104	85	5300	6300	NUP212NM/YB2	

Abutment and fillet dimensions							Weight	Model	Weight	Separate thrust collar		
d _{amin}	d _{amax}	d _{bmin}	D _{amax}	D _{amin}	r _{amax}	r _{bmax}				A1	A2	r _{3,4}
mm							kg	kg	mm			
64	68	80	111		2	2	1.75					
64		80	111		2	2	1.65					
64		80	111		2	2	1.71					
64	104		111	109	2	2	1.60					
64	104		111	109	2	2	1.61					
64	68	80	111		2	2	1.45					
64	68	73	111		2	2	1.45					
64	68	73	111		2	2	1.44					
64	68	80	111		2	2	1.67					
64	68	73	111		2	2	1.64					
64	68	80	111		2	2	1.69					
64	104		111	109	2	2	1.42					
64	68	73	111		2	2	1.64					
64	68	73	111		2	2	1.63					
64	68	73	111		2	2	2.43					
64	104		111	110	2	2	2.56					
64	68	80	111		2	2	2.62					
64	68	73	111		2	2	2.59					
66	114		129	119	2	2	2.86					
66	74	88	129		2	2	2.95					
66	74	88	129		2	2	2.85					
65	83		88.5	87	1	1	0.432					
65	83		88.5	87	1	1	0.387					
65	67	72	90		1	1	0.466					
65	70		102		1.5	1.5	0.910					
68			102		1.5	1.5	0.937					
68			102		1.5	1.5	0.957					
68	70	75	102		1.5	1.5	0.938					
68	70	80	102		1.5	1.5	0.916					
68	70	80	102		1.5	1.5	0.952					
68	70	80	102		1.5	1.5	0.947					
68	70	80	102		1.5	1.5	0.938					
68	70	80	102		1.5	1.5	0.842					
68	70	80	102		1.5	1.5	0.820					
68	70	80	102		1.5	1.5	0.978					

Single-row Cylindrical Roller Bearing

d 60 mm

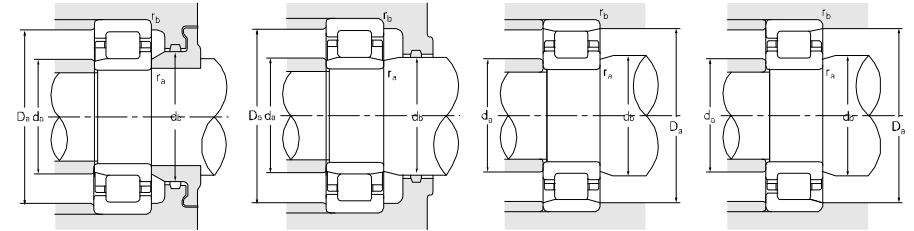
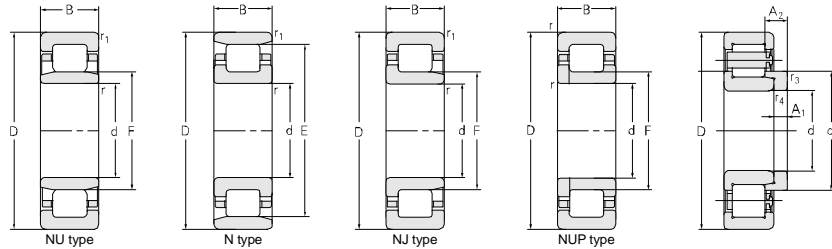

Principal dimensions						Basic load ratings		Limit speed ratings		Designations	
d	D	B	r _{1smin}	r _{smin}	F	E	C _r	C _{0r}	Grease		Oil
mm							kN				r/min
60	110	28		1.5	73.5		140	145	5300	6300	NUP2212M
	110	28	1.5	1.5	72		140	145	5300	6300	NU2212EM
	110	28	1.5	1.5	72		140	145	5300	6300	NJ2212EM
	110	28	1.5	1.5	72		140	145	5300	6300	NJ2212ETN1
	110	36.51	1.5	1.5	72.39		150	195	4800	5600	NU5212XPC3
	110	36.51	1.5	1.5	72.39		150	195	4800	5600	NU3212X2M/C9YA6
	110	60	1.5	1.5	73.5		105	130	5300	6300	NU2212WBM/C3
	130	31	2.1	2.1		113	165	150	4300	5000	N312M
	130	31	2.1	2.1	77		141	150	4300	5000	NU312M
	130	31	2.1	2.1	77		141	150	4300	5000	NU312Q1
	130	31	2.1	2.1	77		141	150	4300	5000	NJ312M
	130	31	2.1	2.1		115	165	155	4300	5000	N312E
	130	31	2.1	2.1		115	165	155	4300	5000	N312EM
	130	31	2.1	2.1		115	165	155	4300	5000	N312ETN1
	130	31	2.1	2.1		115	165	155	4300	5000	NF312E
	130	31	2.1	2.1		115	165	155	4300	5000	NF312EM
	130	31	2.1	2.1	77		165	155	4300	5000	NJ312E
	130	31	2.1	2.1	77		165	155	4300	5000	NJ312EM/YAB
	130	31	2.1	2.1	77		165	155	4300	5000	NU312E
	130	31	2.1	2.1	77		165	155	4300	5000	NU312EM
	130	31	2.1	2.1	77		165	155	4300	5000	NU312ETN1
	130	31	2.1	2.1	77		165	155	4300	5000	NU312ETN1/C9
	130	31	2.1	2.1	77		165	155	4300	5000	NUP312E
	130	31	2.1	2.1	77		165	155	4300	5000	NUP312E/C9
	130	31	2.1	2.1	77		165	155	4300	5000	NUP312ENRM
	130	31	2.1	2.1	77		165	155	4300	5000	NUP312ENR/J/C3
	130	31	2.1	2.1		113	140	150	4300	5000	N312TN1
	130	31	2.1	2.1	77		140	150	4300	5000	NJ312TN1
	130	46	2.1	2.1		113	190	215	4300	5000	N2312M
	130	46	2.1	2.1	77		190	215	4300	5000	NJ2312M/C4W124YA8
	130	46	2.1	2.1	77		190	215	4300	5000	NJ2312M
	130	46	2.1	2.1	78		190	215	4300	5000	NJ2313M
	130	46	2.1	2.1		115	250	255	4300	5000	N2312E
	130	46	2.1	2.1	77		250	255	4300	5000	NU2312ETN1/C9
	130	46	2.1	2.1	77		250	255	4300	5000	NU2312E
	130	46	2.1	2.1	77		250	255	4300	5000	NJ2312E

Abutment and fillet dimensions						Weight	Model	Weight	Separate thrust collar		
d _{amin}	d _{amax}	d _{bmin}	D _{amax}	D _{amin}	r _{amax}				r _{bmax}	A1	A2
mm							kg	kg	mm		
68		80	102		1.5	1.5	1.27				
68	70	74	102		1.5	1.5	1.21				
68	70	80	102		1.5	1.5	1.23				
68	70	80	102		1.5	1.5	1.07				
66	70	75	103		1	1	1.75				
66	70	75	103		1	1	1.75				
68	70	74	102		1.5	1.5	1.57				
71	110			116	2	2	2.04				
71	72	80	119		2	2	2.06				
71	72	80	119		2	2	2.03				
71	72	86	119		2	2	2.10				
71	112			118	2	2	1.94				
71	112			118	2	2	2.06				
71	112			118	2	2	1.79				
71				118	2	2	2.00				
71				118	2	2	2.12				
71	74	87	119		2	2	1.98				
71	74	87	119		2	2	2.10				
71	74	79	119		2	2	1.94				
71	74	79	119		2	2	2.06				
71	74	79	119		2	2	1.78				
71	74	79	119		2	2	1.78				
71		87	119		2	2	2.03				
71		87	119		2	2	2.03				
71		87	119		2	2	2.2				
71		87	119		2	2	1.92				
71	110			116	2	2	1.78				
71	72	86	119		2	2	1.83				
71	110			117	2	2	2.95				
71	73	80	119		2	2	3.39				
71	73	87	119		2	2	3.38				
71	73	87	119		2	2	3.39				
71	112			118	2	2	2.93				
71	112			118	2	2	2.79				
71	73	80	119		2	2	2.95				
71	73	87	119		2	2	3.00				