

# Single-row Cylindrical Roller Bearing

d 60–65 mm

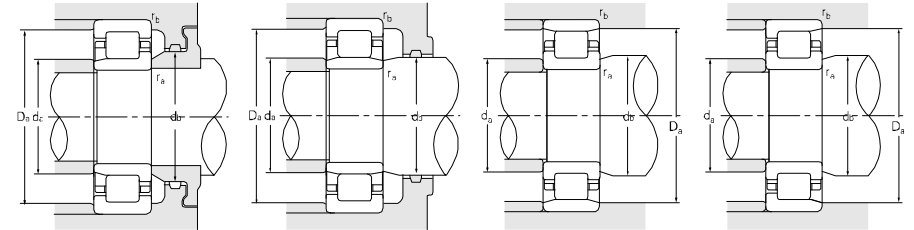
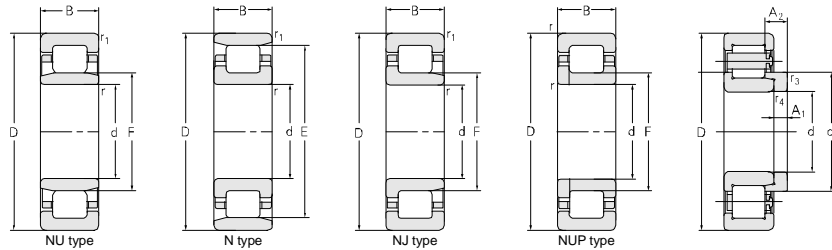

Principal dimensions						Basic load ratings		Limit speed ratings		Designations	
d	D	B	r <sub>1smin</sub>	r <sub>smin</sub>	F	E	C <sub>r</sub>	C <sub>0r</sub>	Grease		Oil
mm						kN		r/min			
60	140	51	2.5	2.5		122	270	310	4300	5000	<b>N612M</b>
	140	51	2.5	2.5		122	270	310	4300	5000	<b>N612M/C9</b>
	150	35	2.1	2.1		127	195	200	4300	5000	<b>N412M</b>
	150	35	2.1	2.1		127	195	200	4300	5000	<b>N412</b>
	150	35	2.1	2.1	83		195	200	4300	5000	<b>NU412M</b>
	150	35	2.1	2.1	83		195	200	4300	5000	<b>NU412</b>
	150	35	2.1	2.1	83		195	200	4300	5000	<b>NJ412J</b>
	150	35	2.1	2.1	83		195	200	4300	5000	<b>NJ412M</b>
	150	35	2.1	2.1	83		195	200	4300	5000	<b>NJ412</b>
	150	35		2.1	83		195	200	4300	5000	<b>NUP412</b>
	150	35		2.1	83		195	200	4300	5000	<b>NUP412J</b>
	150	35		2.1	83		195	200	4300	5000	<b>NUP412M</b>
	150	35	2.1	2.1	83		195	200	4300	5000	<b>NU412TN1</b>
	65	120	23	1.5	1.5		105.6	89	102	4800	5600
120		23	1.5	1.5	79.6		89	102	4800	5600	<b>NU213M</b>
120		23	1.5	1.5	79.6		89	102	4800	5600	<b>NJ213M</b>
120		23	1.5	1.5	79.6		89	102	4800	5600	<b>NUP213M</b>
120		23	1.5	1.5		108.5	120	135	4800	5600	<b>NF213E</b>
120		23	1.5	1.5		108.5	120	135	4800	5600	<b>N213E</b>
120		23	1.5	1.5	78.5		120	135	4800	5600	<b>NU213E</b>
120		23	1.5	1.5	78.5		120	135	4800	5600	<b>NJ213E</b>
120		23	1.5	1.5	78.5		120	135	4800	5600	<b>NUP213E</b>
120		23	1.5	1.5	78.5		120	135	4800	5600	<b>NUP213EM</b>
120		23	1.5	1.5	78.5		120	135	4800	5600	<b>NUP213ETN1</b>
120		23	1.5	1.5	78.5		120	135	4800	5600	<b>NU213ETN1/C9</b>
120		23	1.5	1.5	78.5		120	135	4800	5600	<b>NU213ETN1</b>
120		31	1.5	1.5	79.6		122	155	4800	5600	<b>NJ2213M</b>
120		31	1.5	1.5	79.6		122	155	4800	5600	<b>NU2213M</b>
120		31	1.5	1.5	79.6		131	165	4800	5600	<b>NU2213NM</b>
120		31	1.5	1.5	79.6		131	165	4800	5600	<b>NUP2213M</b>
120		31	1.5	1.5	78.5		163	173	4800	5600	<b>NU2213ETN1/C9</b>
120		31	1.5	1.5	78.5		122	154	4800	5600	<b>NUP2213NM</b>
120		31	1.5	1.5	78.5		163	173	4800	5600	<b>NU2213EM</b>
120		38.1	1.5	1.5	80.42		166	218	4000	4800	<b>NU5213XPC3</b>
120		38.1	1.5	1.5	80.42		166	218	4000	4800	<b>NU3213M/C9YA6</b>

Abutment and fillet dimensions						Weight	Model	Weight	Separate thrust collar		
d <sub>amin</sub>	d <sub>amax</sub>	d <sub>bmin</sub>	D <sub>amax</sub>	D <sub>amin</sub>	r <sub>amax</sub>				r <sub>bmax</sub>	A1	A2
mm						kg	kg	mm			
72	119		128	125	2	2	3.96				
72	119		128	125	2	2	3.96				
71	124		139	130	2	2	3.29				
71	124		139	130	2	2	3.18				
71	80	85	139		2	2	3.23				
71	80	85	139		2	2	3.13				
71	80	94	139		2	2	3.13				
71	80	94	139		2	2	3.36				
71	80	94	139		2	2	3.25				
71		94	139		2	2	3.43				
71		94	139		2	2	3.31				
71		94	139		2	2	3.42				
71	80	85	139		2	2	2.91				
73	103		112	111	1.5	1.5	1.11				
73	76	81	112		1.5	1.5	1.12				
73	76	87	112		1.5	1.5	1.14				
73		87	112		1.5	1.5	1.22				
73			112	111	1.5	1.5	1.14				
73			112	111	1.5	1.5	1.05				
73	106		112		1.5	1.5	0.994				
73	76	81	112		1.5	1.5	1.13				
73	76	87	112		1.5	1.5	1.16				
73		87	112		1.5	1.5	1.22				
73		87	112		1.5	1.5	1.07				
73		87	112		1.5	1.5	1.02				
73	76	81	112		1.5	1.5	1.00				
73	76	87	112		1.5	1.5	1.65				
73	76	81	112		1.5	1.5	1.65				
73		87	112		1.5	1.5	1.64				
73		87	112		1.5	1.5	1.75				
73	76	81	112		1.5	1.5	1.43				
73	76	81	112		1.5	1.5	1.74				
73	76	81	112		1.5	1.5	1.61				
72	78.5	82.5	113.5		1	1	1.96				
72	78.5	82.5	113.5		1	1	1.96				

# Single-row Cylindrical Roller Bearing

d 65-70 mm

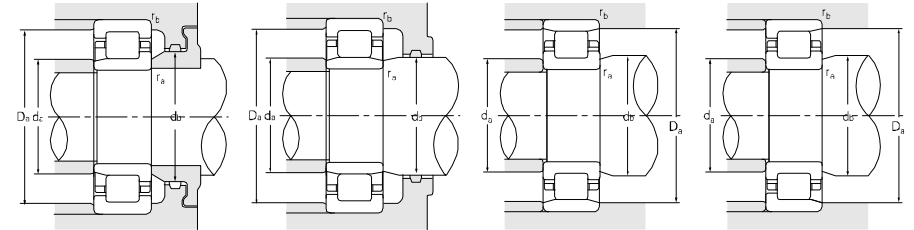
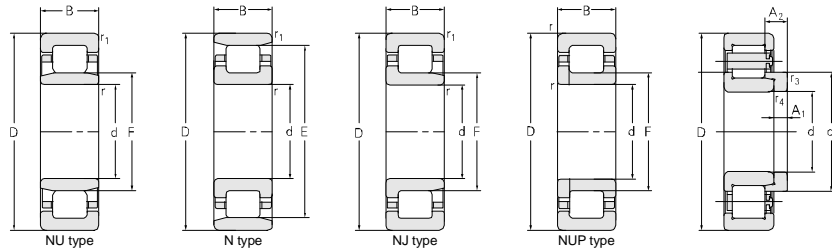

Principal dimensions						Basic load ratings		Limit speed ratings		Designations	
d	D	B	r <sub>1smin</sub>	r <sub>smin</sub>	F	E	C <sub>r</sub>	C <sub>0r</sub>	Grease		Oil
mm						kN		r/min			
<b>65</b>	140	33	2.1	2.1		121.5	156	168	4000	4800	<b>N313</b>
	140	33	2.1	2.1		121.5	156	168	4000	4800	<b>N313M</b>
	140	33	2.1	2.1		121.5	195	210	4000	4800	<b>N313ETN1</b>
	140	33	2.1	2.1	83.5		156	168	4000	4800	<b>NJ313M</b>
	140	33	2.1	2.1	83.5		156	168	4000	4800	<b>NU313M</b>
	140	33	2.1	2.1	83.5		156	168	4000	4800	<b>NU313Q1</b>
	140	33	2.1	2.1	82.5		205	188	4000	4800	<b>NJ313EM</b>
	140	33	2.1	2.1		124.5	205	188	4000	4800	<b>N313EM</b>
	140	33	2.1	2.1		124.5	205	188	4000	4800	<b>NF313EM</b>
	140	33	2.1	2.1	82.5		205	188	4000	4800	<b>NU313EM</b>
	140	33	2.1	2.1	82.5		205	188	4000	4800	<b>NU313ETN1</b>
	140	33	2.1	2.1		124.5	205	188	4000	4800	<b>N313E</b>
	140	33	2.1	2.1	82.5		205	188	4000	4800	<b>NJ313E</b>
	140	33	2.1	2.1	82.5		205	188	4000	4800	<b>NU313E</b>
	140	33	2.1	2.1	82.5		205	188	4000	4800	<b>NUP313EM</b>
	140	33	2.1	2.1	83.5		205	188	4000	4800	<b>NU313M/YA1</b>
	140	48	2.1	2.1	83.5		211	248	4000	4800	<b>NJ2313M</b>
	140	48	2.1	2.1	83.5		211	248	4000	4800	<b>NU2313M</b>
	140	48	2.1	2.1	83.5		274	278	4000	4800	<b>NU2313ETN1</b>
	140	48	2.1	2.1	83.5		274	278	4000	4800	<b>NU2313ETN1/C9</b>
	140	48	2.1	2.1		124.5	274	278	4000	4800	<b>NF2313E</b>
	140	48	2.1	2.1	82.5		274	278	4000	4800	<b>NJ2313E</b>
	140	48	2.1	2.1	82.5		274	278	4000	4800	<b>NU2313E</b>
	160	37	2.1	2.1		135.5	209	222	4000	4800	<b>N413M</b>
	160	37	2.1	2.1		135.5	209	222	4000	4800	<b>N413</b>
	160	37	2.1	2.1	89.5		209	222	4000	4800	<b>NU413M</b>
	160	37	2.1	2.1	89.5		209	222	4000	4800	<b>NU413</b>
	160	37	2.1	2.1	89.5		209	222	4000	4800	<b>NJ413M</b>
160	37	2.1	2.1	89.5		209	222	4000	4800	<b>NJ413M/YA8</b>	
160	37	2.1	2.1	89.5		209	222	4000	4800	<b>NJ413W1</b>	
160	37	2.1	2.1	89.5		209	222	4000	4800	<b>NUP413M</b>	
<b>70</b>	110	20	1.1	1.1	80	73.5	89.5	4600	5500	<b>NU1014M</b>	
	125	24	1.5	1.5	84.5	92.4	96	4500	5300	<b>NUP214M</b>	
	125	24	1.5	1.5		110.5	92.4	110	4500	5300	<b>N214M</b>
	125	24	1.5	1.5		110.5	92.4	110	4500	5300	<b>NF214M</b>

Abutment and fillet dimensions						Weight	Model	Weight	Separate thrust collar		
d <sub>amin</sub>	d <sub>amax</sub>	d <sub>bmin</sub>	D <sub>amax</sub>	D <sub>amin</sub>	r <sub>amax</sub>				r <sub>bmax</sub>	A1	A2
mm						kg	kg	mm			
76	119		129	124	2	2	2.24				
76	119		129	124	2	2	2.45				
76	119		129	124	2	2	2.15				
76	81	93	129		2	2	2.60				
76	81	86	129		2	2	2.54				
76	81	86	129		2	2	2.46				
76	80	93	129		2	2	2.5				
76	122		129	127	2	2	2.42				
76	122		129	127	2	2	2.48				
76	80	85	129		2	2	2.45				
76	80	85	129		2	2	2.18				
76	122		129	127	2	2	2.43				
76	80	93	129		2	2	2.59				
76	80	85	129		2	2	2.46				
77		93	128		2	2	2.64				
76	81	86	129		2	2	2.46				
76	79	93	129		2	2	3.67				
76	79	85	129		2	2	3.60				
76	79	85	129		2	2	3.26				
76	79	85	129		2	2	3.26				
76			129	127	2	2	3.60				
76	79	93	129		2	2	3.55				
76	79	85	129		2	2	3.48				
76	132		149	139	2	2	4.01				
76	132		149	139	2	2	3.92				
76	86	92	149		2	2	4.03				
76	86	92	149		2	2	3.94				
76	86	101	149		2	2	4.09				
76	86	101	149		2	2	4.01				
76	86	101	149		2	2	4.00				
76		101	149		2	2	4.19				
75	76		104		1	1	0.69				
78		92	117		1.5	1.5	1.35				
78	108		117	116	1.5	1.5	1.27				
78			117	116	1.5	1.5	1.30				

# Single-row Cylindrical Roller Bearing

d 70 mm

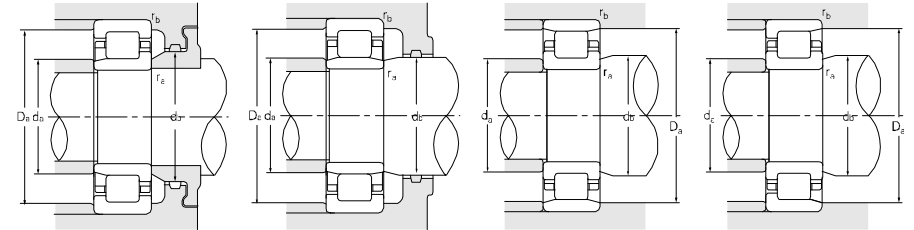
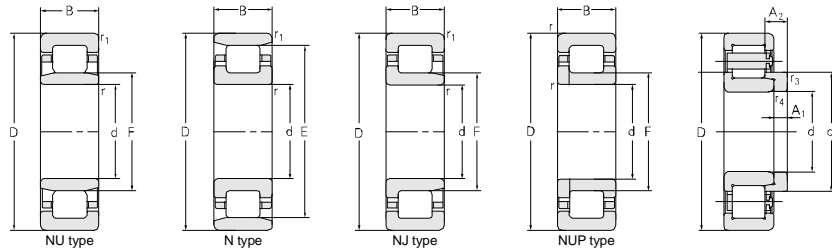

Principal dimensions						Basic load ratings		Limit speed ratings		Designations	
d	D	B	r <sub>1smin</sub>	r <sub>smin</sub>	F	E	C <sub>r</sub>	C <sub>0r</sub>	Grease		Oil
mm						kN		r/min			
<b>70</b>	125	24	1.5	1.5	84.5		92.4	116	4500	5300	<b>NU214Q1</b>
	125	24	1.5	1.5	84.5		92.4	116	4500	5300	<b>NU214M</b>
	125	24	1.5	4.3		113.5	132	152	4500	5300	<b>NF214E/J/C9YB2</b>
	125	24	1.5	1.5		113.5	132	152	4500	5300	<b>N214E</b>
	125	24	1.5	1.5		113.5	132	152	4500	5300	<b>NF214E</b>
	125	24	1.5	4.3		113.5	132	152	4500	5300	<b>NF214E/C9YB2</b>
	125	24	1.5	4.3		113.5	132	152	4500	5300	<b>NF214ETN1/C9YB2</b>
	125	24		1.5	83.5		132	152	4500	5300	<b>NUP214E</b>
	125	24	1.5	1.5	83.5		132	152	4500	5300	<b>NJ214E</b>
	125	24	1.5	1.5	83.5		132	152	4500	5300	<b>NU214ETN1/C9</b>
	125	24	1.5	1.5	83.5		132	152	4500	5300	<b>NJ214E/YA6</b>
	125	24	1.5	1.5	83.5		132	152	4500	5300	<b>NU214E</b>
	125	31		1.5	84.5		130	155	4500	5300	<b>NUP2214M</b>
	125	31	1.5	1.5		110.5	130	155	4500	5300	<b>N2214M</b>
	125	31	1.5	1.5	84.5		130	155	4500	5300	<b>NU2214M</b>
	125	31	1.5	1.5	84.5		130	155	4500	5300	<b>NJ2214M</b>
	125	39.69	1.5	1.5	84.76		166	232	4500	5300	<b>NU5214XPC3</b>
	125	39.69	1.5	1.5	84.76		166	232	4500	5300	<b>NU5214/C9YA6</b>
	125	39.69	1.5	1.5	84.76		166	232	4500	5300	<b>NU3214X2M/C9YA6</b>
	125	41	1.5	1.5	84.5		130	155	4500	5300	<b>NU2214WBM/C2</b>
	150	35	2.1	2.1	90		182	202	3600	4300	<b>NJ314Q1</b>
	150	35	2.1	2.1		130	182	202	3600	4300	<b>N314M</b>
	150	35	2.1	2.1		130	182	202	3600	4300	<b>N314J</b>
	150	35	2.5	2.5	90		182	202	3600	4300	<b>NU314M</b>
	150	35	2.5	2.5	90		182	202	3600	4300	<b>NJ314M</b>
	150	35	2.1	2.1		130	182	202	3600	4300	<b>NF314M</b>
	150	35	2.1	2.1	90		182	202	3600	4300	<b>NU314Q1</b>
	150	35	3	2.1	90		182	202	3600	4300	<b>NU314NRM/YAB</b>
	150	35	2.1	2.1	90		185	202	3600	4300	<b>NU314NM/YB2</b>
	150	35	2.1	2.1	90		185	202	3600	4300	<b>NU314NTN1/YB2</b>
	150	35	2.1	2.1		133	226.5	220	3600	4300	<b>N314E</b>
	150	35	2.1	2.1		133	226.5	220	3600	4300	<b>N314EM</b>
	150	35	2.1	2.1	89		226.5	220	3600	4300	<b>NJ314E/C9</b>
	150	35	2.1	2.1	89		226.5	220	3600	4300	<b>NU314E</b>
	150	35	2.1	2.1	89		226.5	220	3600	4300	<b>NJ314E</b>
	150	35	2.1	2.1	89		226.5	220	3600	4300	<b>NJ314EM/YAB</b>

Abutment and fillet dimensions						Weight	Model	Weight	Separate thrust collar		
d <sub>amin</sub>	d <sub>amax</sub>	d <sub>bmin</sub>	D <sub>amax</sub>	D <sub>amin</sub>	r <sub>amax</sub>				r <sub>bmax</sub>	A1	A2
mm						kg	kg	mm			
78	81	86	117		1.5	1.5	1.23				
78	81	86	117		1.5	1.5	1.24				
78			117	116	4	1.5	1.21				
78	111		117	116	1.5	1.5	1.29				
78			117	116	1.5	1.5	1.31				
78			117	116	4	1.5	1.33				
78			117	116	4	1.5	1.17				
78		92	117		1.5	1.5	1.39				
78	81	92	117		1.5	1.5	1.34				
78	81	92	117		1.5	1.5	1.16				
78	81	92	117		1.5	1.5	1.34				
78	81	86	117		1.5	1.5	1.32				
78		92	117		1.5	1.5	1.8				
78	81		117	100	1.5	1.5	1.68				
78	81	86	117		1.5	1.5	1.70				
78	81	92	117		1.5	1.5	1.73				
76.5	82.5	86.5	118.5		1	1	2.17				
76.5	82.5	86.5	118.5		1	1	2.17				
76.5	82.5	86.5	118.5		1	1	2.17				
78	81	86	117		1.5	1.5	1.88				
81	86	100	139		2	2	3.11				
81	127		139	133	2	2	3.00				
81	127		139	133	2	2	2.78				
81	86	93	139		2	2	3.05				
81	86	100	139		2	2	3.12				
81			139		2	2	3.08				
81	86	92	139		2	2	3.03				
81	86	92	139		2	2	3.05				
81	86	93	139		2	2	2.96				
81	86	93	139		2	2	2.66				
81	130		139	136	2	2	3.00				
81	130		139	136	2	2	3.08				
81	86	100	139		2	2	3.06				
81	86	92	139		2	2	3.01				
81	86	100	139		2	2	3.06				
81	86	100	139		2	2	3.14				

# Single-row Cylindrical Roller Bearing

d 70-75 mm

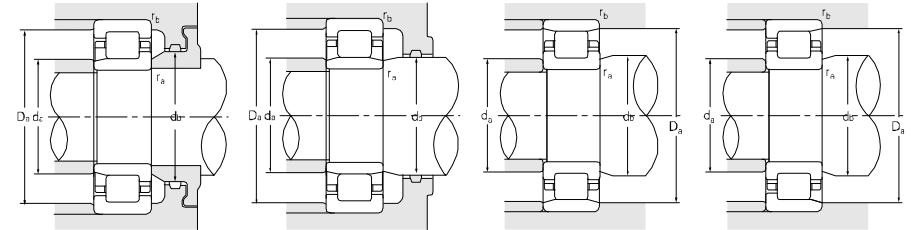
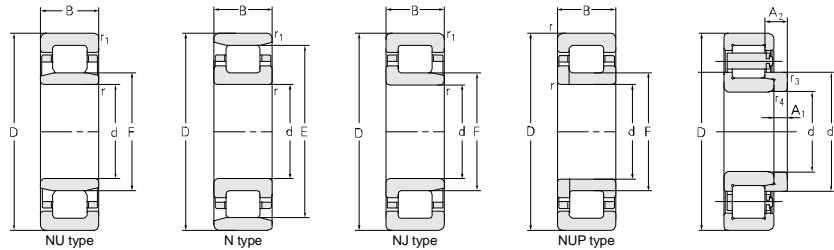

Principal dimensions						Basic load ratings		Limit speed ratings		Designations	
d	D	B	r <sub>1smin</sub>	r <sub>smin</sub>	F	E	C <sub>r</sub>	C <sub>0r</sub>	Grease		Oil
mm						kN		r/min			
<b>70</b>	150	35		2.1	89		226.5	220	3600	4300	<b>NUP314E</b>
	150	35	2.1	2.1	89		226.5	220	3600	4300	<b>NU314EM</b>
	150	35	2.1	2.1	89		226.5	220	3600	4300	<b>NU314ETN1</b>
	150	35	2.1	2.1	89		226.5	220	3600	4300	<b>NU314ETN1/C9</b>
	150	51	2.1	2.1	90		248	300	3600	4300	<b>NU2314M</b>
	150	51	2.1	2.1	90		248	300	3600	4300	<b>NJ2314M</b>
	150	51	2.1	2.1	90		248	300	3600	4300	<b>NJ2314M/C4W124YA8</b>
	150	51	2.1	2.1	89	133	302	345	3600	4300	<b>N2314E</b>
	150	51	2.1	2.1	89	133	302	345	3600	4300	<b>NU2314ETN1/C9</b>
	150	51	2.1	2.1	89	133	302	345	3600	4300	<b>NU2314E</b>
	150	51	2.1	2.1	89	133	302	345	3600	4300	<b>NJ2314E</b>
	150	51	2.1	2.1	86	133	320	370	3600	4300	<b>NJ2314E/WBYAD</b>
	180	42	3	3	3	151	262	283	3600	4300	<b>N414M</b>
	180	42	3	3	3	152	262	283	3600	4300	<b>N414</b>
	180	42	3	3	100	152	262	283	3600	4300	<b>NU414M</b>
	180	42	3	3	100	152	262	283	3600	4300	<b>NU414</b>
	180	42	3	3	100	152	262	283	3600	4300	<b>NJ414</b>
	180	42	3	3	100	152	262	283	3600	4300	<b>NJ414M</b>
	180	42	3	3	100	152	262	283	3600	4300	<b>NJ414M/YA8</b>
	180	42	3	3	100	152	262	283	3600	4300	<b>NUP414M</b>
<b>75</b>	115	20	1.1	1	85	65	83.0	5600	6700		<b>NU1015M</b>
	115.050	20	1.1	1		105	60	74	5600	6700	<b>NF1015X1M</b>
	130	25	1.5	1.5		116.5	107	127	4500	5300	<b>N215M</b>
	130	25	1.5	1.5	88.5		107	127	4500	5300	<b>NU215M</b>
	130	25	1.5	1.5	88.5		107	127	4500	5300	<b>NJ215M</b>
	130	25	1.5	1.5		118.5	144	150	4500	5300	<b>N215E</b>
	130	25	1.5	1.5	88.5		144	150	4500	5300	<b>NU215E</b>
	130	25	1.5	1.5	88.5		144	150	4500	5300	<b>NU215ETN1</b>
	130	25	1.5	1.5	88.5		144	150	4500	5300	<b>NU215ETN1/C9</b>
	130	25	1.5	1.5	88.5		144	150	4500	5300	<b>NJ215E</b>
	130	25	1.5	1.5	88.5		144	150	4500	5300	<b>NU215EL3/HAP53</b>
	130	25	1.5	1.5	88.5		144	150	4500	5300	<b>NUP215EL3/HAP53</b>
	130	30		1.5	88.5		132	166	4500	4500	<b>NUP2215M</b>
	130	30	1.5	1.5	88.5		164	211	4500	4500	<b>NFP2215E</b>
	130	30	1.5	1.5	88.5		164	211	4500	4500	<b>NFP2215EM</b>

Abutment and fillet dimensions						Weight	Model	Weight	Separate thrust collar		
d <sub>amin</sub>	d <sub>amax</sub>	d <sub>bmin</sub>	D <sub>amax</sub>	D <sub>amin</sub>	r <sub>amax</sub>				r <sub>bmax</sub>	A1	A2
mm						kg	kg	mm			
81		100	139		2	2	3.14				
82	86	91	138		2	2	3.45				
82	86	91	138		2	2	2.7				
82	86	91	138		2	2	2.7				
81	86	93	139		2	2	4.52				
81	86	101	139		2	2	4.62				
81	86	101	139		2	2	4.61				
81	130		139	136	2	2	4.27				
81	86	92	139		2	2	3.89				
81	86	92	139		2	2	4.24				
81	86	100	139		2	2	4.33				
81	86	101	139		2	2	4.51				
83	148		167	155	2.5	2.5	5.66				
83	148		167	155	2.5	2.5	6.40				
83	97	102	167		2.5	2.5	5.79				
83	97	102	167		2.5	2.5	6.38				
83	97	113	167		2.5	2.5	6.68				
83	97	113	167		2.5	2.5	5.94				
83	97	113	167		2.5	2.5	5.91				
83		102	167		2.5	2.5	6.17				
80	83	87	108.5		1	1	0.739				
80	83	87	108.5		1	1	0.765				
83	114		122	121	1.5	1.5	1.40				
83	86	91	122		1.5	1.5	1.42				
83	86	97	122		1.5	1.5	1.45				
83	116		122	121	1.5	1.5	1.38				
83	86	91	122		1.5	1.5	1.39				
83	86	91	122		1.5	1.5	1.24				
83	86	91	122		1.5	1.5	1.24				
83	86	97	122		1.5	1.5	1.38				
83	86	91	122		1.5	1.5	1.3				
83		97	122		1.5	1.5	1.35				
83		97	122		1.5	1.5	2.03				
83		97	122		1.5	1.5	1.81				
83		97	122		1.5	1.5	1.86				

# Single-row Cylindrical Roller Bearing



d 75–80 mm

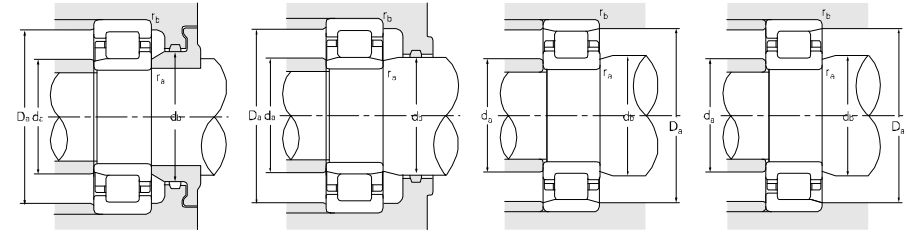
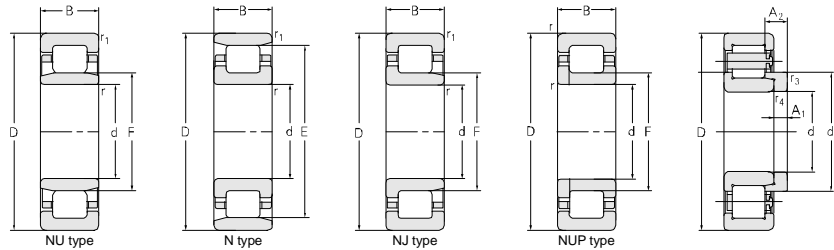

Principal dimensions							Basic load ratings		Limit speed ratings		Designations
d	D	B	r <sub>1smin</sub>	r <sub>smin</sub>	F	E	C <sub>r</sub>	C <sub>0r</sub>	Grease	Oil	
mm							kN		r/min		
<b>75</b>	130	31	1.5	1.5	88.5		164	211	4500	4500	<b>NU2215ETN1/C9</b>
	130	31	1.5	1.5	88.5		132	166	4500	5300	<b>NU2215M</b>
	130	31	1.5	1.5	88.5	116.5	132	166	4500	5300	<b>N2215M</b>
	130	31	1.5	1.5	88.5		132	166	4500	5300	<b>NUP2215TN1</b>
	130	41.28	1.5	1.5	89		204	268	4000	4000	<b>NU5215XPC3</b>
	130	41.28	1.5	3	89		204	268	4000	4000	<b>NU3215X2M/C9YA6</b>
	160	37	2.1	2.1	95.5		204	226	3400	4000	<b>NJ315Q1</b>
	160	37	2.1	2.1	95.5	139.5	269	254	3400	4000	<b>N315EM</b>
	160	37	2.1	2.1	95.5	139.5	204	226	3400	4000	<b>N315J</b>
	160	37	2.1	2.1	95		269	254	3400	4000	<b>NU315EM</b>
	160	37	2.1	2.1	95.5		204	226	3400	4000	<b>NU315Q1</b>
	160	37	2.1	2.1	95	143	269	254	3400	4000	<b>N315E</b>
	160	37	2.1	2.1	95		269	254	3400	4000	<b>NU315ETN1</b>
	160	37	2.1	2.1	95		269	254	3400	4000	<b>NU315ENM</b>
	160	37	2.1	2.1	95		269	254	3400	4000	<b>NUP315EM</b>
	160	37	2.1	2.1	95	139.5	255	226	3400	4000	<b>N315M</b>
	160	37	2.1	2.1	95.5		255	226	3400	4000	<b>NU315M</b>
	160	37	2.1	2.1	95		269	254	3400	4000	<b>NU315E</b>
	160	37	2.1	2.1	95.5		255	226	3400	4000	<b>NJ315M</b>
	160	46	2.1	2.1	95		269	303	3400	4000	<b>NJ315X2EM/YAB</b>
	160	37	2.1	2.1	95		269	254	3400	4000	<b>NJ315E</b>
	160	55	2.1	2.1	95.5	139.5	287	345	3400	4000	<b>N2315M</b>
	160	55	2.1	2.1	95.5	139.5	287	345	3400	4000	<b>N2315Q1</b>
	160	55	2.1	2.1	95.5		287	345	3400	4000	<b>NJ2315M</b>
160	55	2.1	2.1	95.5		287	345	3400	4000	<b>NU2315M</b>	
190	45	3	3	104.5		300	325	3400	5300	<b>NJ415M</b>	
190	45	3	3	104.5		300	325	3400	5300	<b>NJ415M/YA8</b>	
190	45	3	3	104.5	160.5	300	325	3400	4000	<b>N415M</b>	
190	45	3	3	104.5		300	325	3400	4000	<b>NU415M</b>	
<b>80</b>	125	22	1.1	1	113.5	95	122	5300	6300	<b>N1016M</b>	
	125	22	1.1	1	91.5	95	122	5300	6300	<b>NU1016M</b>	
	140	26	2	2	125	127	154	4000	4800	<b>NF216M</b>	
	140	26	2	2	125	127	154	4000	4800	<b>N216M</b>	
	140	26	2	2	95	127	154	4000	4800	<b>NJ216M</b>	
	140	26	2	2	95	127	154	4000	4800	<b>NU216M</b>	

Abutment and fillet dimensions							Weight	Model	Weight	Separate thrust collar		
d <sub>amin</sub>	d <sub>amax</sub>	d <sub>bmin</sub>	D <sub>amax</sub>	D <sub>amin</sub>	r <sub>amax</sub>	r <sub>bmax</sub>				A1	A2	r <sub>3,4</sub>
mm							kg	kg	mm			
83		97	122		1.5	1.5	1.54					
83	86	91	122		1.5	1.5	1.75					
83	86	91	122	121	1.5	1.5	1.77					
83		97	122		1.5	1.5	1.83					
81.5	92	91	123.5		1	1	2.27					
81.5	92	91	123.5		1	1	2.27					
86	137	107	149	142	2	2	3.75					
86	140		149	146	2	2	3.65					
86	92		149		2	2	3.28					
86	92	97	149		2	2	3.62					
86	92	97	149		2	2	3.68					
86	140		149	146	2	2	3.59					
86	92	97	149		2	2	3.25					
86	92	97	149		2	2	3.59					
86		107	149		2	2	3.75					
86	140		149	146	2	2	3.59					
86	92	97	149		2	2	3.56					
86	92	97	149		2	2	3.56					
86	92	107	149		2	2	3.63					
86	92	107	149		2	3	4.62					
86	157	107	149	163	2	2	3.64					
86	136		149	143	2	2	5.30					
86	136		149	143	2	2	5.84					
86	91	107	149		2	2	5.86	HJ2315	0.512	11	21.8	2.1
86	91	98	149		2	2	5.96	HJ2315	0.512	11	21.8	2.1
88	87	119	177		2.5	2.5	7.14					
88	87	119	177		2.5	2.5	7.20					
88	101		177		2.5	2.5	6.86					
88	101	107	177		2.5	2.5	6.94					
<b>85</b>	110		118.5	116.5	1	1	1.00					
	85	90	118.5		1	1	1.21					
	89		131		2	2	1.72					
	89	123		131	128	2	2	1.66				
	89	93	104	131		2	2	1.73				
	89	93	98	131		2	2	1.69				

# Single-row Cylindrical Roller Bearing



d 80 mm

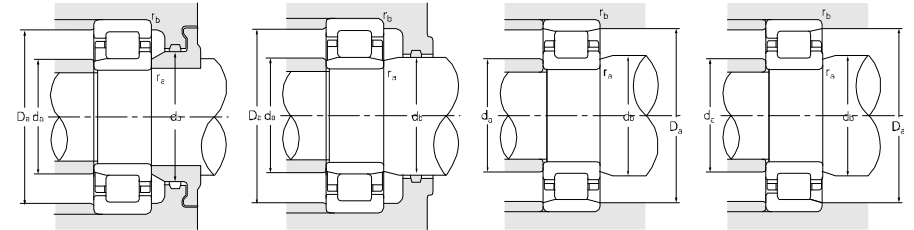
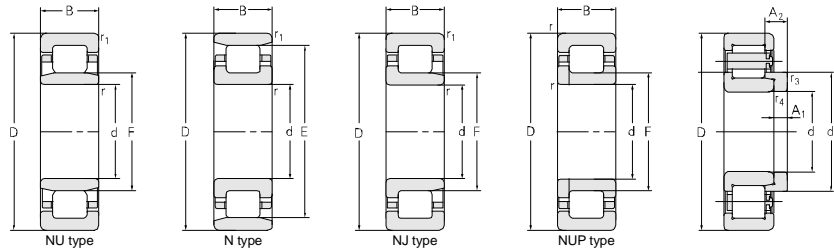

Principal dimensions						Basic load ratings		Limit speed ratings		Designations	
d	D	B	r <sub>1smin</sub>	r <sub>smin</sub>	F	E	C <sub>r</sub>	C <sub>0r</sub>	Grease		Oil
mm						kN		r/min			
80	140	26		2	95		127	154	4000	4800	NUP216M
	140	26	2	2	95.3		151	184	4000	4800	NU216E
	140	26	2	2	95.3		135	170	4000	4800	NU216Q1
	140	26	2	2	95.3		151	184	4000	4800	NU216ETN1/C9
	140	26		2	95.3		151	184	4000	4800	NUP216E
	140	26	2	2		127.3	151	184	4000	4800	N216E
	140	26	2	2	95.3		151	184	4000	4800	NJ216E
	140	26		2	95.3		160	184	4000	4800	NUP216ENR/J/C3YA6
	140	26		2	95.3		160	184	4000	4800	NUP216ENRM/YA6
	140	26	2	2	95		120	144	4000	4800	NU216M-DT
	140	33	2	2	59.3		152	195	4000	4800	NU2216M
	140	33	2	2	95.3		152	226	4000	4800	NJ2216M
	140	33	2	2	95.3		204	235	4000	4800	NU2216EM
	140	33	2	2	95.3		204	235	4000	4800	NJ2216E
	140	33	2	2	95.3		204	235	4000	4800	NU2216E
	140	33	2	2		127.3	204	235	4000	4800	N2216E
	140	33		2	95.3		204	235	4000	4800	NUP2216E
	140	44.5	2	2	95.28		220	305	4000	4800	NU5216
	140	44.5	2	2	95.28		210	290	4000	4800	NU3216X2M/C9YA6
	150	45	2	2	97		245	320	3800	4500	NJ3216X3M/P54
	150	45	2	2	97		245	320	3800	4500	NJP3216X3M/P54
	170	39	2.1	2.1		151	217	246	3200	3800	N316M
	170	39	2.1	2.1		151	217	246	3200	3800	NF316M
	170	39	2.1	2.1	103		217	246	3200	3800	NU316M
	170	39	2.1	2.1	103		217	246	3200	3800	NU316Q1
	170	39	2.1	2.1	103		217	246	3200	3800	NJ316M
	170	39	2.1	2.1	103		217	246	3200	3800	NUP316M
	170	39	2.1	2.1	101		288	278	3200	3800	NJ316EM
	170	39	2.1	2.1		151	288	278	3200	3800	N316EM
	170	39	2.1	2.1	101		288	278	3200	3800	NU316EM
	170	39	2.1	2.1	101		288	278	3200	3800	NU316EF1/C9
	170	39	2.1	2.1		151	288	278	3200	3800	N316E
170	39	2.1	2.1	101		288	278	3200	3800	NJ316E	
170	39	2.1	2.1	101		288	278	3200	3800	NU316E	
170	39	2.1	2.1	101		288	278	3200	3800	NU316ETN1	
170	58	2.1	2.1		147	305	380	3200	3800	N2316M	

Abutment and fillet dimensions						Weight	Model	Weight	Separate thrust collar		
d <sub>amin</sub>	d <sub>amax</sub>	d <sub>bmin</sub>	D <sub>amax</sub>	D <sub>amin</sub>	r <sub>amax</sub>				r <sub>bmax</sub>	A1	A2
mm						kg	kg	mm			
89		104	131		2	2	1.77				
89	93	98	131		2	2	1.65				
89	93	98	131		2	2	1.74				
89	93	98	131		2	2	1.48				
89		104	131		2	2	1.72				
89	125	104	131	130	2	2	1.67				
89	93	104	131		2	2	1.68				
89		104	131		2	2	1.66				
89		104	131		2	2	1.81				
89	93	98	131		2	2	1.65				
89	93	98	131		2	2	2.32				
89	93	104	131		2	2	2.35				
89	93	98	131		2	2	2.39				
89	93	104	131		2	2	2.34				
89	93	98	131		2	2	2.30				
89	124	131	130		2	2	2.16				
89		104	131		2	2	2.13				
88	93	97	132		1.5	1.5	3.03				
88	93	97	132		1.5	1.5	3.03				
90	94	104	136		2	2	3.69				
90	94	104	136		2	2	3.69				
91	144	159			2	2	4.30				
91	144	159			2	2	4.46				
91	100	106	159	150	2	2	4.37				
91	100	106	159		2	2	4.45				
91	98	113	159		2	2	4.47				
91		113	159		2	2	4.58				
91	98	113	159		2	2	4.32				
91	148	159		154	2	2	4.22				
91	98	104	159		2	2	4.26				
91	98	104	159		2	2	4.20				
91	148	159		154	2	2	3.98				
91	98	113	159	154	2	2	4.08				
91	98	104	159		2	2	4.25				
91	98	104	159		2	2	3.89				
91	144	159			2	2	6.15				

# Single-row Cylindrical Roller Bearing

d 80–85 mm

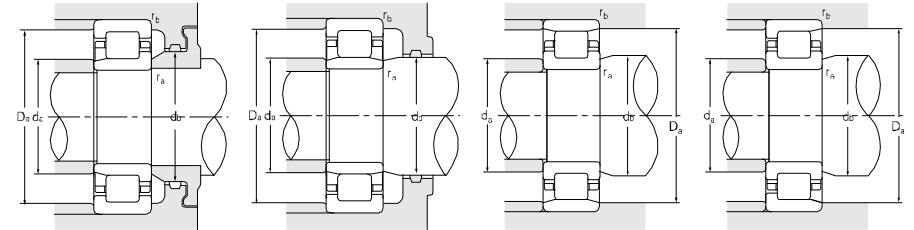
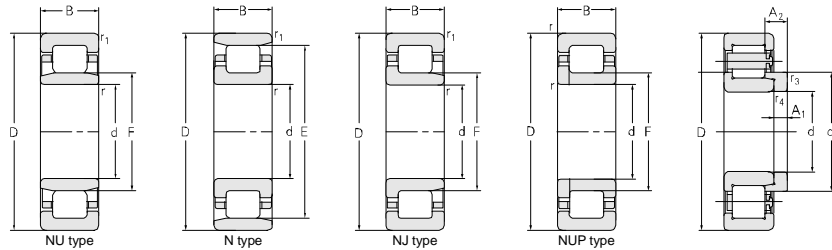

Principal dimensions						Basic load ratings		Limit speed ratings		Designations		
d	D	B	r <sub>1smin</sub>	r <sub>smin</sub>	F	E	C <sub>r</sub>	C <sub>0r</sub>	Grease		Oil	
mm						kN		r/min				
80	170	58	2.1	2.1	103		305	380	3200	3800	NU2316M	
	170	58	2.1	2.1	103		305	380	3200	3800	NJ2316M	
	170	58	2.1	2.1	103		305	380	3200	3800	NJ2316TN1	
	170	60		2.1	100		430	545	3200	3800	NUP2316WB1V	
	170	58	2.1	2.1	101		400	422	3200	3800	NU2316E	
	170	58	2.1	2.1	101	151	400	422	3200	3800	N2316E	
	170	58	2.1	2.1	101		400	422	3200	3800	NJ2316E	
	170	58	2.1	2.1	101		400	422	3200	3800	NJ2316EM	
	170	58		2.1	100		305	380	3200	3800	NUP2316M/YAB	
	170	62		2.1	98		305	380	3200	3800	NUP2316X2V	
	200	48	3	3	3	170	341	375	3200	3800	N416M	
	200	48	3	3	3		341	375	3200	3800	NU416M	
	200	48	3	3	3		341	375	3200	3800	NJ416M	
	200	48	3	3	3		341	375	3200	3800	NJ416M/YA8	
	85	130	22	1.1	1.1	96.5		89	109	5000	6000	NJ1017TN1/C9YA6
		150	28	2	2		133.8	143	175	3800	4500	N217M
150		28	2	2	101.8		143	175	3800	4500	NU217M	
150		28	2	2	101.8		143	175	3800	4500	NU217M/W124	
150		28	2	2	101.8		143	175	3800	4500	NJ217M	
150		28	2	2		136.5	183	215	3800	4500	N217E	
150		28	2	2	100.5		183	215	3800	4500	NU217E	
150		28	2	2	100.5		183	215	3800	4500	NJ217E	
150		28	2	2	100.5		183	215	3800	4500	NUP217EM	
150		36	2	2	101.8		195	265	3800	4500	NU2217M/C3	
150		36	2	2	100.5		240	270	3800	4500	NU2217EM	
150		36	2	2	100.5		240	270	3800	4500	NU2217ETN1/C9	
150		36	2	2	100.5		240	270	3800	4500	NJ2217EM	
150		49.2	2	2	102		223	310	3800	4500	NU3217M/C3	
150		49.21	2	2	102		252	350	3800	4500	NU5217XPC3	
150		49.21	2	2	102		240	330	3800	4500	NU3217X2M/C9YA6	
180		41	3	3		160	325	330	3000	3600	N317EQ1	
180		41	3	3	108		325	330	3000	3600	NJ317EQ1	
180		41	3	3	108		325	330	3000	3600	NU317E	
180		41	3	3	108		325	330	3000	3600	NU317EM	
180		41	3	3	108		325	330	3000	3600	NU317ETN1	

Abutment and fillet dimensions							Weight	Model	Weight	Separate thrust collar		
d <sub>amin</sub>	d <sub>amax</sub>	d <sub>bmin</sub>	D <sub>amax</sub>	D <sub>amin</sub>	r <sub>amax</sub>	r <sub>bmax</sub>				A1	A2	r <sub>3,4</sub>
mm							kg	kg	mm			
91	98	106	159	154	2	2	6.34					
91	98	113	159		2	2	6.44					
91	98	113	159		2	2	6.68					
91	98	104	159		2	2	6.51					
91	98	104	159		2	2	6.28					
91	148	104	159	150	2	2	6.26					
91	98	113	159		2	2	6.94					
91	98	113	159		2	2	6.62					
91	98	118	159		2	2	7.23					
91	97	118	159		2	2	7.19					
93	167		187		2.5	2.5	8.02					
93	106	113	187		2.5	2.5	8.19	HJ416	0.37	13	21.78	3
93	106	125	187		2.5	2.5	8.31	HJ416	0.37	13	21.78	3
93	106	125	187		2.5	2.5	8.27	HJ416	0.37	13	21.78	3
90	95	99	122		1	1	0.972					
94	132		141	139	2	2	2.08					
94	98	103	141		2	2	2.09					
94	98	103	141		2	2	2.09					
94	98	110	141		2	2	2.15					
94	134		141	139	2	2	2.08					
94	98	103	141		2	2	2.08					
94	98	110	141		2	2	2.12					
94	98	110	141		2	2	2.27					
94	98	103	141		2	2	2.8					
94	98	103	141		2	2	2.82					
94	98	103	141		2	2	2.42					
	98	110	141		2	2	2.86					
94	98	103	141		2	2	3.88					
94	100	104	141		1.5	1.5	3.88					
94	100	104	141		1.5	1.5	3.88					
98	157		167	163	2.5	2.5	5.20					
98	105	120	167		2.5	2.5	5.27					
98	105	111	167		2.5	2.5	5.12					
98	105	111	167		2.5	2.5	5.16					
98	105	111	167		2.5	2.5	4.57					

# Single-row Cylindrical Roller Bearing



d 85-90 mm

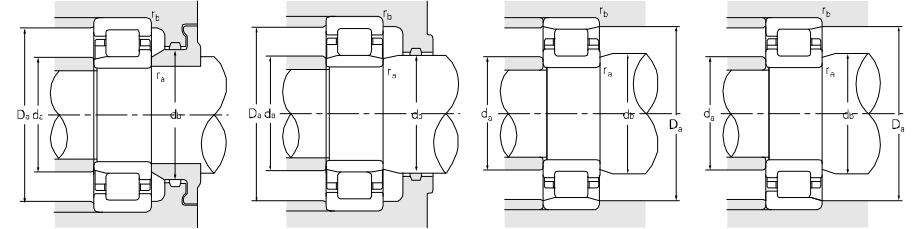
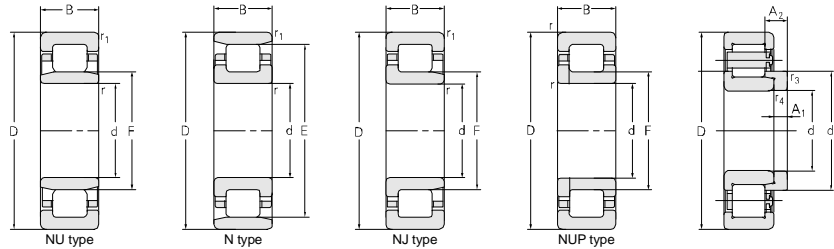

Principal dimensions						Basic load ratings		Limit speed ratings		Designations	
d	D	B	r <sub>1smin</sub>	r <sub>smin</sub>	F	E	C <sub>r</sub>	C <sub>0r</sub>	Grease		Oil
mm						kN		r/min			
<b>85</b>	180	41	3	3	108		325	330	3000	3600	<b>NU317EQ1</b>
	180	41	3	3		160	325	330	3000	3600	<b>N317E</b>
	180	41	3	3		160	300	330	3000	3600	<b>N317E/YA1</b>
	180	41	3	3		160	325	330	3000	3600	<b>N317EM</b>
	180	41	3	3		160	325	330	3000	3600	<b>N317EN1T</b>
	180	41	3	3	108		325	330	3000	3600	<b>NJ317E</b>
	180	41	1.1	1.1	108		325	330	3000	3600	<b>NJ317EM</b>
	180	60	3	3	108		347	435	3000	3600	<b>NU2317M</b>
	180	60	3	3	108		347	435	3000	3600	<b>NJ2317M</b>
	180	60	3	3		160	435	470	3000	3600	<b>N2317E</b>
	180	60	3	3	108		435	470	3000	3600	<b>NU2317E</b>
	180	60	3	3	108		435	470	3000	3600	<b>NJ2317E</b>
	210	52	4	4		179.5	385	425	3000	3600	<b>N417M</b>
	210	52	4	4	115.5		385	425	3000	3600	<b>NU417M</b>
	210	52	4	4	115.5		385	425	3000	3600	<b>NJ417M</b>
	210	52	4	4	115.5		385	425	3000	3600	<b>NUP417M</b>
<b>90</b>	140	24	1.5	1.1	103		90	115	3600	4300	<b>NJ1018M</b>
	140	24	1.5	1.1	103		90	115	3600	4300	<b>NUP1018M</b>
	140	24	1.5	1.1	103		90	115	3600	4300	<b>NU1018M</b>
	160	30	2	2		143	165	195	3600	4300	<b>N218J</b>
	160	30	2	2		143	165	195	3600	4300	<b>N218J1</b>
	160	30	2	2		143	170	205	3600	4300	<b>NF218M</b>
	160	30	2	2		143	170	205	3600	4300	<b>N218M</b>
	160	30	2	2	107		170	205	3600	4300	<b>NU218M</b>
	160	30	2	2	107		170	205	3600	4300	<b>NU218M/W124</b>
	160	30	2	2	107		170	205	3600	4300	<b>NJ218M</b>
	160	30	2	2		145	200	215	3600	4300	<b>NF218E</b>
	160	30	2	2		145	200	215	3600	4300	<b>N218E</b>
	160	30	2	2	107		200	215	3600	4300	<b>NU218ETN1/C9</b>
	160	30	2	2	107		200	215	3600	4300	<b>NU218E</b>
	160	30	2	2	107		200	215	3600	4300	<b>NJ218E</b>
	160	30	2	2	107		165	195	3600	4300	<b>NU218M-DT</b>
	160	30	2	2	107		165	195	3600	4300	<b>NUP218M</b>
	160	40	2	2	143		215	285	3600	4300	<b>N2218M</b>
	160	40	2	2	107		270	300	3600	4300	<b>NUP2218EM</b>

Abutment and fillet dimensions							Weight	Model	Weight	Separate thrust collar		
d <sub>amin</sub>	d <sub>amax</sub>	d <sub>bmin</sub>	D <sub>amax</sub>	D <sub>amin</sub>	r <sub>amax</sub>	r <sub>bmax</sub>				A1	A2	r <sub>3,4</sub>
mm							kg	kg	mm			
98	105	111	167		2.5	2.5	5.18					
98	157		167	163	2.5	2.5	5.14					
98	157		167	163	2.5	2.5	5.13					
98	157		167	163	2.5	2.5	5.20					
98	157		167	163	2.5	2.5	4.59					
98	105	120	167		2.5	2.5	5.21					
98	105	111	167		2.5	2.5	5.27					
96	103	111	169		2.5	2.5	7.36	HJ2317	0.617	12	23.73	3
96	103	120	169		2.5	2.5	7.81	HJ2317	0.617	12	23.73	3
96	157		169		2.5	2.5	7.44					
96	104	111	169		2.5	2.5	7.40					
96	104	120	169	163	2.5	2.5	7.57					
101	176		194	183	3	3	9.48					
101	112	119	194		3	3	9.66	HJ417	0.4	14	23.73	4
101	109	129	194		3	3	9.83	HJ417	0.4	14	23.73	4
101		129	194		3	3	10.1					
96.5	101	106	132		1.5	1	1.38					
96.5		106	132		1.5	1	1.4					
96.5	99	106	132		1.5	1	1.34					
99	140		151	148	2	2	2.37					
99	140		151	148	2	2	2.47					
99			151	148	2	2	2.71					
99	140		151	148	2	2	2.64					
99	104	110	151		2	2	2.66					
99	104	110	151		2	2	2.66					
99	104	117	151		2	2	2.72					
99			151	148	2	2	2.55					
99	142		151	148	2	2	2.49					
99	104	110	151		2	2	2.26					
99	104	110	151		2	2	2.49					
99	104	117	151		2	2	2.54					
99	104	110	151		2	2	2.57					
99		110	151		2	2	2.81					
99	105		158	151	2	2	3.62					
99		117	151		2	2	3.68					

# Single-row Cylindrical Roller Bearing

d 90–95 mm

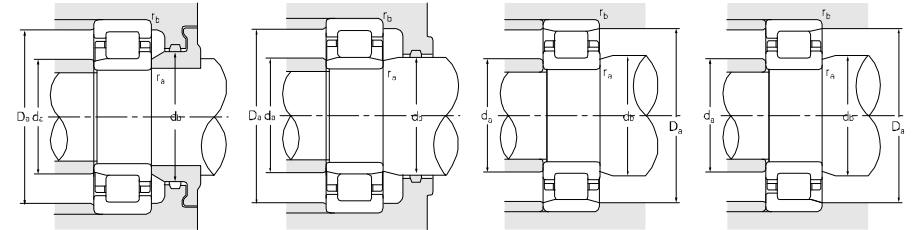
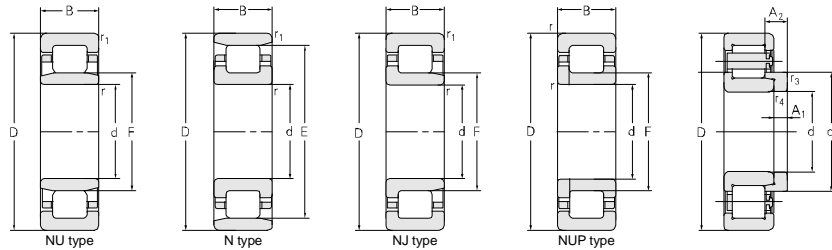

Principal dimensions						Basic load ratings		Limit speed ratings		Designations	
d	D	B	r <sub>1smin</sub>	r <sub>smin</sub>	F	E	C <sub>r</sub>	C <sub>0r</sub>	Grease		Oil
mm						kN		r/min			
<b>90</b>	160	40	2	2	107		270	300	2800	3400	<b>NU2218ETN1</b>
	160	40		2	107		270	300	2800	3400	<b>NUP2218F2-ZZ/C9S2YAD</b>
	160	40		2	107		270	300	2800	3400	<b>NUP2218EM</b>
	160	52.4	2	2	107.218		280	390	3600	4300	<b>NU3218A</b>
	160	52.4	2	2	107.218		280	390	3200	3800	<b>NU5218XPC3</b>
	160	52.4	2	2	107.218		280	390	3200	3800	<b>NU5218/C9YA6</b>
	160	52.4	2	2	107.218		280	390	3600	4300	<b>NU3218M/C9YA6</b>
	190	43	3	3		165	274	295	2800	3400	<b>NF318</b>
	190	43	3	3		165	274	315	2800	3400	<b>NF318M</b>
	190	43	3	3		165	274	315	2800	3400	<b>N318M</b>
	190	43	3	3	115		274	315	2800	3400	<b>NU318M</b>
	190	43	3	3	115		274	315	2800	3400	<b>NU318Q1</b>
	190	43	3	3	115		274	315	2800	3400	<b>NJ318M</b>
	190	43	3	3	115		274	315	2800	3400	<b>NUP318M</b>
	190	43	3	3	113.5		274	315	2700	3300	<b>NJ318M/C4YA8</b>
	190	43	3	3		169.5	350	345	2800	3400	<b>N318EM</b>
	190	43	3	3	113.5		350	345	2800	3400	<b>NU318EM</b>
	190	43	3	3	113.5		350	345	2800	3400	<b>NU318ETN1</b>
	190	43	3	3		169.5	350	345	2800	3400	<b>N318E</b>
	190	43	3	3	113.5		350	345	2800	3400	<b>NJ318E</b>
	190	43	3	3	113.5		350	345	2800	3400	<b>NUP318E</b>
	190	43	3	3	113.5		350	345	2800	3400	<b>NU318E</b>
	190	43	3	3	113.5		350	345	2800	3400	<b>NH318EQ1/YB2</b>
	190	64	3	3	115		400	505	2800	3400	<b>NJ2318M/C4</b>
	190	64	3	3	115		400	505	2800	3400	<b>NUP2318M</b>
	190	64	3	3	113.5		480	520	2800	3400	<b>NJ2318E</b>
	190	64	3	3	113.5		480	520	2800	3400	<b>NU2318E</b>
225	54	4	4		191.5	430	480	2800	3400	<b>N418M</b>	
225	54	4	4	123.5		430	480	2800	3400	<b>NU418M</b>	
225	54	4	4	123.5		430	480	2800	3400	<b>NJ418M/C5</b>	
<b>95</b>	145	24	1.5	1.1	108		115	165	4500	5300	<b>NJ1019M</b>
	170	32	2.1	2.1	113.5	151.5	190	230	3400	4000	<b>N219M</b>
	170	32	2.1	2.1	113.5		190	230	3400	4000	<b>NU219M</b>
	170	32	2.1	2.1	113.5		190	230	3400	4000	<b>NU219M/W124</b>
	170	32	2.1	2.1	113.5		190	230	3400	4000	<b>NJ219M</b>

Abutment and fillet dimensions						Weight	Model	Weight	Separate thrust collar		
d <sub>amin</sub>	d <sub>amax</sub>	d <sub>bmin</sub>	D <sub>amax</sub>	D <sub>amin</sub>	r <sub>amax</sub>				r <sub>bmax</sub>	A1	A2
mm						kg	kg	mm			
100	105	110	150		2.5	2.5	3.12				
100	105	110	150		2.5	2.5	3.45				
104		117	149		2	2	3.59				
99	104	110	151		2	2	4.50				
95	105	110	151		1.5	1.5	4.50				
95	105	110	151		1.5	1.5	4.50				
95	105	110	151		1.5	1.5	4.50				
103		177		168	2.5	2.5	5.78				
103		177		168	2.5	2.5	6.21				
103	162		177	168	2.5	2.5	6.05				
103	112	118	177		2.5	2.5	6.06				
103	112	118	177		2.5	2.5	5.88				
103	110	127	177		2.5	2.5	6.19				
103		127	177		2.5	2.5	6.33				
103	110	127	177		2.5	2.5	6.37				
103	166		177	173	2.5	2.5	5.99				
103	110	116	177		2.5	2.5	5.9				
103	110	116	177		2.5	2.5	5.36				
103	166		177	173	2.5	2.5	5.93				
103	110	127	177		2.5	2.5	6.09				
103		127	177		2.5	2.5	6.05				
103	110	116	177		2.5	2.5	5.84				
103	110	127	177		2.5	2.5	6.64				
103	110	127	177		2.5	2.5	9.29				
103	110	127	177		2.5	2.5	9.36				
103	110	127	177		2.5	2.5	8.84				
103	110	118	177		2.5	2.5	8.69				
106	188		209	195	3	3	11.3				
106	120	126	209		3	3	11.5				
106	120	140	209		3	3	11.9				
101.5	104	116	137		1.5	1	1.53				
	106	149	159	157	2	2	3.07				
	106	110	116	159		2	3.13				
	106	110	116	159		2	3.13				
	106	110	116	159		2	3.13				
	106	110	123	159		2	3.23				