

UCF2 Normale Reihe - Нормальная серия

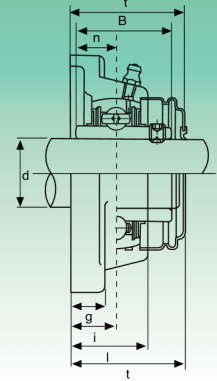

Typ Тип	Abmessungen - Размеры											Bef.Bolz. Креп. винт	Tragzahlen (N) Коэффициент нагрузки (H)		Lager Подшипник	Gehäuse Корпус	Gewicht Вес	
	d	a	e	i	g	l	s	z	t	B	n		dynamisch C Динамическая C	statisch C ₀ Статическая C ₀				kg
	mm/Zoll - мм/дюйм												mm/Zoll - мм/дюйм					
UCF201	12	86	64	15	12	25,5	12	33,3	37,5	31	12,7	M10	12160	6318	UC201	F204	0,60	
UCF201-8	3/4	33/8	233/64	19/32	15/32	1	15/32	15/16	131/64	1,2205	0,500	3/8					UC201-8	0,59
UCF202	15	86	64	15	12	25,5	12	33,3	37,5	31	12,7	M10	12160	6318	UC202	F204	0,59	
UCF202-9	9/16	33/8	233/64	19/32	15/32	1	15/32	15/16	131/64	1,2205	0,500	3/8					UC202-9	0,59
UCF202-10	5/8	33/8	233/64	19/32	15/32	1	15/32	15/16	131/64	1,2205	0,500	3/8	UC202-10	0,59				
UCF203	17	86	64	15	12	25,5	12	33,3	37,5	31	12,7	M10	12160	6318	UC203	F204	0,58	
UCF203-11	11/16	33/8	233/64	19/32	15/32	1	15/32	15/16	131/64	1,2205	0,500	3/8					UC203-11	0,57
UCF204	20	86	64	15	12	25,5	12	33,3	37,5	31	12,7	M10	12160	6318	UC204	F204	0,56	
UCF204-12	3/4	33/8	233/64	19/32	15/32	1	15/32	15/16	131/64	1,2205	0,500	3/8					UC204-12	0,56
UCF205	25	95	70	16	14	27	12	35,8	40	34,1	14,3	M10	13300	7457	UC205	F205	0,80	
UCF205-13	13/16																UC205-13	0,84
UCF205-14	7/8	3 3/4	2 3/4	5/8	35/64	11/16	15/32	113/32	19/16	1,3425	0,563	3/8					UC205-14	0,83
UCF205-15	15/16																UC205-15	0,81
UCF205-16	1																UC205-16	0,80
UCF206	30	108	83	18	14	31	12	40,2	44,5	38,1	15,9	M10	18525	10735	UC206	F206	1,12	
UCF206-17	11/16																UC206-17	1,15
UCF206-18	11/8	4 1/4	317/64	45/64	35/64	17/32	15/32	119/32	1 3/4	1,5000	0,626	3/8					UC206-18	1,14
UCF206-19	13/15																UC206-19	1,12
UCF206-20	1 1/4																UC206-20	1,11
UCF207	35	117	92	19	16	34	14	44,4	48,5	42,9	17,5	M12	24415	14630	UC207	F207	1,46	
UCF207-20	1 1/4																UC207-20	1,52
UCF207-21	15/16	439/64	35/8	3/4	5/8	111/32	35/64	1 3/4	129/32	1,6890	0,689	7/16					UC207-21	1,49
UCF207-22	13/8																UC207-22	1,46
UCF207-23	17/16																UC207-23	1,43
UCF208	40	130	102	21	16	36	16	51,2	55,5	49,2	19	M14	27645	16910	UC208	F208	1,84	
UCF208-24	1 1/2	51/8	41/64	53/64	5/8	127/64	5/8	21/64	23/16	1,9370	0,748	1/2					UC208-24	1,88
UCF208-25	19/16																UC208-25	1,85
UCF209	45	137	105	22	18	38	16	52,2	56,5	49,2	19	M14	32395	20235	UC209	F209	2,15	
UCF209-26	15/8																UC209-26	2,25
UCF209-27	111/16	513/32	49/64	55/64	23/32	1 1/2	5/8	21/16	27/32	1,9370	0,748	1/2					UC209-27	2,21
UCF209-28	1 3/4																UC209-28	2,17
UCF210	50	143	111	22	18	40	16	54,6	59,5	51,6	19	M14	33345	22135	UC210	F210	2,42	
UCF210-29	113/16																UC210-29	2,54
UCF210-30	17/8	55/8	43/8	55/64	23/32	19/16	5/8	25/32	211/32	2,0315	0,748	1/2					UC210-30	2,49
UCF210-31	115/16																UC210-31	2,44
UCF210-32	2												UC210-32	2,40				
UCF211	55	162	130	25	20	43	19	58,4	63	55,6	22,2	M16	41230	27930	UC211	F211	3,31	
UCF211-32	2																UC211-32	3,46
UCF211-33	21/16	63/8	51/8	63/64	25/32	111/16	3/4	15/16	231/64	2,1890	0,874	5/8					UC211-33	3,40
UCF211-34	21/8																UC211-34	3,35
UCF211-35	23/16																UC211-35	3,29
UCF212	60	175	143	29	20	48	19	68,7	73,5	65,1	25,4	M16	49780	34390	UC212	F212	4,28	
UCF212-36	2 1/4																UC212-36	4,41
UCF212-37	25/16	657/64	55/8	19/64	25/32	157/64	3/4	245/64	257/64	2,5630	1,000	5/8					UC212-37	4,33
UCF212-38	23/8																UC212-38	4,26
UCF212-39	27/16																UC212-39	4,19
UCF213	65	187	149	30	22	50	19	69,7	74,5	65,1	25,4	M16	54340	38095	UC213	F213	4,99	
UCF213-40	2 1/2	723/64	555/64	13/16	55/64	131/32	3/4	2 3/4	215/16	2,5630	1,000	5/8					UC213-40	5,08
UCF213-41	29/16																UC213-41	4,99
UCF214	70	193	152	31	22	54	19	75,4	81,5	74,6	30,2	M16	59090	41895	UC214	F214	5,85	
UCF214-42	25/8																UC214-42	6,06
UCF214-43	211/16	719/32	563/64	17/32	55/64	21/8	3/4	221/32	313/64	2,9370	1,189	5/8					UC214-43	5,96
UCF214-44	2 3/4																UC214-44	5,86
UCF215	75	200	159	34	22	56	19	78,5	83,5	77,8	33,3	M16	64030	45885	UC215	F215	6,91	
UCF215-45	213/16																UC215-45	7,16
UCF215-46	27/8	77/8	617/64	111/32	55/64	27/32	3/4	33/32	39/32	3,0630	1,311	5/8					UC215-46	7,05
UCF215-47	215/16																UC215-47	6,94
UCF215-48	3																UC215-48	6,82
UCF216	80	208	165	34	22	58	23	83,3	88,5	82,6	33,3	M20	69065	50350	UC216	F216	7,50	
UCF216-49	31/16																UC216-49	7,68
UCF216-50	31/8	83/16	6 1/2	111/32	55/64	29/32	29/32	39/32	339/64	3,2520	1,311	3/4					UC216-50	7,55
UCF216-51	33/16																UC216-51	7,42
UCF217	85	220	175	36	24	63	23	87,6	92,6	85,7	34,1	M20	79800	58805	UC217	F217	9,66	
UCF217-52	3 3/4																UC217-52	9,88
UCF217-53	35/6	821/33	657/64	127/64	15/16	215/32	29/32	37/16	341/64	3,3740	1,343	3/4					UC217-53	9,74
UCF217-55	37/16																UC217-55	9,45
UCF218	90	235	187	40	24	68	23	96,3	101,5	96	39,7	M20	91295	67925	UC218	F218	12,06	
UCF218-56	3 1/2	9 1/4	723/64	137/64	15/16	211/16	29/32	325/32	101,5	4	3,7795	1,5630					3/4	UC218-56

UCF3 Schwere Reihe - Тяжелая серия

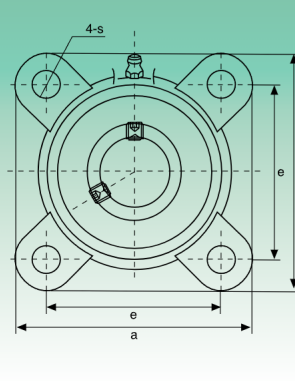
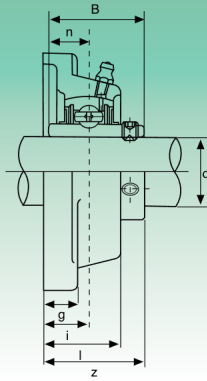
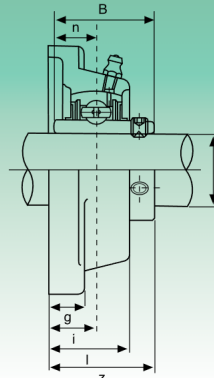
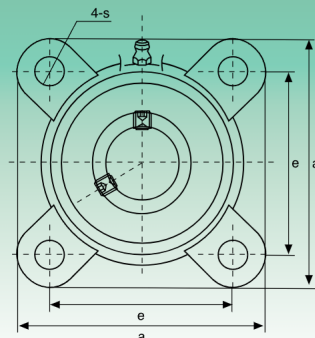

Typ Тип	Abmessungen - Размеры										Bef.Bolz. Креп. винт	Tragzahlen (N) Коэффициент нагрузки (H)		Lager Подшипник	Gehäuse Корпус	Gewicht Вес								
	d	a	e	i	g	l	s	z	B	n		dynamisch C Динамическая C	statisch C ₀ Статическая C ₀				kg							
mm/Zoll - мм/дюйм											mm/Zoll - мм/дюйм													
UCF305 UCF305-13 UCF305-14 UCF305-15 UCF305-16	25 13/16 7/8 15/16 1	110	80	16	13	29	16	39	38	15	M14	20140	10355	UC305 UC305-13 UC305-14 UC305-15 UC305-16	F305	1,1								
UCF306 UCF306-17 UCF306-18 UCF306-19	30 11/16 11/8 13/16	125	95	18	15	32	16	44	43	17	M14			25365			14250	UC306 UC306-17 UC306-18 UC306-19	F306	1,6				
UCF307 UCF307-20 UCF307-21 UCF307-22 UCF307-23	35 1 1/4 15/16 13/8 17/16	135	100	20	16	36	19	49	48	19	M16							31730			18335	UC307 UC307-20 UC307-21 UC307-22 UC307-23	F307	2
UCF308 UCF308-24 UCF308-25	40 1 1/2 19/16	150	112	23	17	40	19	56	52	19	M16											38665		
UCF309 UCF309-26 UCF309-27 UCF309-28	45 15/8 111/16 1 3/4	160	125	25	18	44	19	60	57	22	M16			46455			28025		UC309 UC309-26 UC309-27 UC309-28	F309				
UCF310 UCF310-29 UCF310-30 UCF310-31	50 113/16 17/8 115/16	175	132	28	19	48	23	67	61	22	M20	58900	36385		UC310 UC310-29 UC310-30 UC310-31	F310			4,5					
UCF311 UCF311-32 UCF311-33 UCF311-34 UCF311-35	55 2 21/16 21/8 23/16	185	140	30	20	52	23	71	66	25	M20				68020			42750			UC311 UC311-32 UC311-33 UC311-34 UC311-35	F311	5,5	
UCF312 UCF312-36 UCF312-37 UCF312-38 UCF312-39	60 2 1/4 25/16 23/8 27/16	195	150	33	22	56	23	78	71	26	M20			77805			49590			UC312 UC312-36 UC312-37 UC312-38 UC312-39	F312			6,5
UCF313 UCF313-40 UCF313-41	65 2 1/2 29/16	208	166	33	22	58	23	78	75	30	M20									88065				
UCF314 UCF314-42 UCF314-43 UCF314-44	70 25/8 211/16 2 3/4	226	178	36	25	61	25	81	78	33	M22	98800	64790		UC314 UC314-42 UC314-43 UC314-44	F314		9,5						
UCF315 UCF315-45 UCF315-46 UCF315-47 UCF315-48	75 213/16 27/8 215/16 3	236	184	39	25	66	25	89	82	32	M22				107350				73340	UC315 UC315-45 UC315-46 UC315-47 UC315-48		F315	12	
UCF316 UCF316-49 UCF316-50 UCF316-51	80 31/16 31/8 33/16	250	196	38	27	68	31	90	86	34	M27			116850			82365			UC316 UC316-49 UC316-50 UC316-51	F316			14
UCF317 UCF317-52 UCF317-53 UCF317-55	85 3 3/4 35/16 37/16	260	204	44	27	74	31	100	96	40	M27	126350	91960			UC317 UC317-52 UC317-53 UC317-55		F317		16				
UCF318 UCF318-55 UCF318-56	90 37/16 3 1/2	280	216	44	30	76	35	100	96	40	M30					135850								
UCF319 UCF319-58 UCF319-59 UCF319-60	95 35/8 311/16 3 3/4	290	228	59	30	94	35	121	103	41	M30			145350	113050		UC319 UC319-58 UC319-59 UC319-60		F319		22			
UCF320 UCF320-61 UCF320-62 UCF320-63 UCF320-64	100 313/16 37/8 315/16 4	310	242	59	32	94	38	125	108	42	M33					164350	133950					UC320 UC320-61 UC320-62 UC320-63 UC320-64	F320	25
UCF321	105	310	242	59	32	94	38	127	-	44	M33	174800	145350					UC321		F321		25,6		
UCF322	110	340	266	60	35	96	41	131	-	46	M36	194750	171000					UC322		F322		34,7		
UCF324	120	370	290	65	40	110	41	140	-	51	M36	196650	175750	UC324	F324	47,2								
UCF326	130	410	320	65	45	115	41	146	-	54	M36	217550	203300	UC326	F326	62,7								
UCF328	140	450	350	75	55	125	41	161	-	59	M36	240350	233700	UC328	F328	87,0								

UKF2 Normale Reihe - Нормальная серия

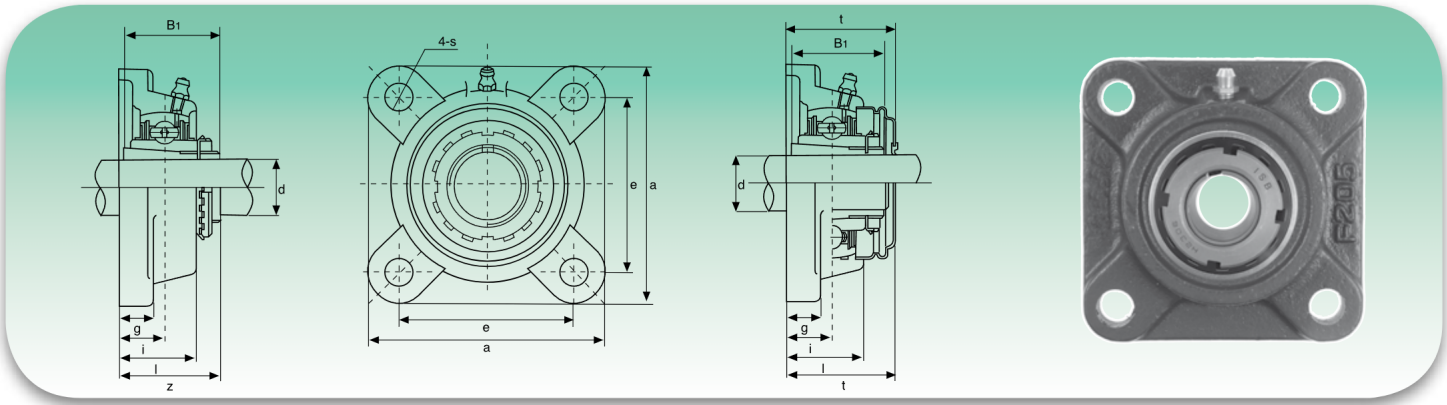

Typ Тун	Abmessungen - Размеры										Bef.Bolz. Креп. винт	Tragzahlen (N) Коэффициент нагрузки (H)		Lager Подшипник	Gehäuse Корпус	Gewicht Вес	
	d	a	e	i	g	l	s	z	t	B1		dynamisch C Динамическая C	statisch C ₀ Статическая C ₀				kg
	mm/Zoll - мм/дюйм											mm/Zoll - мм/дюйм					
UKF205+H2305	20	95	70	16	14	27	12	35,5	40	35	M10	13300	7457	UK205+H2305	F205	0,85	
UKF205+HE2305	¾	3¾	2¾	5/8	35/64	11/16	15/32	125/64	19/16	1,378	3/8			UK205+HE2305			
UKF206+H2306	25	108	83	18	14	31	12	39	44,5	38	M10	18525	10735	UK206+H2306	F206	1,16	
UKF206+HS2306	7/8	4¼	317/64	45/64	35/64	17/32	15/32	117/32	1¾	1,496	3/8			UK206+HS2306			
UKF206+HE2306	1													UK206+HE2306			
UKF207+H2307	30	117	92	19	16	34	14	42,5	48,5	43	M12	24415	14630	UK207+H2307	F207	1,55	
UKF207+HS2307	1 1/8	439/64	35/8	¾	5/8	111/32	35/64	143/64	129/32	1,693	7/16			UK207+HS2307			
UKF208+H2308	35	130	102	21	16	36	16	46,5	55,5	46	M14	27645	16910	UK208+H2308	F208	1,94	
UKF208+HE2308	1 ¼	51/8	41/64	53/64	5/8	127/64	5/8	153/64	23/16	1,811	½			UK208+HE2308			
UKF208+HS2308	1 3/8													UK208+HS2308			
UKF209+H2309	40	137	105	22	18	38	16	48,5	56,5	50	M14	32395	20235	UK209+H2309	F209	2,30	
UKF209+HA2309	17/16													UK209+HA2309			
UKF209+HE2309	1 ½	513/32	49/64	55/64	23/32	1 ½	5/8	129/32	27/32	1,969	½	UK209+HE2309					
UKF209+HS2309	1 5/8													UK209+HS2309			
UKF210+H2310	45	143	111	22	18	40	16	50	59,5	55	M14	33345	22135	UK210+H2310	F210	2,59	
UKF210+HS2310	15/8													UK210+HS2310			
UKF210+HA2310	1 11/16	55/8	43/8	55/64	23/32	19/16	5/8	131/32	211/32	2,165	½	UK210+HA2310					
UKF210+HE2310	1 ¾													UK210+HE2310			
UKF211+H2311	50	162	130	25	20	43	19	54,5	63	59	M16	41230	27930	UK211+H2311	F211	3,46	
UKF211+HS2311	17/8													UK211+HS2311			
UKF211+HA2311	1 11/16	63/8	51/8	63/64	25/32	111/16	¾	29/64	231/64	2,323	5/8	UK211+HA2311					
UKF211+HE2311	2													UK211+HE2311			
UKF212+H2312	55	175	143	29	20	48	19	61	73,5	62	M16	49780	34390	UK212+H2312	F212	4,33	
UKF212+HS2312	2 1/8	657/64	55/8	19/64	25/32	157/64	¾	219/32	257/64	2,441	5/8			UK212+HS2312			
UKF213+H2313	60	187	149	30	22	50	19	64	74,5	65	M16	54340	38095	UK213+H2313	F213	4,90	
UKF213+HA2313	23/16													UK213+HA2313			
UKF213+HE2313	2 ¼	723/64	555/64	13/16	55/64	131/32	¾	233/64	215/16	2,559	5/8	UK213+HE2313					
UKF213+HS2313	2 3/8													UK213+HS2313			
UKF215+H2315	65	200	159	34	22	56	19	71	83,5	73	M16	64030	45885	UK215+H2315	F215	7,02	
UKF215+HA2315	27/16													UK215+HA2315			
UKF215+HE2315	2 ½	77/8	617/64	111/32	55/64	27/32	¾	251/64	39/32	2,874	5/8	UK215+HE2315					
UKF216+H2316	70	208	165	34	22	58	23	73,5	88,5	78	M20	69065	50350	UK216+H2316	F216	7,76	
UKF216+HA2316	2 11/16													UK216+HA2316			
UKF216+HE2316	2 ¾	83/16	6 ½	111/32	55/64	29/32	29/32	257/64	331/64	3,071	¾	UK216+HE2316					
UKF217+H2317	75	220	175	36	24	63	23	77	92,6	82	M20	79800	58805	UK217+H2317	F217	10,08	
UKF217+HA2317	2 15/16													UK217+HA2317			
UKF217+HE2317	3	821/32	657/64	127/64	15/16	215/32	29/32	31/32	341/64	3,228	¾	UK217+HE2317					
UKF218+H2318	80	235	187	40	24	68	23	81,5	101,5	86	M20	91295	67925	UK218+H2318	F218	12,44	
UKF218+HA2318	3 3/16	9¼	723/64	137/64	15/16	211/16	29/32	313/64	4	3,386	¾			UK218+HA2318			

Hülsen HA; HE; HS mit Zollgewinde
Втулки HA; HE; HS с дюймовой резьбой

UKF3 Schwere Reihe - Тяжелая серия

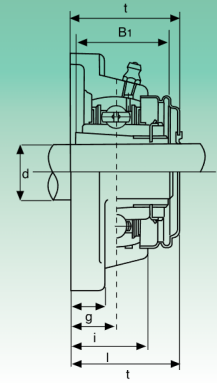
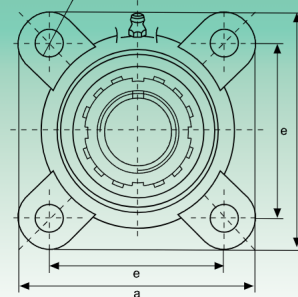
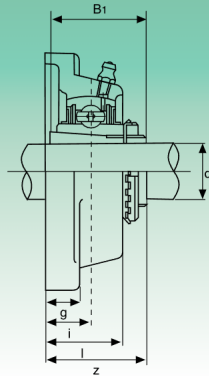

Typ Тун	Abmessungen - Размеры									Bef.Bolz. Крен. винт	Tragzahlen (N) Коэффициент нагрузки (H)		Lager Подшипник	Gehäuse Корпус	Gewicht Вес	
	d	a	e	i	g	l	s	z	B ₁		dynamisch C Динамическая C	statisch C ₀ Статическая C ₀				kg
	mm/Zoll - мм/дюйм										mm/Zoll - мм/дюйм					
UKF305+H2305 UKF305+HE2305	20 ¾	110 411/32	80 35/32	16 5/8	13 ½	29 15/32	16 5/8	37 129/64	35 1,378	M14 ½	20140	10355	UK305+H2305 UK305+HE2305	F305	1,4	
UKF306+H2306 UKF306+HS2306 UKF306+HE2306	25 7/8 1	125 429/32	95 347/64	18 45/64	15 19/32	32 1¼	16 5/8	40,5 219/32	38 1,496	M14 ½	25365	14250	UK306+H2306 UK306+HS2306 UK306+HE2306	F306	1,9	
UKF307+H2307 UKF307+HS2307	30 11/8	135 55/16	100 315/16	20 25/32	16 5/8	36 113/32	19 ¾	44,5 2¾	43 1,693	M16 5/8	31730	18335	UK307+H2307 UK307+HS2307	F307	2,3	
UKF308+H2308 UKF308+HE2308 UKF308+HS2308	35 1¼ 13/8	150 529/32	112 413/32	23 29/32	17 21/32	40 19/16	19 ¾	50 231/32	46 1,811	M16 5/8	38665	22800	UK308+H2308 UK308+HE2308 UK308+HS2308	F308	3,1	
UKF309+H2309 UKF309+HA2309 UKF309+HE2309 UKF309+HS2309	40 17/16 1½ 15/8	160 61/16	125 459/64	25 63/64	18 23/32	44 123/32	19 ¾	54,5 29/64	50 1,969	M16 5/8	46455	28025	UK309+H2309 UK309+HA2309 UK309+HE2309 UK309+HS2309	F309	4,1	
UKF310+H2310 UKF310+HS2310 UKF310+HA2310 UKF310+HE2310	45 15/8 111/16 1¾	175 67/8	132 513/64	28 17/64	19 ¾	48 17/8	23 29/32	60 223/64	55 2,165	M20 ¾	58900	36385	UK310+H2310 UK310+HS2310 UK310+HA2310 UK310+HE2310	F310	5,1	
UKF311+H2311 UKF311+HS2311 UKF311+HA2311 UKF311+HE2311	50 17/8 115/16 2	185 79/32	140 533/64	30 13/16	20 25/32	52 21/16	23 29/32	63,5 2½	59 2,323	M20 ¾	68020	42750	UK311+H2311 UK311+HS2311 UK311+HA2311 UK311+HE2311	F311	5,9	
UKF312+H2312 UKF312+HS2312	55 21/8	195 711/16	150 529/32	33 119/64	22 7/8	56 27/32	23 29/32	69 223/32	62 2,441	M20 ¾	77805	49590	UK312+H2312 UK312+HS2312	F312	6,8	
UKF313+H2313 UKF313+HA2313 UKF313+HE2313 UKF313+HS2313	60 23/16 2¼ 23/8	208 83/16	166 617/32	33 119/64	22 7/8	58 29/32	23 29/32	71 251/64	65 2,559	M20 ¾	88065	56905	UK313+H2313 UK313+HA2313 UK313+HE2313 UK313+HS2313	F313	7,9	
UKF315+H2315 UKF315+HA2315 UKF315+HE2315	65 27/16 2½	236 99/32	184 7¼	39 117/32	25 63/64	66 219/32	25 63/64	81 33/16	73 2,874	M22 7/8	107350	73340	UK315+H2315 UK315+HA2315 UK315+HE2315	F315	11,7	
UKF316+H2316 UKF316+HA2316 UKF316+HE2316	70 211/16 2¾	250 927/32	196 723/32	38 1½	27 11/16	68 211/16	31 17/32	83,5 39/32	78 3,071	M27 1	116850	82365	UK316+H2316 UK316+HA2316 UK316+HE2316	F316	12,9	
UKF317+H2317 UKF317+HA2317 UKF317+HS2317	75 215/16 3	260 10¼	204 81/32	44 147/64	27 11/16	74 229/32	31 35/8	92 35/8	82 3,228	M27 1	126350	91960	UK317+H2317 UK317+HA2317 UK317+HS2317	F317	15,2	
UKF318+H2318 UKF318+HA2318	80 33/16	280 111/32	216 8½	44 147/64	30 13/16	76 3	35 13/8	93,5 311/16	86 3,386	M30 11/8	135850	101650	UK318+H2318 UK318+HA2318	F318	19	
UKF319+H2319 UKF319+HA2319	85 35/16	290 1113/32	228 831/32	59 221/64	30 13/16	94 311/16	35 13/8	111 43/8	90 3,543	M30 11/8	145350	113050	UK319+H2319 UK319+HA2319	F319	21,9	
UKF320+H2320 UKF320+HA2320	90 37/16	310 127/32	242 917/32	59 221/64	32 1¼	94 311/16	38 1½	115 417/32	97 3,814	M33 1¼	164350	133950	UK320+H2320 UK320+HA2320	F320	25,4	
UKF322+H2322 UKF322+HA2322	100 315/16	340 133/8	266 1015/32	60 323/64	35 13/8	96 325/32	41 139/64	121 449/64	105 4,134	M36 13/8	194750	171000	UK322+H2322 UK322+HA2322	F322	35,2	
UKF324+H2324 UKF324+HA2324	110 43/16	370 165/32	290 1219/32	65 29/16	40 19/16	110 411/32	41 139/64	130 51/8	112 4,410	M36 13/8	196650	175750	UK324+H2324 UK324+HA2324	F324	47,6	
UKF326+H2326 UKF326+HA2326	115 47/16	410 165/32	320 1219/32	65 29/16	45 125/32	115 417/32	41 139/64	134 59/32	121 4,764	M36 13/8	217550	203300	UK326+H2326 UK326+HA2326	F326	65,3	
UKF328+H2328 UKF328+HA2328	125 415/16	450 1723/32	350 1325/32	75 261/64	55 25/32	125 429/32	41 139/64	148 553/64	131 5,158	M36 13/8	240350	233700	UK328+H2328 UK328+HA2328	F328	93,4	

Hülsen HA; HE; HS mit Zollgewinde
Втулки HA; HE; HS с дюймовой резьбой

UCFC2 Normale Reihe - Нормальная серия

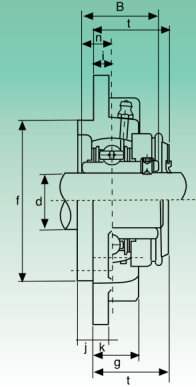
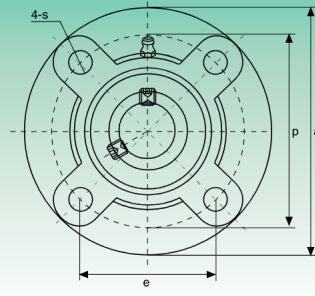
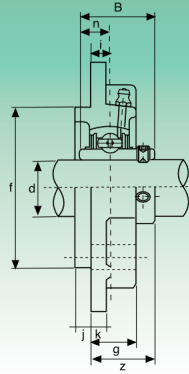

Typ Тун	Abmessungen - Размеры													Bef.Bolz. Креп. винт	Tragzahlen (N)		Lager Подшипник	Gehäuse Корпус	Gewicht Вес		
	d	a	p	e	i	s	j	k	g	f	z	t	B		n	dynamisch C				statisch C ₀	kg
	mm/Zoll - мм/дюйм														Динамическая C	Статическая C ₀					
UCFC201	12	100	78	55,1	10	12	5	7	20,5	62	28,3	32,5	31	12,7	M10	12160	6318	UC201	FC204	0,73	
UCFC201-8	3/4	315/16	35/64	211/64	25/64	15/32	13/64	9/32	13/16	2,4409	11/8	19/32	1,2205	0,500	3/8	12160	6318	UC201-8	FC204	0,72	
UCFC202	15	100	78	55,1	10	12	5	7	20,5	62	28,3	32,5	31	12,7	M10	12160	6318	UC202	FC204	0,72	
UCFC202-9	9/16	315/16	35/64	211/64	25/64	15/32	13/64	9/32	13/16	2,4409	11/8	19/32	1,2205	0,500	3/8	12160	6318	UC202-9	FC204	0,72	
UCFC202-10	5/8	315/16	35/64	211/64	25/64	15/32	13/64	9/32	13/16	2,4409	11/8	19/32	1,2205	0,500	3/8	12160	6318	UC202-10	FC204	0,72	
UCFC203	17	100	78	55,1	10	12	5	7	20,5	62	28,3	32,5	31	12,7	M10	12160	6318	UC203	FC204	0,71	
UCFC203-11	11/16	315/16	35/64	211/64	25/64	15/32	13/64	9/32	13/16	2,4409	11/8	19/32	1,2205	0,500	3/8	12160	6318	UC203-11	FC204	0,70	
UCFC204	20	100	78	55,1	10	12	5	7	20,5	62	28,3	32,5	31	12,7	M10	12160	6318	UC204	FC204	0,69	
UCFC204-12	3/4	315/16	35/64	211/64	25/64	15/32	13/64	9/32	13/16	2,4409	11/8	19/32	1,2205	0,500	3/8	12160	6318	UC204-12	FC204	0,69	
UCFC205	25	115	90	63,6	10	12	6	7	21	70	29,8	34	34,1	14,3	M10	13300	7457	UC205	FC205	1,00	
UCFC205-13	13/16	417/32	335/64	2 1/2	25/64	15/32	15/64	9/32	53/64	2,7559	111/64	111/32	1,3425	0,563	3/8	13300	7457	UC205-13	FC205	1,04	
UCFC205-14	7/8	417/32	335/64	2 1/2	25/64	15/32	15/64	9/32	53/64	2,7559	111/64	111/32	1,3425	0,563	3/8	13300	7457	UC205-14	FC205	1,03	
UCFC205-15	15/16	417/32	335/64	2 1/2	25/64	15/32	15/64	9/32	53/64	2,7559	111/64	111/32	1,3425	0,563	3/8	13300	7457	UC205-15	FC205	1,01	
UCFC205-16	1	417/32	335/64	2 1/2	25/64	15/32	15/64	9/32	53/64	2,7559	111/64	111/32	1,3425	0,563	3/8	13300	7457	UC205-16	FC205	1,00	
UCFC206	30	125	100	70,7	10	12	8	8	23	80	32,2	36,5	38,1	15,9	M10	18525	10735	UC206	FC206	1,30	
UCFC206-17	11/16	459/64	315/16	16225/32	25/64	15/32	5/16	5/16	29/32	3,1496	117/64	17/16	1,5000	0,626	3/8	18525	10735	UC206-17	FC206	1,31	
UCFC206-18	11/8	459/64	315/16	16225/32	25/64	15/32	5/16	5/16	29/32	3,1496	117/64	17/16	1,5000	0,626	3/8	18525	10735	UC206-18	FC206	1,32	
UCFC206-19	13/16	459/64	315/16	16225/32	25/64	15/32	5/16	5/16	29/32	3,1496	117/64	17/16	1,5000	0,626	3/8	18525	10735	UC206-19	FC206	1,30	
UCFC206-20	1 1/4	459/64	315/16	16225/32	25/64	15/32	5/16	5/16	29/32	3,1496	117/64	17/16	1,5000	0,626	3/8	18525	10735	UC206-20	FC206	1,29	
UCFC207	35	135	110	77,8	11	14	8	9	26	90	36,4	41	42,9	17,5	M12	24415	14630	UC207	FC207	1,81	
UCFC207-20	1 1/4	55/16	421/64	31/16	7/16	35/64	5/16	23/64	11/32	3,5433	17/16	15/8	1,6890	0,689	7/16	24415	14630	UC207-20	FC207	1,87	
UCFC207-21	15/16	55/16	421/64	31/16	7/16	35/64	5/16	23/64	11/32	3,5433	17/16	15/8	1,6890	0,689	7/16	24415	14630	UC207-21	FC207	1,84	
UCFC207-22	13/8	55/16	421/64	31/16	7/16	35/64	5/16	23/64	11/32	3,5433	17/16	15/8	1,6890	0,689	7/16	24415	14630	UC207-22	FC207	1,81	
UCFC207-23	17/16	55/16	421/64	31/16	7/16	35/64	5/16	23/64	11/32	3,5433	17/16	15/8	1,6890	0,689	7/16	24415	14630	UC207-23	FC207	1,78	
UCFC208	40	145	120	84,8	11	14	10	9	26	100	41,2	45,5	49,2	19	M12	27645	16910	UC208	FC208	2,14	
UCFC208-24	1 1/2	545/64	423/32	321/31/32	7/16	35/64	25/64	23/84	11/32	3,9370	15/8	151/64	1,9370	0,748	7/16	27645	16910	UC208-24	FC208	2,18	
UCFC208-25	19/6	545/64	423/32	321/31/32	7/16	35/64	25/64	23/84	11/32	3,9370	15/8	151/64	1,9370	0,748	7/16	27645	16910	UC208-25	FC208	2,15	
UCFC209	45	160	132	93,3	10	16	12	14	26	105	40,2	44,5	49,2	19	M14	32395	20235	UC209	FC209	2,68	
UCFC209-26	15/8	111/66	619/64	513/64	343/64	25/64	5/8	15/32	35/64	11/32	4,1339	137/64	1 3/4	1,9370	0,748	1/2	32395	20235	UC209-26	FC209	2,78
UCFC209-27	1 1/4	111/66	619/64	513/64	343/64	25/64	5/8	15/32	35/64	11/32	4,1339	137/64	1 3/4	1,9370	0,748	1/2	32395	20235	UC209-27	FC209	2,74
UCFC209-28	1 3/4	111/66	619/64	513/64	343/64	25/64	5/8	15/32	35/64	11/32	4,1339	137/64	1 3/4	1,9370	0,748	1/2	32395	20235	UC209-28	FC209	2,70
UCFC210	50	165	138	97,6	10	16	12	14	28	110	42,6	47,5	51,6	19	M14	33345	22135	UC210	FC210	2,90	
UCFC210-29	113/16	6 1/2	57/16	327/32	25/64	5/8	15/32	35/64	17/64	4,3307	11/16	17/8	2,0315	0,748	1/2	33345	22135	UC210-29	FC210	3,02	
UCFC210-30	17/8	6 1/2	57/16	327/32	25/64	5/8	15/32	35/64	17/64	4,3307	11/16	17/8	2,0315	0,748	1/2	33345	22135	UC210-30	FC210	2,97	
UCFC210-31	115/16	6 1/2	57/16	327/32	25/64	5/8	15/32	35/64	17/64	4,3307	11/16	17/8	2,0315	0,748	1/2	33345	22135	UC210-31	FC210	2,92	
UCFC210-32	2	6 1/2	57/16	327/32	25/64	5/8	15/32	35/64	17/64	4,3307	11/16	17/8	2,0315	0,748	1/2	33345	22135	UC210-32	FC210	2,88	
UCFC211	55	185	150	106,1	13	19	12	15	31	125	46,4	51	55,6	22,2	M16	41230	27930	UC211	FC211	4,01	
UCFC211-32	2	79/32	529/32	43/16	33/64	3/4	15/32	19/32	17/32	4,9213	153/64	21/64	2,1890	0,874	5/8	41230	27930	UC211-32	FC211	4,16	
UCFC211-33	21/8	79/32	529/32	43/16	33/64	3/4	15/32	19/32	17/32	4,9213	153/64	21/64	2,1890	0,874	5/8	41230	27930	UC211-33	FC211	4,10	
UCFC211-34	23/16	79/32	529/32	43/16	33/64	3/4	15/32	19/32	17/32	4,9213	153/64	21/64	2,1890	0,874	5/8	41230	27930	UC211-34	FC211	4,05	
UCFC211-35	23/16	79/32	529/32	43/16	33/64	3/4	15/32	19/32	17/32	4,9213	153/64	21/64	2,1890	0,874	5/8	41230	27930	UC211-35	FC211	3,99	
UCFC212	60	195	160	113,1	17	19	12	15	36	135	56,7	61,5	65,1	25,4	M16	49780	34390	UC212	FC212	4,94	
UCFC212-36	2 1/4	711/166	619/64	4429/64	43/64	3/4	15/32	19/32	127/64	5,3150	215/64	227/64	2,5630	1,000	5/8	49780	34390	UC212-36	FC212	5,07	
UCFC212-37	25/16	711/166	619/64	4429/64	43/64	3/4	15/32	19/32	127/64	5,3150	215/64	227/64	2,5630	1,000	5/8	49780	34390	UC212-37	FC212	4,99	
UCFC212-38	23/8	711/166	619/64	4429/64	43/64	3/4	15/32	19/32	127/64	5,3150	215/64	227/64	2,5630	1,000	5/8	49780	34390	UC212-38	FC212	4,92	
UCFC212-39	27/16	711/166	619/64	4429/64	43/64	3/4	15/32	19/32	127/64	5,3150	215/64	227/64	2,5630	1,000	5/8	49780	34390	UC212-39	FC212	4,85	
UCFC213	65	205	170	120,2	16	19	14	15	36	145	55,7	60,5	65,1	25,4	M16	54340	38095	UC213	FC213	5,65	
UCFC213-40	2 1/2	85/64	611/16	447/64	5/8	3/4	35/64	19/32	127/64	5,5118	13/16	225/64	2,5630	1,000	5/8	54340	38095	UC213-40	FC213	5,74	
UCFC213-41	29/16	85/64	611/16	447/64	5/8	3/4	35/64	19/32	127/64	5,5118	13/16	225/64	2,5630	1,000	5/8	54340	38095	UC213-41	FC213	5,65	
UCFC214	70	215	177	125,1	17	19	14	18	40	150	61,4	-	74,6	30,2	M16	59090	41895	UC214	FC214	6,95	
UCFC214-42	25/8	211/68	151/32	321/32	459/64	43/64	3/4	35/64	23/32	137/64	5,9055	113/32	-	2,9370	1,189	5/8	59090	41895	UC214-42	FC214	7,16
UCFC214-43	211/68	151/32	321/32	459/64	43/64	43/64	3/4	35/64	23/32	137/64	5,9055	113/32	-	2,9370	1,189	5/8	59090	41895	UC214-43	FC214	7,06
UCFC214-44	2 3/4	211/68	151/32	321/32	459/64	43/64	3/4	35/64	23/32	137/64	5,9055	113/32	-	2,9370	1,189	5/8	59090	41895	UC214-44	FC214	6,96
UCFC215	75	220	184	130,1	18	19	16	18	40	160	62,5	-	77,8	33,3	M16	64030	45885	UC215	FC215	7,56	
UCFC215-45	213/16	831/32	7 1/4	51/8	23/32	3/4	5/8	23/32	137/64	6,2992	215/32	-	3,0630	1,311	5/8	64030	45885	UC215-45	FC215	7,81	
UCFC215-46	27/8	831/32	7 1/4	51/8	23/32	3/4	5/8	23/32	137/64	6,2992	215/32	-	3,0630	1,311	5/8	64030	45885	UC215-46	FC215	7,70	
UCFC215-47	215/16	831/32	7 1/4	51/8	23/32	3/4	5/8	23/32	13												

UKFC2 Normale Reihe - Нормальная серия

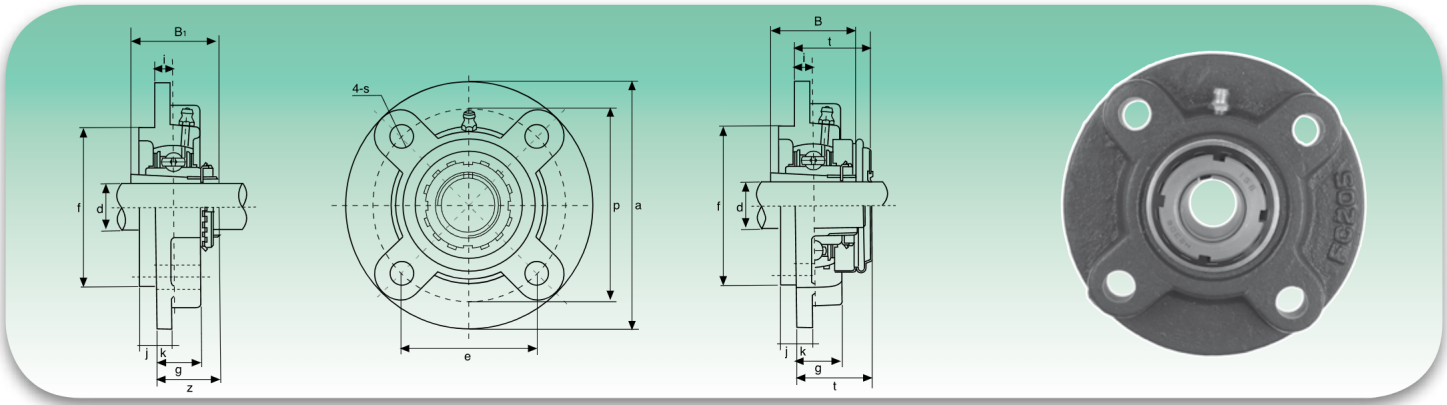

Typ Тип	Abmessungen - Размеры														Bef.Bolz. Креп. винт	Tragzahlen (N) Коэффициент нагрузки (H)		Lager Подшипник	Gehäuse Корпус	Gewicht Вес
	d	a	p	e	i	s	j	k	g	f	z	t	B ₁	dynamisch C Динамическая C		statisch C ₀ Статическая C ₀	kg			
	mm/Zoll - мм/дюйм															mm/Zoll - мм/дюйм				
UKFC205+H2305	20	115	90	63,6	10	12	6	7	21	70	29,5	34	35	M10	13300	7457	UK205+H2305	FC205	1,05	
UKFC205+HE2305	3/4	417/32	335/64	2 1/2	15/64	15/32	15/64	9/32	53/64	2,7559	15/32	111/32	1,378	3/8			UK205+HE2305			
UKFC206+H2306	25	125	100	70,7	10	12	8	8	23	80	31	36,5	38	M10	18525	10735	UK206+H2306	FC206	1,34	
UKFC206+HS2306	7/8																UK206+HS2306			
UKFC206+HE2306	1	459/64	315/16	225/32	25/64	15/32	5/16	5/16	29/32	3,1496	17/32	17/16	1,496	3/8			UK206+HE2306			
UKFC207+H2307	30	135	110	77,8	11	14	8	9	26	90	33,5	41	43	M12	24415	14630	UK207+H2307	FC207	1,90	
UKFC207+HS2307	11/8	55/6	421/64	31/16	7/16	35/64	5/16	23/64	11/32	3,5433	15/16	15/8	1,693	7/16			UK207+HS2307			
UKFC208+H2308	35	145	120	84,8	11	14	10	9	26	100	35,5	45,5	46	M12	27645	16910	UK208+H2308	FC208	2,24	
UKFC208+HE2308	1 1/4																UK208+HE2308			
UKFC208+HS2308	13/8	545/64	423/32	3211/32	7/16	35/64	25/64	23/64	11/32	3,9370	125/64	151/64	1,811	7/16			UK208+HS2308			
UKFC209+H2309	40	160	132	93,3	10	16	12	14	26	105	36	44,5	50	M14			UK209+H2309			
UKFC209+HA2309	17/16																UK209+HA2309			
UKFC209+HE2309	1 1/2	619/64	513/64	343/64	25/64	5/8	15/32	35/64	11/32	4,1339	127/64	1 3/4	1,969	1/2	32395	20235	UK209+HE2309	PFC209	2,83	
UKFC209+HS2309	15/8																UK209+HS2309			
UKFC210+H2310	45	165	138	97,6	10	16	12	14	28	110	37,5	47,5	55	M14			UK210+H2310			
UKFC210+HS2310	15/8																UK210+HS2310			
UKFC210+HA2310	111/16	6 1/2	57/16	327/32	25/64	5/8	15/32	35/64	17/64	4,3307	115/32	17/8	2,165	1/2	33345	22135	UK210+HA2310	FC210	3,07	
UKFC210+HE2310	1 3/4																UK210+HE2310			
UKFC211+H2311	50	185	150	106,1	13	19	12	15	31	125	41,5	51	59	M16			UK211+H2311			
UKFC211+HS2311	17/8																UK211+HS2311			
UKFC211+HA2311	115/16	79/32	529/32	43/16	33/64	3/4	15/32	19/32	17/32	4,9213	141/64	21/64	2,323	5/8	41230	27930	UK211+HA2311	FC211	4,16	
UKFC211+HE2311	2																UK211+HE2311			
UKFC212+H2312	55	195	160	113,1	17	19	12	15	36	135	48	61,5	62	M16			UK212+H2312			
UKFC212+HS2312	21/8	711/16	619/64	429/64	43/64	3/4	15/32	19/32	127/64	5,3150	157/64	227/64	2,441	5/8	49780	34390	UK212+HS2312	FC212	4,99	
UKFC213+H2313	60	205	170	120,2	16	19	14	15	36	145	49	60,5	65	M16			UK213+H2313			
UKFC213+HA2313	23/16																UK213+HA2313			
UKFC213+HE2313	2 1/4	85/64	611/16	447/64	5/8	3/4	35/64	19/32	127/64	5,5118	115/16	225/64	2,559	5/8	54340	38095	UK213+HE2313	FC213	5,56	
UKFC213+HS2313	23/8																UK213+HS2313			
UKFC215+H2315	65	220	184	130,1	18	19	16	18	40	160	53,5	-	73	M16			UK215+H2315			
UKFC215+HA2315	27/16																UK215+HA2315			
UKFC215+HE2315	2 1/2	821/32	7 1/4	51/8	23/32	3/4	5/8	23/32	137/64	6,2992	27/64	-	2,874	5/8	64030	45885	UK215+HE2315	FC215	7,67	
UKFC216+H2316	70	240	200	141,4	18	23	16	18	42	170	57	-	78	M20			UK216+H2316			
UKFC216+HA2316	211/16																UK216+HA2316			
UKFC216+HE2316	2 3/4	929/64	77/8	59/16	23/32	29/32	5/8	23/32	121/32	6,6929	2 1/4	-	3,071	3/4	69065	50350	UK216+HE2316	FC216	9,41	
UKFC217+H2317	75	250	208	147,1	18	23	18	20	45	180	59	-	82	M20			UK217+H2317			
UKFC217+HA2317	215/16																UK217+HA2317			
UKFC217+HE2317	3	927/32	83/16	551/64	23/32	29/32	23/32	25/32	125/32	7,0866	221/64	-	3,228	3/4	79800	58805	UK217+HE2317	FC217	11,23	
UKFC218+H2318	80	265	220	155,5	22	23	18	20	50	190	64,5	-	86	M20			UK218+H2318			
UKFC218+HA2318	33/16	107/16	821/32	61/8	55/64	29/32	23/32	25/32	131/32	7,4803	335/64	-	3,386	3/4	91295	67925	UK218+HA2318	FC218	13,34	

Hülsen HA; HE; HS mit Zollgewinde
Втулки HA; HE; HS с дюймовой резьбой

UCFL2 Normale Reihe - Нормальная серия

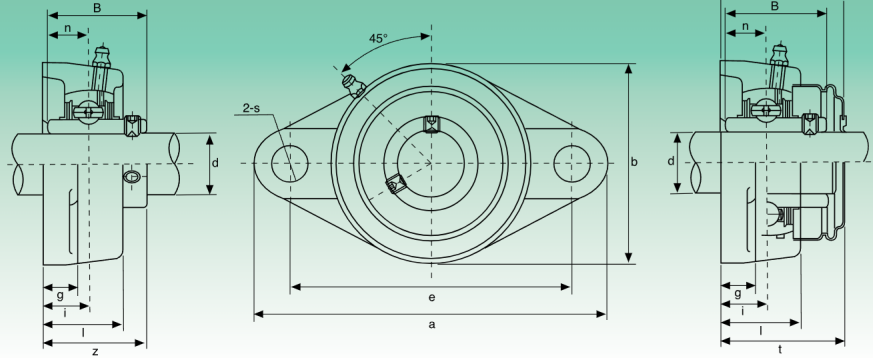

Typ Тун	Abmessungen - Размеры											Bef.Bolz. Креп. винт	Tragzahlen (N) Коэффициент нагрузки (H)		Lager Подшипник	Gehäuse Корпус	Gewicht Вес		
	d	a	e	i	g	l	s	b	z	t	B		n	dynamisch C Динамическая C				statisch C ₀ Статическая C ₀	kg
	mm/Zoll - мм/дюйм												mm/Zoll мм/дюйм						
UCFL201	12	113	90	15	11	25,5	12	60	33,3	37,5	31	12,7	M10	12160	6318	UC201	FL204	0,45	
UCFL201-8	3/4	47/16	335/64	19/32	7/16	1	15/32	23/8	15/16	131/64	1,2205	0,500	3/8	12160	6318	UC201-8	FL204	0,44	
UCFL202	15	113	90	15	11	25,5	12	60	33,3	37,5	31	12,7	M10	12160	6318	UC202	FL204	0,44	
UCFL202-9	9/16	47/16	335/64	19/32	7/16	1	15/32	23/8	15/16	131/64	1,2205	0,500	3/8	12160	6318	UC202-9	FL204	0,44	
UCFL202-10	5/8	47/16	335/64	19/32	7/16	1	15/32	23/8	15/16	131/64	1,2205	0,500	3/8	12160	6318	UC202-10	FL204	0,44	
UCFL203	17	113	90	15	11	25,5	12	60	33,3	37,5	31	12,7	M10	12160	6318	UC203	FL204	0,43	
UCFL203-11	11/16	47/16	335/64	19/32	7/16	1	15/32	23/8	15/16	131/64	1,2205	0,500	3/8	12160	6318	UC203-11	FL204	0,42	
UCFL204	20	113	90	15	11	25,5	12	60	33,3	37,5	31	12,7	M10	12160	6318	UC204	FL204	0,41	
UCFL204-12	3/4	47/16	335/64	19/32	7/16	1	15/32	23/8	15/16	131/64	1,2205	0,500	3/8	12160	6318	UC204-12	FL204	0,41	
UCFL205	25	130	99	16	13	27	16	68	35,8	40	34,1	14,3	M14	13300	7457	UC205	FL205	0,58	
UCFL205-13	13/16	51/8	357/64	5/8	1/2	11/16	5/8	211/16	113/32	19/16	1,3425	0,563	1/2	13300	7457	UC205-13	FL205	0,62	
UCFL205-14	7/8	51/8	357/64	5/8	1/2	11/16	5/8	211/16	113/32	19/16	1,3425	0,563	1/2	13300	7457	UC205-14	FL205	0,61	
UCFL205-15	15/16	51/8	357/64	5/8	1/2	11/16	5/8	211/16	113/32	19/16	1,3425	0,563	1/2	13300	7457	UC205-15	FL205	0,59	
UCFL205-16	1	51/8	357/64	5/8	1/2	11/16	5/8	211/16	113/32	19/16	1,3425	0,563	1/2	13300	7457	UC205-16	FL205	0,58	
UCFL206	30	148	117	18	13	31	16	80	40,2	44,5	38,1	15,9	M14	18525	10735	UC206	FL206	0,86	
UCFL206-17	11/16	513/16	439/64	45/64	1/2	17/32	5/8	35/32	119/32	1 3/4	1,5000	0,626	1/2	18525	10735	UC206-17	FL206	0,89	
UCFL206-18	11/8	513/16	439/64	45/64	1/2	17/32	5/8	35/32	119/32	1 3/4	1,5000	0,626	1/2	18525	10735	UC206-18	FL206	0,88	
UCFL206-19	13/16	513/16	439/64	45/64	1/2	17/32	5/8	35/32	119/32	1 3/4	1,5000	0,626	1/2	18525	10735	UC206-19	FL206	0,86	
UCFL206-20	1 1/4	513/16	439/64	45/64	1/2	17/32	5/8	35/32	119/32	1 3/4	1,5000	0,626	1/2	18525	10735	UC206-20	FL206	0,85	
UCFL207	35	161	130	19	14	34	16	90	44,4	48,5	42,9	17,5	M14	24415	14630	UC207	FL207	1,08	
UCFL207-20	1 1/4	611/32	51/8	3/4	35/64	113/32	5/8	335/64	1 3/4	129/32	1,6890	0,689	1/2	24415	14630	UC207-20	FL207	1,14	
UCFL207-21	15/16	611/32	51/8	3/4	35/64	113/32	5/8	335/64	1 3/4	129/32	1,6890	0,689	1/2	24415	14630	UC207-21	FL207	1,11	
UCFL207-22	13/8	611/32	51/8	3/4	35/64	113/32	5/8	335/64	1 3/4	129/32	1,6890	0,689	1/2	24415	14630	UC207-22	FL207	1,08	
UCFL207-23	17/16	611/32	51/8	3/4	35/64	113/32	5/8	335/64	1 3/4	129/32	1,6890	0,689	1/2	24415	14630	UC207-23	FL207	1,05	
UCFL208	40	175	144	21	14	36	16	100	51,2	55,5	49,2	19	M14	27645	16910	UC208	FL208	1,44	
UCFL208-24	1 1/2	67/8	543/64	53/64	35/64	113/32	5/8	315/16	21/64	23/16	1,9370	0,748	1/2	27645	16910	UC208-24	FL208	1,48	
UCFL208-25	19/16	67/8	543/64	53/64	35/64	113/32	5/8	315/16	21/64	23/16	1,9370	0,748	1/2	27645	16910	UC208-25	FL208	1,45	
UCFL209	45	188	148	22	15	38	19	108	52,2	56,5	49,2	19	M16	32395	20235	UC209	FL209	1,74	
UCFL209-26	15/8	713/32	553/64	55/64	19/32	1 1/2	3/4	4 1/4	21/16	27/32	1,9370	0,748	5/8	32395	20235	UC209-26	FL209	1,84	
UCFL209-27	111/16	713/32	553/64	55/64	19/32	1 1/2	3/4	4 1/4	21/16	27/32	1,9370	0,748	5/8	32395	20235	UC209-27	FL209	1,80	
UCFL209-28	1 3/4	713/32	553/64	55/64	19/32	1 1/2	3/4	4 1/4	21/16	27/32	1,9370	0,748	5/8	32395	20235	UC209-28	FL209	1,76	
UCFL210	50	197	157	22	15	40	19	115	54,6	59,5	51,6	19	M16	33345	22135	UC210	FL210	2,10	
UCFL210-29	113/16	7 3/4	63/16	55/64	19/32	137/64	3/4	417/32	25/32	211/32	2,0315	0,748	5/8	33345	22135	UC210-29	FL210	2,22	
UCFL210-30	17/8	7 3/4	63/16	55/64	19/32	137/64	3/4	417/32	25/32	211/32	2,0315	0,748	5/8	33345	22135	UC210-30	FL210	2,17	
UCFL210-31	115/16	7 3/4	63/16	55/64	19/32	137/64	3/4	417/32	25/32	211/32	2,0315	0,748	5/8	33345	22135	UC210-31	FL210	2,12	
UCFL210-32	2	7 3/4	63/16	55/64	19/32	137/64	3/4	417/32	25/32	211/32	2,0315	0,748	5/8	33345	22135	UC210-32	FL210	2,08	
UCFL211	55	224	184	25	18	43	19	130	58,4	63	55,6	22,2	M16	41230	27930	UC211	FL211	2,91	
UCFL211-32	2	813/16	7 1/4	63/64	23/32	111/16	3/4	51/6	25/16	215/32	2,1890	0,874	5/8	41230	27930	UC211-32	FL211	3,06	
UCFL211-33	21/16	813/16	7 1/4	63/64	23/32	111/16	3/4	51/6	25/16	215/32	2,1890	0,874	5/8	41230	27930	UC211-33	FL211	3,00	
UCFL211-34	21/8	813/16	7 1/4	63/64	23/32	111/16	3/4	51/6	25/16	215/32	2,1890	0,874	5/8	41230	27930	UC211-34	FL211	2,95	
UCFL211-35	23/16	813/16	7 1/4	63/64	23/32	111/16	3/4	51/6	25/16	215/32	2,1890	0,874	5/8	41230	27930	UC211-35	FL211	2,89	
UCFL212	60	250	202	29	18	48	23	140	68,7	73,5	65,1	25,4	M20	49780	34390	UC212	FL212	3,74	
UCFL212-36	2 1/4	927/32	761/64	19/64	23/32	17/8	29/32	5 1/2	223/32	257/64	2,5630	1,000	3/4	49780	34390	UC212-36	FL212	3,87	
UCFL212-37	25/16	927/32	761/64	19/64	23/32	17/8	29/32	5 1/2	223/32	257/64	2,5630	1,000	3/4	49780	34390	UC212-37	FL212	3,79	
UCFL212-38	23/8	927/32	761/64	19/64	23/32	17/8	29/32	5 1/2	223/32	257/64	2,5630	1,000	3/4	49780	34390	UC212-38	FL212	3,72	
UCFL212-39	27/16	927/32	761/64	19/64	23/32	17/8	29/32	5 1/2	223/32	257/64	2,5630	1,000	3/4	49780	34390	UC212-39	FL212	3,65	
UCFL213	65	258	210	30	22	50	23	155	69,7	74,5	65,1	25,4	M20	54340	38095	UC213	FL213	4,57	
UCFL213-40	2 1/2	105/32	817/64	13/16	7/8	131/32	29/32	63/32	2 3/4	215/16	2,5630	1,000	3/4	54340	38095	UC213-40	FL213	4,66	
UCFL213-41	29/16	105/32	817/64	13/16	7/8	131/32	29/32	63/32	2 3/4	215/16	2,5630	1,000	3/4	54340	38095	UC213-41	FL213	4,57	
UCFL214	70	265	216	31	22	54	23	160	75,4	-	74,6	30,2	M20	59090	41895	UC214	FL214	5,11	
UCFL214-42	25/8	107/16	8 1/2	17/32	7/8	21/8	29/32	65/16	231/32	-	2,9370	1,189	3/4	59090	41895	UC214-42	FL214	5,32	
UCFL214-43	211/16	107/16	8 1/2	17/32	7/8	21/8	29/32	65/16	231/32	-	2,9370	1,189	3/4	59090	41895	UC214-43	FL214	5,22	
UCFL214-44	2 3/4	107/16	8 1/2	17/32	7/8	21/8	29/32	65/16	231/32	-	2,9370	1,189	3/4	59090	41895	UC214-44	FL214	5,12	
UCFL215	75	275	225	34	22	56	23	165	78,5	-	77,8	33,3	M20	64030	45885	UC215	FL215	5,37	
UCFL215-45	213/16	1013/16	855/64	111/32	7/8	27/32	29/32	6 1/2	33/32	-	3,0630	1,311	3/4	64030	45885	UC215-45	FL215	5,62	
UCFL215-46	27/8	1013/16	855/64	111/32	7/8	27/32	29/32	6 1/2	33/32	-	3,0630	1,311	3/4	64030	45885	UC215-46	FL215	5,51	
UCFL215-47	215/16	1013/16	855/64	111/32	7/8	27/32	29/32	6 1/2	33/32	-	3,0630	1,311	3/4	64030	45885	UC215-47	FL215	5,40	
UCFL215-48	3	1013/16	855/64	111/32	7/8	27/32	29/32	6 1/2	33/32	-	3,0630	1,311	3/4	64030	45885	UC215-48	FL215	5,28	
UCFL216	80	290	233	34	22	58	25	180	83,3	-	82,6	33,3	M22	69065	50350	UC216	FL216	7,20	
UCFL216-49	31/16	1113/32	911/64	111/32	7/8	29/32	63/64	73/32	39/32	-	3,2520	1,311	7/8	69065	50350	UC216-49	FL216	7,38	
UCFL216-50	31/8	1113/32	911/64	111/32	7/8	29/32	63/64	73/32	39/32	-	3,2520	1,311	7/8	69065	50350	UC216-50	FL216	7,25	
UCFL216-51	31/16	1113/32	911/64	111/32	7/8	29/32	63/64	73/32	39/32	-	3,2520	1,311	7/8	69065	50350	UC216-51	FL216	7,12	
UCFL217	85	305	248	36	24	63	25	190	87,6	-	85,7	34,1	M22	79800	58805	UC217	FL217	8,61	
UCFL217-52	3 1/4	12	949/64	127/64	15/16	215/32	63/64	715/32	37/16	-									

UCFL3 Schwere Reihe - Тяжелая серия

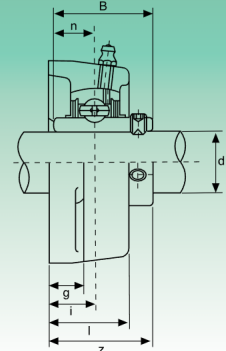
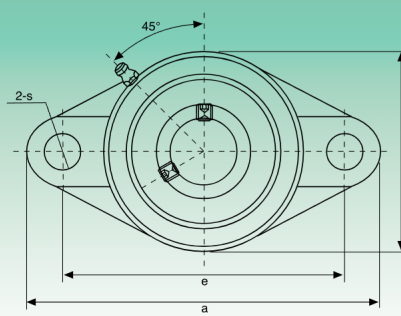

Typ Тип	Abmessungen - Размеры											Bef.Bolz. Креп. винт	Tragzahlen (N) Коэффициент нагрузки (H)		Lager Подшипник	Gehäuse Корпус	Gewicht Вес
	d	a	e	i	g	l	s	b	z	B	n		dynamisch C Динамическая C	statisch C ₀ Статическая C ₀			
mm/Zoll - мм/дюйм												mm/Zoll - мм/дюйм					
UCFL305	25	150	113	16	13	29	19	80	39	38	15	M16			UC305		
UCFL305-13	13/16														UC305-13		
UCFL305-14	7/8	529/32	47/16	5/8	1/2	15/32	3/4	35/32	117/32	1,4961	0,591	5/8	20140	10355	UC305-14	FL305	1,1
UCFL305-15	15/16														UC305-15		
UCFL305-16	1														UC305-16		
UCFL306	30	180	134	18	15	32	23	90	44	43	17	M20			UC306		
UCFL306-17	11/16														UC306-17		
UCFL306-18	11/8	73/32	59/32	45/64	19/32	1 1/4	29/32	317/32	147/64	1,6929	0,669	3/4	25365	14250	UC306-18	FL306	1,5
UCFL306-19	13/16														UC306-19		
UCFL307	35	185	141	20	16	36	23	100	49	48	19	M20			UC307		
UCFL307-20	1 1/4														UC307-20		
UCFL307-21	15/16	79/32	535/64	25/32	5/8	113/32	29/32	315/16	159/64	1,8898	0,748	3/4	31730	18335	UC307-21	FL307	1,9
UCFL307-22	13/8														UC307-22		
UCFL307-23	17/16														UC307-23		
UCFL308	40	200	158	23	17	40	23	112	56	52	19	M20			UC308		
UCFL308-24	1 1/2														UC308-24		
UCFL308-25	19/6	77/8	57/32	29/32	21/32	19/16	29/32	413/32	113/64	2,0472	0,748	3/4	38665	22800	UC308-25	FL308	2,5
UCFL309	45	230	177	25	18	44	25	125	60	57	22	M22			UC309		
UCFL309-26	15/8														UC309-26		
UCFL309-27	111/16	91/16	631/32	63/64	23/32	123/32	63/64	429/32	223/64	2,2441	0,866	7/8	46455	28025	UC309-27	FL309	3,4
UCFL309-28	1 3/4														UC309-28		
UCFL310	50	240	187	28	19	48	25	140	67	61	22	M22			UC310		
UCFL310-29	113/16														UC310-29		
UCFL310-30	17/8	97/16	723/64	17/64	3/4	17/8	63/64	5 1/2	241/64	2,4016	0,866	7/8	58900	36385	UC310-30	FL310	4,4
UCFL310-31	115/16														UC310-31		
UCFL311	55	250	198	30	20	52	25	150	71	66	25	M22			UC311		
UCFL311-32	2														UC311-32		
UCFL311-33	21/16	927/32	751/64	13/16	25/32	21/16	63/64	529/32	251/64	2,5984	0,984	7/8	68020	42750	UC311-33	FL311	5,1
UCFL311-34	21/8														UC311-34		
UCFL311-35	23/16														UC311-35		
UCFL312	60	270	212	33	22	56	31	160	78	71	26	M27			UC312		
UCFL312-36	2 1/4														UC312-36		
UCFL312-37	25/16	105/8	811/32	119/64	7/8	27/32	17/32	65/64	35/64	2,9753	1,024	1	77805	49590	UC312-37	FL312	6,1
UCFL312-38	23/8														UC312-38		
UCFL312-39	27/16														UC312-39		
UCFL313	65	295	240	33	25	58	31	175	78	75	30	M27			UC313		
UCFL313-40	2 1/2														UC313-40		
UCFL313-41	29/16	115/8	929/64	119/64	31/32	29/32	17/32	67/8	35/64	2,9528	1,181	1	88065	56905	UC313-41	FL313	7,8
UCFL314	70	315	250	36	28	61	35	185	81	78	33	M30			UC314		
UCFL314-42	25/8														UC314-42		
UCFL314-43	211/16	1213/32	927/32	127/64	13/32	213/32	13/8	79/32	33/16	3,0708	1,299	11/8	98800	64790	UC314-43	FL314	9,0
UCFL314-44	2 3/4														UC314-44		
UCFL315	75	320	260	39	30	66	35	195	89	82	32	M30			UC315		
UCFL315-45	213/16														UC315-45		
UCFL315-46	27/8	1219/32	1015/64	117/32	13/16	219/32	13/8	711/16	3 1/2	3,2283	1,260	11/8	107350	73340	UC315-46	FL315	10
UCFL315-47	215/16														UC315-47		
UCFL315-48	3														UC315-48		
UCFL316	80	355	285	38	32	68	38	210	90	86	34	M33			UC316		
UCFL316-49	31/16														UC316-49		
UCFL316-50	31/8	1331/32	117/32	1 1/2	1 1/4	211/16	1 1/2	89/32	335/64	3,3858	1,339	1 1/4	116850	82365	UC316-50	FL316	13
UCFL316-51	33/16														UC316-51		
UCFL317	85	370	300	44	32	74	38	220	100	96	40	M33			UC317		
UCFL317-52	3 1/4														UC317-52		
UCFL317-53	35/16	149/16	1113/14	147/64	1 1/4	229/32	1 1/2	821/32	315/16	3,7795	1,575	1 1/4	126350	91960	UC317-53	FL317	15
UCFL317-55	37/16														UC317-55		
UCFL318	90	385	315	44	36	76	38	235	100	96	40	M33			UC318		
UCFL318-55	37/16														UC318-55		
UCFL318-56	3 1/2	155/32	1213/32	147/64	113/32	3	1 1/2	9 1/4	315/16	3,7795	1,575	1 1/4	135850	101650	UC318-56	FL318	18
UCFL319	95	405	330	59	40	94	41	250	121	103	41	M36			UC319		
UCFL319-58	35/8														UC319-58		
UCFL319-59	311/16	1515/16	1263/64	221/64	19/16	311/16	139/64	927/32	449/64	4,0551	1,614	13/8	145350	113050	UC319-59	FL319	22
UCFL319-60	3 3/4														UC319-60		
UCFL320	100	440	360	59	40	94	44	270	125	108	42	M39			UC320		
UCFL320-61	313/16														UC320-61		
UCFL320-62	37/8	175/16	1411/64	221/64	19/16	311/16	147/64	105/8	459/64	4,2520	1,654	1 1/2	164350	133950	UC320-62	FL320	27
UCFL320-63	315/16														UC320-63		
UCFL320-64	4														UC320-64		
UCFL322	110	470	390	60	42	96	44	300	131	117	46	M39			UC322		
	-	18 1/2	1523/64	223/64	121/32	325/32	147/64	1113/16	55/32	4,6035	1,8110	1 1/2	194750	171000	UC322	FL322	33
UCFL324	120	520	430	65	48	110	47	330	140	126	51	M42			UC324		
	-	2015/32	1659/64	29/16	17/8	411/32	127/32	13	5 1/2	4,9606	2,0079	-	196650	175750	UC324	FL324	48
UCFL326	130	550	460	65	50	115	47	360	146	135	54	M42			UC326		
	-	2121/32	187/64	29/16	131/32	417/32	127/32	143/16	54/3	5,1350	2,1260	-	217550	203300	UC326	FL326	58
UCFL328	140	600	500	75	60	125	51	400	161	145	59	M45			UC328		
	-	235/8	1911/16	261/64	23/8	429/32	2	15 3/4	611/32	5,7086	2,3228	-	240350	233700	UC328	FL328	81

UKFL2 Normale Reihe - Нормальная серия

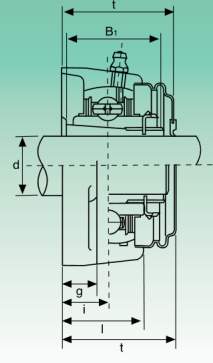
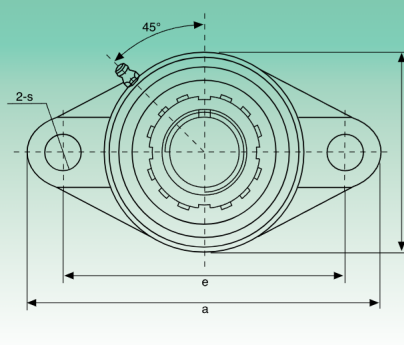
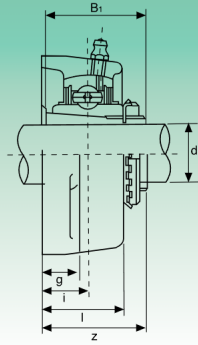

Typ Тип	Abmessungen - Размеры											Bef.Bolz. Креп. винт	Tragzahlen (N) Коэффициент нагрузки (H)		Lager Подшипник	Gehäuse Корпус	Gewicht Вес	
	d	a	e	i	g	l	s	b	z	t	B ₁		dynamisch C Динамическая C ₀	statisch C ₀ Статическая C ₀				kg
	mm/Zoll - мм/дюйм												mm/Zoll - мм/дюйм					
UKFL205+H2305	20	130	99	16	13	27	16	68	35,5	40	35	M14	13300	7457	UK205+H2305	FL205	0,63	
UKFL205+HE2305	¾	51/8	357/64	5/8	½	11/16	5/8	211/16	125/64	19/16	1,378	½						
UKFL206+H2306	25	148	117	18	13	31	16	80	39	44,5	38	M14	18525	10735	UK206+H2306	FL206	0,90	
UKFL206+HS2306	7/8	513/16	439/64	45/64	½	17/32	5/8	35/32	117/32	1¾	1,496	½						
UKFL206+HE2306	1																	
UKFL207+H2307	30	161	130	19	14	34	16	90	42,5	48,5	43	M14	24415	14630	UK207+H2307	FL207	1,17	
UKFL207+HS2307	11/8	611/32	51/8	¾	35/64	111/32	5/8	335/64	143/64	129/32	1,693	½						
UKFL208+H2308	35	175	144	21	14	36	16	100	46,5	55,5	46	M14	27645	16910	UK208+H2308	FL208	1,54	
UKFL208+HE2308	1¼	67/8	543/64	53/64	35/64	113/32	5/8	315/16	153/64	23/16	1,811	½						
UKFL208+HS2308	13/8																	
UKFL209+H2309	40	188	148	22	15	38	19	108	48,5	56,5	50	M16	32395	20235	UK209+H2309	FL209	1,89	
UKFL209+HA2309	17/16	713/32	553/64	55/64	19/32	1½	¾	4¾	129/32	27/32	1,969	5/8						
UKFL209+HE2309	1½																	
UKFL209+HS2309	15/8																	
UKFL210+H2310	45	197	157	22	15	40	19	115	50	59,5	55	M16	33345	22135	UK210+H2310	FL210	2,27	
UKFL210+HS2310	15/8	7¾	63/16	55/64	19/32	137/64	¾	417/32	131/32	211/32	2,165	5/8						
UKFL210+HA2310	111/16																	
UKFL210+HE2310	1¾																	
UKFL211+H2311	50	224	184	25	18	43	19	130	54,5	63	59	M16	41230	27930	UK211+H2311	FL211	3,06	
UKFL211+HS2311	17/8	813/16	7¼	63/64	23/32	111/16	¾	51/8	29/64	215/32	2,323	5/8						
UKFL211+HA2311	115/16																	
UKFL211+HE2311	2																	
UKFL212+H2312	55	250	202	29	18	48	23	140	61	73,5	62	M20	49780	34390	UK212+H2312	FL212	3,79	
UKFL212+HS2312	21/8	927/32	761/64	19/64	23/32	17/8	29/32	5½	213/32	257/64	2,441	¾						
UKFL213+H2313	60	258	210	30	22	50	23	155	64	74,5	65	M20	54340	38095	UK213+H2313	FL213	4,48	
UKFL213+HA2313	23/16	105/32	817/64	13/16	7/8	131/32	29/32	63/62	233/64	215/16	2,559	¾						
UKFL213+HE2313	2¼																	
UKFL213+HS2313	23/8																	
UKFL215+H2315	65	275	225	34	22	56	23	165	71	-	73	M20	64030	45885	UK215+H2315	FL215	5,48	
UKFL215+HA2315	27/16	1013/16	855/64	111/32	7/8	27/32	29/32	6½	251/64	-	2,874	¾						
UKFL215+HE2315	2½																	
UKFL216+H2316	70	290	233	34	22	58	25	180	73,5	-	78	M22	69065	50350	UK216+H2316	FL216	7,46	
UKFL216+HA2316	211/16	1113/32	911/64	111/32	7/8	29/32	63/64	73/32	257/64	-	3,071	7/8						
UKFL216+HE2316	2¾																	
UKFL217+H2317	75	305	248	36	24	63	25	190	77	-	82	M22	79800	58805	UK217+H2317	FL217	9,03	
UKFL217+HA2317	215/16	12	949/64	127/64	15/16	215/32	63/64	715/32	31/32	-	3,228	7/8						
UKFL217+HE2317	3																	
UKFL218+H2318	80	320	265	40	24	68	25	205	81,5	-	86	M22	91295	67925	UK218+H2318	FL218	10,89	
UKFL218+HA2318	33/16	1219/32	107/16	137/64	15/16	211/16	63/64	81/16	313/64	-	3,386	7/8						

Hülsen HA; HE; HS mit Zollgewinde
Втулки HA; HE; HS с дюймовой резьбой