

Single-row Cylindrical Roller Bearing

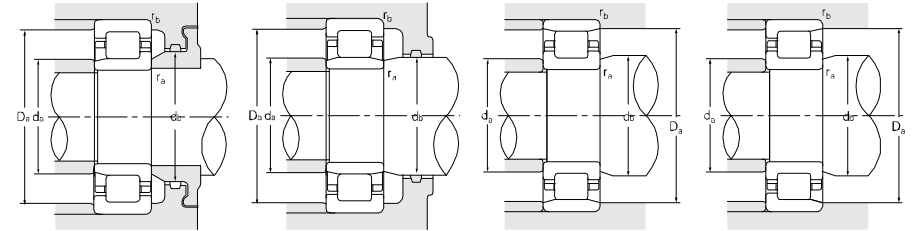

d 240~260 mm

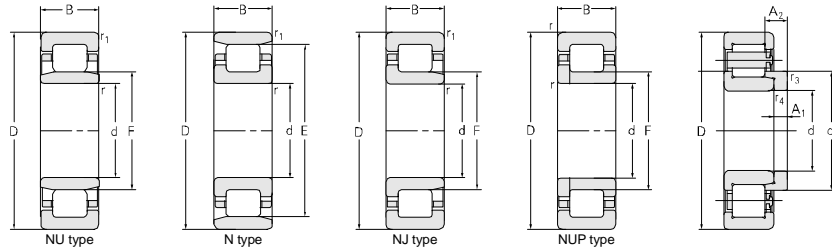

Principal dimensions						Basic load ratings		Limit speed ratings		Designations	
d	D	B	r _{1smin}	r _{smin}	F	E	C _r	C _{0r}	Grease		Oil
mm						kN		r/min			
240	360	56	3	3	270		512	775	1700	2000	NJ1048M
	360	56	3	3	270		545	855	1700	2000	NU1048Q1
	360	56	3	3	270		510	775	1700	2000	NU1048MA
	360	56	3	3	270		510	775	1700	2000	NU1048MA/P4
	390	108	4	4	278		1210	2060	1500	1800	NU2148X3M
	390	107.95	3	3	272.26		1400	2230	1500	1800	NUP2148X3M/C9YA1
	440	72	4	4	295		1050	1540	1300	1600	NU248M
	440	72	4	4	295		1050	1185	1690	1600	NU248EMA
	440	72	4	4	295		1050	1540	1300	1600	NJ248M
	440	72	4	4		385	1050	1540	1300	1600	N248M
	440	72	4	4		393	1180	1690	1300	1600	N248EM
	440	120	4	4	295		1490	2450	1200	1500	NU2248MA
	440	146	4	4	290		2240	3820	1100	1400	NU5248/P5
	500	95	5	5		430	1530	2120	1000	1300	N348M
	500	95	5	5	310		1530	2120	1000	1300	NU348M
	500	95	5	5	306		1670	2190	1000	1300	NU348EM
	500	155	5	5	310		2190	3360	950	1200	NU2348MA
	500	155	5	5	310		2190	3360	950	1200	NU2348M
500	155	5	5	303		2640	4000	950	1200	NU2348E/YA5	
250	308	50	6	2.3		347	655	1050	1800	2300	N650EM/HAC9
260	360	46	2.1	2.1		337	445	785	1600	1850	NF1952M
	360	75	3	3	285		740	1470	1600	1850	NUP3952M/C9W33YA8
	360	75	3	3	285		860	1780	1600	1850	NUP3952M/C9W33
	400	65	4	4		347	690	1090	1500	1800	NU1052M
	400	65	4	4	296		690	1090	1500	1800	NUP1052M
	400	65	4	4	296		690	1090	1500	1800	NJ1052M
	400	82	4	4	294		1080	1880	1300	1700	NU2052EM
	400	82	4	4	294		1090	1880	1300	1700	NU2052ENM
	400	104	4	4	290.5		1350	2340	1150	1450	NU3052M
	440	144	4	4	298.5		2050	3450	950	1250	NU3152M
	440	144	4	4	305		2090	3800	950	1250	NB3152M
	480	80	5	5	320		1220	1800	1100	1400	NU252M
	480	80	5	5	320		1370	1970	1100	1400	NU252EMA
	480	80	5	5	320		1220	1800	1050	1350	NJ252M

Abutment and fillet dimensions						Weight	Model	Weight	Separate thrust collar		
d _{amin}	d _{amax}	d _{bmin}	D _{amax}	D _{amin}	r _{amax}				r _{bmax}	A1	A2
mm						kg	kg	mm			
253	266	274	347		2.5	2.5	21.1				
253	266	274	347		2.5	2.5	21.2				
253	266	274	347		2.5	2.5	19.6				
253	266	274	347		2.5	2.5	19.6				
253	266	280	410		3	3	51.2				
253	266	280	410		2.5	2.5	50.5				
256	288	299	424		3	3	46.9				
256	288	299	424		3	3	51.3				
256	288	317	424		3	3	49.6				
256	288	317	424		3	3	49.1				
256	288	300	424		3	3	50.5				
256	284	299	423		3	3	84.8				
256	287	293	424		3	3	104				
260	426	480		434	4	4	96.3				
260	302	314	480		4	4	96.3				
260	296	313	480		4	4	94.9				
260	296	314	480		4	4	155				
260	296	314	480		4	4	154				
260	296	314	480		4	4	154				
268	343		368	351	5	2	21.4				
276	280	295	346		2	2	14.9				
274		287	346		2	2	24.5				
274		287	346		3	3	24.9				
276	291	300	384		3	3	30.2				
276		313	384		3	3	37.2				
276	291	300	384		3	3	36.3				
276	291	300	384		3	3	40.1				
276	291	300	384		3	3	40.1				
275	286	295	385		3	3	49.5				
277	295	302	423		3	3	98				
277	295	302	423		3	3	86.4				
280	313	324	460		4	4	67.1				
280	313	324	460		4	4	68.4				
280	313	324	460		4	4	68.5				

Single-row Cylindrical Roller Bearing

d 260~280 mm

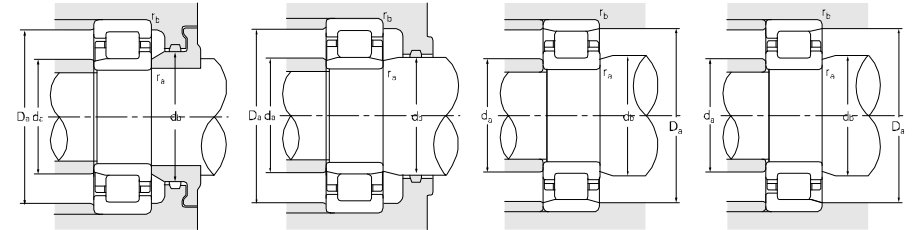
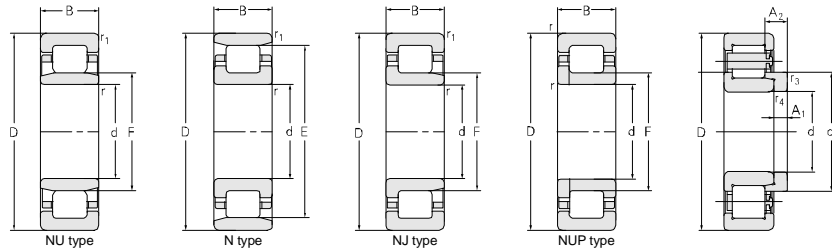

Principal dimensions						Basic load ratings		Limit speed ratings		Designations		
d	D	B	r _{1smin}	r _{smin}	F	E	C _r	C _{0r}	Grease		Oil	
mm						kN		r/min				
260	480	80	5	5	320		1220	1800	1050	1350	NJ252MA	
	480	80		5	320		1220	1800	1050	1350	NUP252M	
	480	80	5	5	317		1370	1970	1050	1350	NJ252EM/YA8	
	480	130	5	5	320		1780	2910	1000	1300	NU2252	
	480	130	5	5	320		1750	2910	1000	1300	NU2252MA	
	480	130	5	5		420	1780	2910	950	1250	N2252M	
	480	130	5	5	320		1780	2910	950	1250	NJ2252M	
	480	150	5	5	320		2100	3600	950	1250	NU2252X2M	
	540	102	6	6	336		1690	2290	850	1050	NU352M	
	540	165	6	6	319		3150	4500	850	1050	NU2352M	
	540	165	6	6	319		3200	4720	850	1050	NJD2352M/YA8	
	280	340	30	2	2		327	308	690	1800	2200	N1856X3M/HG2
		350	42	2	2	299		363	790	1800	2200	NJ2856M
		360	30	2	2	301		385	625	1700	1900	NJ1856X3M/HG2
360		30	2	2		341	385	625	1700	1900	N1856X3M/HG2P6-1	
380		46	2.1	2.1	306		473	865	1700	1900	NU1956M	
380		46	2.1	2.1		354	325	533	1700	1900	NF1956M	
420		65	4	4		384	700	1150	1400	1700	N1056M	
420		65	4	4	316		700	1150	1400	1700	NU1056M	
420		65	4	4	316		700	1150	1400	1700	NJ1056M	
420		82	4	4	314		1190	2170	1050	1300	NU2056M	
420		82	4	4	314		1110	1980	1050	1300	NU2056EMA	
440		135	3	3	318		1880	3400	1100	1400	NB4056X3M	
460		123.825	5	5	320.675		1900	3300	900	1150	NU2156X2M/YA4-1	
500		80	5	5	340		1100	1750	1150	1450	NJ256M	
500		80	5	5	340		1100	1750	1150	1450	NU256M	
500		80	5	5	440		1140	1700	1150	1450	N256M/SPC9W33	
500		130	5	5	333		2090	3270	1100	1400	NU2256E	
500		130	5	5	333		2080	3270	1100	1400	NU2256EF3	
500		130	5	5	333		2080	3270	1100	1400	NU2256EM	
500		130	5	5	333		2080	3270	1100	1400	NU2256EM-1	
500		165.1	5	5	333		2820	4900	950	1300	NU3256X2/C9YA1	
580		108	6	6	362		1880	2660	850	1000	NU356M	

Abutment and fillet dimensions								Weight	Model	Weight	Separate thrust collar		
d _{amin}	d _{amax}	d _{bmin}	D _{amax}	D _{amin}	r _{amax}	r _{bmax}					A1	A2	r _{3,4}
mm								kg	kg	mm			
280	313	324	460		4	4		68.3					
280	313	324	460		4	4		70					
280	313	324	460		4	4		68.8					
280	309	324	460		4	4		106					
280	309	324	460		4	4		107					
280	416	427	460		4	4		105					
280	309	324	460		4	4		108					
280	309	324	460		4	4		128					
286	330	341	514		5	5		120					
286	310	323	514		5	5		188					
286	310	323	514		5	5		165					
289		324	330	330	2	2		5.76					
289	309	324	330		2	2		9.15					
289	309	334	340		2	2		8.11					
289	309	340	340	330	2	2		8					
291	303	309	369		2	2		15.5					
291		340	308	308	2	2		16.9					
291		340	308	308	2	2		31.5					
296	380	411	388		3	3		30.9					
296	311	320	404		3	3		32.2					
296	311	332	404		3	3		39.5					
295	310	318	405		3	3		42					
295	310	318	405		3	3		75.4					
295	311	340	405		3	3		85.8					
296	316	325	424		3	3		71.5					
300	316	325	440		4	4		70					
300	333	364	480		4	4		70.2					
300	333	344	480		4	4		116					
300	350	480	480		4	4		116					
300	333	344	480		4	4		118					
300	333	344	480		4	4		118					
300	333	344	480		4	4		142					
300	333	344	480		4	4		147					
300	333	344	480		4	4		232					
306	347	366	554		5	5							

Single-row Cylindrical Roller Bearing



d 290~320 mm

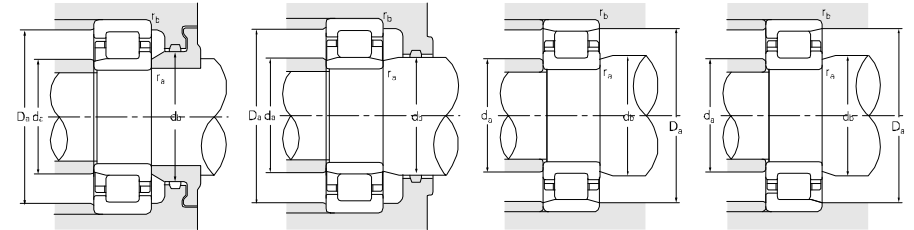
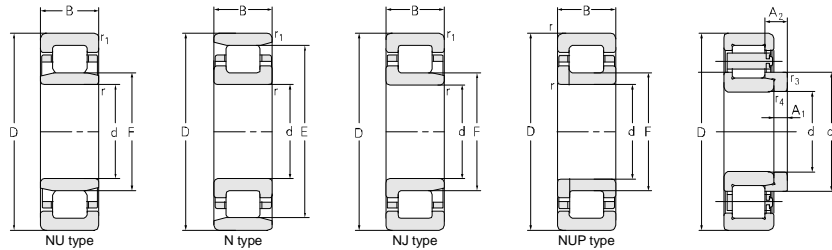

Principal dimensions						Basic load ratings		Limit speed ratings		Designations	
d	D	B	r _{1smin}	r _{smin}	F	E	C _r	C _{0r}	Grease		Oil
mm						kN		r/min			
290	420	65	4	4		389	730	1200	1300	1600	NFP10/290K
300	380	48	2.1	2.1		321	450	1000	1370	1650	NJ2860M
	380	48	2.1	2.1		321	450	1000	1370	1650	NU2860M
	380	60	2.1	2.1	360	468	990	1200	1500		N3860M/HG2
	420	90		3	328.5	1150	2250	1350	1600		NUP3960M/C9W33YA8
	420	90		3	328.5	1150	2250	1350	1600		NUP3960M/C9W33
	460	57	4	4	344	770	1250	1400	1700		NJ1060X2M
	460	74	4	4	340	935	1510	1200	1500		NJ1060M
	460	74	4	4	340	935	1510	1200	1500		NU1060M
	460	74	4	4	340	935	1510	1200	1500		NU1060M/HA
	460	95	4	4	341	1400	2510	980	1250		NU2060M
	460	95	4	4	341	1400	2510	980	1250		NU2060MA
	460	118	4	4	340	1470	2700	1200	1500		NU3060M
	540	85	5	5	364	1510	2270	1000	1300		NU260M
	540	140	5	5	364	2080	3450	1000	1200		NU2260M
620	109	7.5	7.5	385	2310	3300	900	1100		NU360M	
320	400	38	2.1	1.5	341	365	715	1270	1550		NU1864M
	400	48	2.1	1.5	341	490	1050	1250	1550		NU2864M
	440	56	3	3	350	638	1130	1100	1400		NU1964M
	440	56	3	3	350	670	1150	1100	1400		FL-NU1964EMA
	440	90		3	350	1060	2190	1100	1400		NUP3964M/C9
	480	74	4	4	360	960	1580	1100	1400		NJ1064M
	480	74	4	4	360	910	1490	1100	1400		NU1064M
	480	74	4	4	360	915	1490	1100	1400		NU1064MA
	480	74	4	4	360	957	1580	1100	1400		NU1064KM/C9
	480	74	4	4	360	910	1490	1100	1400		NUP1064M
	480	95	4	4	360	1380	2650	970	1250		NU2064M
	540	176	5	5	374	2780	5000	870	1050		NU3164M
	580	92	5	5	390	1620	2450	960	1200		NU264M
	580	150	5	5	390	2480	4150	900	1100		NU2264
	580	150	5	5	380	2700	4200	900	1100		NU2264EM
	580	170	5	5	390	2940	5200	900	1100		NU2264X2M-1

Abutment and fillet dimensions								Weight	Model	Weight	Separate thrust collar		
d _{amin}	d _{amax}	d _{bmin}	D _{amax}	D _{amin}	r _{amax}	r _{bmax}					A1	A2	r _{3,r4}
mm								kg	kg	mm			
305	320	332	404		3	3		33.2					
310	318	332	370		1.5	1.5		15.5					
310	318	324	370		1.5	1.5		14.5					
316	335		444	440	4	4		16.6					
314		333	406					41					
314		333	406					40.7					
316	335	358	444		3	3		36.5					
316	335	358	444		3	3		45.1					
316	335	344	444		3	3		44.1					
316	335	344	444		3	3		44.1					
317	336	345	443		3	3		60					
317	336	345	443		3	3		60					
316	335	344	444		3	3		72.5					
320	358	368	520		4	4		86.9					
320	352	368	520		4	4		146					
330	379	390	590		7	7		166					
327	337	345	389		2	1.5		11.3					
327	337	345	389		2	1.5		15					
335	346	354	425		2.5	2.5		24.7					
335	346	354	425		2.5	2.5		24.7					
334		354	426		2.5	2.5		45.8					
336	355	380	464		3	3		47.8					
336	355	364	464		3	3		48.2					
336	355	364	464		3	3		48.2					
336	355	364	464		3	3		46.3					
336	355	380	464		3	3		49.1					
335	357	364	465		3	3		63					
367	369	387	490		4	4		172					
340	383	394	560		4	4		112					
340	377	394	560		4	4		181					
340	377	394	560		4	4		181					
340	377	394	560		4	4		212					

Single-row Cylindrical Roller Bearing



d 320~360 mm

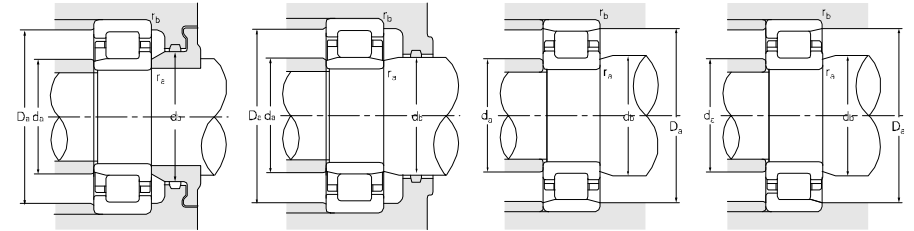
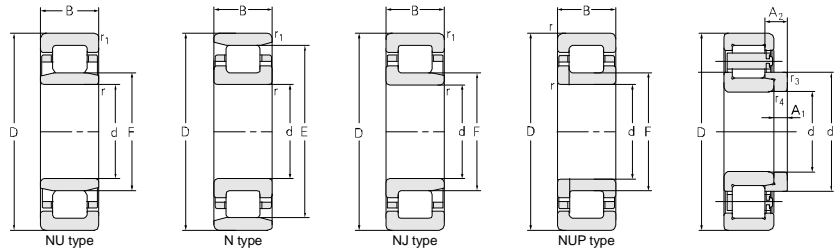

Principal dimensions						Basic load ratings		Limit speed ratings		Designations	
d	D	B	r _{1smin}	r _{smin}	F	E	C _r	C _{0r}	Grease		Oil
mm						kN		r/min			
320	580	190.5	5	5	390		3050	5480	900	1100	NU2264X2M
	580	150	5	5	377		3190	4720	900	1100	NUD2264M/YA8
	670	200	7.5	7.5	410		4590	7200	1100	1400	NU2364/HCR
	670	200	7.5	7.5	410		4150	6500	1100	1400	NU2364F1/HC
330	580	151	6	6	395		2750	4800	900	1100	NU666/HCYA8
340	420	48	2.1	2.1	361		490	1150	1150	1450	NJ2868M
	440	56	3	3	365		690	1380	1050	1350	NU1968X1M
	440	56	3	3	365		690	1380	1050	1350	NJ1968X1M
	460	56	3	3	370		700	1400	1050	1350	NU1968M
	460	72	3	3	373		785	1650	1050	1350	NU2968M
	520	82	5	5	385		1130	1910	1000	1300	NU1068M
	520	82	5	5	385		1130	1830	1000	1300	NJ1068M
	580	190	5	5	399		3300	5900	760	910	NU3168E
	580	190	5	5	400		3550	6650	760	910	NU3168
	580	200	5	5	400		3550	6650	760	910	NU3168WB
	580	190	5	5	399		3300	5900	760	910	NU3168EF3
	620	165	6	6	416		2950	4900	810	950	NU2268
	620	165	6	6	416		2950	4900	810	950	NU2268MA
	620	165	6	6	416		2950	4900	810	950	NU2268F3
	620	224	6	6	410		4600	8600	810	950	NU3268
	360	480	72	3	3	388		1220	2300	1100	1300
480		72	3	3	388		1110	2300	1100	1300	NF2972EM
480		72	3	3	388		1110	2300	1100	1300	NU2972E
480		90	3	3	388		1220	2590	1100	1300	NUP3972M/C9W33YA8
480		90	3	3	388		1220	2590	1100	1300	NUP3972M/C9W33
540		82	5	5	495		1180	2000	980	1280	N1072M/C9W33A
540		82	5	5	405		1190	2000	980	1280	NU1072MA
540		82	5	5	405		1190	2000	980	1280	NU1072M
540		82	5	5	499		1180	2000	980	1280	NF1072M
540		106	5	5	405		1890	3560	870	1050	NU2072M
540		134	5	5	405		2060	4050	800	1000	NU3072M
600		192	5	5	420		3520	6500	900	1000	NU3172

Abutment and fillet dimensions						Weight	Model	Weight	Separate thrust collar		
d _{amin}	d _{amax}	d _{bmin}	D _{amax}	D _{amin}	r _{amax}				r _{bmax}	A1	A2
mm						kg	kg	mm			
340	377	394	560		4	4	232				
340	377	394	560		4	4	151				
360	377	390	642		7	7	349				
360	377	390	642		7	7	349				
350	387	411	560		5	5	177				
350	357	372	410		2	2	15.5				
348	355	366	427		2.5	2.5	22.3				
					2.5	2.5	22.7				
353	365	374	447		2.5	2.5	28.3				
353	369	377	447		2.5	2.5	36.2				
360	380	389	500		4	4	65.0				
360	380	389	500		4	4	64.7				
360	388	403	560		4	4	211				
360	388	403	560		4	4	211				
360	388	403	560		4	4	213				
360	388	403	560		4	4	211				
366	401	421	594		5	5	229				
366	401	421	594		5	5	230				
366	401	421	594		5	5	229				
366	401	421	594		5	5	307				
380	400	380	464		2.5	2.5	38.1				
380	400	380	464		2.5	2.5	37.6				
380	400	380	464		2.5	2.5	37.4				
380		380	464		2.5	2.5	47.7				
380		380	464		2.5	2.5	51.3				
378		410	522	508	4	4	65.2				
378	400	410	522		4	4	66.2	HJ1072	7.7	21	
378	400	410	522		4	4	65.9	HJ1072	7.7	21	
378	400	410	522		4	4	67.7			39.03	
380	399	410	520		4	4	89.5			5	
381	400	410	520		4	4	112				
373	417		587	423	4	4	219				

Single-row Cylindrical Roller Bearing



d 360~400 mm

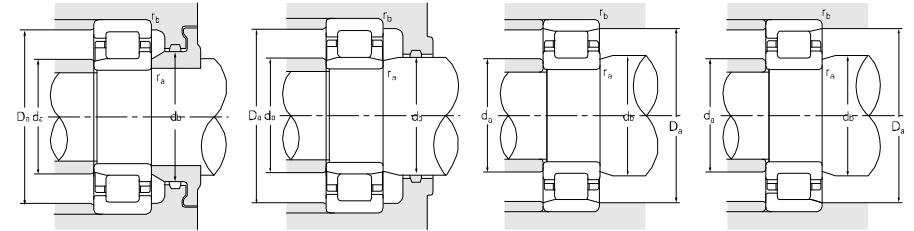
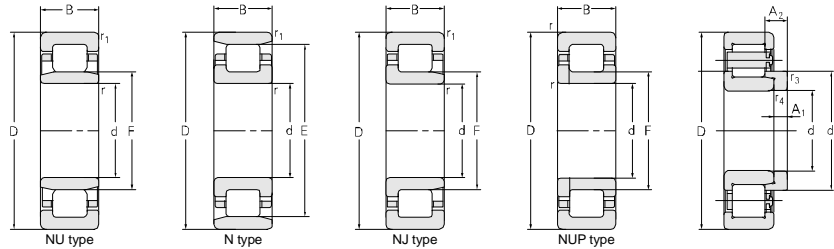

Principal dimensions						Basic load ratings		Limit speed ratings		Designations	
d	D	B	r _{1smin}	r _{smin}	F	E	C _r	C _{0r}	Grease		Oil
mm						kN		r/min			
360	650	170	6	6	437		3150	5400	800	950	NU2272M
	650	232	6	6	435		4400	8050	800	950	NU3272M/HC
	750	224	7.5	7.5	455		5390	8650	700	850	NU2372
	750	224	7.5	7.5	455		4900	7600	700	850	NUP2372M
379.5	480	60	2.1	2.1	454		550	680	900	1180	N2876K/P69
	480	60	2.1	2.1	454		550	680	900	1180	N2876/P69
	480	60	2.1	2.1	406		550	680	900	1180	NUP2876K/P69
380	480	60	2.1	2.1	406		550	680	900	1180	N2876/P69
	480	46	2.1	2.1	406		525	1050	950	1250	NU1876M
	480	46	2.1	2.1	406		525	1050	950	1250	NUP1876M
	520	82	4	4			1180	2540	920	1200	N2976M
	560	82	5	5	425		1220	2090	950	1200	NU1076M
	560	106	5	5	425		1930	3750	800	950	NU2076EM
	560	135	5	5	425		2250	4700	800	950	NU3076EM
	680	175	6	6	462		3050	5500	730	860	NU2276EM
	680	175	6	6	462		2860	5400	730	860	NU2276MA
	680	175	7.5	7.5	462		2860	5400	730	860	NU2276MA/YA36
	680	240	6	6	458		5860	9290	730	860	NU3276/HC
	400	500	46	2.1	2.1	423		565	1150	980	1250
500		75	2.1	2.1	425		855	2010	980	1250	NU3880Q1
540		65	4	4	435		900	1750	900	1150	NU1980M
540		65	4	4	435		1000	1850	900	1150	NU1980
540		82	4	4	435		1350	2850	900	1150	NU2980EM
540		82	4	4	435		1340	2780	900	1150	FL-NJ2980/HCEC9
540		82	4	4	438		1250	2510	900	1150	NU2980M
540		82	4	4	438		1250	2510	900	1150	NF2980M
600		90	5	5	450	506	1450	2470	900	1100	NUP1080M
600		90	5	5	450		1450	2470	900	1100	NU1080M
600		90	5	5	450		1330	2210	900	1100	NU1080MA
600		90	5	5	450		1450	2480	900	1100	NJ1080
600		118	5	5	449		2150	4800	750	900	NU2080EM
600		148	5	5	450		2330	4550	900	1100	NU3080M

Abutment and fillet dimensions						Weight	Model	Weight	Separate thrust collar		
d _{amin}	d _{amax}	d _{bmin}	D _{amax}	D _{amin}	r _{amax}				r _{bmax}	A1	A2
mm						kg	kg	mm			
386	428	442	624		5	5		262			
381	400	410	520		5	5		352			
390	445	460	720		7	7		480			
390	445	460	720		7	7		513			
391		406	468	463	2	2		26.0			
391		406	468	463	2	2		25.9			
391		406	468		2	2		27.1			
390	401	410	470		2	2		25.9			
390	401	410	470		2	2		23.5			
390	401	410	470		2	2		24			
400	419	428	490		3	3		82.8			
400	420	430	540		4	4		71.0	HJ1076	8.48	21 39.03 5
398	422	430	542		4	4		93			
398	417	430	542		4	4		116			
406	443	443	654		5	5		276			
406	443	443	654		5	5		289			
406	443	443	654		7	7		289			
406	435	435	654		5	5		383			
410	419	428	490		2	2		21.2			
410	419	428	490		2	2		33.4			
415	429	439	525		3	3		42			
415	429	439	525		3	3		41.7			
415	429	439	525		3	3		57.8			
415	429	439	525		3	3		56.2			
415	434	442	525		3	3		55.2			
415	434	442	525		3	3		52.6			
420	446	455	580		4	4		93.6			
420	446	455	580		4	4		92.5			
420	446	455	580		4	4		93			
420	446	472	580		4	4		90.6			
418	446	454	582		4	4		122			
420	446	455	580		4	4		153			

Single-row Cylindrical Roller Bearing

d 400~445 mm

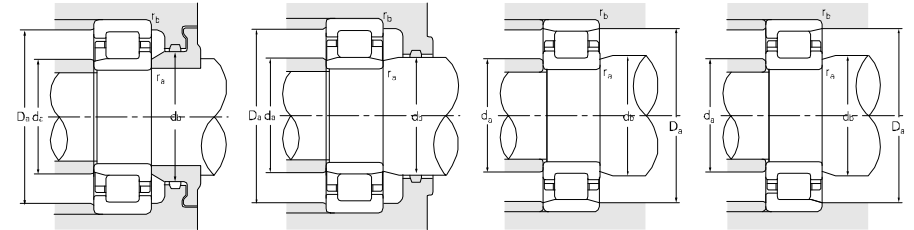
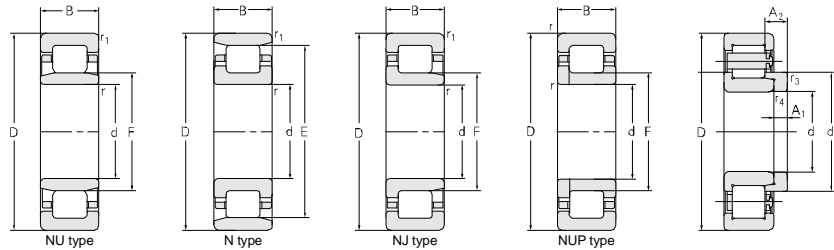

Principal dimensions						Basic load ratings		Limit speed ratings		Designations	
d	D	B	r _{1smin}	r _{smin}	F	E	C _r	C _{0r}	Grease		Oil
mm						kN		r/min			
400	650	145	6	6	460		2920	5190	700	850	NU2180M
	650	200	6	6	460		3760	7170	700	850	NU3180M
406	502	76	2	2		481	1130	2660	1000	1200	NF6/406/C9W33
406.362	501.688	76.2	3	3		481.33	1050	2550	1000	1200	N6/406X4M/C9W520
420	520	46	2.1	2.1	447		605	1270	900	1100	NU1884
	520	46		2.1	447		605	1270	900	1100	NUP1884
	520	46	2.1	2.1	447		605	1270	900	1100	NU1884M
	520	75		2.1	447		900	2250	930	1150	NJ3884M
	560	65	4	4		528	1080	2010	930	1150	NF1984F3
	560	65	4	4	449		1080	1950	930	1150	NJ1984MA
	560	82	4	4	458		1290	2800	930	1150	NU2984M
	560	82	4	4	458		1290	2800	930	1150	NJ2984
	560	106	4	4	458		1550	3700	930	1150	NUP3984M/C9W33
	580	130	4	4	468		1790	4660	930	1150	NU684ZWF1/C9YA3
	620	90	5	5	470		1440	2490	900	1100	NU1084M/C3
	620	118	5	5	469		2400	4750	770	950	NU2084EM
	700	224	6	6	485		4950	8950	650	780	NU3184EM
	760	280	7.5	7.5	507		6800	13400	560	700	NU3284X2/HCYA3
	440	600	74	4	4	482		1010	1980	870	1050
600		74	4		482		1030	1900	870	1050	NJ1988M
600		95	4	4	481.5		1670	3550	870	1050	NJ2988EM
600		118		4	481.5		1940	4250	850	1000	NUP3988EM
650		94	6	6	493		1570	2430	850	1000	NU1088M
650		94		6	493		1570	2430	850	1000	NJ1088M
650		122	6	6	487		2450	5000	670	820	NU2088EM
720		122		6	6	648	2850	4300	800	950	N1188
720		226	6	6	508			5230	9800	600	750
790		255	7.5	7.5	530		5760	10700	650	800	NU3288X2/HC
445		815	210	7.5	7.5	539		4800	7950	750	1100

Abutment and fillet dimensions								Weight	Model	Weight	Separate thrust collar		
d _{amin}	d _{amax}	d _{bmin}	D _{amax}	D _{amin}	r _{amax}	r _{bmax}					A1	A2	r _{3,4}
mm								kg	kg	mm			
420	450	460	590		4	4		197					
420	450	460	590		4	4		274					
420			490	470	2	2		31.2					
418		432	491	489	2.5	2.5		34.1					
440	466	380	500		2	2		20.7					
440	466	380	500		2	2		23.7					
440	466	380	500		2	2		22.7					
427	441	462	510		2	2		33.3					
435	523		530	533	3	3		45.2					
435	442	466	545		3	3		46					
435	452	463	545		3	3		58.1					
435	452	463	545		3	3		59.5					
435		463	545		3	3		78.7					
435	452	463	567	558	3	3		110					
440	466	475	600		4	4		98.0					
438	466	474	602		4	4		127					
446	478	490	694		5	5		368					
446	478	490	730		6	6		577					
455	477	487	585		3	3		65					
455	477	487	585		3	3		61.4					
455	477	500	585		3	3		83.5					
455		483	585		3	3		106					
466	488	498	624		5	5		102	HJ1088	12.8	24	44.47	6
466	488	498	624		5	5		106	HJ1088	12.8	24	44.47	6
463	483	492	627		5	5		146					
466	488		690	670	5	5		207					
460	498	518	700		5	5		374					
468	498	510	762		6	6		583					
478	535	560	770		6	6		501					

Single-row Cylindrical Roller Bearing



d 452~480 mm

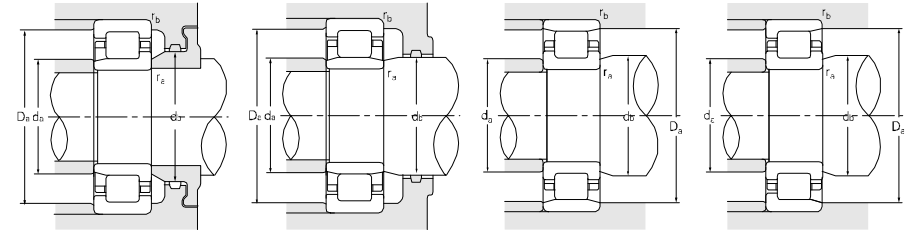
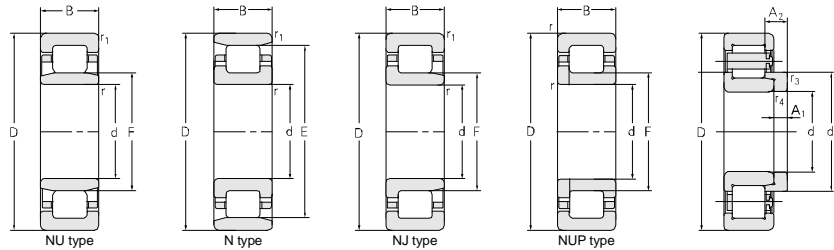

Principal dimensions						Basic load ratings		Limit speed ratings		Designations	
d	D	B	r _{1smin}	r _{smin}	F	E	C _r	C _{0r}	Grease		Oil
mm						kN		r/min			
452	680	100	6	6	516		1690	2630	600	750	NU10/452M/YB2
460	580	56	3	3		553	795	1720	800	950	N1892M
	580	56	3	3		553	840	1730	800	950	NF1892M
	580	56	3	3	489		840	1730	800	950	NJ1892M
	580	72	3	3	489		1030	2350	860	1050	NJ2892EM
	580	72	3	3	490		1090	2480	860	1050	FL-NJ2892/HCEC9
	620	95	4	4	502		1640	3500	800	950	NJ2992
	620	95	4	4	502		1670	1600	800	950	NUP2992
	620	95	4	4	502		1670	1600	800	950	NU2992
	620	118	4	4	502		1950	4400	800	950	NUP3992M/C9W33-1
	620	118	4	4	502		1950	4400	800	950	NUP3992M/C9W33
	680	100	6	6	516		1690	2630	800	950	NU1092M
	680	128	6	6	513		2700	5450	650	800	NU2092EM
	680	128	6	6	513		2450	4800	650	800	NU2092EMA
	680	128	6	6	516		2450	4800	650	800	NU2092MA
	680	163	6	6	516		2970	6150	650	790	NU3092M
	760	240	7.5	7.5	531		5450	10400	400	480	NU3192
	760	240	7.5	7.5	531		5450	10400	400	480	NU3192MA
	760	240	7.5	7.5	531		5310	10400	400	480	NU3192F3
	830	165	7.5	7.5	554		4200	6800	600	720	NU1292
	830	212	7.5	7.5	554		5700	10000	580	670	NU2292/HCYAD
	820	200	7.5	7.5	554		5650	9070	580	670	NU2292X3/HC
	830	212	7.5	7.5	554		4850	8000	580	670	NU2292M
	830	212	7.5	7.5	554		4850	8000	580	670	NU2292MA
	830	212	7.5	7.5	554		4850	8000	580	670	NU2292MA/HC
	830	212	7.5	7.5	554		4850	8000	580	670	NU2292MA-1
	830	212	7.5	7.5	554		4850	8000	580	670	NU2292MA/HCC9
480	600	56	3	3	511		750	1620	840	950	NU1896M
	600	56	3	3	511		785	1680	840	950	NU1896
	600	56	3	3	511		785	1680	840	950	NJ1896M
	600	72	3	3	509.5		1050	2400	840	950	NJ2896EM
	600	72	3	3	509.5		1140	2600	840	950	NJ2896EM
	650	78	5	5	525		1130	2200	780	920	NU1996/HCYA4

Abutment and fillet dimensions						Weight	Model	Weight	Separate thrust collar			
d _{amin}	d _{amax}	d _{bmin}	D _{amax}	D _{amin}	r _{amax}				r _{bmax}	A1	A2	r _{3,4}
mm						kg	kg	mm				
470	510	580	660		5	5	116	HJ10/452	15.1	25	47.47	6
473	548		567	558	2.5	2.5	37.2					
473	548		567	558	2.5	2.5	36.5					
473	480	503	567		2.5	2.5	36.3					
473	485	505	567		2.5	2.5	48.7					
473	485	505	567		2.5	2.5	46.1					
486	511	550	610		3	3	83.4					
480		524	600		3	3	85.0					
480		524	600		3	3	98.3					
476		510	604		3	3	107					
476		510	604		3	3	107					
486	511	521	654		5	5	111					
483	509	518	657		5	5	166					
483	509	518	657		5	5	164					
483	496	508	657		5	5	164					
483	496	508	657		5	5	211					
490	526	536	730		6	6	467					
490	526	536	730		6	6	481					
490	526	536	730		6	6	467					
492	542	559	798		6	6	405					
492	542	559	798		6	6	505					
492	542	559	798		6	6	505					
492	542	559	798		6	6	515					
492	542	559	798		6	6	518					
492	542	559	798		6	6	518					
492	542	559	798		6	6	518					
492	542	559	798		6	6	518					
439	507	516	587		2.5	2.5	37.5					
439	507	516	587		2.5	2.5	36.3					
439	507	516	587		2.5	2.5	37.4					
493	504	524	587		2.5	2.5	46.5					
493	504	524	587		2.5	2.5	49.0					
498	517	530	632		4	4	74.3					

Single-row Cylindrical Roller Bearing



d 480~530 mm

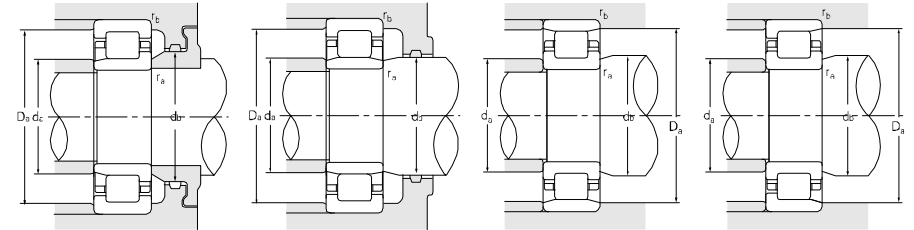
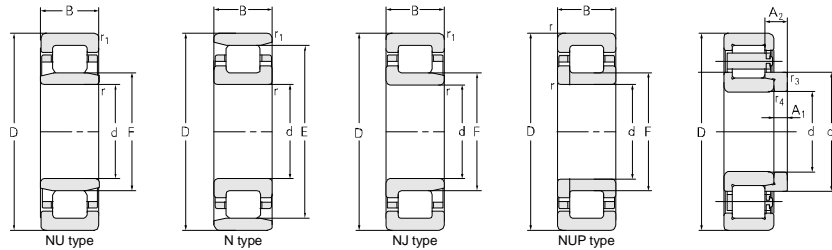

Principal dimensions						Basic load ratings		Limit speed ratings		Designations	
d	D	B	r _{1smin}	r _{smin}	F	E	C _r	C _{0r}	Grease		Oil
mm						kN		r/min			
480	700	100	6	6	536		1600	2970	720	860	NU1096M
	700	100	6	6	536		1900	3500	720	860	NU1096MA
	700	128	6	6	536		2600	5250	600	720	NU2096MA
	790	248	7.5	7.5	547		5650	10700	500	600	NU3196EM
	790	248	7.5	7.5	556		5700	11000	500	600	NU3196M
488.95	660.4	149.225	5	5	532		2350	5480	600	750	NU6/488X4/W33X
500	620	56	3	3		592	795	1700	780	940	NF18/500EM
	620	72	3	3	530		1130	2670	780	940	NU28/500EM
	670	78	5	5	544		1160	2350	720	880	NU19/500EM
	670	100	5	5	543		1930	4300	750	900	NU29/500
	670	100	5	5	543		1860	4100	750	900	NJ29/500
	670	100	5	5	543		1940	4300	750	900	NU29/500F3
	670	100	5	5		627	1860	4100	750	900	N29/500
	670	128		5	543		2300	5350	670	840	NUP39/500M/C9W33-1
	670	128		5	543		2400	5700	670	840	NUP39/500M/C9W33
	670	128	5	5		633	2250	5150	670	840	N39/500EM
	720	100	6	6	556		1680	3050	720	880	NJ10/500
	720	128	6	6	553		2850	5900	620	720	NU20/500EM
	720	167	6	6	556		3210	6970	620	720	NU30/500
	830	264	7.5	7.5	581		6250	12200	480	580	NU31/500
	830	264	7.5	7.5	581		7500	12200	480	580	NU31/500/HCC9YA3
	900	210	7.5	7.5	600		6500	11800	540	600	NU12/500X3/HC
	900	210	7.5	7.5	600		6500	11800	540	600	NU12/500X3/HCYB2
920	185	7.5	7.5	603.1		5050	8450	540	650	NU12/500M	
920	185	7.5	7.5	603.1		5800	9800	540	650	NU12/500/HCEC9	
508	622.3	95.25		4	538		1360	3430	740	850	NUP6/508Q1/C9
530	650	72	3	3		622	1170	2890	900	1100	NF28/530
	650	72	3	3	562		1160	2890	900	1100	NJ28/530
	710	82	5	5	573		1500	2980	680	830	NJ19/530EM
	710	106		5	580		2000	4600	400	500	NUP29/530
	710	106		5	580		2000	4600	400	500	NUP29/530F3
	710	106	5	5	580		1990	4550	400	500	NU29/530/YA1

Abutment and fillet dimensions						Weight	Model	Weight	Separate thrust collar					
d _{amin}	d _{amax}	d _{bmin}	D _{amax}	D _{amin}	r _{amax}				r _{bmax}	A1	A2	r _{3,4}		
mm						kg	kg	mm						
503	531	538	677		5	5					128			
503	531	538	677		5	5					129			
503	529	538	677		5	5					176			
512	536	552	758		6	6					495			
512	545	561	767		6	6					508			
507	517		640		4	4					153			
513			607	598	2.5	2.5					38.5			
513	526	534	607		2.5	2.5					48.5			
518	537	549	652		4	4					80			
522	537	549	648		3	3					101			
522	537	549	648		3	3					105			
522	537	549	648		3	3					102			
519	537		648		3	3					103			
522		549	648		3	3					137			
522		549	648		3	3					137			
518	627	638	652		4	4					128			
523	550		697		5	5					136			
523	549	558	697		5	5					175			
523	530	545	697		5	5					232			
532	550	580	798		6	6					602			
					6	6					602			
532	593	610	868		6	6					606			
532	593	610	868		6	6					606			
532	593	610	888		6	6					585			
532	593	610	888		6	6					572			
520	526	534	607		3	3					65.6			
544			645	625	2.5	2.5					52.2			
544			645	625	2.5	2.5					54.4			
548	568	598	692		4	4					94.5			
555		605	585		4	4					125			
555		605	585		4	4					125			
555	585	605	585		4	4					125			
										HJ29/530	13.2	24	41.42	5

Single-row Cylindrical Roller Bearing



d 530~600 mm

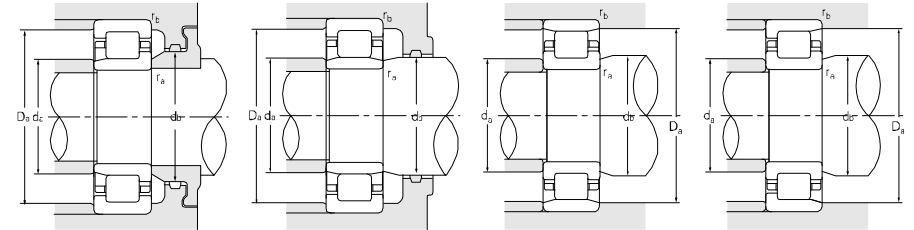
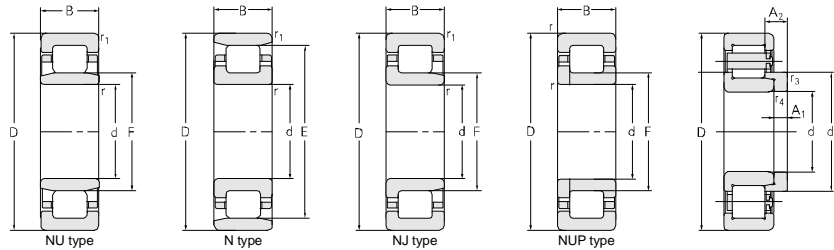

Principal dimensions						Basic load ratings		Limit speed ratings		Designations		
d	D	B	r _{1smin}	r _{smin}	F	E	C _r	C _{0r}	Grease		Oil	
mm						kN		r/min				
530	710	106	5	5	580		2000	4800	400	500	NU29/530F3	
	780	112	6	6	593		2200	4050	650	780	NU10/530M	
	780	145	6	6	591		3650	7360	550	650	NU20/530EM	
	870	272	7.5	7.5	612		7250	14500	460	550	NU31/530EM	
	870	272	7.5	7.5	612		7500	13500	460	550	NU31/530/HCE	
	870	272	7.5	7.5	612		7000	13500	460	550	NU31/530	
	870	272	7.5	7.5	612		6900	13500	460	550	NU31/530/HG2	
	870	272	7.5	7.5	612		7500	13500	460	550	NU31/530/HCYA6	
558.8	685.8	100		5	590.5		1680	4450	670	820	NUP6/558.8Q1/C9-NJB	
560	680	56	3	3	591		810	1830	670	820	NJ18/560M	
	680	56	3	3	591		810	1830	670	820	NJ18/560MA	
	680	72	3	3		651	1170	2950	670	820	NF28/560	
	750	85	5	5	608		1630	3200	650	780	NU19/560EM	
	750	85	5	5	608		1660	3250	650	780	NJ19/560	
	750	85	5	5	608		1660	3250	650	780	NJ19/560MA	
	750	112	5	5	607		2400	5450	650	780	NJ29/560	
	750	112	5	5	607		2400	5450	650	780	NJ29/560F3	
	750	112	5	5		703	2420	5600	650	780	N29/560	
	750	112	5	5	607		2470	5570	650	780	FL-NU29/560/C3	
	820	115	6	6	625		2250	4200	620	720	NU10/560M	
	820	150	6	6	626		3650	7600	500	600	NU20/560EM	
	960	270	9.5	9.5	670		8900	17000	480	550	NU6/560/HC	
	1030	206	9.5	9.5	668		6850	11000	460	550	NU12/560MA	
	600	730	60	3	3	632		860	2000	650	780	NU18/600EM
		730	78	3	3	632		1250	3350	620	730	NU28/600EM
800		90	5	5	649		1900	3800	620	750	NU19/600EM	
800		90	5	5	649		1860	3600	620	750	NU19/600	
800		90	5	5	649		1900	3800	620	750	NUP19/600EM	
800		90	5	5		757	1900	3800	620	750	NF19/600EM	
800		90	5	5	649		1860	3600	620	750	NJ19/600M	
800		118	5	5	649		2900	6550	620	750	NU29/600E	
830		150	5	5	655		3410	7450	600	700	NU6/600	

Abutment and fillet dimensions						Weight	Model	Weight	Separate thrust collar			
d _{amin}	d _{amax}	d _{bmin}	D _{amax}	D _{amin}	r _{amax}				r _{bmax}	A1	A2	r _{3,r4}
mm						kg	kg	mm				
555	585	605	585		4	4	125	HJ29/530	13.2	24	41.42	5
553	585	598	757		5	5	187					
553	587	596	757		5	5	252					
562	605	617	838		6	6	663					
562	605	617	838		6	6	670					
562	605	617	838		6	6	670					
562	605	617	838		6	6	670					
562	605	617	838		6	6	670					
573	584	590	667		4	4	82.9					
573	584	606	667		2.5	2.5	42.5					
573	584	606	667		2.5	2.5	44.2					
573	645	665	657	657	2.5	2.5	53					
578	600	613	732		4	4	108					
578	600	613	732		4	4	111					
578	600	613	732		4	4	111					
586	620	693	724		4	4	148					
586	620	693	724		4	4	148					
586	620	693	724	713	4	4	138					
586	620	693	724		4	4	146					
583	617	630	797		5	5	215					
583	616	631	797		5	5	289					
588	630	646	932		8	8	846					
600	657	674	990		8	8	809					
613	625	637	717		2.5	2.5	49.3					
613	625	637	717		2.5	2.5	68.5					
618	642	645	782		4	4	128					
618	642	645	782		4	4	128					
618	642	645	782		4	4	135					
618	642	645	782		4	4	130					
619	642	657	782		4	4	130					
618	642	657	782		4	4	163					
619	647	703	806		4	4	237					