

UC2 Normale Reihe - Нормальная серия

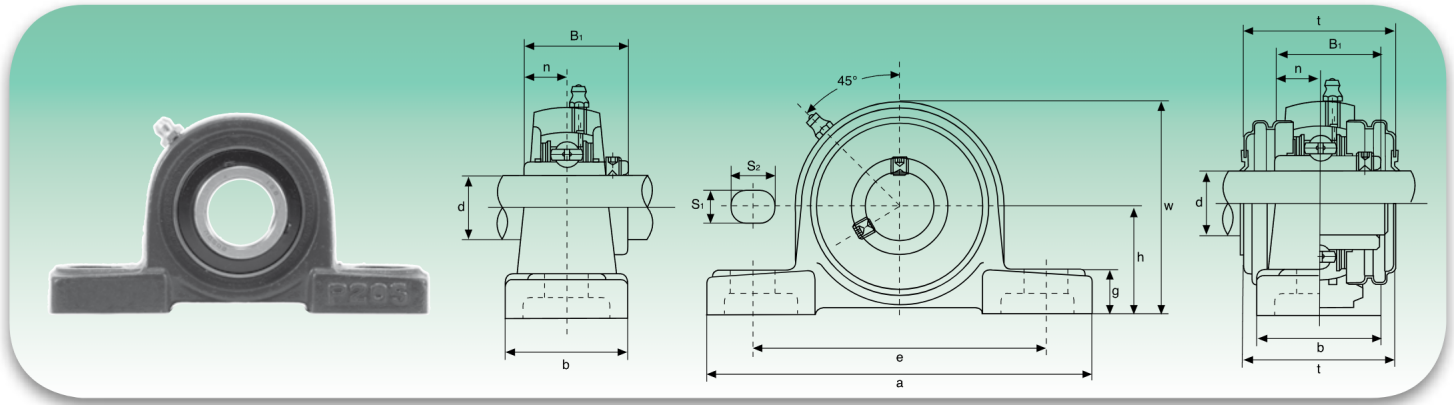

Typ Тун	Abmessungen - Размеры											Bef.Bolz. Креп. винт	Tragzahlen (N) Коэффициент нагрузки (H)		Lager Подшипник	Gehäuse Корпус	Gewicht Вес		
	d	h	a	e	b	S ₁	S ₂	g	w	t	B ₁		n	dynamisch C Динамическая C				statisch C ₀ Статическая C ₀	kg
	mm/Zoll - мм/дюйм												mm/Zoll - мм/дюйм						
UCP201	12	30,2	127	95	38	13	19	14	62	44,5	31	12,7	M10	12160	6318	UC201	P203	0,69	
UCP201-8	3/4	13/16	5	3 3/4	1 1/2	1/2	3/4	9/16	27/16	1 3/4	1,2205	0,500	3/8			UC201-8		0,69	
UCP202	15	30,2	127	95	38	13	19	14	62	44,5	31	12,7	M10	12160	6318	UC202	P203	0,69	
UCP202-9	9/16	13/16	5	3 3/4	1 1/2	1/2	3/4	9/16	27/16	1 3/4	1,2205	0,500	3/8			UC202-9		0,69	
UCP202-10	5/8	13/16	5	3 3/4	1 1/2	1/2	3/4	9/16	27/16	1 3/4	1,2205	0,500	3/8	UC202-10	0,69				
UCP203	17	30,2	127	95	38	13	19	14	62	44,5	31	12,7	M10	12160	6318	UC203	P203	0,68	
UCP203-11	11/16	13/16	5	3 3/4	1 1/2	1/2	3/4	9/16	27/16	1 3/4	1,2205	0,500	3/8			UC203-11		0,67	
UCP204	20	33,3	127	95	38	13	19	14	65	44,5	31	12,7	M10	12160	6318	UC204	P204	0,66	
UCP204-12	3/4	15/16	5	3 3/4	1 1/2	1/2	3/4	9/16	29/16	1 3/4	1,2205	0,500	3/8			UC204-12		0,66	
UCP205	25	36,5	140	105	38	13	19	15	71	48	34,1	14,3	M10	13300	7457	UC205	P205	0,81	
UCP205-13	13/16	7/8	17/16	5 1/2	4 1/8	1 1/2	1/2	3/4	19/32	225/32	157/64	1,3425	0,563			UC205-13		0,85	
UCP205-14	7/8	17/16	5 1/2	4 1/8	1 1/2	1/2	3/4	19/32	225/32	157/64	1,3425	0,563	UC205-14			0,83			
UCP205-15	15/16	17/16	5 1/2	4 1/8	1 1/2	1/2	3/4	19/32	225/32	157/64	1,3425	0,563	UC205-15			0,82			
UCP205-16	1	17/16	5 1/2	4 1/8	1 1/2	1/2	3/4	19/32	225/32	157/64	1,3425	0,563	UC205-16			0,81			
UCP206	30	42,9	165	121	48	17	20	17	84	53	38,1	15,9	M14	18525	10735	UC206	P206	1,24	
UCP206-17	11/16	11/16	6 1/2	4 3/4	17/8	43/64	25/32	21/32	35/16	25/64	1,5000	0,626	1/2			UC206-17		1,27	
UCP206-18	11/8	11/16	6 1/2	4 3/4	17/8	43/64	25/32	21/32	35/16	25/64	1,5000	0,626	1/2			UC206-18		1,26	
UCP206-19	13/16	11/16	6 1/2	4 3/4	17/8	43/64	25/32	21/32	35/16	25/64	1,5000	0,626	1/2			UC206-19		1,24	
UCP206-20	1 1/4	11/16	6 1/2	4 3/4	17/8	43/64	25/32	21/32	35/16	25/64	1,5000	0,626	1/2			UC206-20		1,23	
UCP207	35	47,6	167	127	48	17	20	18	93	59,5	42,9	17,5	M14	24415	14630	UC207	P207	1,58	
UCP207-20	1 1/4	17/8	69/16	5	17/8	43/64	25/32	45/64	321/32	211/32	1,6890	0,689	1/2			UC207-20		1,64	
UCP207-21	15/16	17/8	69/16	5	17/8	43/64	25/32	45/64	321/32	211/32	1,6890	0,689	1/2			UC207-21		1,61	
UCP207-22	13/8	17/8	69/16	5	17/8	43/64	25/32	45/64	321/32	211/32	1,6890	0,689	1/2			UC207-22		1,58	
UCP207-23	17/16	17/8	69/16	5	17/8	43/64	25/32	45/64	321/32	211/32	1,6890	0,689	1/2			UC207-23		1,55	
UCP208	40	49,2	184	137	54	17	20	18	100	69	49,2	19	M14	27645	16910	UC208	P208	1,89	
UCP208-24	1 1/2	115/16	7 1/4	5 1/8	21/8	43/64	25/32	45/64	315/16	223/32	1,9370	0,748	1/2			UC208-24		1,93	
UCP208-25	19/16	115/16	7 1/4	5 1/8	21/8	43/64	25/32	45/64	315/16	223/32	1,9370	0,748	1/2			UC208-25		1,90	
UCP209	45	54,0	190	146	54	17	20	20	106	69	49,2	19	M14	32395	20235	UC209	P209	2,14	
UCP209-26	15/8	2 1/8	7 1/2	5 3/4	2 1/8	43/64	25/32	25/32	411/64	223/32	1,9370	0,748	1/2			UC209-26		2,24	
UCP209-27	111/16	2 1/8	7 1/2	5 3/4	2 1/8	43/64	25/32	25/32	411/64	223/32	1,9370	0,748	1/2			UC209-27		2,20	
UCP209-28	1 3/4	2 1/8	7 1/2	5 3/4	2 1/8	43/64	25/32	25/32	411/64	223/32	1,9370	0,748	1/2			UC209-28		2,14	
UCP210	50	57,2	206	159	60	20	23	21	113	74,5	51,6	19	M16	33345	22135	UC210	P210	2,66	
UCP210-29	113/16	2 1/4	8 1/8	6 1/4	2 3/8	25/32	29/32	53/64	429/64	215/16	2,0315	0,748	5/8			UC210-29		2,78	
UCP210-30	17/8	2 1/4	8 1/8	6 1/4	2 3/8	25/32	29/32	53/64	429/64	215/16	2,0315	0,748	5/8			UC210-30		2,73	
UCP210-31	115/16	2 1/4	8 1/8	6 1/4	2 3/8	25/32	29/32	53/64	429/64	215/16	2,0315	0,748	5/8			UC210-31		2,68	
UCP210-32	2	2 1/4	8 1/8	6 1/4	2 3/8	25/32	29/32	53/64	429/64	215/16	2,0315	0,748	5/8			UC210-32		2,64	
UCP211	55	63,5	219	171	60	20	23	23	125	76	55,6	22,2	M16	41230	27930	UC211	P211	3,31	
UCP211-32	2	2 1/2	8 5/8	6 7/8	2 3/8	25/32	29/32	29/32	459/64	3	2,1890	0,874	5/8			UC211-32		3,46	
UCP211-33	21/16	2 1/2	8 5/8	6 7/8	2 3/8	25/32	29/32	29/32	459/64	3	2,1890	0,874	5/8			UC211-33		3,40	
UCP211-34	21/8	2 1/2	8 5/8	6 7/8	2 3/8	25/32	29/32	29/32	459/64	3	2,1890	0,874	5/8			UC211-34		3,35	
UCP211-35	23/16	2 1/2	8 5/8	6 7/8	2 3/8	25/32	29/32	29/32	459/64	3	2,1890	0,874	5/8			UC211-35		3,29	
UCP212	60	69,8	241	184	70	20	23	25	138	89	65,1	25,4	M16	49780	34390	UC212	P212	4,90	
UCP212-36	2 1/4	2 3/4	9 1/2	7 1/4	2 3/4	25/32	29/32	63/64	57/16	3 1/2	2,5630	1,000	5/8			UC212-36		5,03	
UCP212-37	25/16	2 3/4	9 1/2	7 1/4	2 3/4	25/32	29/32	63/64	57/16	3 1/2	2,5630	1,000	5/8			UC212-37		4,95	
UCP212-38	23/8	2 3/4	9 1/2	7 1/4	2 3/4	25/32	29/32	63/64	57/16	3 1/2	2,5630	1,000	5/8			UC212-38		4,88	
UCP212-39	27/16	2 3/4	9 1/2	7 1/4	2 3/4	25/32	29/32	63/64	57/16	3 1/2	2,5630	1,000	5/8			UC212-39		4,81	
UCP213	65	76,2	265	203	70	25	28	27	150	89	65,1	25,4	M20	54340	38095	UC213	P213	5,15	
UCP213-40	2 1/2	3	10 7/16	8	2 3/4	63/64	13/32	11/16	529/32	3 1/2	2,5630	1,000	3/4			UC213-40		5,24	
UCP213-41	29/16	3	10 7/16	8	2 3/4	63/64	13/32	11/16	529/32	3 1/2	2,5630	1,000	3/4			UC213-41		5,15	
UCP214	70	79,4	266	210	72	25	28	27	156	-	74,6	30,2	M20	59090	41895	UC214	P214	6,20	
UCP214-42	25/8	3 1/8	10 5/16	8 1/8	2 7/8	63/64	13/32	11/16	69/64	-	2,9370	1,189	3/4			UC214-42		6,41	
UCP214-43	211/16	3 1/8	10 5/16	8 1/8	2 7/8	63/64	13/32	11/16	69/64	-	2,9370	1,189	3/4			UC214-43		6,31	
UCP214-44	2 3/4	3 1/8	10 5/16	8 1/8	2 7/8	63/64	13/32	11/16	69/64	-	2,9370	1,189	3/4			UC214-44		6,21	
UCP215	75	82,6	275	217	74	25	28	28	162	-	77,8	33,3	M20	64030	45885	UC215	P215	7,16	
UCP215-45	213/16	3 1/4	10 5/8	8 3/8	2 7/8	63/64	13/32	13/32	63/8	-	3,0630	1,311	3/4			UC215-45		7,41	
UCP215-46	27/8	3 1/4	10 5/8	8 3/8	2 7/8	63/64	13/32	13/32	63/8	-	3,0630	1,311	3/4			UC215-46		7,30	
UCP215-47	215/16	3 1/4	10 5/8	8 3/8	2 7/8	63/64	13/32	13/32	63/8	-	3,0630	1,311	3/4			UC215-47		7,19	
UCP215-48	3	3 1/4	10 5/8	8 3/8	2 7/8	63/64	13/32	13/32	63/8	-	3,0630	1,311	3/4			UC215-48		7,07	
UCP216	80	88,9	292	232	78	25	28	30	174	-	82,6	33,3	M20	69065	50350	UC216	P216	8,10	
UCP216-49	31/16	3 1/8	11 1/2	9 1/8	3 1/16	63/64	13/32	13/16	627/32	-	3,2520	1,311	3/4			UC216-49		8,28	
UCP216-50	31/8	3 1/8	11 1/2	9 1/8	3 1/16	63/64	13/32	13/16	627/32	-	3,2520	1,311	3/4			UC216-50		8,15	
UCP216-51	33/16	3 1/8	11 1/2	9 1/8	3 1/16	63/64	13/32	13/16	627/32	-	3,2520	1,311	3/4			UC216-51		8,02	
UCP217	85	95,2	310	247	83	25	28	32	185	-	85,7	34,1	M20	79800	58805	UC217	P217	9,81	
UCP217-52	3 3/4	3 3/4	12 1/4	9 3/8	3 1/8	63/64	13/32	1 1/4	79/32	-	3,3740	1,343	3/4			UC217-52		10,03	
UCP217-53	35/16	3 3/4	12 1/4	9 3/8	3 1/8	63/64	13/32	1 1/4	79/32	-	3,3740	1,343	3/4			UC217-53		9,89	
UCP217-55	37/16	3 3/4	12 1/4	9 3/8	3 1/8	63/64	13/32	1 1/4	79/32	-	3,3740	1,343	3/4			UC217-55		9,60	
UCP218	90	101,6	327	262	88	27	30	33	198	-	96	39,7	M22	91295	67925	UC218	P218	11,96	
UCP218-56	3 1/2	4	12 7/8	10 5/16	3 1/2	11/16	13/16	119/64	751/64	-	3,7795	1,5630	7/8			UC218-56		12,07	

HCP2 Normale Reihe - Нормальная серия

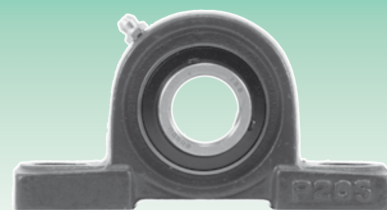
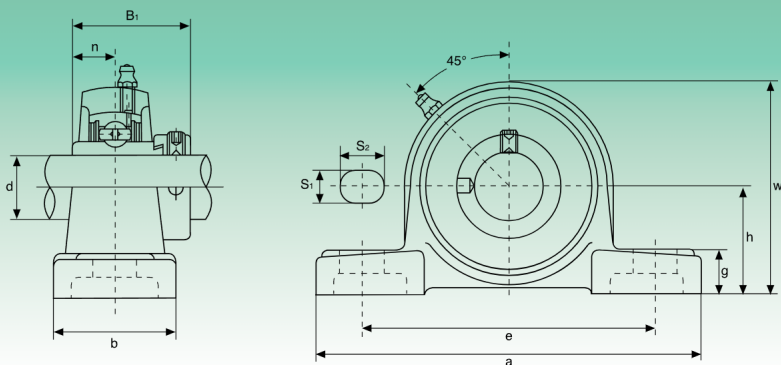

Typ Тип	Abmessungen - Размеры											Bef.Bolz. Креп. винт	Tragzahlen (N) Коэффициент нагрузки (H)		Lager Подшипник	Gehäuse Корпус	Gewicht Вес	
	d	h	a	e	b	S ₁	S ₂	g	w	B ₁	n		dynamisch C _d	statisch C _s				kg
	mm/Zoll - мм/дюйм												mm/Zoll - мм/дюйм	Динамическая C				
HCP204	20	33,3	127	95	38	13	19	14	65	43,7	17,1	M10	12160	6318	HC204	P204	0,73	
HCP204-12	1 1/4	15/16	5	3 3/4	1 1/2	1/2	3/4	9/16	29/16	1,720	0,673	3/8			HC204-12		0,73	
HCP205	25	36,5	140	105	38	13	19	15	71	44,4	17,5	M10	13300	7457	HC205	P205	0,88	
HCP205-13	13/16	17/16	5 1/2	41/8	1 1/2	1/2	3/4	19/32	225/32	1,748	0,689	3/8			HC205-13		0,93	
HCP205-14	7/8														HC205-14		0,92	
HCP205-15	15/16														HC205-15		0,90	
HCP205-16	1														HC205-16		0,88	
HCP206	30	42,9	165	121	48	17	20	17	84	48,4	18,3	M14	18525	10735	HC206	P206	1,37	
HCP206-17	11/16	111/16	6 1/2	4 3/4	17/8	43/64	25/32	21/32	35/16	1,906	0,720	1/2			HC206-17		1,42	
HCP206-18	11/8														HC206-18		1,39	
HCP206-19	13/16														HC206-19		1,37	
HCP206-20	1 1/4														HC206-20		1,34	
HCP207	35	47,6	167	127	48	17	20	18	93	51,1	18,8	M14	24415	14630	HC207	P207	1,70	
HCP207-20	1 1/4	17/8	69/16	5	17/8	43/64	25/32	45/64	321/32	2,012	0,740	1/2			HC207-20		1,77	
HCP207-21	15/16														HC207-21		1,73	
HCP207-22	13/8														HC207-22		1,70	
HCP207-23	17/16														HC207-23		1,67	
HCP208	40	49,2	184	137	54	17	20	18	100	56,3	21,4	M14	27645	16910	HC208	P208	2,04	
HCP208-24	1 1/2	115/16	7 1/4	513/32	21/8	43/64	25/32	45/64	315/16	2,217	0,843	1/2			HC208-24		2,09	
HCP208-25	19/16														HC208-25		2,05	
HCP209	45	54,0	190	146	54	17	20	20	106	56,3	21,4	M14	32395	20235	HC209	P209	2,31	
HCP209-26	15/8	111/16	715/32	5 3/4	21/8	43/64	25/32	25/32	411/64	2,217	0,843	1/2			HC209-26		2,42	
HCP209-27	111/16														HC209-27		2,37	
HCP209-28	1 3/4														HC209-28		2,33	
HCP210	50	57,2	206	159	60	20	23	21	113	62,7	24,6	M16	33345	22135	HC210	P210	2,85	
HCP210-29	113/16	2 1/4	81/8	6 1/4	23/8	25/32	29/32	53/64	429/64	2,469	0,969	5/8			HC210-29		3,00	
HCP210-30	17/8														HC210-30		2,94	
HCP210-31	115/16														HC210-31		2,88	
HCP210-32	2	HC210-32	2,82															
HCP211	55	63,5	219	171	60	20	23	23	125	71,4	27,8	M16	41230	27930	HC211	P211	3,52	
HCP211-32	2	2 1/2	85/8	647/64	23/8	25/32	29/32	29/32	459/64	2,811	1,094	5/8			HC211-32		3,72	
HCP211-33	21/16														HC211-33		3,64	
HCP211-34	21/8														HC211-34		3,57	
HCP211-35	23/16														HC211-35		3,49	
HCP212	60	69,8	241	184	70	20	23	25	138	77,8	31	M16	49780	34390	HC212	P212	5,24	
HCP212-36	2 1/4	2 3/4	9 1/2	7 1/4	234	25/32	29/32	63/64	57/16	3,063	1,220	5/8			HC212-36		5,40	
HCP212-37	25/16														HC212-37		5,31	
HCP212-38	23/8														HC212-38		5,26	
HCP212-39	27/16														HC212-39		5,13	
HCP213	65	76,2	265	203	70	25	28	27	150	85,7	34,1	M20	54340	38095	HC213	P213	5,71	
HCP213-40	2 1/2	3	107/16	8	2 3/4	63/64	13/32	11/16	529/32	3,374	1,343	3/4			HC213-40		5,81	
HCP213-41	29/16														HC213-41		5,70	
HCP214	70	79,4	266	210	72	25	28	27	156	85,7	34,1	M20	59090	41895	HC214	P214	6,70	
HCP214-42	25/8	31/8	1015/32	817/64	227/32	63/64	13/32	11/16	69/64	3,374	1,343	3/4			HC214-42		6,94	
HCP214-43	211/16														HC214-43		6,83	
HCP214-44	2 3/4														HC214-44		6,71	
HCP215	75	82,6	275	217	74	25	28	28	162	92,1	37,3	M20	64030	45885	HC215	P215	7,79	
HCP215-45	213/16	3 1/4	1053/64	835/64	229/32	63/64	13/32	13/32	63/8	3,626	1,426	3/4			HC215-45		8,09	
HCP215-46	27/8														HC215-46		7,96	
HCP215-47	215/16														HC215-47		7,83	
HCP215-48	3														HC215-48		7,69	

UCLP2 Höhenreduzierte Reihe - Пониженная серия

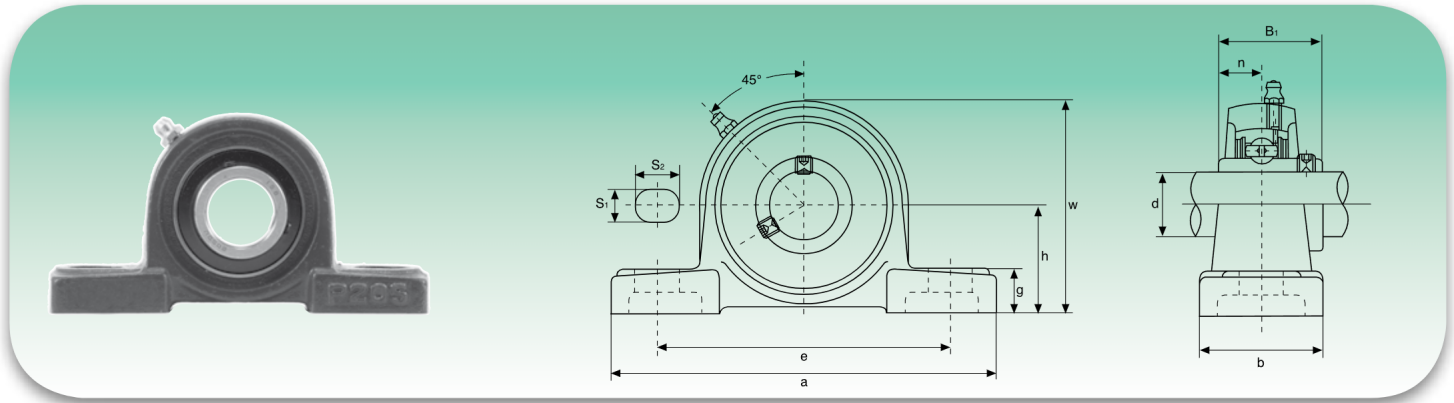

Typ Тип	Abmessungen - Размеры											Bef.Bolz. Креп. винт	Tragzahlen (N) Коэффициент нагрузки (H)		Lager Подшипник	Gehäuse Корпус	Gewicht Вес	
	d	h	a	e	b	S ₁	S ₂	g	w	B ₁	n		dynamisch C Динамическая C	statisch C ₀ Статическая C ₀				kg
	mm/Zoll - мм/дюйм												mm/Zoll - мм/дюйм					
UCLP201 UCLP201-8	12 ¾	31,75 1¼	127 5	95 3¾	38 1½	13 ½	16 5/8	14 9/16	64 233/64	31 1,2205	12,7 0,500	M10 3/8	12160	6318	UC201 UC201-8	LP204	0,69 0,69	
UCLP202 UCLP202-9 UCLP202-10	15 9/16 5/8	31,75 1¼	127 5	95 3¾	38 1½	13 ½	16 5/8	14 9/16	64 233/64	31 1,2205	12,7 0,500	M10 3/8	12160	6318	UC202 UC202-9 UC202-10	LP204	0,69 0,69 0,69	
UCLP203 UCP203-11	17 11/16	31,75 1¼	127 5	95 3¾	38 1½	13 ½	16 5/8	14 9/16	64 233/64	31 1,2205	12,7 0,500	M10 3/8	12160	6318	UC203 UC203-11	LP204	0,68 0,67	
UCLP204 UCP204-12	20 ¾	31,75 1¼	127 5	95 3¾	38 1½	13 ½	16 5/8	14 9/16	64 233/64	31 1,2205	12,7 0,500	M10 3/8	12160	6318	UC204 UC204-12	LP204	0,66 0,66	
UCLP205 UCLP205-13 UCLP205-14 UCLP205-15 UCLP205-16	25 13/16 7/8 15/16 1	33,34 15/16	140 5½	105 41/8	38 1½	13 ½	16 5/8	15 19/32	68 243/64	34,1 1,3425	14,3 0,563	M10 3/8	13300	7457	UC205 UC205-13 UC205-14 UC205-15 UC205-16	LP205	0,81 0,85 0,83 0,82 0,81	
UCLP206 UCLP206-17 UCLP206-18 UCLP206-19 UCLP206-20	30 11/16 11/8 13/16 1¼	39,69 19/16	165 6½	121 4¾	48 17/8	17 43/64	20 25/32	17 21/32	80 35/32	38,1 1,5000	15,9 0,626	M14 ½	18525	10735	UC206 UC206-17 UC206-18 UC206-19 UC206-20	LP206	1,24 1,27 1,26 1,24 1,23	
UCLP207 UCLP207-20 UCLP207-21 UCLP207-22 UCLP207-23	35 1¼ 15/16 13/8 17/16	46,04 113/16	167 69/16	127 5	48 17/8	17 43/64	20 25/32	18 45/64	91 337/64	42,9 1,6890	17,5 0,689	M14 ½	24415	14630	UC207 UC207-20 UC207-21 UC207-22 UC207-23	LP207	1,58 1,64 1,61 1,58 1,55	
UCLP208 UCLP208-24 UCLP208-25	40 1½ 19/16	49,2 115/16	184 7¼	137 513/32	54 21/8	17 43/64	20 25/32	18 45/64	100 315/16	49,2 1,9370	19 0,748	M14 ½	27645	16910	UC208 UC208-24 UC208-25	LP208	1,89 1,93 1,90	
UCLP209 UCLP209-26 UCLP209-27 UCLP209-28	45 15/8 111/16 1¾	52,39 21/16	190 715/32	146 5¾	54 21/8	17 43/64	20 25/32	20 25/32	104 43/32	49,2 1,9370	19 0,748	M14 ½	32395	20235	UC209 UC209-26 UC209-27 UC209-28	LP209	2,14 2,24 2,20 2,14	
UCLP210 UCLP210-29 UCLP210-30 UCLP210-31 UCLP210-32	50 113/16 17/8 115/16 2	55,56 23/16	206 81/8	159 6¾	60 23/8	20 25/32	23 29/32	21 53/64	112 413/32	51,6 2,0315	19 0,748	M16 5/8	33345	22135	UC210 UC210-29 UC210-30 UC210-31 UC210-32	LP210	2,66 2,78 2,73 2,68 2,64	
UCLP211 UCLP211-32 UCLP211-33 UCLP211-34 UCLP211-35	55 2 21/16 21/8 23/16	61,91 27/16	219 85/8	171 647/64	60 23/8	20 25/32	23 29/32	23 29/32	124 47/8	55,6 2,1890	22,2 0,874	M16 5/8	41230	27930	UC211 UC211-32 UC211-33 UC211-34 UC211-35	LP211	3,31 3,46 3,40 3,35 3,29	
UCLP212 UCLP212-36 UCLP212-37 UCLP212-38 UCLP212-39	60 2¼ 25/16 23/8 27/16	68,26 211/16	241 9½	184 7¼	70 234	20 25/32	23 29/32	25 63/64	136 523/64	65,1 2,5630	25,4 1,000	M16 5/8	49780	34390	UC212 UC212-36 UC212-37 UC212-38 UC212-39	LP212	4,90 5,03 4,95 4,88 4,81	

UCP3 Schwere Reihe - Тяжелая серия

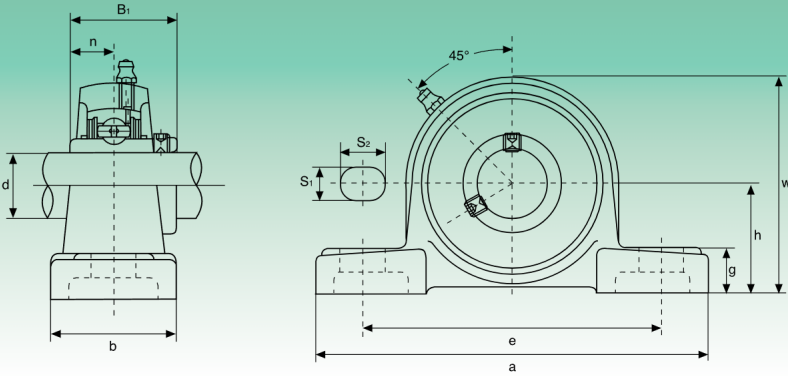

Typ Тип	Abmessungen - Размеры											Bef.Bolz. Креп. винт	Tragzahlen (N) Коэффициент нагрузки (H)		Lager Подшипник	Gehäuse Корпус	Gewicht Вес	
	d	h	a	e	b	S ₁	S ₂	g	w	B ₁	n		dynamisch C Динамическая C	statisch C ₀ Статическая C ₀				kg
	mm/Zoll - мм/дюйм												mm/Zoll - мм/дюйм					
UCP305	25	45	175	132	45	17	20	15	85	38	15	M14			UC305			
UCP305-13	13/16														UC305-13			
UCP305-14	7/8														UC305-14	P305	1,4	
UCP305-15	15/16	149/64	67/8	53/16	125/32	43/64	25/32	19/32	311/32	1,4961	0,591	1/2	20140	10355	UC305-15			
UCP305-16	1														UC305-16			
UCP306	30	50	180	140	50	17	20	18	95	43	17	M14			UC306			
UCP306-17	11/16														UC306-17			
UCP306-18	11/8	131/32	73/32	5 1/2	131/32	43/64	25/32	23/32	3 3/4	1,6929	0,669	1/2	25365	14250	UC306-18	P306	1,8	
UCP306-19	13/16														UC306-19			
UCP307	35	56	210	160	56	17	25	20	106	48	19	M14			UC307			
UCP307-20	1 1/4														UC307-20			
UCP307-21	15/16	113/64	89/32	65/16	213/64	43/64	31/32	25/32	43/16	1,8898	1,748	1/2	31730	18335	UC307-21	P307	2,8	
UCP307-22	13/8														UC307-22			
UCP307-23	17/16														UC307-23			
UCP308	40	60	220	170	60	17	27	22	116	52	19	M14			UC308			
UCP308-24	1 1/2														UC308-24	P308	3,0	
UCP308-25	19/16	223/64	821/32	611/16	23/8	43/64	111/16	7/8	49/16	2,0472	0,748	1/2	38665	22800	UC308-25			
UCP309	45	67	245	190	67	20	30	24	129	57	22	M16			UC309			
UCP309-26	15/8														UC309-26	P309	4,1	
UCP309-27	11 1/16	241/64	921/32	715/32	25/8	25/32	13/16	15/16	53/32	2,2441	0,866	5/8	46455	28025	UC309-27			
UCP309-28	1 3/4														UC309-28			
UCP310	50	75	275	212	75	20	35	27	143	61	22	M16			UC310			
UCP310-29	113/16														UC310-29	P310	5,8	
UCP310-30	17/8	261/64	1013/16	811/32	215/16	25/32	13/8	11/16	55/8	2,4016	0,866	5/8	58900	36385	UC310-30			
UCP310-31	115/16														UC310-31			
UCP311	55	80	310	236	80	20	38	30	154	66	25	M16			UC311			
UCP311-32	2														UC311-32	P311	7,4	
UCP311-33	21/16	35/32	127/32	99/32	35/32	25/32	1 1/2	13/16	61/16	2,5984	0,984	5/8	68020	42750	UC311-33			
UCP311-34	21/8														UC311-34			
UCP311-35	23/16														UC311-35			
UCP312	60	85	330	250	85	25	38	32	165	71	26	M20			UC312			
UCP312-36	2 1/4														UC312-36	P312	9,4	
UCP312-37	25/16	311/32	13	917/32	311/32	31/32	1 1/2	1 1/4	6 1/2	2,7953	1,024	3/4	77805	49590	UC312-37			
UCP312-38	23/8														UC312-38			
UCP312-39	27/16														UC312-39			
UCP313	65	90	340	260	90	25	38	33	176	75	30	M20			UC313			
UCP313-40	2 1/2														UC313-40	P313	10	
UCP313-41	29/16	335/64	133/8	10 3/4	317/32	31/32	1 1/2	15/16	615/16	2,9528	1,181	3/4	88065	56905	UC313-41			
UCP314	70	95	360	280	90	27	40	35	187	78	33	M22			UC314			
UCP314-42	25/8														UC314-42	P314	12	
UCP314-43	211/16	347/64	143/16	111/32	317/32	11/16	19/16	13/8	73/8	3,0708	1,299	7/8	98800	64790	UC314-43			
UCP314-44	2 3/4														UC314-44			
UCP315	75	100	380	290	100	27	40	35	198	82	32	M22			UC315			
UCP315-45	216/8														UC315-45	P315	14	
UCP315-46	27/8	315/16	1431/32	1113/32	315/16	11/16	19/16	13/8	725/32	3,2283	1,260	7/8	107350	73340	UC315-46			
UCP315-47	215/16														UC315-47			
UCP315-48	3														UC315-48			
UCP316	80	106	400	300	110	27	40	40	210	86	34	M22			UC316			
UCP316-49	31/16														UC316-49	P316	18	
UCP316-50	31/8	411/64	15 3/4	1113/16	411/32	11/16	19/16	19/16	89/32	3,3858	1,339	7/8	111850	82365	UC316-50			
UCP316-51	33/16														UC316-51			
UCP317	85	112	420	320	110	33	45	40	220	96	40	M27			UC317			
UCP317-52	3 3/4														UC317-52	P317	20	
UCP317-53	35/16	413/32	1617/32	1219/32	411/32	15/16	125/32	19/16	821/32	3,7795	1,575	1	126350	91960	UC317-53			
UCP317-55	37/16														UC317-55			
UCP318	90	118	430	330	110	33	45	45	235	96	40	M27			UC318			
UCP318-55	37/16														UC318-55	P318	24	
UCP318-56	3 1/2	441/64	1615/16	13	411/32	15/16	125/32	125/32	9 3/4	3,7795	1,575	1	135850	101650	UC318-56			
UCP319	95	125	470	360	120	36	50	45	250	103	41	M30			UC319			
UCP319-58	35/8														UC319-58	P319	29	
UCP319-59	311/16	459/64	18 1/2	143/16	423/32	113/32	131/32	125/32	927/32	4,0551	1,614	11/8	145350	113050	UC319-59			
UCP319-60	3 3/4														UC319-60			
UCP320	100	140	490	380	120	36	50	50	275	108	42	M30			UC320			
UCP320-64	4	533/64	199/32	1431/32	423/32	113/32	131/32	131/32	1013/16	4,2520	1,654	11/8	164350	133950	UC320-64	P320	35	
UCP321	105	140	490	380	120	36	50	56	283	112	44	M33	174800	145350	UC321	P321	35	
UCP322	110	150	520	400	140	40	55	61	303	117	46	M33	194750	171000	UC322	P322	45	
UCP324	120	160	570	450	140	40	55	71	323	126	51	M33	196650	175750	UC324	P324	55	
UCP326	130	180	600	480	140	40	55	81	363	135	54	M33	217550	203300	UC326	P326	72	
UCP328	140	200	620	500	140	40	55	81	403	145	59	M33	240350	233700	UC328	P328	89	

UCPX Mittlere Reihe - Средняя серия

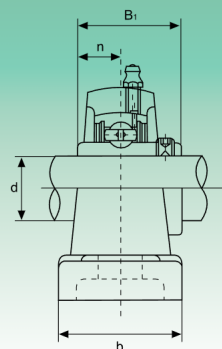
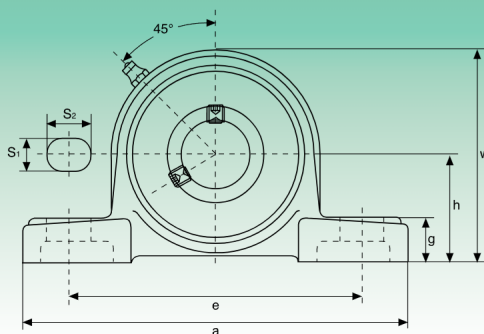
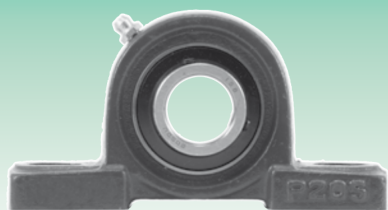

Typ Тип	Abmessungen - Размеры											Bef.Bolz. Креп. винт	Tragzahlen (N) Коэффициент нагрузки (H)		Lager Подшипник	Gehäuse Корпус	Gewicht Вес	
	d	h	a	e	b	S ₁	S ₂	g	w	B ₁	n		dynamisch C Динамическая C	statisch C ₀ Статическая C ₀				kg
	mm/Zoll - мм/дюйм												mm/Zoll - мм/дюйм					
UCPX05 UCPX05-13 UCPX05-14 UCPX05-15 UCPX05-16	25 13/16 7/8 15/16 1	44,4 1 3/4	159 6 1/4	119 4 11/16	51 2	17 43/64	20 25/32	18 23/32	85 3 11/32	38,1 1,5000	15,9 0,626	M14 1/2	18525	10735	UCX05 UCX05-13 UCX05-14 UCX05-15 UCX05-16	PX05	1,5	
UCPX06 UCPX06-17 UCPX06-18 UCPX06-19 UCPX06-20	30 1 1/16 1 1/8 1 3/16 1 1/4	47,6 1 7/8	175 6 7/8	127 5	57 2 1/4	17 43/64	20 25/32	20 25/32	93 3 31/32	42,9 1,6890	17,5 0,689	M14 1/2	24415	14630	UCX06 UCX06-17 UCX06-18 UCX06-19 UCX06-20	PX06	2,0	
UCPX07 UCPX07-21 UCPX07-22 UCPX07-23	35 1 5/16 1 3/8 1 7/16	54,0 2 1/8	203 8	144 5 21/32	57 2 1/4	17 43/64	20 25/32	21 13/16	105 4 1/8	49,2 1,9370	19 0,748	M14 1/2	27645	16910	UCX07 UCX07-21 UCX07-22 UCX07-23	PX07	2,6	
UCPX08 UCPX08-24 UCPX08-25	40 1 1/2 1 9/16	58,7 2 5/16	222 8 3/4	156 6 5/32	67 2 5/8	20 25/32	23 29/32	26 11/32	111 4 3/8	49,2 1,9370	19 0,748	M16 5/8	32395	20235	UCX08 UCX08-24 UCX08-25	PX08	3,3	
UCPX09 UCPX09-26 UCPX09-27 UCPX09-28 UCPX09-29	45 1 5/8 1 11/16 1 3/4 1 13/16	58,7 2 5/16	222 8 3/4	156 6 5/32	67 2 5/8	20 25/32	23 29/32	26 11/32	116 4 9/16	51,6 2,0315	19 0,748	M16 5/8	33345	22135	UCX09 UCX09-26 UCX09-27 UCX09-28 UCX09-29	PX09	3,3	
UCPX10 UCPX10-30 UCPX10-31 UCPX10-32	50 1 7/8 1 11/16 2	63,5 2 1/2	241 9 1/2	171 6 47/64	73 2 7/8	20 25/32	23 29/32	27 11/16	126 4 31/32	55,6 2,1890	22,2 0,874	M16 5/8	41230	27930	UCX10 UCX10-30 UCX10-31 UCX10-32	PX10	4,3	
UCPX11 UCPX11-33 UCPX11-34 UCPX11-35 UCPX11-36 UCPX11-37	55 2 1/16 2 1/8 2 3/16 2 1/4 2 5/16	69,8 2 3/4	260 10 1/4	184 7 1/4	79 3 1/8	25 31/32	28 13/32	30 13/16	137 5 13/32	65,1 2,5630	25,4 1,000	M20 3/4	49780	34390	UCX11 UCX11-33 UCX11-34 UCX11-35 UCX11-36 UCX11-37	PX11	5,7	
UCPX12 UCPX12-38 UCPX12-39	60 2 3/8 2 7/16	76,2 3	286 11 1/4	203 8	83 3 9/32	25 31/32	28 13/32	33 15/16	151 5 15/16	65,1 2,5630	25,4 1,000	M20 3/4	54340	38095	UCX12 UCX12-38 UCX12-39	PX12	7,3	
UCPX13 UCPX13-40 UCPX13-41	65 2 1/2 2 9/16	76,2 3	286 11 1/4	203 8	83 3 9/32	25 63/64	28 13/32	33 15/16	154 6 1/16	74,6 2,9370	30,2 1,189	M20 3/4	59090	41895	UCX13 UCX13-40 UCX13-41	PX13	7,6	
UCPX14 UCPX14-42 UCPX14-43 UCPX14-44	70 2 5/8 2 11/16 2 3/4	88,9 3 1/2	330 13	229 9 1/32	89 3 1/2	27 11/16	30 13/16	35 13/8	170 6 11/16	77,8 3,0630	33,3 1,311	M22 7/8	64030	45885	UCX14 UCX14-42 UCX14-43 UCX14-44	PX14	9,9	
UCPX15 UCPX15-45 UCPX15-46 UCPX15-47 UCPX15-48	75 2 13/16 2 7/8 2 15/16 3	88,9 3 1/2	330 13	229 9 1/32	89 3 1/2	27 11/16	30 13/16	35 13/8	175 6 7/8	82,6 3,2520	33,3 1,311	M22 7/8	69065	50350	UCX15 UCX15-45 UCX15-46 UCX15-47 UCX15-48	PX15	11	
UCPX16 UCPX16-49 UCPX16-50 UCPX16-51 UCPX16-52	80 3 1/16 3 1/8 3 3/16 3 3/4	101,6 4	381 15	283 11 5/32	102 4 1/32	27 11/16	30 13/16	40 1 9/16	194 7 5/8	85,7 3,3740	34,1 1,343	M22 7/8	79800	58805	UCX16 UCX16-49 UCX16-50 UCX16-51 UCX16-52	PX16	15	
UCPX17 UCPX17-53 UCPX17-55	85 3 5/16 3 7/16	101,6 4	381 15	283 11 5/32	102 4 1/32	27 11/16	30 13/16	40 1 9/16	200 7 7/8	96 3,7795	39,7 1,563	M22 7/8	91295	67925	UCX17 UCX17-53 UCX17-55	PX17	16	
UCPX18 UCPX18-56 UCPX18-57	90 3 7/16 3 3/8	101,6 4	381 15	283 11 5/32	111 4 3/8	27 11/16	30 13/16	40 1 9/16	206 8 1/8	104 4,0945	42,9 1,689	M22 7/8	103550	77805	UCX18 UCX18-56 UCX18-57	PX18	17	
UCPX20 UCPX20-58 UCPX20-59 UCPX20-60 UCPX20-61	100 3 13/16 3 7/8 3 15/16 4	127 5	432 17	337 13 9/32	121 4 3/4	33 15/16	36 113/32	45 1 25/32	244 9 19/32	117,5 4,6260	49,2 1,937	M27 1	126350	99750	UCX20 UCX20-58 UCX20-59 UCX20-60 UCX20-61	PX20	30	

UKP2 Normale Reihe - Нормальная серия

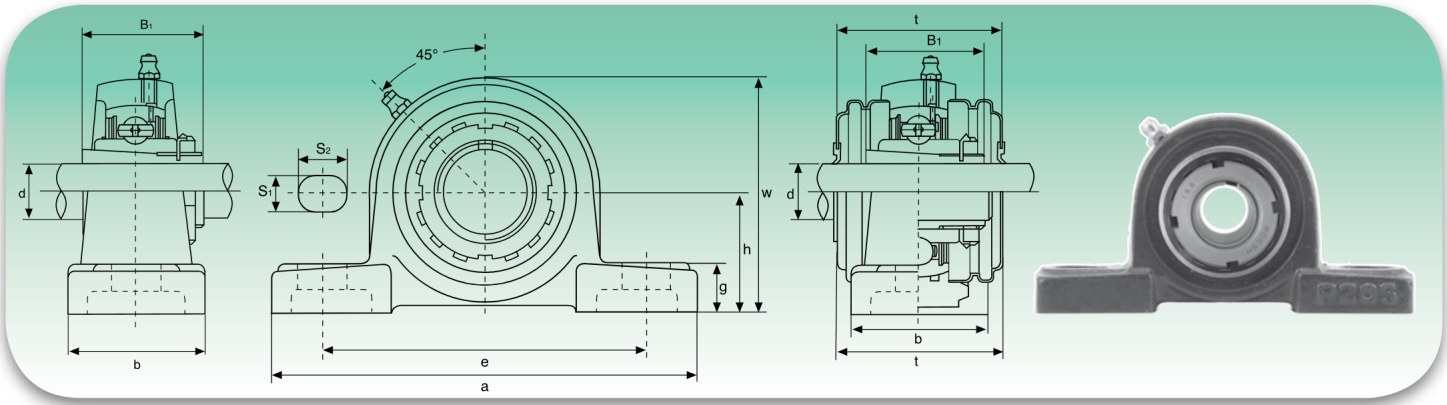

Typ Тип	Abmessungen - Размеры											Bef.Bolz. Креп. винт	Tragzahlen (N) Коэффициент нагрузки (H)		Lager Подшипник	Gehäuse Корпус	Gewicht Вес
	d	h	a	e	b	S ₁	S ₂	g	w	t	B ₁		dynamisch C _d	statisch C _s			
	mm/Zoll - мм/дюйм												mm/Zoll - мм/дюйм				
UKP205+H2305	20	36,5	140	105	38	13	19	15	71	48	35	M10	13300	7457	UK205+H2305	P205	0,86
UKP205+HE2305	¾	17/16	5½	41/8	1½	½	¾	19/32	225/32	157/64	1,378	3/8			UK205+HE2305		
UKP206+H2306	25	42,9	165	121	48	17	20	17	84	53	38	M14	18525	10735	UK206+H2306	P206	1,28
UKP206+HS2306	7/8	111/16	6½	4¾	17/8	43/64	25/32	43/64	35/16	25/64	1,496	½			UK206+HS2306		
UKP206+HE2306	1												UK206+HE2306				
UKP207+H2307	30	47,6	167	127	48	17	20	18	93	59,5	43	M14	24415	14630	UK207+H2307	P207	1,67
UKP207+HS2307	11/8	17/8	69/16	5	17/8	43/64	25/32	45/64	321/32	211/32	1,693	½			UK207+HS2307		
UKP208+H2308	35	49,2	184	137	54	17	20	18	100	69	46	M14	27645	16910	UK208+H2308	P208	1,99
UKP208+HE2308	1¼	115/16	7¼	513/32	21/8	43/64	25/32	45/64	315/16	223/32	1,811	½			UK208+HE2308		
UKP208+HS2308	13/8												UK208+HS2308				
UKP209+H2309	40	54	190	146	54	17	20	20	106	69	50	M14	32395	20235	UK209+H2309	P209	1,29
UKP209+HA2309	17/16	21/8	715/32	5¾	21/8	43/64	25/32	25/32	411/64	223/32	1,969	½			UK209+HA2309		
UKP209+HE2309	1½												UK209+HE2309				
UKP209+HS2309	15/8	UK209+HS2309															
UKP210+H2310	45	57,2	206	159	60	20	23	21	113	74,5	55	M16	33345	22135	UK210+H2310	P210	2,83
UKP210+HS2310	15/8	2¼	81/8	6¼	23/8	25/32	29/32	53/64	429/64	215/16	2,165	5/8			UK210+HS2310		
UKP210+HA2310	111/16												UK210+HA2310				
UKP210+HE2310	1¾	UK210+HE2310															
UKP211+H2311	50	63,5	219	171	60	20	23	23	125	76	59	M16	41230	27930	UK211+H2311	P211	3,46
UKP211+HS2311	17/8	2½	85/8	647/64	23/8	25/32	29/32	29/32	459/64	3	2,323	5/8			UK211+HS2311		
UKP211+HA2311	115/16												UK211+HA2311				
UKP211+HE2311	2	UK211+HE2311															
UKP212+H2312	55	69,8	241	184	70	20	23	25	138	89	62	M16	49780	34390	UK212+H2312	P212	4,95
UKP212+HS2312	21/8	2¾	9½	7¼	2¾	25/32	29/32	63/64	57/16	3½	2,441	5/8			UK212+HS2312		
UKP213+H2313	60	76,2	265	203	70	25	28	27	150	89	65	M20	54340	38095	UK213+H2313	P213	5,06
UKP213+HA2313	23/16	3	107/16	8	2¾	63/64	13/32	11/16	529/32	3½	2,559	¾			UK213+HA2313		
UKP213+HE2313	2¼												UK213+HE2313				
UKP213+HS2313	23/8	UK213+HS2313															
UKP215+H2315	65	82,6	275	217	74	25	28	28	162	-	73	M20	64030	45885	UK215+H2315	P215	7,27
UKP215+HA2315	27/16	3¼	1053/64	835/64	229/32	63/64	13/32	13/32	63/8	-	2,874	¾			UK215+HA2315		
UKP215+HE2315	2½	UK215+HE2315															
UKP216+H2316	70	88,9	292	232	78	25	28	30	174	-	78	M20	69065	50350	UK216+H2316	P216	8,36
UKP216+HA2316	211/16	3½	11½	91/8	31/16	63/64	13/32	13/16	627/32	-	3,071	¾			UK216+HA2316		
UKP216+HE2316	2¾	UK216+HE2316															
UKP217+H2317	75	95,2	310	247	83	25	28	32	185	-	82	M20	79800	58805	UK217+H2317	P217	10,23
UKP217+HA2317	215/16	3¾	1213/64	923/32	317/64	63/64	13/32	1¼	79/32	-	3,228	¾			UK217+HA2317		
UKP217+HE2317	3	UK217+HE2317															
UKP218+H2318	80	101,6	327	262	88	27	30	33	198	-	86	M22	91295	67925	UK218+H2318	P218	12,34
UKP218+HA2318	33/16	4	127/8	105/16	315/32	11/16	13/16	119/64	751/64	-	3,386	7/8			UK218+HA2318		

Hülsen HA; HE; HS mit Zollgewinde
Втулки HA; HE; HS с дюймовой резьбой

UKP3 Schwere Reihe - Тяжелая серия

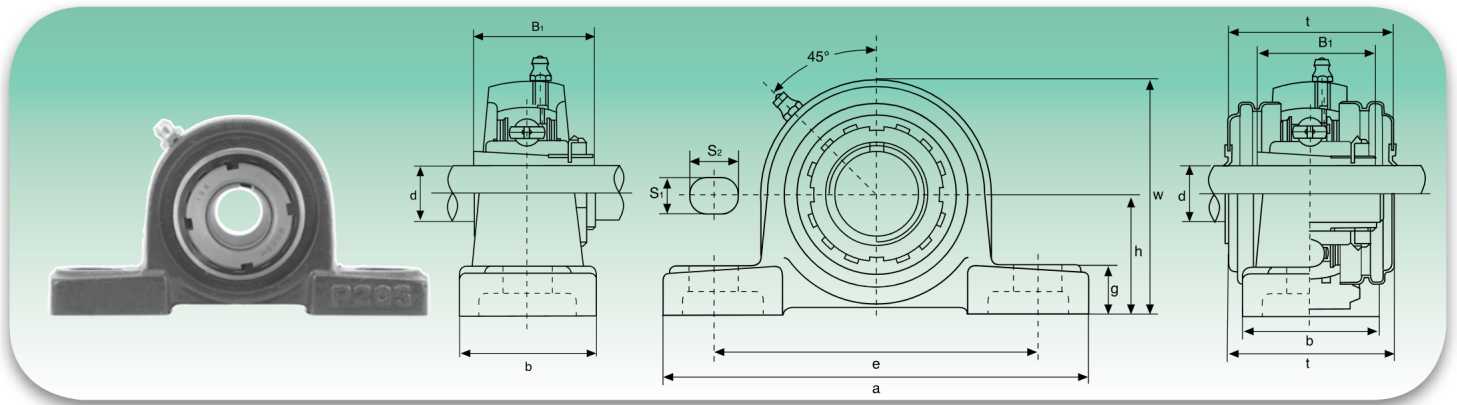

Typ Тип	Abmessungen - Размеры										Bef.Bolz. Креп. винт	Tragzahlen (N) Коэффициент нагрузки (H)		Lager Подшипник	Gehäuse Корпус	Gewicht Вес	
	d	h	a	e	b	S ₁	S ₂	g	w	B ₁		dynamisch C Динамическая C	statisch C ₀ Статическая C ₀				kg
	mm/Zoll - мм/дюйм											mm/Zoll - мм/дюйм					
UKP305+H2305 UCP305+HE2305	20 ¾	45 149/64	175 67/8	132 53/16	45 1¾	17 43/64	20 19/32	15 25/32	85 311/32	35 1,378	M14 ½	20140	10355	UK305+H2305 UK305+HE2305	P305	1,7	
UKP306+H2306 UKP306+HS2306 UKP306+HE2306	25 7/8 1	50 131/32	180 73/32	140 5½	50 131/32	17 43/64	20 25/32	18 23/32	95 3¾	38 1,496	M14 ½	25365	14250	UK306+H2306 UK306+HS2306 UK306+HE2306	P306	2,3	
UKP307+H2307 UKP307+HS2307	30 11/8	56 213/64	210 89/32	160 65/16	56 27/32	17 43/64	25 63/64	20 25/32	106 43/16	43 1,693	M14 ½	31730	18335	UK307+H2307 UK307+HS2307	P307	3,0	
UKP308+H2308 UKP308+HE2308 UKP308+HS2308	35 1¼ 13/8	60 223/64	220 821/32	170 611/16	60 23/8	17 43/64	27 11/16	22 7/8	116 49/16	46 1,811	M16 5/8	38665	22800	UK308+H2308 UK308+HE2308 UK308+HS2308	P308	3,8	
UKP309+H2309 UKP309+HA2309 UKP309+HE2309 UKP309+HS2309	40 17/16 1½ 15/8	67 141/64	245 921/32	190 715/32	67 25/8	20 25/32	30 13/16	24 15/16	129 53/32	50 1,969	M16 5/8	46455	28025	UK309+H2309 UK309+HA2309 UK309+HE2309 UK309+HS2309	P309	5,0	
UKP310+H2310 UKP310+HS2310 UKP310+HA2310 UKP310+HE2310	45 15/8 111/16 1¾	75 261/64	275 1013/16	212 811/32	75 215/16	20 25/32	35 13/8	27 11/16	143 55/8	55 2,165	M16 5/8	58900	36385	UK310+H2310 UK310+HS2310 UK310+HA2310 UK310+HE2310	P310	6,7	
UKP311+H2311 UKP311+HS2311 UKP311+HA2311 UKP311+HE2311	50 17/8 115/16 2	80 35/32	310 127/32	236 99/32	80 35/32	20 25/32	38 1½	30 13/16	154 61/16	59 2,323	M16 5/8	68020	42750	UK311+H2311 UK311+HS2311 UK311+HA2311 UK311+HE2311	P311	8,1	
UKP312+H2312 UKP312+HS2312	55 21/8	85 311/32	330 12	250 927/32	85 311/32	25 63/64	38 1½	32 1¼	165 6½	62 2,441	M20 ¾	77805	49590	UK312+H2312 UK312+HS2312	P312	9,4	
UKP313+H2313 UKP313+HA2313 UKP313+HE2313 UKP313+HS2313	60 23/16 2¼ 23/8	90 335/64	340 133/8	260 10¼	90 317/32	25 63/64	38 1½	33 15/16	176 615/16	65 2,559	M20 ¾	88065	56905	UK313+H2313 UK313+HA2313 UK313+HE2313 UK313+HS2313	P313	10,8	
UKP315+H2315 UKP315+HA2315 UKP315+HE2315	65 27/16 2½	100 315/16	380 1431/32	290 1113/32	100 315/16	27 11/16	40 19/18	35 13/8	198 725/32	73 2,874	M22 7/8	107350	73340	UK315+H2315 UK315+HA2315 UK315+HE2315	P315	14,9	
UKP316+H2316 UKP316+HA2316 UKP316+HE2316	70 211/16 2¾	106 411/64	400 15¾	300 1113/16	110 411/32	27 11/16	40 19/16	40 19/16	210 89/32	78 3,071	M22 7/8	116850	82365	UK316+H2316 UK316+HA2316 UK316+HE2316	P316	18,6	
UKP317+H2317 UKP317+HA2317 UKP317+HS2317	75 215/16 3	112 411/64	420 1617/32	320 1219/32	110 411/32	33 15/16	45 125/32	40 19/16	220 821/32	82 3,228	M27 1	126350	91960	UK317+H2317 UK317+HA2317 UK317+HS2317	P317	20,2	
UKP318+H2318 UKP318+HA2318	80 33/16	118 441/64	430 1615/16	330 13	110 411/32	33 15/16	45 125/32	45 125/32	235 9¼	86 3,386	M27 1	135850	101650	UK318+H2318 UK318+HA2318	P318	22,8	
UKP319+H2319 UKP319+HA2319	85 35/16	125 459/64	470 18½	360 143/16	120 423/32	36 113/32	50 131/32	45 125/32	250 927/32	90 3,543	M30 11/8	145350	113050	UK319+H2319 UK319+HA2319	P319	29,3	
UKP320+H2320 UKP320+HA2320	90 37/16	140 533/64	490 199/32	380 1431/32	120 423/32	36 113/32	50 131/32	50 131/32	275 1053/64	97 3,814	M30 11/8	164350	133950	UK320+H2320 UK320+HA2320	P320	34,8	
UKP322+H2322 UKP322+HA2322	100 315/16	150 529/32	520 2015/32	400 15¾	140 5½	40 19/16	55 25/32	55 25/32	300 1113/16	105 4,134	M33 1¼	194750	171000	UK322+H2322 UK322+HA2322	P322	43,9	
UKP324+H2324 UKP324+HA2324	110 43/16	160 619/64	570 227/16	450 1723/32	140 5½	40 19/16	55 25/32	65 121/32	320 1219/32	112 4,410	M33 1¼	196650	175750	UK324+H2324 UK324+HA2324	P324	55,7	
UKP326+H2326 UKP326+HA2326	115 47/16	180 73/32	600 235/8	480 1829/32	140 5½	40 19/16	55 25/32	75 261/64	335 1331/32	121 4,764	M33 1¼	217550	203300	UK326+H2326 UK326+HA2326	P326	71,9	
UKP328+H2328 UKP328+HA2328	125 415/16	200 77/8	620 2413/32	500 1911/16	140 5½	40 19/16	55 25/32	75 261/64	390 1532/64	131 5,158	M33 1¼	240350	233700	UK328+H2328 UK328+HA2328	P328	92,5	

Hülsen HA; HE; HS mit Zollgewinde
Втулки HA; HE; HS с дюймовой резьбой

UKPX Mittlere Reihe - Средняя серия

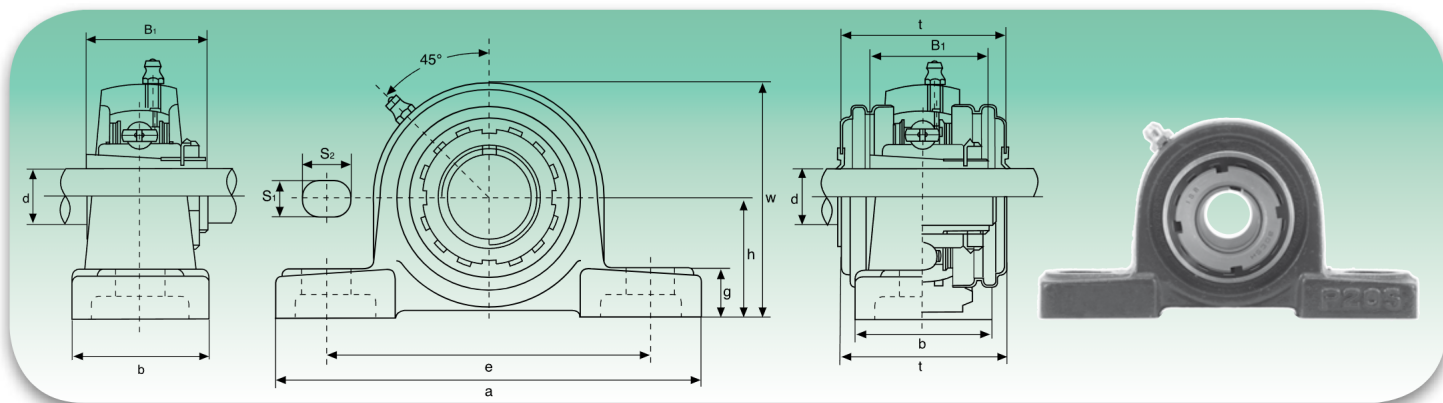

Typ Тип	Abmessungen - Размеры										Bef.Bolz. Креп. винт	Tragzahlen (N) Коэффициент нагрузки (H)		Lager Подшипник	Gehäuse Корпус	Gewicht Вес	
	d	h	a	e	b	S ₁	S ₂	g	w	B ₁		dynamisch C Динамическая C	statisch C ₀ Статическая C ₀				kg
	mm/Zoll - мм/дюйм											mm/Zoll - мм/дюйм					
UKPX05+H2305	20	44,4	159	119	51	17	20	18	85	35	M14	18525	10735	UKX05+H2305	PX05	1,5	
UKPX05+HE2305	¾	1¾	6¼	411/16	2	43/64	25/32	311/32	1,378	½	½			UKX05+HE2305			
UKPX06+H2306	25	47,6	175	127	57	17	20	20	93	38	M14	24415	14630	UKX06+H2306	PX06	2,1	
UKPX06+HS2306	7/8	17/8	67/8	5	2¼	43/64	25/32	25/32	321/32	1,496	½			UKX06+HS2306			
UKPX06+HE2306	1											UKX06+HE2306					
UKPX07+H2307	30	54,0	203	144	57	17	20	21	105	43	M14	27645	16910	UKX07+H2307	PX07	2,7	
UKPX07+HS2307	11/8	21/8	8	521/32	2¼	43/64	25/32	13/16	41/8	1,693	½			UKX07+HS2307			
UKPX08+H2308	35	58,7	222	156	67	20	23	26	111	46	M16	32395	20235	UKX08+H2308	PX08	3,5	
UKPX08+HE2308	1¼	25/16	8¾	65/32	25/8	25/32	29/32	11/32	43/8	1,811	5/8			UKX08+HE2308			
UKPX08+HS2308	13/8											UKX08+HS2308					
UKPX09+H2309	40	58,7	222	156	67	20	23	26	116	50	M16	33345	22135	UKX09+H2309	PX09	3,7	
UKPX09+HA2309	17/16	25/16	8¾	65/32	25/8	25/32	29/32	11/32	49/18	1,969	5/8			UKX09+HA2309			
UKPX09+HE2309	1½											UKX09+HE2309					
UKPX09+HS2309	15/8	UKX09+HS2309															
UKPX10+H2310	45	63,5	241	171	73	20	23	27	126	55	M16	41230	27930	UKX10+H2310	PX10	4,6	
UKPX10+HS2310	15/8	2½	9½	647/64	27/8	25/32	29/32	11/16	431/32	2,165	5/8			UKX10+HS2310			
UKPX10+HA2310	111/16											UKX10+HA2310					
UKPX10+HE2310	1¾	UKX10+HE2310															
UKPX11+H2311	50	69,8	260	184	79	25	28	30	137	59	M20	49780	34390	UKX11+H2311	PX11	6,2	
UKPX11+HS2311	17/8	2¾	10¼	7¼	31/8	31/32	13/32	13/16	513/32	2,323	¾			UKX11+HS2311			
UKPX11+HA2311	115/16											UKX11+HA2311					
UKPX11+HE2311	2	UKX11+HE2311															
UKPX12+H2312	55	76,2	286	203	83	25	28	33	151	62	M20	54340	38095	UKX12+H2312	PX12	7,5	
UKPX12+HS2312	21/8	3	11¼	8	39/32	63/64	13/32	15/16	2,441	¾	¾			UKX12+HS2312			
UKPX13+H2313	60	76,2	286	203	83	25	28	33	154	65	M20	59090	41895	UKX13+H2313	PX13	7,8	
UKPX13+HA2313	23/16	3	11¼	8	39/32	63/64	13/32	15/16	61/16	2,559	¾			UKX13+HA2313			
UKPX13+HE2313	2¼											UKX13+HE2313					
UKPX13+HS2313	23/8	UKX13+HS2313															
UKPX15+H2315	65	88,9	330	229	89	27	30	35	175	73	M22	69065	50350	UKX15+H2315	PX15	10,5	
UKPX15+HA2315	27/16	3½	13	91/32	3½	11/16	13/16	13/8	67/8	2,874	7/8			UKX15+HA2315			
UKPX15+HS2315	2½											UKX15+HS2315					
UKPX16+H2316	70	101,6	381	283	102	27	30	40	194	78	M22	79800	58805	UKX16+H2316	PX16	15,4	
UKPX16+HA2316	211/16	4	15	115/32	41/32	11/16	13/16	19/16	75/8	3,071	7/8			UKX16+HA2316			
UKPX16+HS2316	2¾											UKX16+HS2316					
UKPX17+H2317	75	101,6	381	283	102	27	30	40	200	82	M22	91295	67925	UKX17+H2317	PX17	15,8	
UKPX17+HA2317	215/16	4	15	115/32	41/32	11/16	13/16	19/16	77/8	3,228	7/8			UKX17+HA2317			
UKPX17+HE2317	3											UKX17+HE2317					
UKPX18+H2318	80	101,6	381	283	111	27	30	40	206	86	M22	103550	77805	UKX18+H2318	PX18	18,6	
UKPX18+HA2318	33/16	4	15	115/32	43/8	11/16	13/16	19/16	81/8	3,386	7/8			UKX18+HA2318			
UKPX20+H2320	¾											5	17	139/32	4¾	15/16	113/32
UKPX20+HA2320	3½	UKX20+HS2320															

Hülsen HA; HE; HS mit Zollgewinde
Втулки HA; HE; HS с дюймовой резьбой