

168 HARDTEC HARD STONE DRILL BIT



DRIVE



D Ø mm	D Ø 31	L2 mm	L1 mm	d Ø mm	Box	EAN 4016707...	12345
4,0	5/32	40	75	4	20	915772	168 000 040
5,0	3/16	50	85	5	20	915789	168 000 050
6,0	15/64	60	100	6	20	915796	168 000 060
8,0	5/16	75	120	8	20	915802	168 000 080
10,0	3/8	75	120	10	20	915857	168 000 100

EXECUTION



Certified product by
Prüfgemeinschaft Mauerbohrer (PGM)

- ISO 5468
- Diamond-ground carbide tip
- Universal drill bit with MS5 helix
- High-temperature brazing at about 1,120°C
- Special cutting helix with micro surface hardness
- Ground surface

FOR USE IN

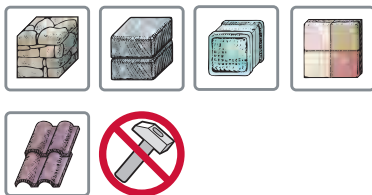

APPLICATION

- In all rotary and percussion drilling machines
- Only for rotary use
- High contact pressure
- Rotation speed approx. 1000 rpm

PACKAGING



[144]

SPECIAL FEATURES

Special carbide tip:

- High portion of tungsten carbide
- Homogenous fine structured grain
- Special cutting edge of 120°
- Precise diamond grinding

Materials:

- Expert for granite, gneissic rock, slate, basalt
- Specially suitable for hard ceramic tiles, porcelain and other hard materials

Advantages:

- Wear resistant carbide drill bit with long life time
- High drilling speed
- The drill bit can be resharpened with a diamond- or silicon carbide grinding wheel
- Very long service life

