

Гайка закладная кузовная квадратная

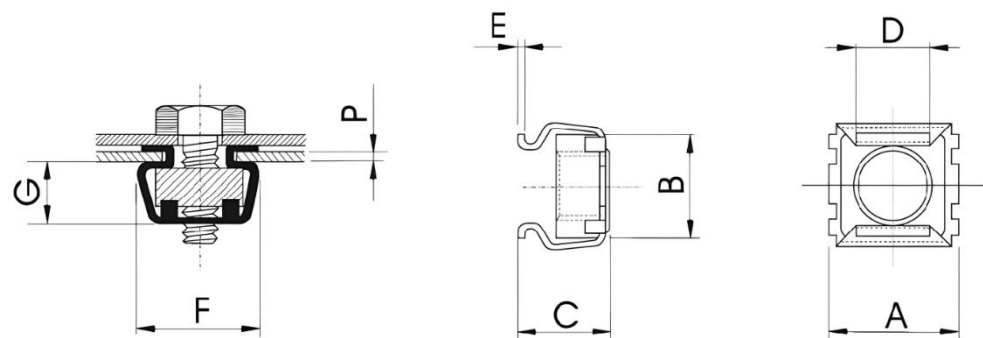

Диаметр резьбы	Толщина металла	Артикул	A +/- 0.6	B +/- 0.5	C +/- 0.3	D +/- 0.2	E	F +/- 0.3	G +/- 0.2	Отверстие в металле
M3	0.3-0.9	5303-A	9.8	8.5	5.1	4.8	0.3	9.8	3.7	5.3x5.3
	1.0-1.6	5303-B	9.8	8.5	5.8	4.8	0.3	9.8	3.7	5.3x5.3
	1.7-2.3	5303-C	9.8	8.5	6.6	4.8	0.3	9.8	3.7	5.3x5.3
	2.4-3.1	5303-D	9.8	8.5	7.6	4.8	0.3	9.8	3.7	5.3x5.3
M4	0.3-0.9	5304-A	9.8	8.5	5.1	4.8	0.3	9.8	3.7	5.3x5.3
	1.0-1.6	5304-B	9.8	8.5	5.8	4.8	0.3	9.8	3.7	5.3x5.3
	1.7-2.3	5304-C	9.8	8.5	6.6	4.8	0.3	9.8	3.7	5.3x5.3
	2.4-3.1	5304-D	9.8	8.5	7.6	4.8	0.3	9.8	3.7	5.3x5.3
M5	0.3-0.9	5305-A	9.8	8.5	5.1	4.8	0.3	9.8	3.7	5.3x5.3
	1.0-1.6	5305-B	9.8	8.5	5.8	4.8	0.3	9.8	3.7	5.3x5.3
	1.7-2.3	5305-C	9.8	8.5	6.6	4.8	0.3	9.8	3.7	5.3x5.3
	2.4-3.1	5305-D	9.8	8.5	7.6	4.8	0.3	9.8	3.7	5.3x5.3

M3	0.7-1.6	673-A	10	8.5	5.2	5.8	0.45	10.5	5	6.7x6.7
	1.7-2.6	673-B	10	8.5	7.2	5.8	0.45	10.5	5	6.7x6.7
M4	0.7-1.6	674-A	10	8.5	7.2	5.8	0.45	10.5	5	6.7x6.7
	1.7-2.6	674-B	10	8.5	8.2	5.8	0.45	10.5	5	6.7x6.7
M5	0.7-1.6	675-A	10	8.5	7.2	5.8	0.45	10.5	5	6.7x6.7
	1.7-2.6	675-B	10	8.5	8.2	5.8	0.45	10.5	5	6.7x6.7
M4	0.3-1.1	834-O	12	10.8	8	7.2	0.45	12.5	6	8.3x8.3
	1.2-1.6	834-A	12	10.8	8.3	7.2	0.45	12.5	6	8.3x8.3
	1.7-2.5	834-B	12	10.8	9.3	7.2	0.45	12.5	6	8.3x8.3
	2.6-3.5	834-C	12	10.8	10.1	7.2	0.45	12.5	6	8.3x8.3
	3.6-4.5	834-D	12	10.8	11	7.2	0.45	12.5	6	8.3x8.3
M5	0.3-1.1	835-O	12	10.8	8	7.2	0.45	12.5	6	8.3x8.3
	1.2-1.6	835-A	12	10.8	8.3	7.2	0.45	12.5	6	8.3x8.3
	1.7-2.5	835-B	12	10.8	9.3	7.2	0.45	12.5	6	8.3x8.3
	2.6-3.5	835-C	12	10.8	10.1	7.2	0.45	12.5	6	8.3x8.3
	3.6-4.5	835-D	12	10.8	11	7.2	0.45	12.5	6	8.3x8.3
M6	0.3-1.1	836-O	12	10.8	8	7.2	0.45	12.5	6	8.3x8.3
	1.2-1.6	836-A	12	10.8	8.3	7.2	0.45	12.5	6	8.3x8.3
	1.7-2.5	836-B	12	10.8	9.3	7.2	0.45	12.5	6	8.3x8.3
	2.6-3.5	836-C	12	10.8	10.1	7.2	0.45	12.5	6	8.3x8.3
	3.6-4.5	836-D	12	10.8	11	7.2	0.45	12.5	6	8.3x8.3
M4	0.7-1.6	954-A	13	12	8.6	7.7	0.45	13.5	6	9.5x9.5
	1.7-2.6	954-B	13	12	9.5	7.7	0.45	13.5	6	9.5x9.5
	2.7-3.5	954-C	13	12	10.2	7.7	0.45	13.5	6	9.5x9.5
M5	0.7-1.6	955-A	13	12	8.6	7.7	0.45	13.5	6	9.5x9.5
	1.7-2.6	955-B	13	12	9.5	7.7	0.45	13.5	6	9.5x9.5
	2.7-3.5	955-C	13	12	10.2	7.7	0.45	13.5	6	9.5x9.5
M6	0.7-1.6	956-A	13	12	8.6	7.7	0.45	13.5	6	9.5x9.5
	1.7-2.6	956-B	13	12	9.5	7.7	0.45	13.5	6	9.5x9.5
	2.7-3.5	956-C	13	12	10.2	7.7	0.45	13.5	6	9.5x9.5
M4	0.7-1.6	904-AS	13.3	12	8.5	7	0.5	13.5	6.5	9x9

	1.7-2.6	904-BS	13.3	12	9.6	7	0.5	13.5	6.5	9x9
	2.7-3.5	904-CS	13.3	12	10.2	7	0.5	13.5	6.5	9x9
M5	0.7-1.6	905-AS	13.3	12	8.5	7	0.5	13.5	6.5	9x9
	1.7-2.6	905-BS	13.3	12	9.6	7	0.5	13.5	6.5	9x9
	2.7-3.5	905-CS	13.3	12	10.2	7	0.5	13.5	6.5	9x9
M6	0.7-1.6	906-AS	13.3	12	8.5	7	0.5	13.5	6.5	9x9
	1.7-2.6	906-BS	13.3	12	9.6	7	0.5	13.5	6.5	9x9
	2.7-3.5	906-CS	13.3	12	10.2	7	0.5	13.5	6.5	9x9
M6	0.7-1.7	1236-AS*	16.5	14.7	10.4	7.5	0.6	17.5	7.6	12.3x12.3
	1.8-3.1	1236-BS*	16.5	14.7	12	7.5	0.6	17.5	7.6	12.3x12.3
M8	0.7-1.7	1238-AS*	16.5	14.7	10.4	7.5	0.6	17.5	7.6	12.3x12.3
	1.8-3.1	1238-BS*	16.5	14.7	12	7.5	0.6	17.5	7.6	12.3x12.3
M10	0.7-1.7	1231-AS*	16.5	14.7	10.4	7.5	0.6	17.5	7.6	12.3x12.3
	1.8-3.1	1231-BS*	16.5	14.7	12	7.5	0.6	17.5	7.6	12.3x12.3
M6	0.7-1.7	1236-A	16.6	15	10	8.5/11*	0.5	16.5	7.2	12.3x12.3
	1.8-3.2	1236-B	16.6	15	11.4	8.5/11*	0.5	16.5	7.2	12.3x12.3
	3.3-4.7	1236-C	16.6	15	12.8	8.5/11*	0.5	16.5	7.2	12.3x12.3
	4.8-6.2	1236-D	16.6	15	14	8.5/11*	0.5	16.5	7.2	12.3x12.3
M8	0.7-1.7	1238-A	16.6	15	10	8.5/11*	0.5	16.5	7.2	12.3x12.3
	1.8-3.2	1238-B	16.6	15	11.4	8.5/11*	0.5	16.5	7.2	12.3x12.3
	3.3-4.7	1238-C	16.6	15	12.8	8.5/11*	0.5	16.5	7.2	12.3x12.3
	4.8-6.2	1238-D	16.6	15	14	8.5/11*	0.5	16.5	7.2	12.3x12.3
M10	0.7-1.7	1231-A	16.6	15	10	8.5/11*	0.5	16.5	7.2	12.3x12.3
	1.8-3.2	1231-B	16.6	15	11.4	8.5/11*	0.5	16.5	7.2	12.3x12.3
	3.3-4.7	1231-C	16.6	15	12.8	8.5/11*	0.5	16.5	7.2	12.3x12.3
	4.8-6.2	1231-D	16.6	15	14	8.5/11*	0.5	16.5	7.2	12.3x12.3
M8	0.7-1.7	1408-A	20	18	13.5	12.6	0.6	20.5	10.4	14x14
	1.8-3.2	1408-B	20	18	15	12.6	0.6	20.5	10.4	14x14
	3.3-4.7	1408-C	20	18	16.5	12.6	0.6	20.5	10.4	14x14
	4.8-6.2	1408-D	20	18	18	12.6	0.6	20.5	10.4	14x14
M10	0.7-1.7	1410-A	20	18	13.5	12.6	0.6	20.5	10.4	14x14

	1.8-3.2	1410-B	20	18	15	12.6	0.6	20.5	10.4	14x14
	3.3-4.7	1410-C	20	18	16.5	12.6	0.6	20.5	10.4	14x14
	4.8-6.2	1410-D	20	18	18	12.6	0.6	20.5	10.4	14x14
M12	0.7-1.7	1412-A	20	18	13.5	12.6	0.6	20.5	10.4	14x14
	1.8-3.2	1412-B	20	18	15	12.6	0.6	20.5	10.4	14x14
	3.3-4.7	1412-C	20	18	16.5	12.6	0.6	20.5	10.4	14x14
	4.8-6.2	1412-D	20	18	18	12.6	0.6	20.5	10.4	14x14