

The perfect size of premium  
megayachts for MICE&Charters

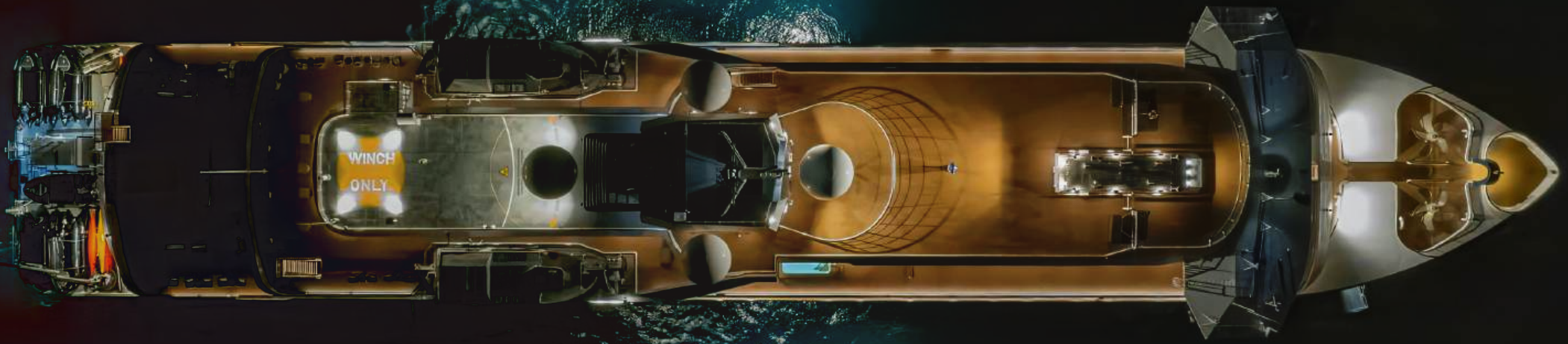

 **SWAN  
HELLENIC**

# Course for success

- Shipowner and cruise operator of its own fleet;
- 3 newest expedition megayachts of high polar class;
- Worldwide geography;
- Expedition and cultural cruises;
- Educational program and built around the itinerary;
- “Ultra All Inclusive” system;
- Personalized service on board - guest to crew ratio close to 1:1;



Creatively conceived  
and designed specially for expeditions





Visiting remote and inaccessible corners of the world even in the absence of onshore infrastructure

The compact size of the vessel allows you to visit the smallest bays and narrowest straits



Safe and comfortable landings  
on Zodiac boats

 SWAN  
HELLENIC



Navigation in “expedition mode” provides maximum opportunities for exploration



Flexibility in daily routing and schedule



Accustomed comfort and service  
surrounded by elegance  
regardless of the itinerary



 SWAN  
HELLENIC

Unrivaled Ultra All Inclusive system

 SWAN  
HELLENIC



Private and friendly atmosphere  
in the company of like-minded people



High-quality educational program built around the itinerary: the-best-in-their-field invited experts and lecturers



# Experienced crew



# MICE & Charters



- Full charter or group booking for a theme-based event
  - for premium customers
  - for corporate purposes
- Private charter for a cruise with family and friends

- All necessary equipment for conferences, parties and concerts is included in the price
- Multiple entertainment activities in the lounges and on the open deck according to the charterer's wishes: tennis competition for guests, music parties and movie under stars, barbecues and so on.



# Expedition Fleet



	<b>SH Minerva</b>	<b>SH Vega</b>	<b>SH Diana</b>
Entered into service	November 2025	July 2022	April 2023
Порт приписки	Liberia	Liberia	Liberia
Polar class	PC5	PC5	PC6
Guest capacity	152	152	192
Staff	120	120	141
No. of Decks	9	9	9
Length	113 m	113 m	125 m
Width	20,2 m	20,2 m	23 m
Gross Tonnage	10 500 GRT	10 500 GRT	12 100 GRT

The youngest and most innovative fleet  
in the expedition sector

 SWAN  
HELLENIC



# Deck Plan SH Vega

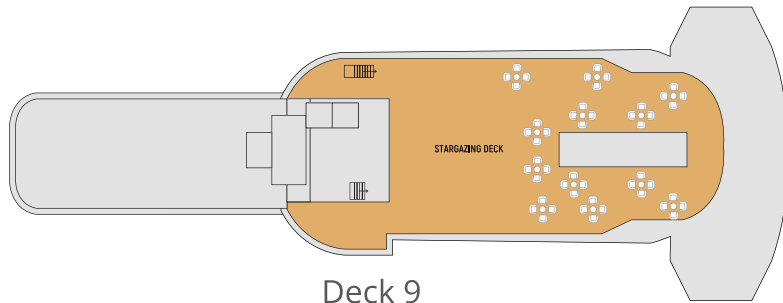

Deck 9

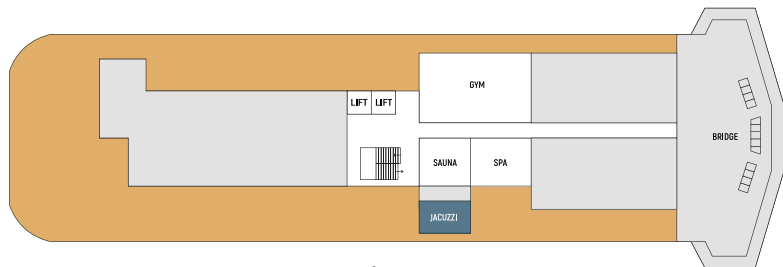

Deck 8

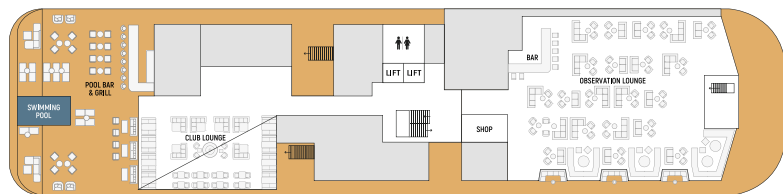

Deck 7

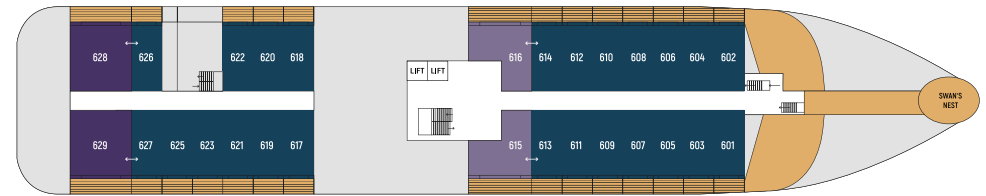

Deck 6

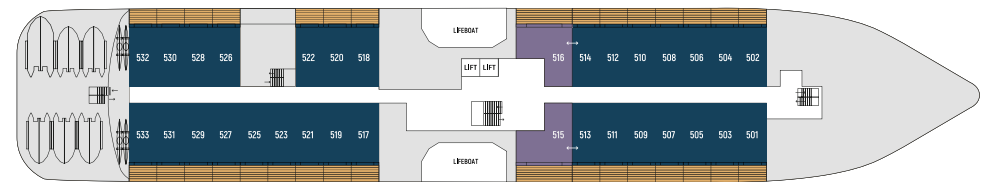

Deck 5

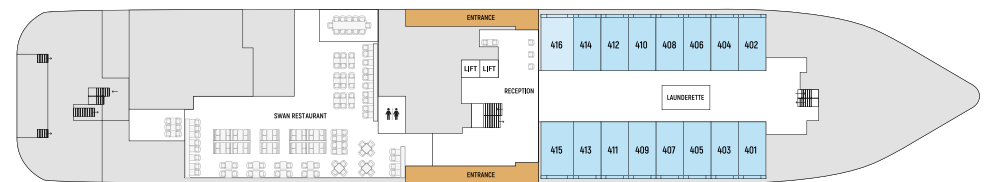

Deck 4

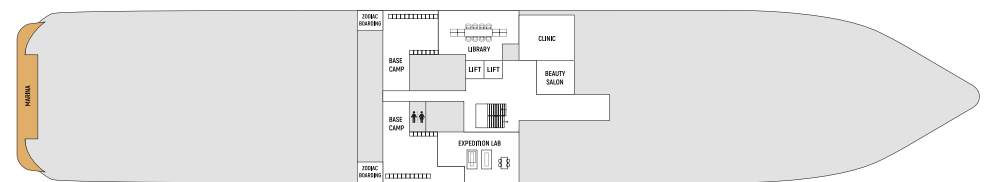

Deck 3

Public areas decks 3, 4, 7, 8, 9  
Staterooms decks 4, 5, 6

# Sophisticated infrastructure and spacious public areas

Public areas	Capacity, pers	Area, sq. m.
Observation Deck		365
Observation Lounge	150	385
Club Lounge	70	164
Pool Bar and Grill	41	225
Swan Restaurant	150	315
Chef's Table	10	23
Spa, Beauty Salon and Sauna	6	51
Gym		43
Library and Expedition Office	9	42
Expedition Lab	12	29
Base Camp	40	128
Swan Nest	25	16

The highest ratio of public areas on board per 1 passenger in the industry



# Observation Deck



No matter what destination are exploring our guests are in, they enjoy spending time on the Observation Deck, the best place to admire the world around vessel.

Area - 365 m2.

During the cruise our guests enjoy the advantage to:

- watch birds or whales swimming by
- admire icebergs and fjords
- take a sunbath
- discover new experiences with the expedition team
- catch the best shots
- gaze up at stars and constellations in the night sky

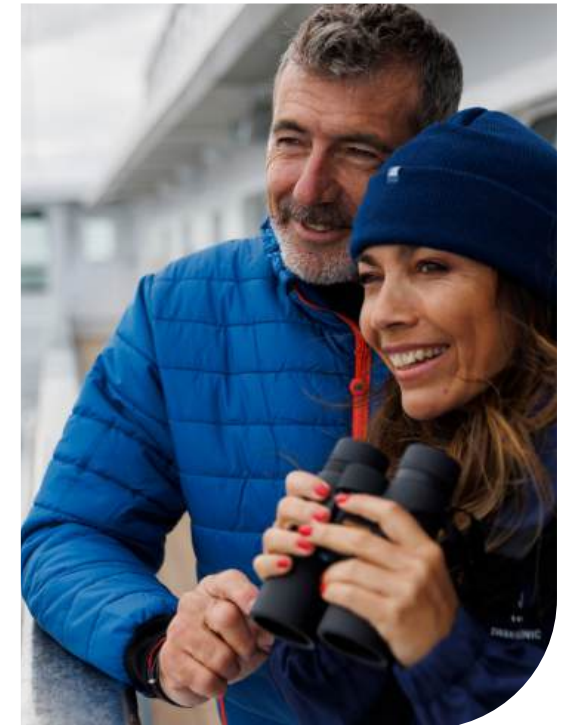

# Observation Deck

SWAN  
HELLENIC



# Observation Deck

 SWAN  
HELLENIC

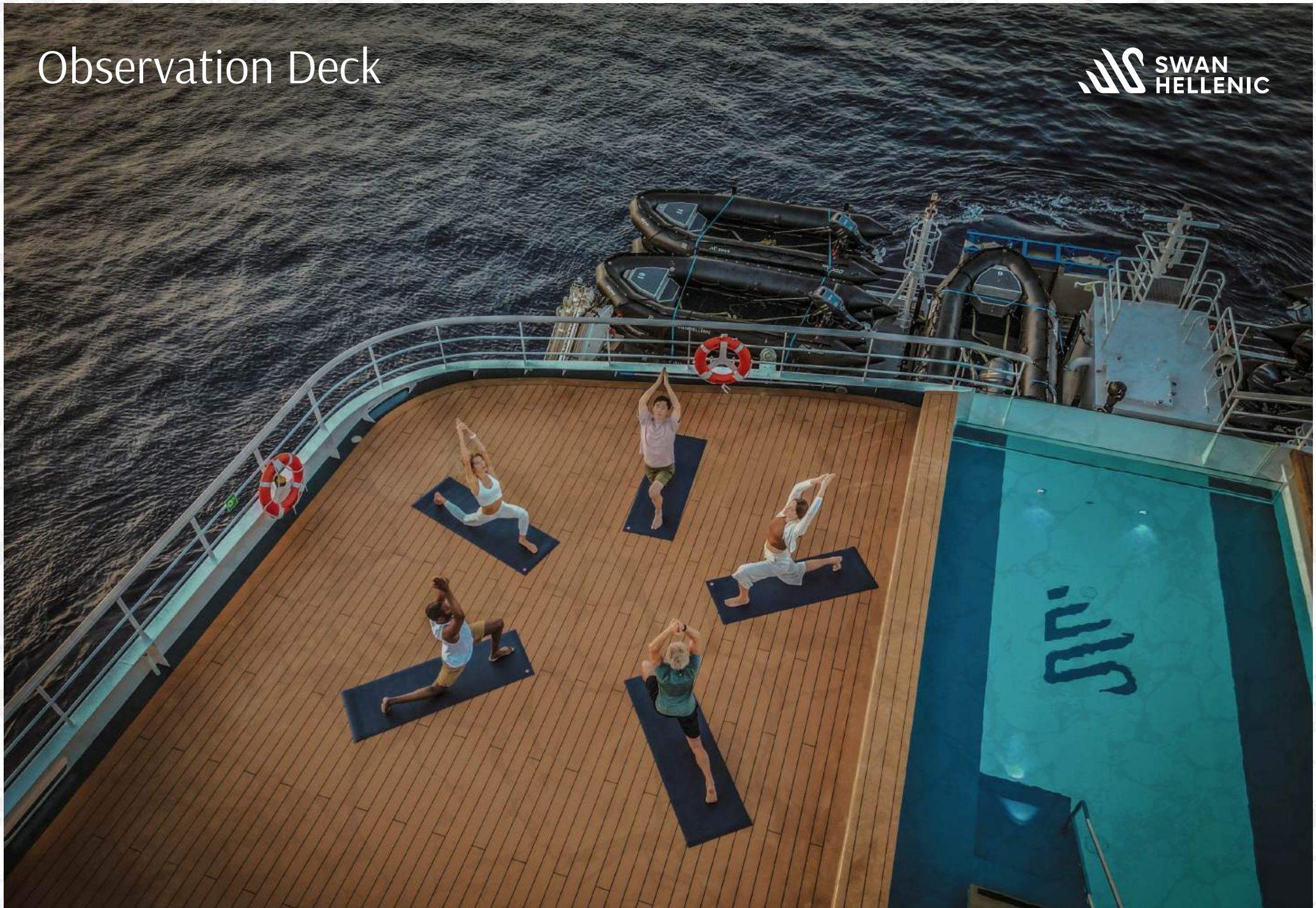

# Central Staircase and Reception



# Central Staircase and Reception





Central Staircase and Reception



# Observation Lounge



Area 385 sq.m.  
Capacity 150 guests  
Stage 15 sq.m.  
Opening hours 24 hours a day

# Observation Lounge



The area of absolute contrasts with chrome and massive panoramic windows, soft sofas and armchairs impresses with a diverse selection of cozy places to relax, both inside and outdoors.



# Observation Lounge



Sound equipment on board allows to arrange both performances of professional musicians and singers and as well as private concerts:

- acoustic guitar
- bass and electric guitars
- drum kit
- synthesizer
- microphones
- electric piano
- speaker system and lights



Experienced expedition team members and top guest experts in geology, glaciology, ornithology, marine biology and history accompany the cruise with lectures, presentations, scientific facts and amazing stories.

Movies

SWAN  
HELLENIC



# Observation Lounge

SWAN  
HELLENIC



# Observation Lounge



# Observation Lounge

 SWAN  
HELLENIC

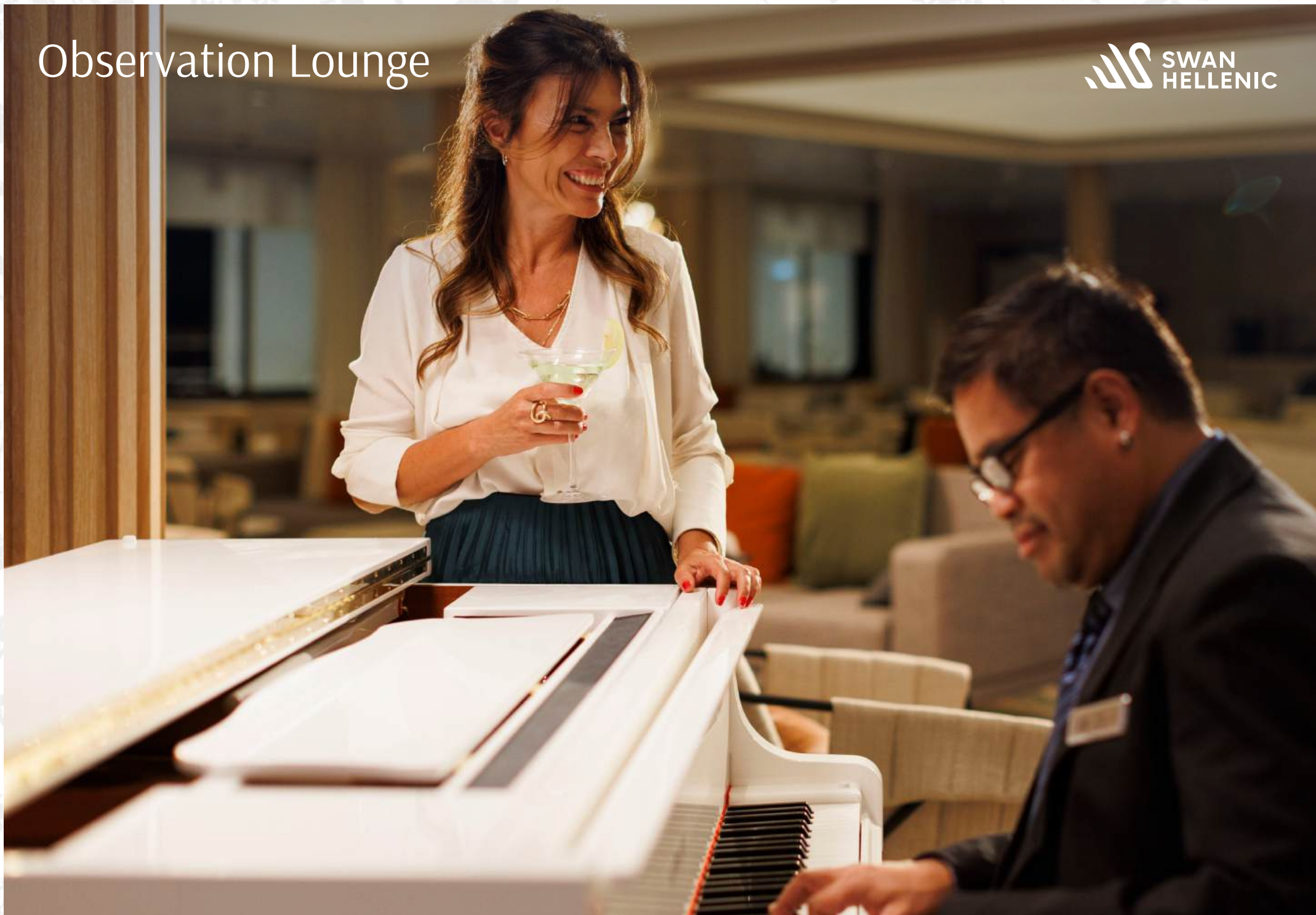

# Cards Room

 SWAN  
HELLENIC



# Swan Restaurant



The main restaurant on board can comfortably accommodate all cruise guests in one sitting.

Breakfast and lunch are served in buffet style. Open-seating system allows the guests to eat whenever they want and with whomever they want.

Changes in lighting and table settings transform daytime casual comfort into a sophisticated atmosphere for dinner in the evening.

Dietary, vegetarian, and gluten-free menus are available.

Area 315 sq.m.  
Capacity 150 guests  
Opening hours from morning to evening



# Swan Restaurant

 SWAN  
HELLENIC

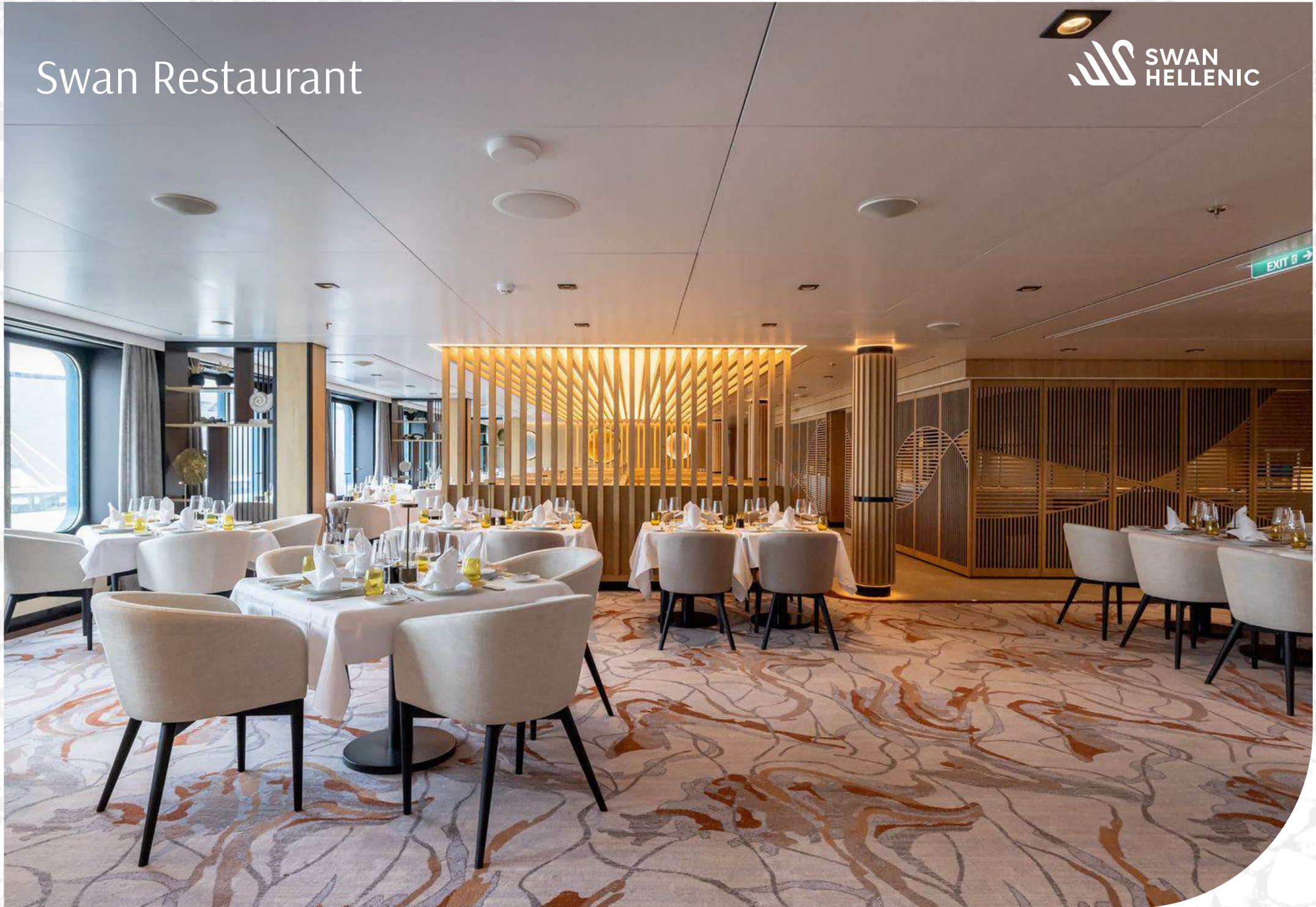

# Swan Restaurant

 SWAN  
HELLENIC





Swan Restaurant





Swan Restaurant



# Private Dining Room



Area 23 sq.m.  
Capacity 10 guests  
Opening hours daily in the evening  
or on request

# Private Dining Room



# Private Dining Room

SWAN  
HELLENIC



# Club Lounge



The bright and welcoming Club Lounge is always the center of attraction, serving customized dishes and a whole palette of promising culinary delights.

The freshest pizza from a special Italian oven or traditional tapas, to which signature Swan Hellenic cocktail goes so well, make the Club Lounge the perfect place to socialize and get-togethers.

Signature tapas and tempting seasonal local specialties, complemented by panoramic views of the ocean, are available to guests 24 hours a day.

Area 164 sq.m.  
Capacity 70 guests  
Opening hours 24 hours a day



# Club Lounge

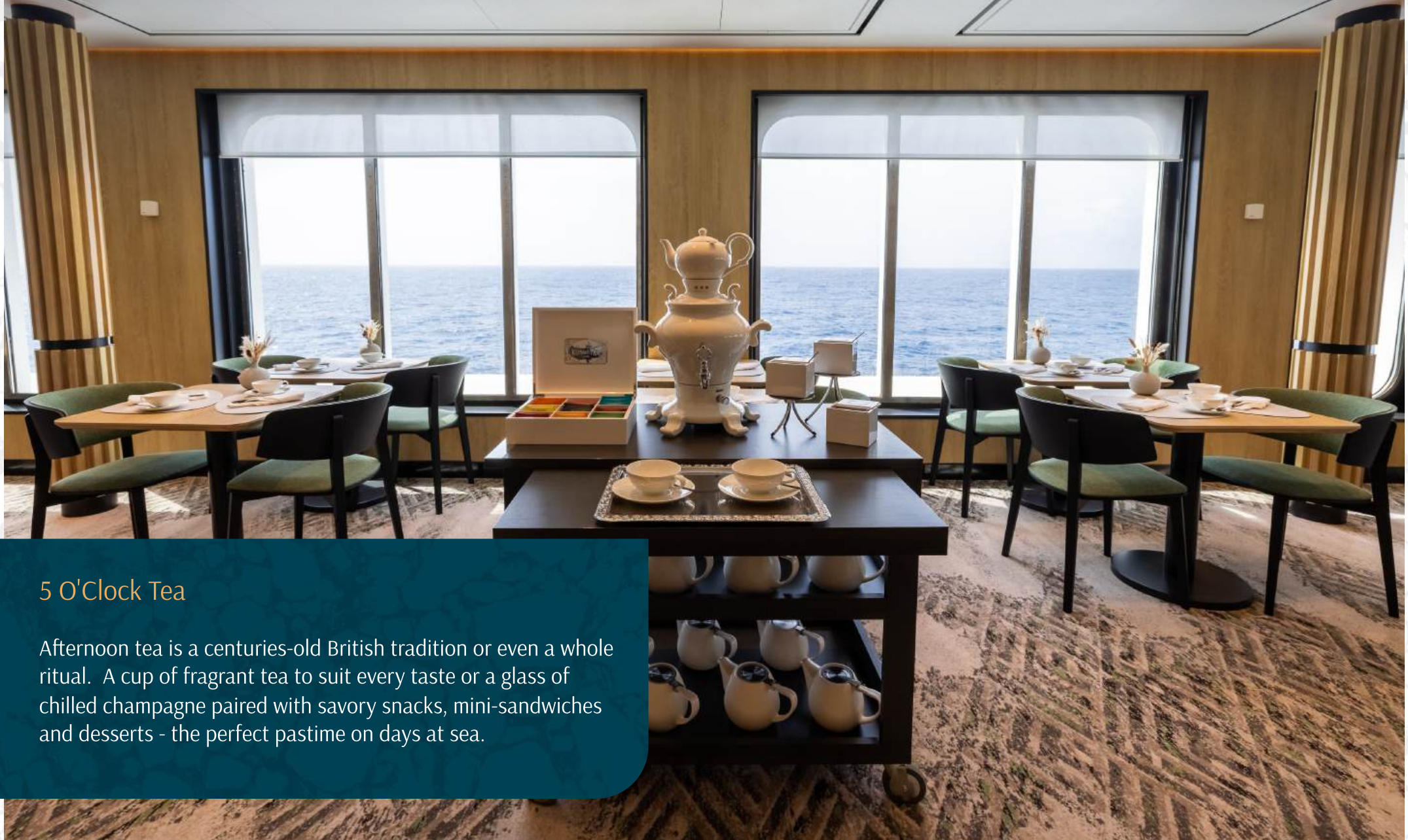

## 5 O'Clock Tea

Afternoon tea is a centuries-old British tradition or even a whole ritual. A cup of fragrant tea to suit every taste or a glass of chilled champagne paired with savory snacks, mini-sandwiches and desserts - the perfect pastime on days at sea.

# Club Lounge



# Club Lounge

SWAN  
HELLENIC



# Club Lounge



# Pool Bar & Grill

The perfect place to enjoy not only the gastronomic component - dishes created from local fresh seasonal ingredients and flavorful wines - but also the changing landscapes of the cities and countries from which they were delivered.

Area 225 sq.m.  
Capacity 41 guests  
Opening hours from morning to evening



# Outdoor Infinity Pool With Ocean View

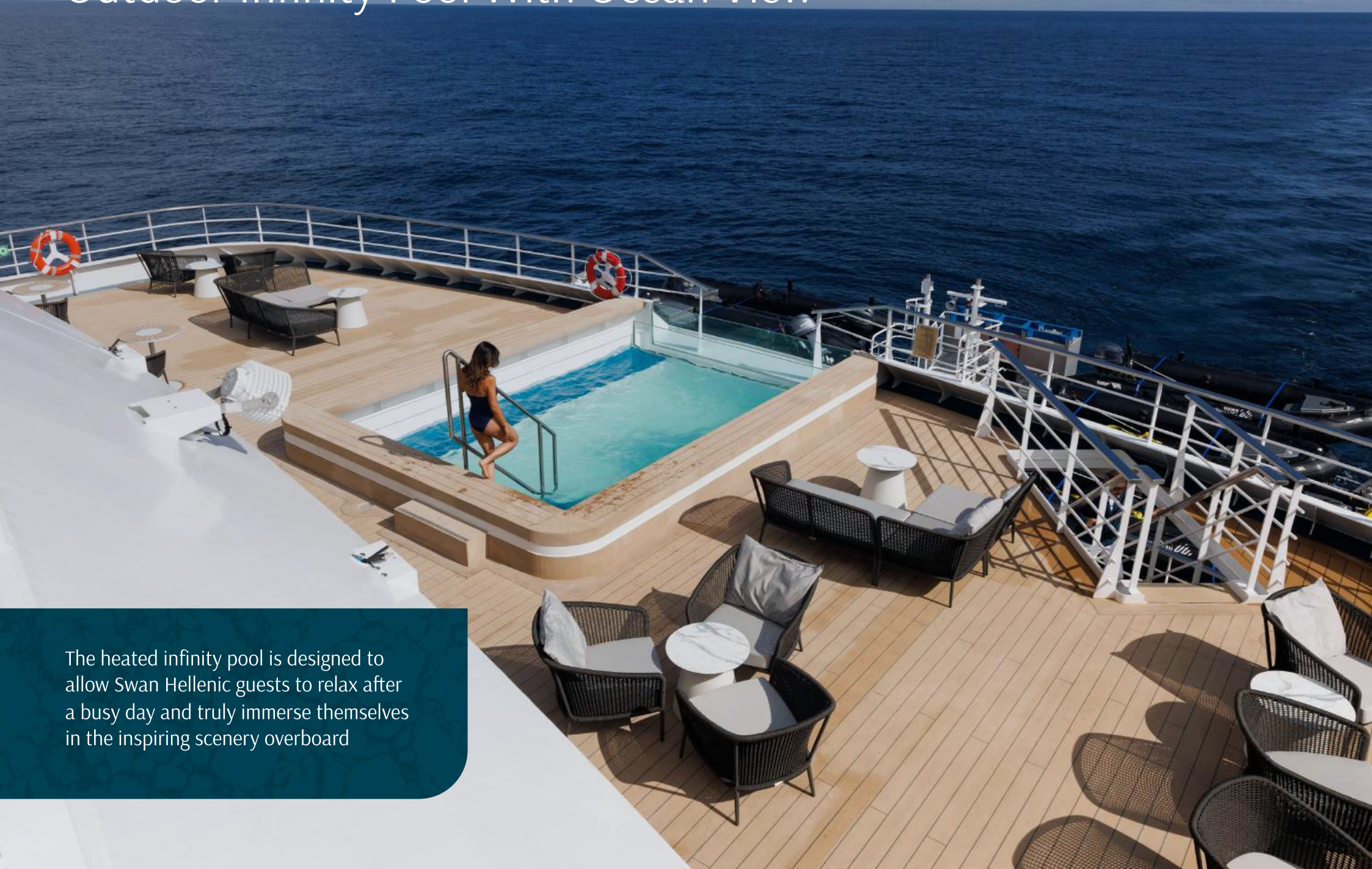

The heated infinity pool is designed to allow Swan Hellenic guests to relax after a busy day and truly immerse themselves in the inspiring scenery overboard

# Outdoor Infinity Pool With Ocean View



# Spa and Beauty Salon

 SWAN  
HELLENIC



Area 51 sq.m.  
Capacity 5 guests

# Spa and Beauty Salon

SWAN  
HELLENIC

Area 51 sq.m.  
Capacity 5 guests



Panoramic Sauna with jacuzzi  
on the open deck

 SWAN  
HELLENIC



# Panoramic Sauna with jacuzzi on the open deck



Length 4 m  
Width 2.45 m  
Capacity 6 guests



Here, after a relaxing massage, guests can admire surrounding views..

Outdoor hot tubs allow guests to refresh themselves after the sauna.



# Gym



Modern Gym on board features: cardio machines, stretching bands, free weights and of course group and personal training from yoga and pilates to meditation and weight training.

Swan Hellenic guests do not have to interrupt their regular training sessions: everything is available onboard to continue sports activities as usual wherever in the world.



Area 43 sq.m.

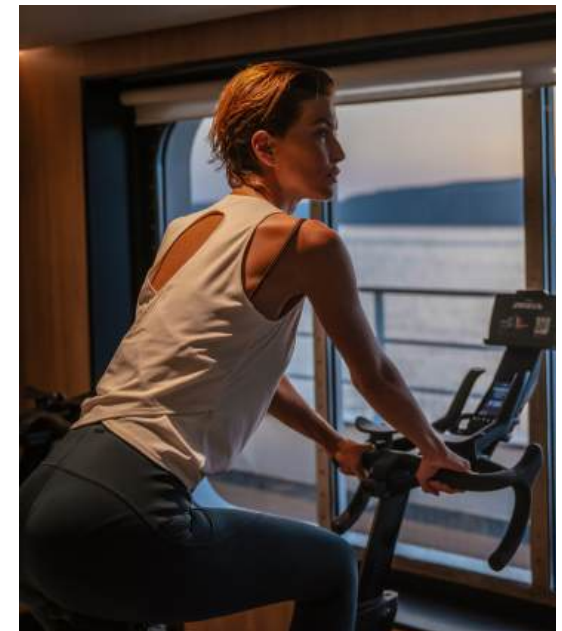

Gym

 SWAN  
HELLENIC



Gym

SWAN  
HELLENIC



# Expedition equipment



# Water activities

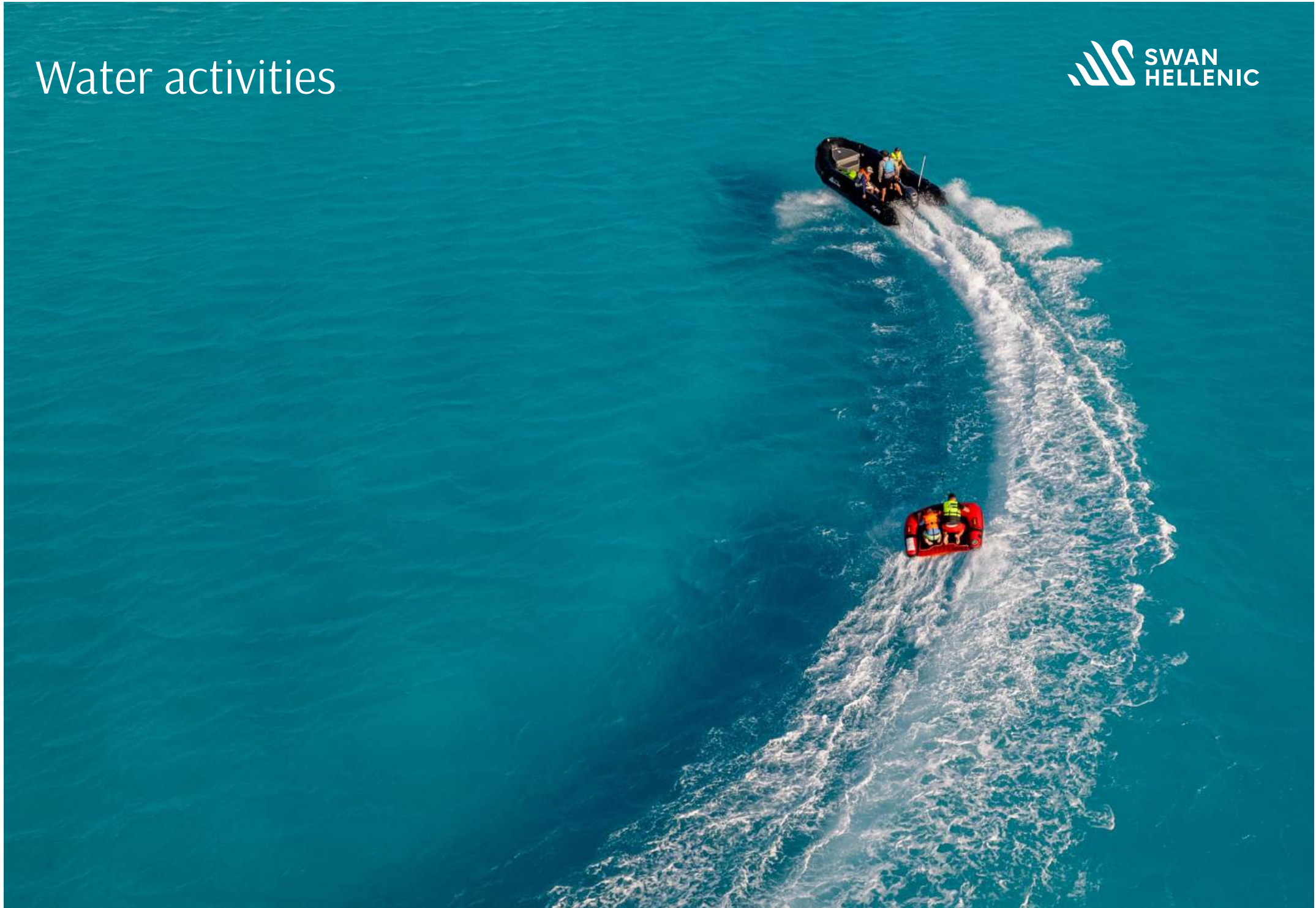

# Water activities



# Water activities



# Library and Expedition Office



Every Swan Hellenic cruise is an ocean of opportunities to develop creative passions.

Our Library features has a large selection of literature on a variety of subjects from history and geography, to biology and astrophysics, photo books, rare and albums editions, books about voyages, great geographical discoveries and destinations we visit.

Here everyone can find a book according to their interests. For the youngest passengers there is a plenty of books about the Arctic and Antarctic. The Library also offers a large selection of board games.

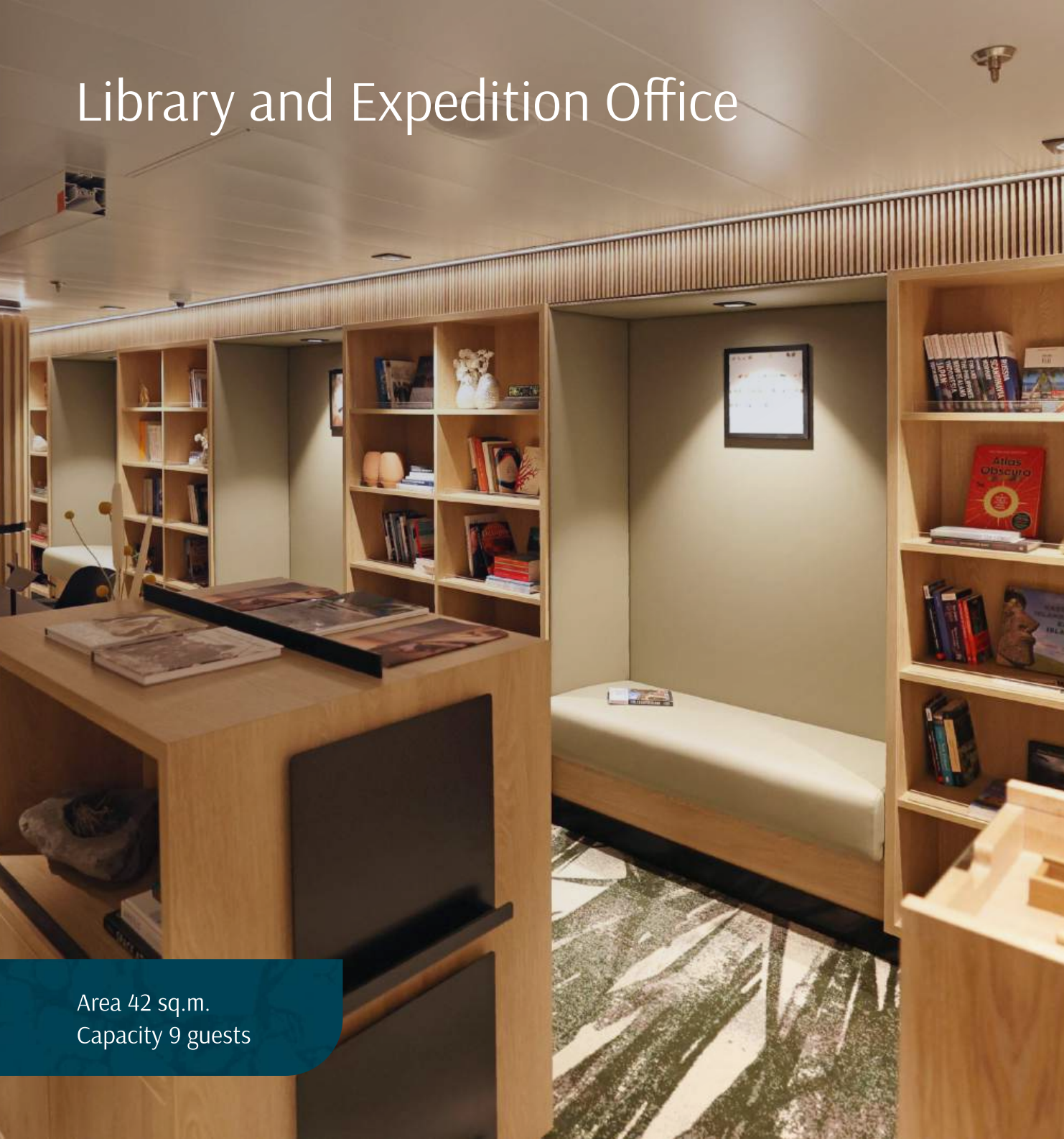

Area 42 sq.m.  
Capacity 9 guests



# Expedition Lab

 SWAN  
HELLENIC

Area 29 sq.m.  
Capacity 12 guests



# Art on board



Thanks to the art on board, during a voyage you can make several journeys at once: a large geographical journey over the world, a medium journey within the ship, and a small journey over one's inner world.

The works of art here are not objects of pilgrimage, they are organically embedded in the environment and live their own life near you throughout the journey.



# Art on board



# Art on board



# Base Camp



The perfect place to start and end every excursion.

Here the Guests are helped to prepare their expedition outfit before disembarkation and leave the outfit for further cleaning, disinfection and drying after the landing.

76 lockers  
Area 128 sq.m.  
Capacity 40 guests



# Base Camp

SWAN  
HELLENIC



The lobby's elegant interiors feature a signature design with natural textures and tones. You can always relax and share impressions with a warming cup of coffee in hands after your landings.

# Base Camp

 SWAN  
HELLENIC

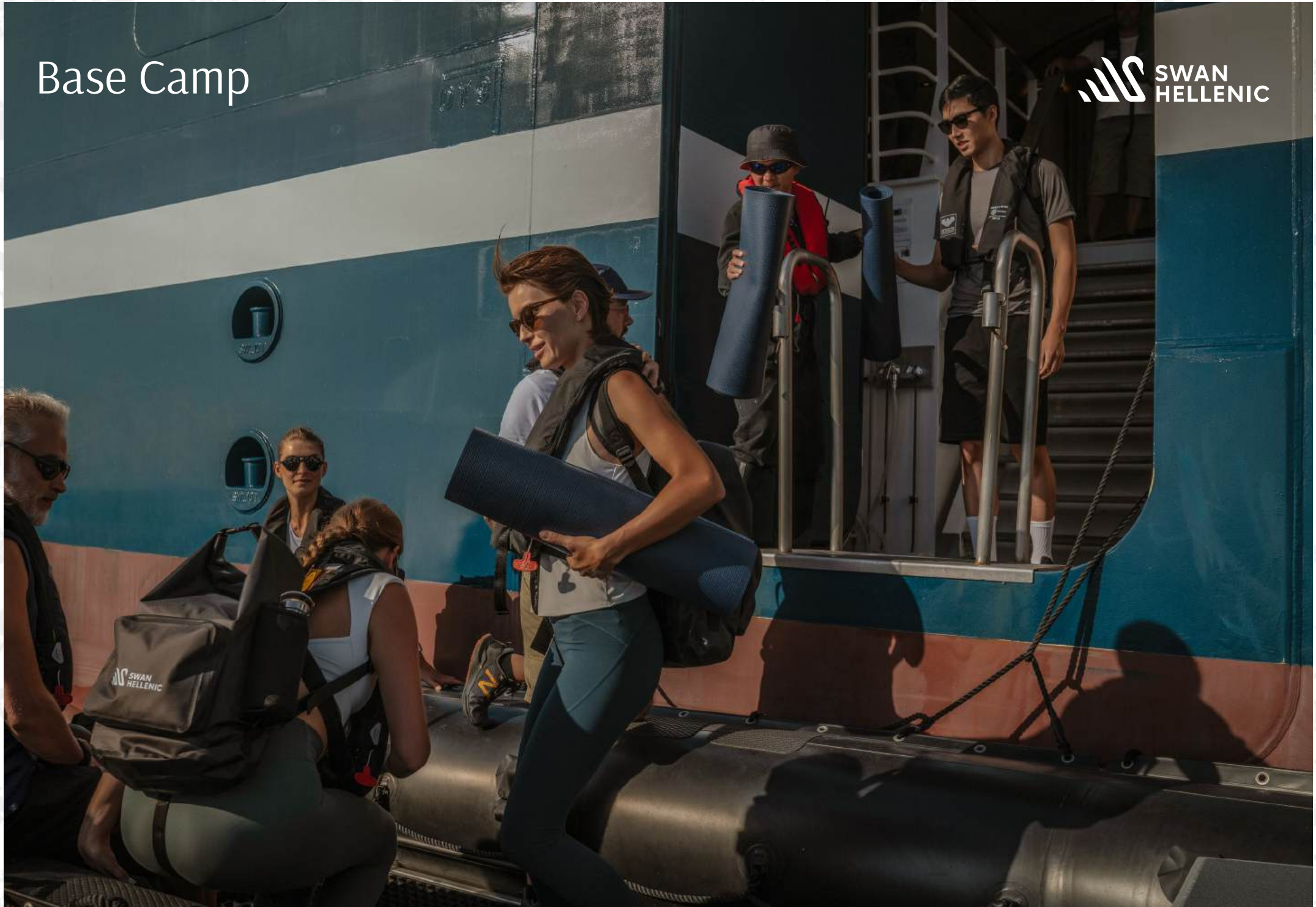

# Swan Nest

Panoramic Area at the bow of the vessel for impeccable shots of the ever-changing inspiring scenery overboard.

Area 16 sq.m.  
Capacity 25 guests  
Open 24 hours a day



# Staterooms

Maximum passenger capacity for double occupancy 152 guests



76 staterooms  
6 pairs of staterooms are connected

## Premium Suite

2 staterooms – 49 m<sup>2</sup>, balcony – 12 m<sup>2</sup>, wardrobe – 5 m<sup>2</sup>

## Suite

4 staterooms – 44 m<sup>2</sup>, balcony – 12 m<sup>2</sup>

## Balcony

54 staterooms – 28 m<sup>2</sup>, balcony – 6 m<sup>2</sup>

## Oceanview

16 staterooms – 19 m<sup>2</sup>

Only on SH Vega additional 2 pairs of connected balcony staterooms.

1 oceanview stateroom is equipped for handicapped passengers

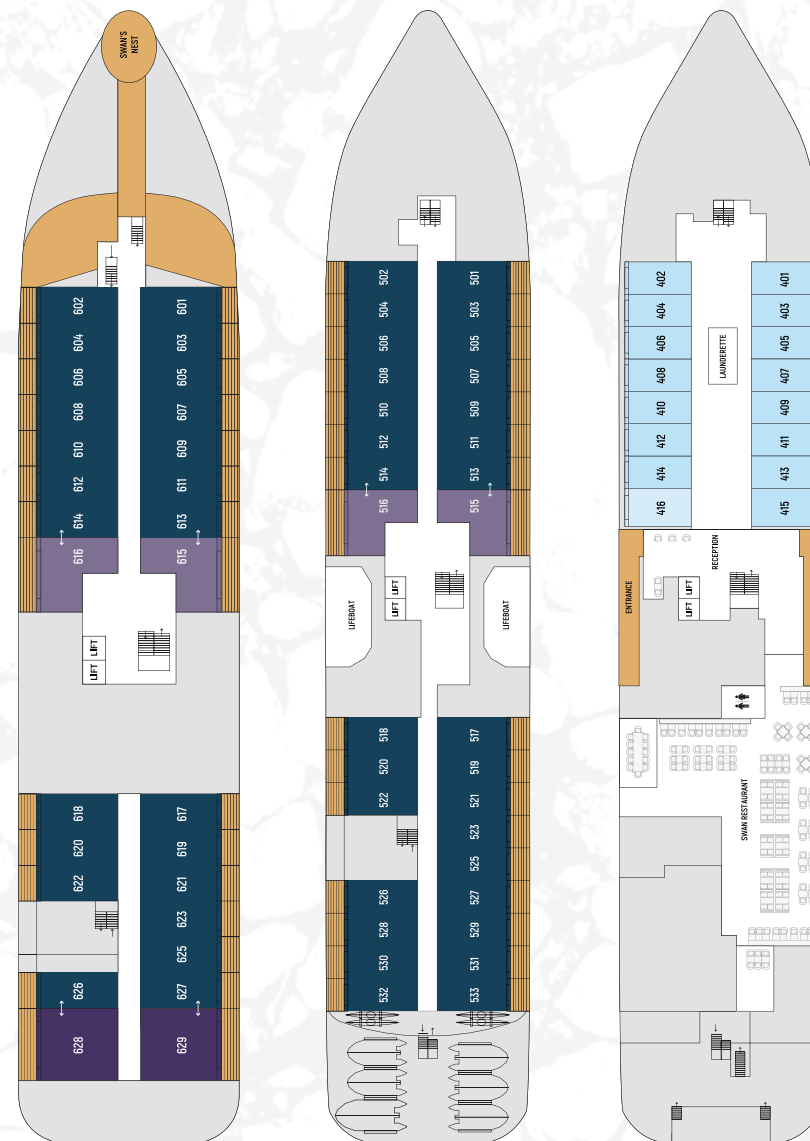

Deck 6

Deck 5

Deck 4

# Staterooms

Cozy and spacious staterooms with fireplaces and panoramic balconies



In all staterooms:

- Interactive TV
- Mini-bar
- Safe
- Internal telephone
- Air conditioning system
- Pillow menu
- Babyliss hair dryer
- Bathrobes and slippers
- Lajatica cosmetics in the bathroom
- Coffee machine
- Cabin service 24/7
- 24/7 self-service laundry available on deck 4



The laconic interior in elegant Scandinavian style is made in natural shades, using a lot of wood.

Smoothed forms of furniture elements, rounded wall surfaces, dictated by the ergonomics of the vessel, are complemented by accents of decorative objects.

Textile elements of deep colors, richness of textures and materials, competent lighting create a cozy and harmonious environment.

# Staterooms

Cozy and spacious staterooms with fireplaces and panoramic balconies



Convenient lighting choices for every mood and a real flame effect fireplace make each stateroom the perfect space to relax.

For a comfortable stay on board, the suites have a separate living room and bedroom, all suites are equipped with spacious walk-in dressing rooms and spacious bathrooms.



# Oceanview Stateroom



Area 20 sq.m.

Max. capacity 2 guests

5 oceanview staterooms are additionally equipped with a sofa to accommodate up to 4 guests

deck 4

# Oceanview Stateroom



# Oceanview Stateroom

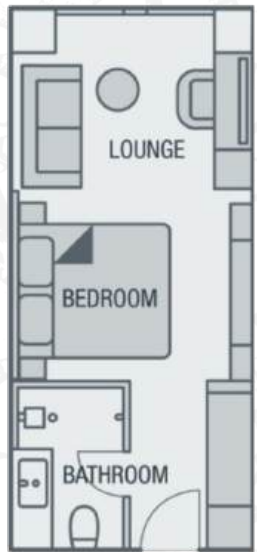

# Balcony Stateroom



Area 25 sq.m. including panoramic balcony of 5 sq.m.

Max. capacity 2 guests

26 balcony staterooms are additionally equipped with a sofa and to accommodate up to 4 guests.

Decks 5 and 6

# Balcony Stateroom



# Balcony Stateroom



# Suite



Area 40 sq.m. including panoramic balcony 10 sq.m.

Max.capacity 4 guests

Up to 5 guests can be accommodated on request

Decks 5 and 6

Suite

SWAN  
HELLENIC



# Suite

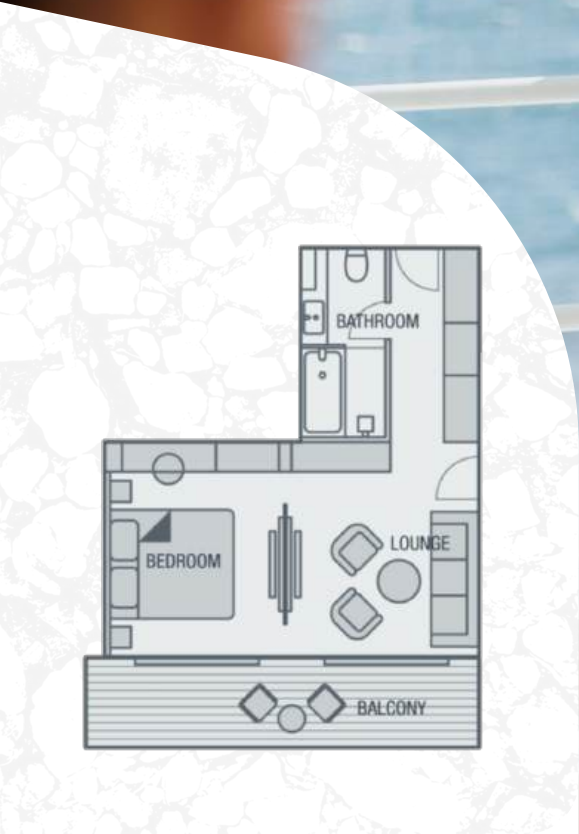

# Premium Suite



Area 47 sq.m. including panoramic balcony 12 sq.m.

Max.capacity 4 guests

Up to 5 guests can be accommodated on request

Deck 6

# Premium Suite



For a large family or company, a Suite or Premium Suite can be connected with a neighboring balcony stateroom for a total area of 77 sqm. In such case up to 9 guests can be accommodated.

# Premium Suite



# Premium Suite

 SWAN  
HELLENIC



# Premium Suite

 SWAN  
HELLENIC

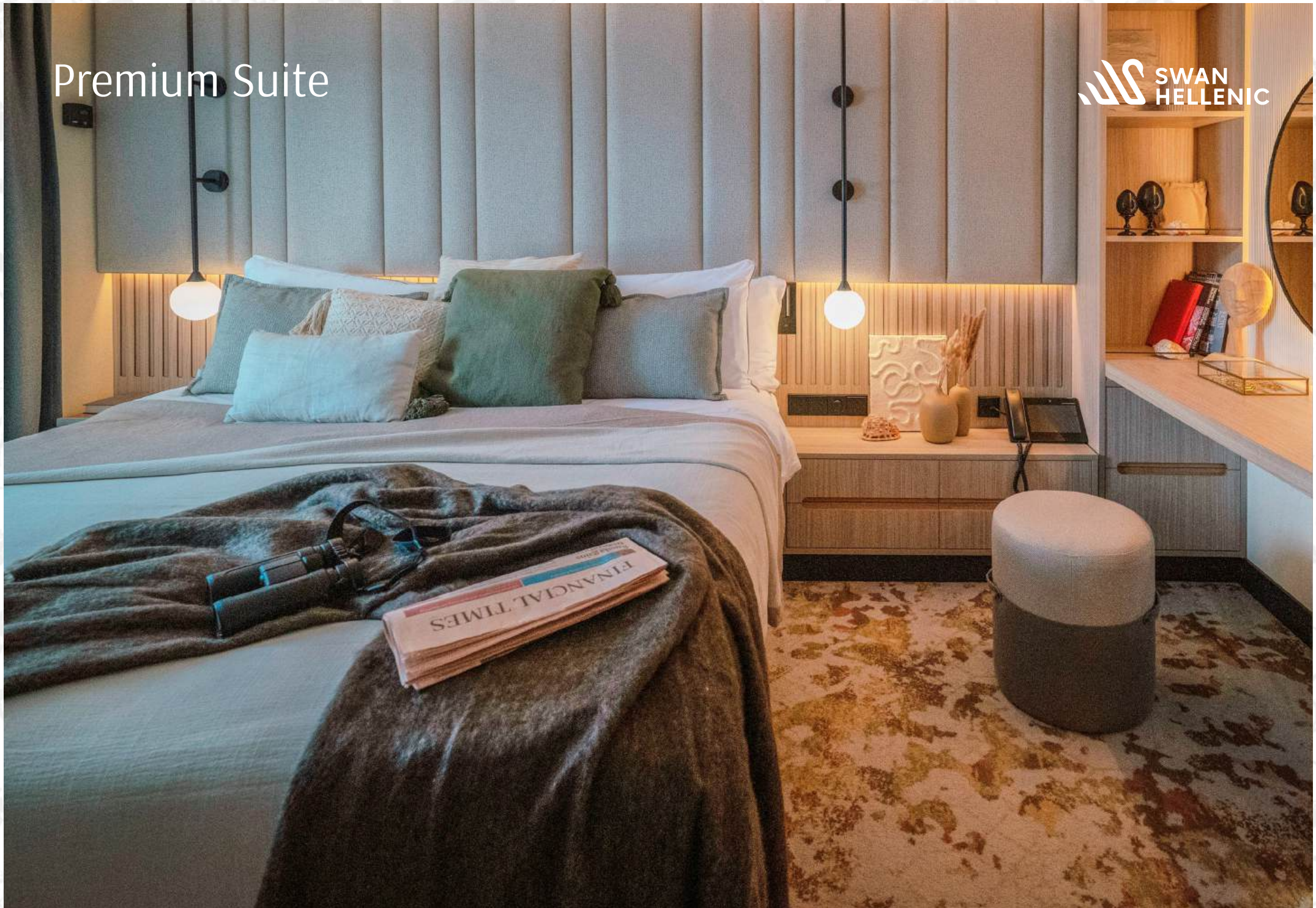



- Groups from 5 staterooms up
- 11th stateroom complimentary
- Charter price from \$90K to \$190K per day

# The charter price includes

- Bunker;
- Accommodation on board in passenger staterooms;
- Meals on board and room service, 24 hours a day;
- Coffee, tea, soft and alcoholic drinks 24 hours a day;
- Lecture programs by expedition experts and guest speakers;
- Dedicated areas with built-in audiovisual equipment for private events and parties;
- Zodiac landings and expedition activities led by our experienced expedition team including kayaking, snorkeling, sappboarding;
- Service charges on board and port charges along the itinerary;
- Basic WIFI package.



# Optional services on request:



- International flight to and from the port of embarkation;
- All transfers between airports, hotel and port;
- Shore excursions along the route in those ports where infrastructure is available;
- Mandatory health insurance;
- Premium WiFi Packages;
- Premium branded alcoholic beverages, Spa and beauty treatments, laundry services, shopping at retail stores on board.

# Charter of Expedition Vessel: Opportunities and Benefits



- Adaptation of dates, itinerary and duration of the expedition to the wishes and expectations of the Charterer
- Food and beverages on the “All Inclusive” system
- A personal on-board coordinator ensures easy planning and management of processes during the cruise
- Dedicated spaces with built-in audio-visual equipment for arranging private events and parties
- Ability to brand beverages and dishes
- Experienced video and photo operator on board
- Wi-Fi on all decks of the vessel

# Support at all stages



- Opportunity to inspect the vessel;
- Presentation/training for the charterer's team;
- Branded cruise booklet in any language;
- Marketing package for preparation of own;
- Participation of SH representative as a speaker at customer events;
- Informational support of the charterer team;
- Assistance in planning and arranging the entertainment program.

# Worldwide geography

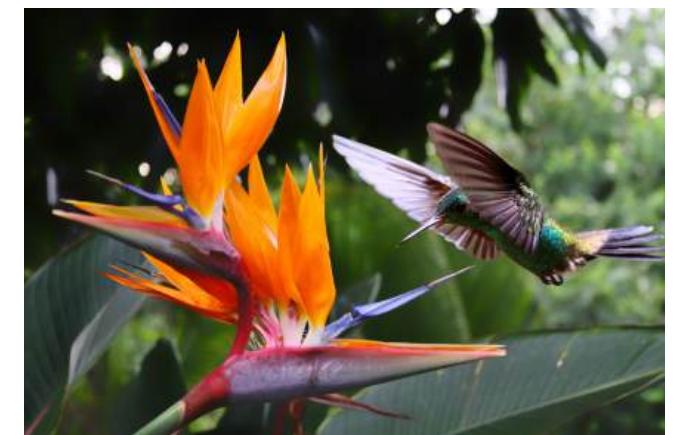

# World class adventure 2026/27

SH DIANA ① SH VEGA ② SH MINERVA ③



# Cruise calendar 2026-2027



[Download](#)

See you on board!

