

尺寸 Size:120mmx120mmx25mm  
风量 Airflow:76~112m3/hr  
45~66CFM

重量 Weight:314g  
噪音 Noise:31~42dBA  
风叶 Impeller: PBT Thermoplastic Black,UL94-VO  
外框 Frame:Aluminum Alloy  
端子 Terminals:0.5mm  
引线 Lead Wire: AWG#22 UL 1007(Optional)  
马达 Motor:Shaded Pole Induction Motor  
安规认证 Safety: UL > CUL > TUV > CE >   
温度范围 Operation Temperature:-10°C~+65°C

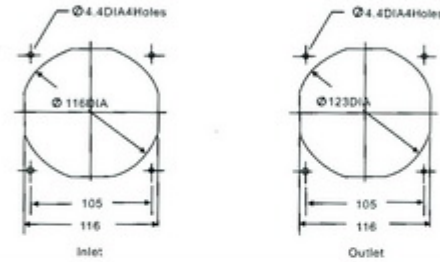

Model (型号)	Bearing System (轴承型式)	Voltage VAC (电压)	Freq. Hz (频率)	Current A (电流)	Power W (功率)	Speed RPM (转速)	Noise dBA (噪音)	Air Flow (风量)		Phase (相数)	Capacitor (电容)
								M3/hr	CFM		
G12025HA,S	Sleeve	100~125	50/60	0.25	21	2300/2700	39/42	96/112	57/66	1	/
G12025HA,S		200~240	50/60	0.13	21	2300/2700	39/42	96/112	57/66	1	/
G12025HA,B	Ball	100~125	50/60	0.25	21	2300/2700	39/42	96/112	57/66	1	/
G12025HA,B		200~240	50/60	0.13	21	2300/2700	39/42	96/112	57/66	1	/
G12025MA,S	Sleeve	100~125	50/60	0.16	16	1800/2300	31/36	76/95	45/56	1	/
G12025MA,S		200~240	50/60	0.08	16	1800/2300	31/36	76/95	45/56	1	/
G12025MA,B	Ball	100~125	50/60	0.16	16	1800/2300	31/36	76/95	45/56	1	/
G12025MA,B		200~240	50/60	0.08	16	1800/2300	31/36	76/95	45/56	1	/

